

INDEX OF SHEETS

1. COVER
2. GENERAL NOTES, TYPICAL SECTIONS, & SUMMARY QUANTITIES
3. TRAFFIC CONTROL PLAN
4. REMOVAL PLAN
5. PLAN AND PROFILE
6. EROSION CONTROL PLAN
7. GENERAL PLAN AND ELEVATION
8. GEOMETRIC LAYOUT AND REMOVAL PLAN
9. SUPERSTRUCTURE PLAN
10. SUPERSTRUCTURE SECTIONS
11. PARAPET AND MISC. DETAILS
12. PARAPET RAILING DETAILS
13. WING WALLS & END POSTS
14. ABUTMENT CONCRETE REPAIRS

LIST OF STANDARDS

- 280001-05 TEMPORARY EROSION CONTROL SYSTEMS
 442201-03 CLASS C AND D PATCHES
 515001-03 NAME PLATE FOR BRIDGES
 606001-04 CONCRETE CURB TYPE B AND COMBINATION CONCRETE CURB AND GUTTER
 606301-04 PC CONCRETE ISLANDS AND MEDIANS
 630001-08 STEEL PLATE BEAM GUARDRAIL
 631011-06 TRAFFIC BARRIER TERMINAL, TYPE 2
 631031-08 TRAFFIC BARRIER TERMINAL, TYPE 6
 635006-03 REFLECTOR AND TERMINAL MARKER PLACEMENT
 667101-01 PERMANENT SURVEY MARKERS
 701006-03 OFF-RD OPERATIONS, 2L, 2W, 15' TO 24" FROM PAVEMENT EDGE
 701101-02 OFF-RD OPERATIONS, MULTILANE, 15' TO 24" FROM PAVEMENT EDGE
 701606-06 URBAN LANE CLOSURE, MULTILANE, 2W WITH MOUNTABLE MEDIAN
 701901-01 TRAFFIC CONTROL DEVICES
 720001-01 SIGN PANEL MOUNTING DETAILS
 720006-02 SIGN PANEL ERECTION DETAILS
 720011-01 METAL POSTS FOR SIGNS, MARKERS AND DELINEATORS
 728001-01 TELESCOPING STEEL SIGN SUPPORT
 7290G1-01 APPLICATIONS OF TYPES A & B METAL POSTS (FOR SIGNS AND MARKERS)
 731001-01 BASE FOR TELESCOPING STEEL SIGN SUPPORT
 780001-02 TYPICAL PAVEMENT MARKINGS
 BLR 21-8 TYPICAL APPLICATION OF TRAFFIC CONTROL DEVICES FOR CONSTRUCTION ON RURAL LOCAL HIGHWAYS

STATE OF ILLINOIS
 DEPARTMENT OF TRANSPORTATION
 DIVISION OF HIGHWAYS

**PLANS FOR PROPOSED
 BRIDGE REHABILITATION PROJECT
 F.A.U. ROUTE 5068 (MORSAY DRIVE)
 OVER NORTH BRANCH KEITH CREEK
 ROCKFORD, IL**

SECTION 09-00565-00-BR
 WINNEBAGO COUNTY
 PROJECT BHM-5099(099)
 JOB NUMBER C-92-100-10

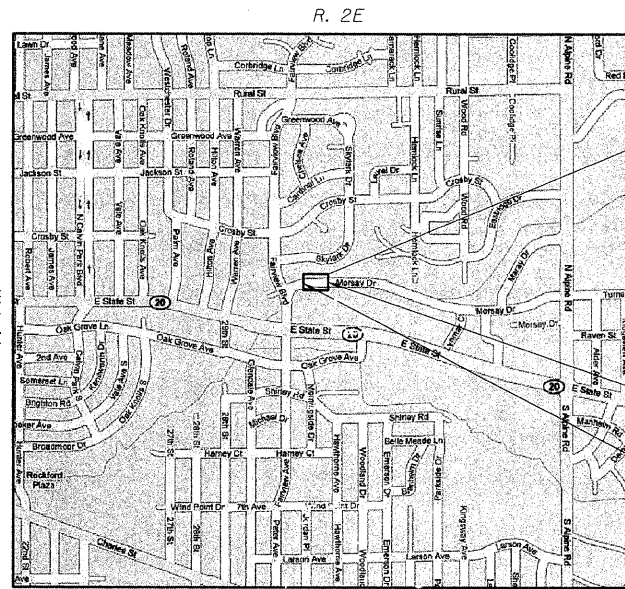

PROPOSED IMPROVEMENTS
 SUPERSTRUCTURE REPLACEMENT AND
 SUBSTRUCTURE REHABILITATION OF
 EXISTING BRIDGE OVER NORTH BRANCH
 KEITH CREEK.

IMPROVEMENT ENDS
 STATION 2+52
 IMPROVEMENT BEGINS
 STATION 1+62

LOCATION PLAN

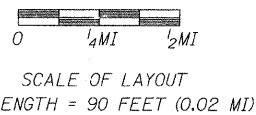

TRAFFIC DATA
 HIGHWAY CLASSIFICATION: COLLECTOR
 2030 ADT: 7500 1% TRUCKS
 DESIGN SPEED: 30 MPH
 POSTED SPEED: 30 MPH



Know what's below.
 Call before you dig.

TOLL FREE

JOINT UTILITY LOCATING INFORMATION FOR EXCAVATORS
 (J.U.L.I.E.) TELEPHONE NUMBER
 1-800-892-0123 or 811

UTILITY NOTE

THE LOCATIONS OF THOSE BURIED AND ABOVEGROUND UTILITIES SHOWN ARE APPROXIMATE, ARE SHOWN FOR CONTRACTOR INFORMATIONAL USE ONLY, AND ARE NOT TO BE REFERENCED FOR CONSTRUCTION PURPOSES. THE IMPLIED PRESENCE OR ABSENCE OF UTILITIES IS NOT TO BE CONSTRUED BY THE OWNER, ENGINEER, CONTRACTOR, OR SUBCONTRACTORS TO BE AN ACCURATE AND COMPLETE REPRESENTATION OF UTILITIES THAT MAY OR MAY NOT EXIST ON THE CONSTRUCTION SITE. BURIED AND ABOVEGROUND UTILITY LOCATION, IDENTIFICATION, AND MARKING ARE THE SOLE RESPONSIBILITY OF THE CONTRACTOR. REROUTING, DISCONNECTION, PROTECTION, ETC. OF ANY UTILITIES MUST BE COORDINATED AMONG THE CONTRACTOR, UTILITY COMPANY, AND OWNER. SITE SAFETY, INCLUDING THE AVOIDANCE OF HAZARDS, ASSOCIATED WITH BURIED AND ABOVEGROUND UTILITIES REMAIN THE SOLE RESPONSIBILITY OF THE CONTRACTOR.

APPROVED January 21 2010
Paul T. Matus
 CITY ENGINEER

PASSED Feb. 16 2010
[Signature]
 DISTRICT ENGINEER OF LOCAL ROADS & STREETS

RELEASING FOR BID BASED ON LIMITED REVIEW Feb. 16 2010
[Signature]
 DEPUTY DIRECTOR OF HIGHWAYS REGION 2 ENGINEER

STATE OF ILLINOIS
 DEPARTMENT OF TRANSPORTATION

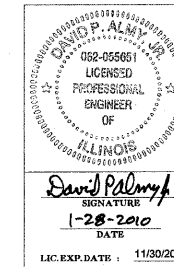

09L0012	Copyright Hanson Professional Services Inc. 2009	SHEET NO.	F.A.U. ROUTE 5068	SECTION 09-00565-00-BR	COUNTY WINNEBAGO	TOTAL SHEETS 14	SHEET NO. 1
DATE 01/20/10	HANSON	SHEETS	CONTRACT NO. 85507		FED. ROAD DIST. NO. 2 ILLINOIS FED. AID PROJECT		

CONTRACT NO. - 85507

01/20/10
 SWK 11/20/09
 MWH 11/20/09
 SWK 11/20/09
 01/20/10
 SWK 11/20/09
 MWH 11/20/09
 SWK 11/20/09