

F.A.U. RTE.	SECTION	COUNTY	TOTAL SHEETS	SHEET NO.
5102	09-00557-00-BR	Winnebago	18	1
FED. ROAD DIST. NO. 2		ILLINOIS	CONTRACT NO. 85508	

INDEX OF SHEETS

SHEET NO.	DESCRIPTION
1	COVER SHEET
2	GENERAL NOTES & SPECIFICATIONS
3	SUMMARY OF QUANTITIES
4	TYPICAL SECTIONS
5	PLAN AND PROFILE
6	TEMPORARY DETOUR PLAN
7	STRIPING, EROSION CONTROL & RESTORATION PLAN
8-16	BRIDGE PLANS
17-18	CROSS SECTIONS

STATE STANDARDS

000001-05	STANDARD SYMBOLS, ABBREVIATIONS AND PATTERNS
280001-05	TEMPORARY EROSION CONTROL SYSTEM
515001-03	NAME PLATE FOR BRIDGES
542301-02	PRECAST REINFORCED CONCRETE FLARED END SECTION
602001-01	CATCH BASIN TYPE A
602401-02	MANHOLE TYPE A
604001-03	FRAME AND LIDS TYPE 1
604006-04	FRAME AND GRATE TYPE 3
606001-04	CONCRETE CURB TYPE B AND COMBINATION CONCRETE CURB AND GUTTER
630001-08	STEEL PLATE BEAM GUARDRAIL
630301-05	SHOULDER WIDENING FOR TYPE 1 (SPECIAL) GUARDRAIL TERMINALS
631031-08	TRAFFIC BARRIER TERMINAL, TYPE 6
635006-03	REFLECTOR AND TERMINAL MARKER PLACEMENT
635011-02	REFLECTOR MARKER AND MOUNTING DETAILS
701006-03	OFF-RD OPERATIONS, 2L, 2W, 15' (4.5M) TO 24' (600mm) FROM PAVEMENT EDGE
701201-03	LANE CLOSURE, 2L, 2W, DAY ONLY, FOR SPEEDS ≥ 45 MPH
701301-03	LANE CLOSURE, 2L, 2W, SHORT TIME OPERATIONS
701901-01	TRAFFIC CONTROL DEVICES
720001-01	SIGN PANEL MOUNTING DETAILS
720006-02	SIGN PANEL ERECTION DETAILS
720011-01	METAL POSTS FOR SIGNS, MARKERS AND DELINEATORS
728001-01	TELESCOPING STEEL SIGN SUPPORT
729001-01	APPLICATIONS OF TYPES A & B METAL POSTS (FOR SIGNS AND MARKERS)
780001-02	TYPICAL PAVEMENT MARKINGS
BLR 21-8	TYPICAL APPLICATION OF TRAFFIC CONTROL DEVICES FOR CONSTRUCTION ON RURAL LOCAL HIGHWAYS
701801-04	LANE CLOSURE MULTILANE 1W OR 2W CROSSWALK OR SIDEWALK CLOSURE
BLR 22-6	TYPICAL APPLICATION OF TRAFFIC CONTROL DEVICES FOR CONSTRUCTION ON RURAL LOCAL HIGHWAYS

CITY OF ROCKFORD PLANS FOR PROPOSED FEDERAL AID HIGHWAY

**FAU ROUTE 5102
CENTRAL AVENUE
OVER THE SOUTH BRANCH OF KENT CREEK
SECTION 09-00557-00-BR
BRIDGE SUPERSTRUCTURE REPLACEMENT
PROJECT NO. BHM-5099 (081)
S.N. 101-6124
WINNEBAGO COUNTY
C-92-097-09**

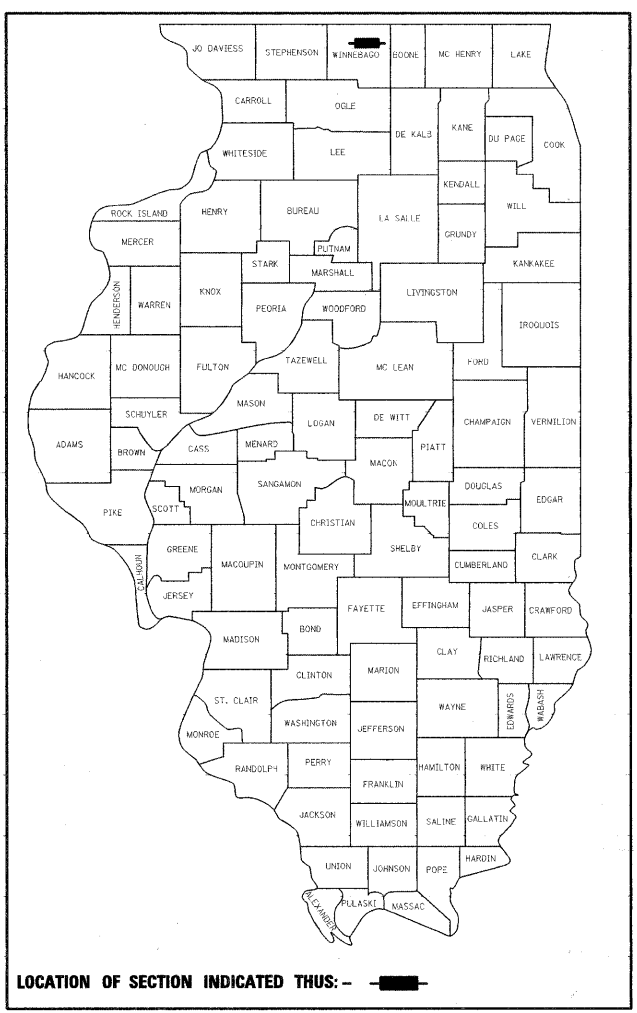

**PRINTED BY THE AUTHORITY
OF THE STATE OF ILLINOIS**

STRUCTURE INFORMATION:
EXISTING SN: 101-6124:
EXISTING THREE SPAN STRUCTURE CONSISTS OF CONTINUOUS REINFORCED CONCRETE SLAB WITH AN OUT-TO-OUT WIDTH OF 39'-0" AND A TOTAL LENGTH OF 76'-3 5/8" BK. TO BK. ABUTMENTS WITH A 9 DEGREE 56 MINUTE SKEW. THE SUBSTRUCTURES CONSIST OF PILE BENT PIERS AND ABUTMENTS. SUPERSTRUCTURE TO BE REMOVED AS SHOWN. SALVAGED EXISTING ALUMINUM RAILINGS TO REMAIN PROPERTY OF THE CITY.

PROPOSED WORK INCLUDES PLACING A REINFORCED CONCRETE SLAB SUPERSTRUCTURE AS SHOWN.

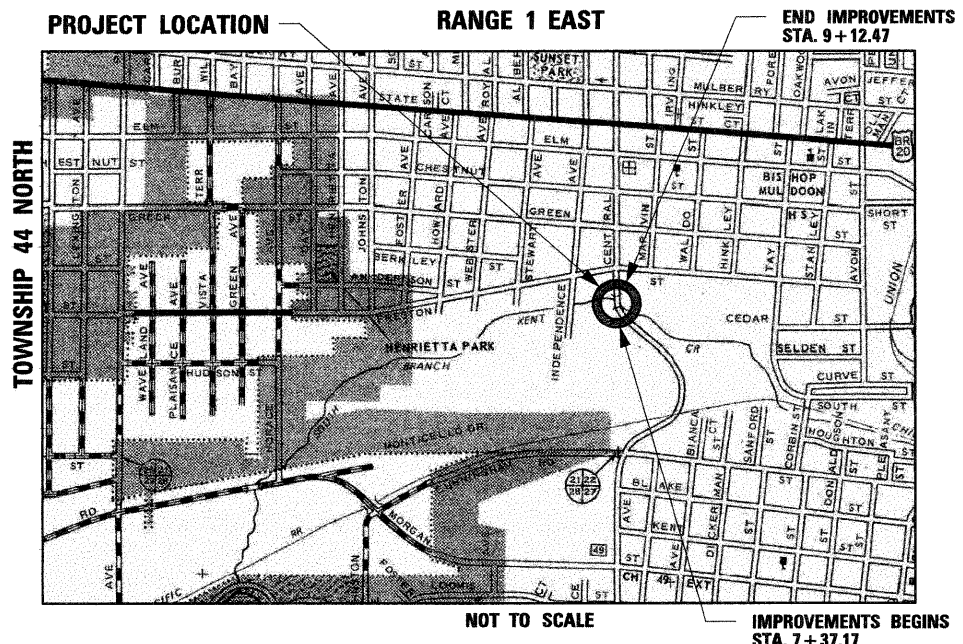

FUNCTIONAL CLASSIFICATION
MINOR ARTERIAL (URBAN)

DESIGN SPEED
CENTRAL AVE.: 35 MPH

SPEED LIMIT
CENTRAL AVE.: 30 MPH

TRAFFIC DATA:
CENTRAL AVE: ADT=5,800 (2008)
ADT=7,200 (2030)
4% TRUCKS

ROCKFORD TOWNSHIP
GROSS LENGTH OF IMPROVEMENT = 176 FT. = 0.03 MILES
NET LENGTH OF IMPROVEMENT = 176 FT. = 0.03 MILES

FEDERAL AID DESIGN ENGINEER: LAURA CONNOLLY (815) 284-2271

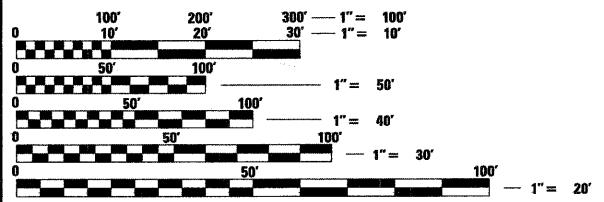

FULL SIZE PLANS HAVE BEEN PREPARED USING STANDARD ENGINEERING SCALES. REDUCED SIZED PLANS WILL NOT CONFORM TO STANDARD SCALES. IN MAKING MEASUREMENTS ON REDUCED PLANS, THE ABOVE SCALES MAY BE USED.

J.U.L.I.E.
JOINT UTILITY LOCATION INFORMATION FOR EXCAVATION
1-800-892-0123

CONTRACT NO. 85508

ENGINEER AND SURVEYOR:
SEC GROUP INC.
420 NORTH FRONT STREET
MCHENRY, ILLINOIS 60050-2136
(815) 385-1778
CONTACT:
BOB DAVIES, S.E., P.E. - STRUCTURAL ENGINEER
KEVIN M. ARFT, P.E. - PROJECT ENGINEER

STRUCTURAL ENGINEER'S SIGN & SEAL

Robert G. Davies
ROBERT G. DAVIES, S.E., P.E.
DATE: 1-26-2010
EXPIRES: 11/30/2010

PROFESSIONAL ENGINEER'S SIGN & SEAL

Kevin M. Arft
KEVIN M. ARFT, P.E.
DATE: 01-26-2010
EXPIRES: 11-30-2011

CITY OF ROCKFORD

APPROVED: January 27, 2010 (DATE)
Bud T. Moberg
CITY OF ROCKFORD, CITY ENGINEER

PASSED: February 9, 2010 (DATE)
Paul J. Plow
DISTRICT 2 ENGINEER OF LOCAL ROADS & STREETS

RELEASING FOR BID
BASED ON LIMITED
REVIEW: February 9, 2010 (DATE)
Shirley F. Puzawa
DEPUTY DIRECTOR OF HIGHWAYS, REGION 2 ENGINEER