

LEGACY PARK

THOMAS AVE.

SEE SHEET 29
MATCH LINE - STA. 27+25

MATCH LINE - STA. 32+50

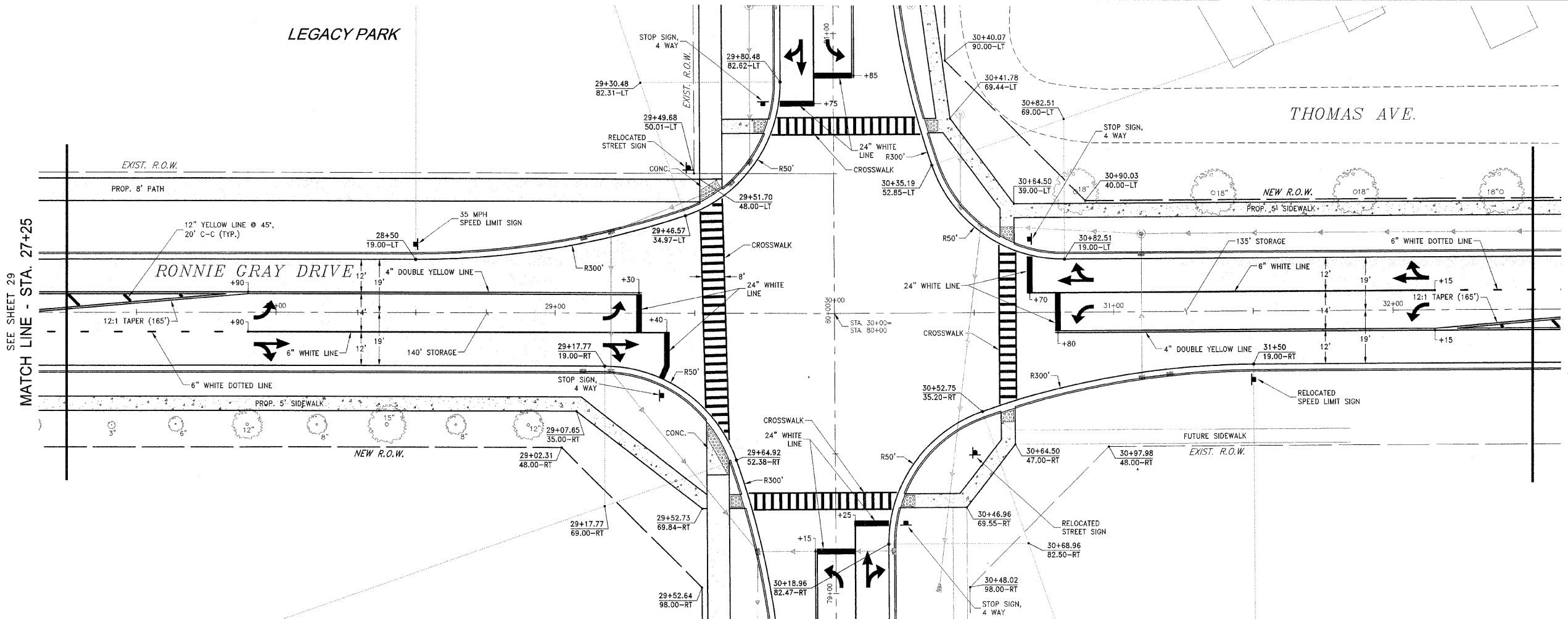

MATCH LINE - STA. 32+50

END IMPROVEMENT (RONNIE GRAY DRIVE)
STA. 36+00

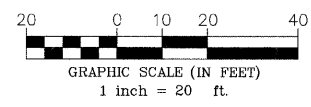
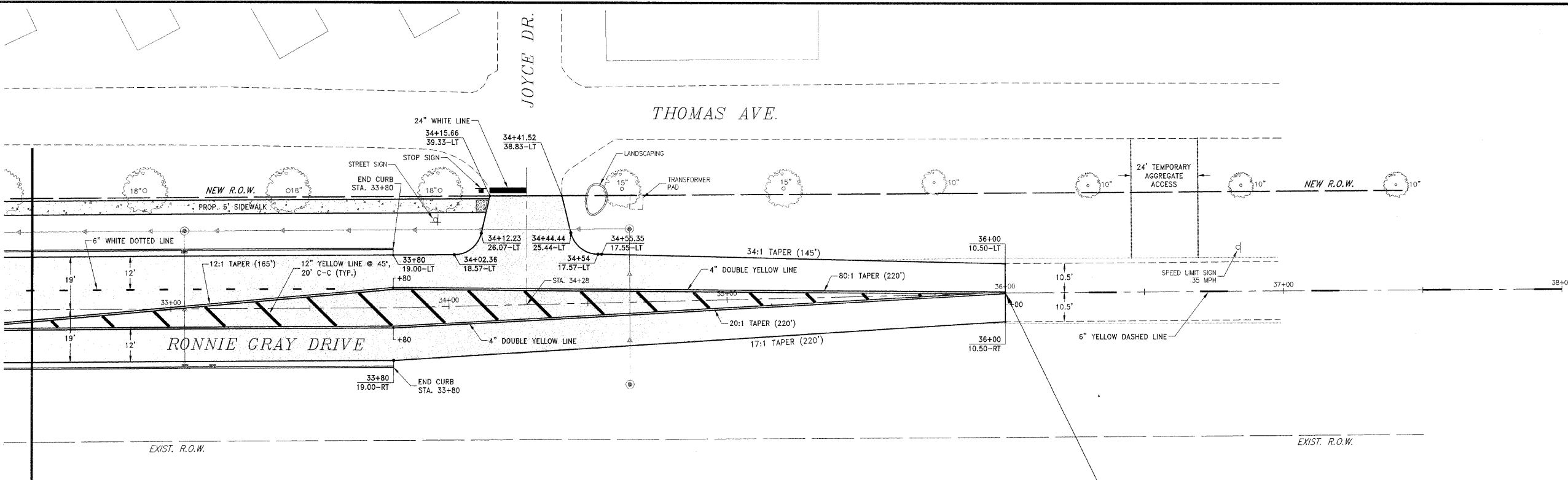

F.A.L. NO.	SECTION	COUNTY	TOTAL SHEETS	SHEET NO.
**	**	KANKAKEE	59	30

CONTRACT NO. 87252

FED. ROAD DIST. NO. ILLINOIS FED. AID PROJECT

* RONNIE GRAY DRIVE (6502)
MAPLE STREET (6512)

** 00-00054-00-FP

TYSON ENGINEERING, INC.
CONSULTING CIVIL ENGINEERS
LAND SURVEYORS
DESIGN FIRM LICENSE #184-001136

367 SOUTH SCHUYLER AVENUE
KANKAKEE, ILLINOIS 60901
PHONE (815) 932-7406

This document and the ideas and designs incorporated herein, as an instrument of professional service, is the property of Tyson Engineering Inc. and is not to be used in whole or in part, for any other project without written authorization of Tyson Engineering Inc.

Do not scale drawings. Use dimensions only.
Contractor shall be responsible for verifying all dimensions.
Information herein and herein is confidential.

REVISIONS			
NO.	DATE	BY	DESCRIPTION
1	10/30/09	MRG	PER IDOT REVIEW

RONNIE GRAY DRIVE
STRIPING AND SIGNAGE
PLAN

PROJECT:
VILLAGE OF MANTENO
MAPLE STREET AND RONNIE GRAY DRIVE IMPROVEMENTS
MANTENO, ILLINOIS

SECTION
00-00054-00-FP

DATE: 9/25/09 JOB NO. E06030

SCALE: HORIZ.: 1"=20'
VERT.: N/A FILE NO.

DRAWN BY: MRG SHEET

CHECKED BY: SRM SHEET
30

0000054-00-FP-30.dwg
11/25/09 11:28:28 AM
SRM