

F.A.S. ROUTE NO.	SECTION	ILLINOIS PROJECT	CONTRACT NO.	COUNTY	TOTAL SHEETS	SHEET NUMBER
268	06-00173-00-SW	TE-00D3(58)	87359	LASALLE	15	2

SUMMARY OF QUANTITIES			SIDEWALK	STRUCTURE	TOTAL
NO.	DESCRIPTION	UNIT	QTY	QTY	QTY
20200100	EARTH EXCAVATION	CU YD	292	-	292
21101615	TOPSOIL FURNISH & PLACE, 4"	SQ YD	581	-	581
25000115	SEEDING, CLASS 1B	ACRE	0.2	-	0.2
25000400	NITROGEN FERTILIZER NUTRIENT	POUND	18	-	18
25000500	PHOSPHOROUS FERTILIZER NUTRIENT	POUND	18	-	18
25000600	POTASSIUM FERTILIZER NUTRIENT	POUND	18	-	18
25100115	MULCH, METHOD 2	ACRE	0.2	-	0.2
28000400	PERIMETER EROSION BARRIER	FOOT	609	-	609
28000500	INLET & PIPE PROTECTION	EACH	2	-	2
35100120	AGGREGATE BASE COURSE, TYPE A, 2"	SQ YD	433	-	433
42400100	PORTLAND CEMENT CONCRETE SIDEWALK, 4"	SQ FT	3528	-	3528
42400200	PORTLAND CEMENT CONCRETE SIDEWALK, 5"	SQ FT	366	-	366
42400800	DETECTABLE WARNINGS	SQ FT	26	-	26
44000100	PAVEMENT REMOVAL	SQ YD	74	-	74
44000600	SIDEWALK REMOVAL	SQ FT	116	-	116
* 50104605	CONCRETE RETAINING WALL REMOVAL	CU YD	-	1.6	1.6
50200100	STRUCTURE EXCAVATION	CU YD	-	30	30
50300225	CONCRETE STRUCTURES	CU YD	-	10.4	10.4
50800105	REINFORCEMENT BARS	POUND	-	920	920
50900605	HANDRAIL REMOVAL	FOOT	-	10	10
51201300	FURNISH STEEL PILES HP 8X36	FOOT	-	158	158
51202305	DRIVING PILES	FOOT	-	150	150
* 60600705	CONCRETE CURB, TYPE B (ABUTTING EXISTING PAVEMENT)	FOOT	77	-	77
* 66410300	CHAIN LINK FENCE REMOVAL	FOOT	22	-	22
67100100	MOBILIZATION	L SUM	1	-	1
70102620	TRAFFIC CONTROL & PROTECTION STANDARD 701501	L SUM	1	-	1
Δ 78001150	PAINT PAVEMENT MARKING - LINE 12"	FOOT	121	-	121
* XX001758	WOOD FENCE REMOVAL	FOOT	32	-	32
* X0322508	PEDESTRIAN TRUSS SUPERSTRUCTURE	SQ FT	-	1278	1278

* SEE SPECIAL PROVISIONS
Δ SPECIALTY ITEMS

GENERAL NOTES:

- 1.) ALL ELEVATIONS REFER TO U.S.G.S. MEAN SEA LEVEL DATUM.
- 2.) ABANDONED UNDERGROUND UTILITIES THAT CONFLICT WITH CONSTRUCTION SHALL BE DISPOSED OF OUTSIDE THE LIMITS OF THE RIGHT OF WAY ACCORDING TO ARTICLE 202.03 OF THE STANDARD SPECIFICATIONS (IDOT) AND AS DIRECTED BY THE ENGINEER. THIS WORK WILL NOT BE PAID FOR SEPARATELY, BUT SHALL BE INCLUDED IN THE COST OF EARTH EXCAVATION.
- 3.) ANY REFERENCE TO A STANDARD IN THESE PLANS SHALL BE INTERPRETED TO MEAN THE EDITION AS INDICATED BY THE SUBNUMBER SHOWN IN THE LIST OF STANDARDS INCLUDED IN THESE PLANS.
- 4.) MEMBERS OF JULIE KNOWN TO BE WITHIN THE LIMITS OF THE IMPROVEMENTS ARE:

AT&T: 65 W. WEBSTER STREET, FLOOR 3 - ENGINEERING, JOLIET, ILLINOIS 60431
MARSEILLES TELEPHONE: 244 LINCOLN STREET, MARSEILLES, ILLINOIS 61341
CITY OF MARSEILLES: 209 LINCOLN STREET, MARSEILLES, ILLINOIS 61341
AMEREN: 340 RACCUGLIA DRIVE, P.O. BOX 1428, LASALLE, ILLINOIS 61301
NICOR: 1844 FERRY ROAD, NAPERVILLE, ILLINOIS 60563
MEDIACOM: 2506-1/2 N. BLOOMINGTON STREET, STREATOR, ILLINOIS 61364

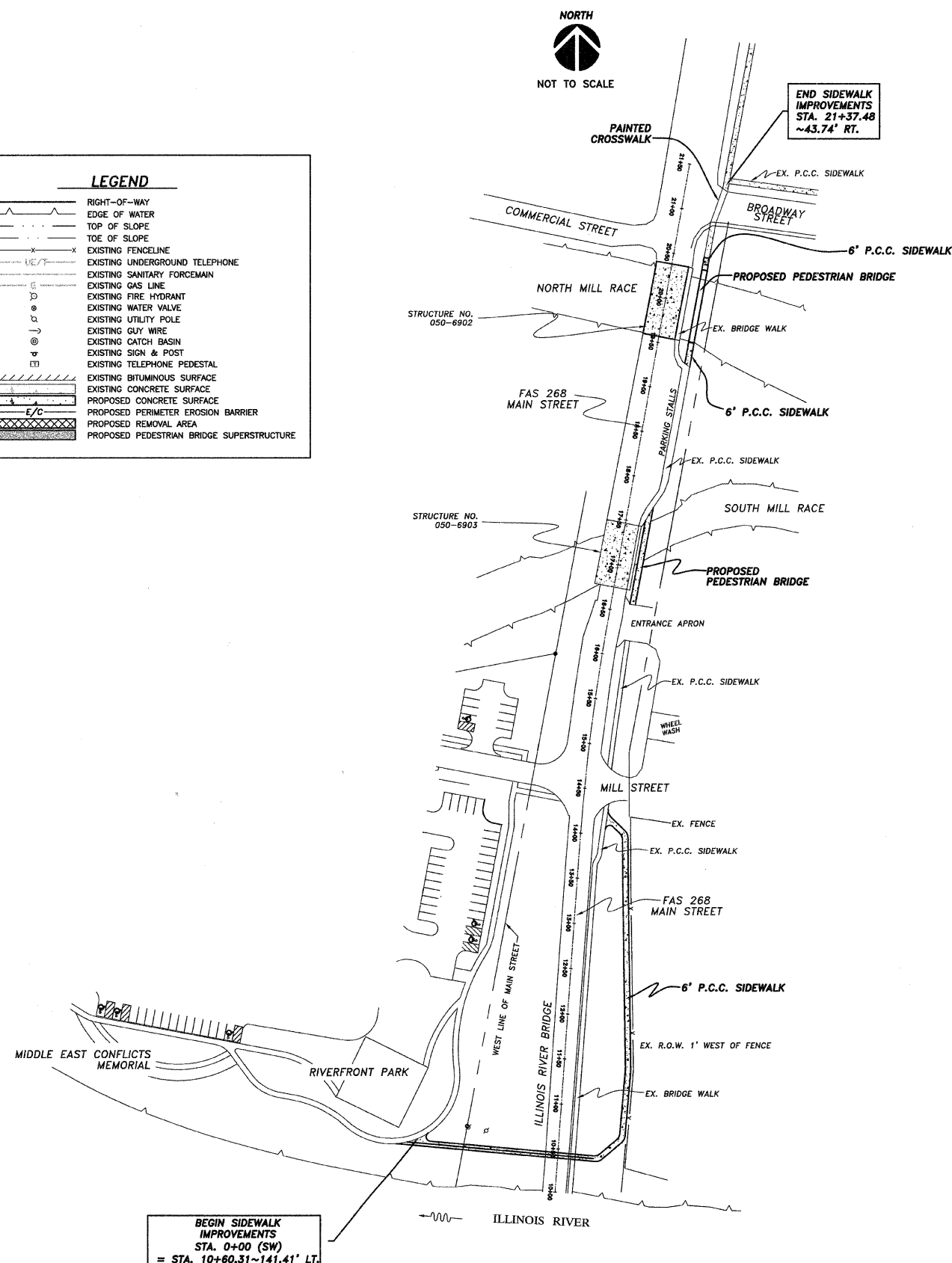
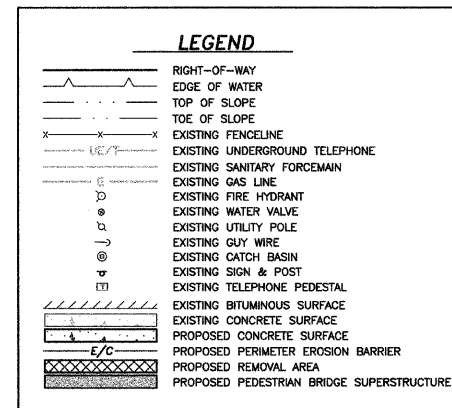

F.A.S. 268 - MAIN STREET
SECTION 06-00173-00-SW
CITY OF MARSEILLES, LASALLE COUNTY

1304 GEMINI CIRCLE
OTTAWA, IL 61350-1692
TEL: 815-434-3925
FAX: 815-434-3953

E TSCHIED
D DUTTLINGER
& ASSOCIATES
Professional Engineers & Land Surveyors

PROFESSIONAL DESIGN
FIRM # 184-000711
DATE PLOTTED:
OCTOBER 21, 2009
DRAWN BY:
A.R.G.
CHECKED BY:

PROJECT NUMBER:
2057.92
DRAWING FILE:
205792_NOTES
SHEET NO.
2 OF 15