

ROUTE NO.	SECTION	COUNTY	TOTAL SHEETS	SHEET NO.
08-00024-00-SW	TAZEWELL	ILLINOIS	19	15
FEDERAL ROAD DIST. NO.		CONTRACT NO. 8996		

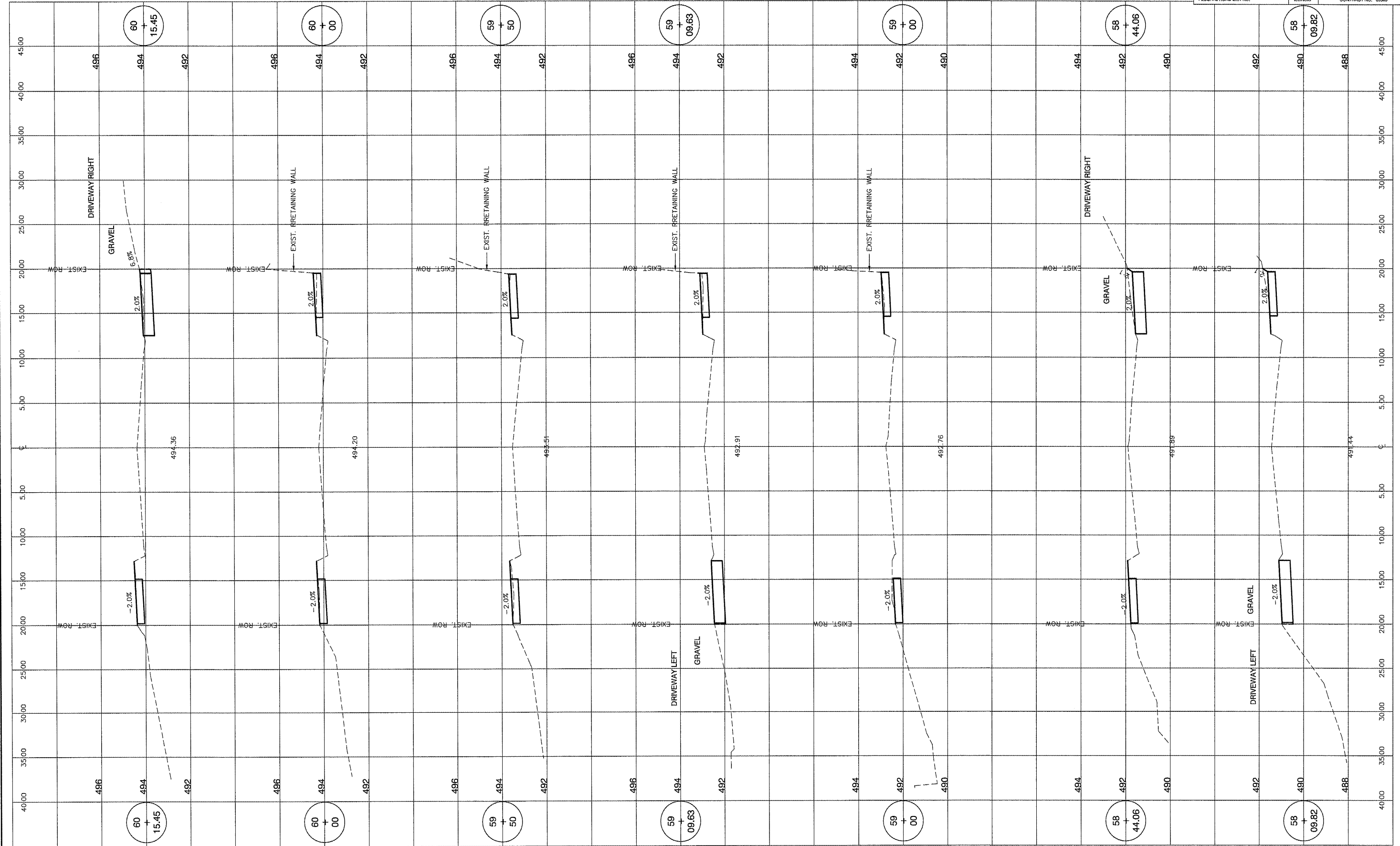

M MOHR & KERR ENGINEERING & LAND SURVEYING, P.C.
 7336 N. University Ave. Office: (309) 692-8500
 Peoria, Illinois 61614 Fax: (309) 692-8501
 www.mohrandkerr.com Professional Design Firm #184.005091

REV.	DATE	NATURE OF REVISION	CHECKED

SURVEYED	MDP
DRAWN	DEH
CHECKED	SDK
SCALE	1" = 5' H 1" = 2' V
DATE	02-15-10

CLIENT: VILLAGE OF NORTH PEKIN
 TAZEWELL COUNTY, ILLINOIS

TITLE: NORTH PEKIN SIDEWALK IMPROVEMENTS
 LEE STREET CROSS SECTIONS
 STA. 58+09.82 TO STA. 60+15.45

PROJECT NO. 09-087
 SHEET 15 OF 19
 DRAWING NO. 15