

STATE OF ILLINOIS
DEPARTMENT OF TRANSPORTATION

Notes:
See sheet 12 of 17 for Sections C-C & D-D.
a(E), and w(E) bar spacings measured perpendicular to \varnothing Rdwy.

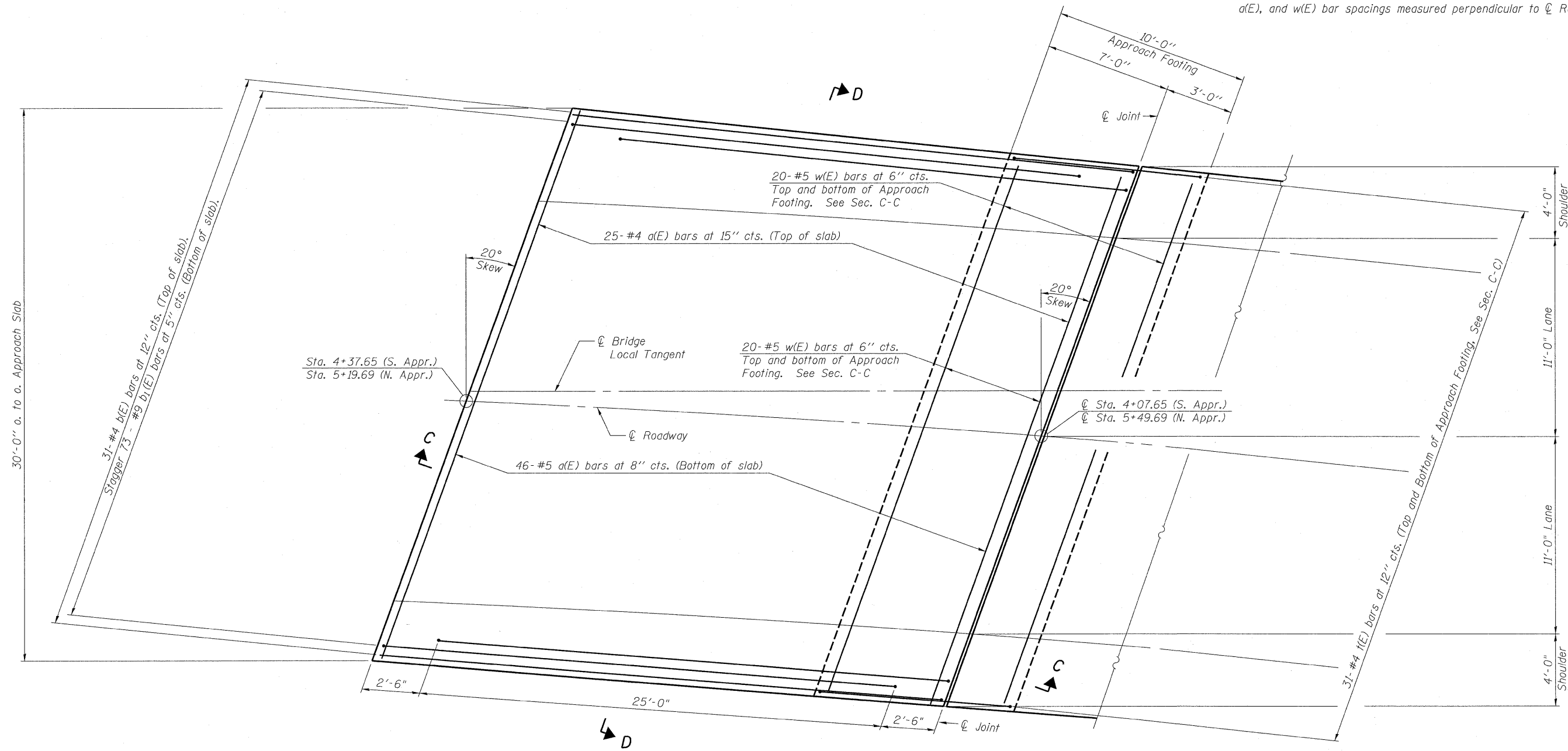

* Tilt #9 b1(E) bars as required to maintain clearance.

PLAN

(Sheet 1 of 2)

BRIDGE APPROACH SLAB DETAILS
F.A.S. ROUTE 454
SECTION 04-00070-00-BR
SCHUYLER COUNTY
STATION 4+79.00
S.N. 085-3055



DESIGNED NIEWINSKI
CHECKED TRELLO
DRAWN VERENSKI
CHECKED TRELLO

G&B PROJECT: - PLOT DRIVER = V81.TDS700.PS.LOCAL.ID01.plt\Fg
FILE NAME = J:\07258\CADD\CAD\sheds\SN 085-3055\0853055-07258-Sht-Approach.dgn
PLOT DATE = 9/18/2009 PLOT SCALE = 21:0000 '1' / in. USER NAME = Frankv

BA-L

10-31-08

SHEET NO. 11	F.A.S. RTE.	SECTION	COUNTY	TOTAL SHEETS	SHEET NO.
	454	04-00070-00-BR	SCHUYLER	30	19
17 SHEETS	CONTRACT NO. 93499				
FED. ROAD DIST. NO. _		ILLINOIS	FED. AID PROJECT		