

COORDINATE DATA:

218	N 1149861.30
	E 2424933.86

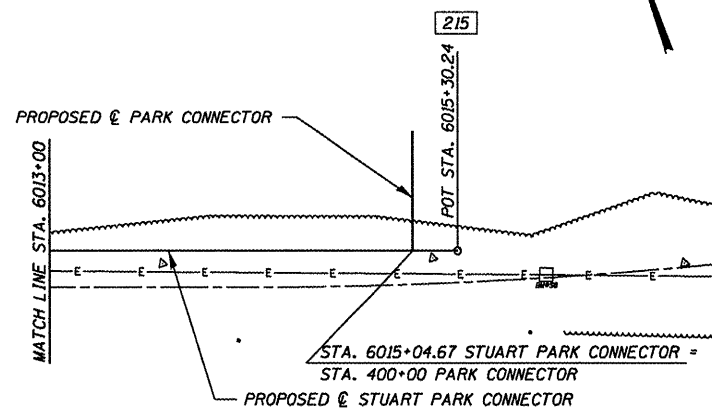

<p>CURVE SPC-1 PI STA. 6000+45.48 $\Delta = 11^\circ 20' 11''$ (RT) $D = 25^\circ 27' 53''$ $T = 22.33'$ $R = 225.00'$ $L = 44.52'$ $E = 1.11'$ PC STA. 6000+23.15 PT STA. 6000+67.67</p>	<p>CURVE SPC-2 PI STA. 6011+03.68 $\Delta = 14^\circ 50' 07''$ (LT) $D = 25^\circ 27' 53''$ $T = 29.29'$ $R = 225.00'$ $L = 58.26'$ $E = 1.90'$ PC STA. 6010+74.38 PT STA. 6011+32.64</p>	<p>CURVE SPC-3 PI STA. 6011+61.93 $\Delta = 14^\circ 50' 07''$ (RT) $D = 25^\circ 34' 43''$ $T = 29.16'$ $R = 224.00'$ $L = 58.00'$ $E = 1.89'$ PC STA. 6011+32.77 PT STA. 6011+90.77</p>
<p>CURVE SPC-4 PI STA. 6007+50.00 $\Delta = 5^\circ 42' 38''$ (RT) $D = 25^\circ 27' 53''$ $T = 11.22'$ $R = 225.00'$ $L = 22.43'$ $E = 0.28'$ PC STA. 6007+38.78 PT STA. 6007+61.20</p>	<p>CURVE SPC-5 PI STA. 6008+00.23 $\Delta = 5^\circ 42' 38''$ (LT) $D = 25^\circ 27' 53''$ $T = 22.50'$ $R = 225.00'$ $L = 44.85'$ $E = 1.12'$ PC STA. 6007+77.73 PT STA. 6008+22.58</p>	<p>CURVE SPC-6 PI STA. 6008+50.33 $\Delta = 11^\circ 25' 16''$ (LT) $D = 25^\circ 27' 53''$ $T = 11.22'$ $R = 225.00'$ $L = 22.43'$ $E = 0.28'$ PC STA. 6008+39.11 PT STA. 6008+61.53</p>

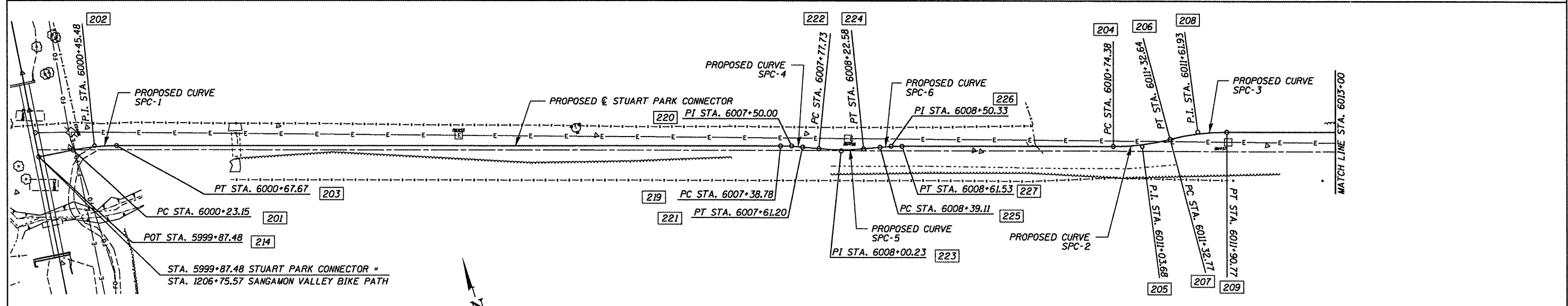
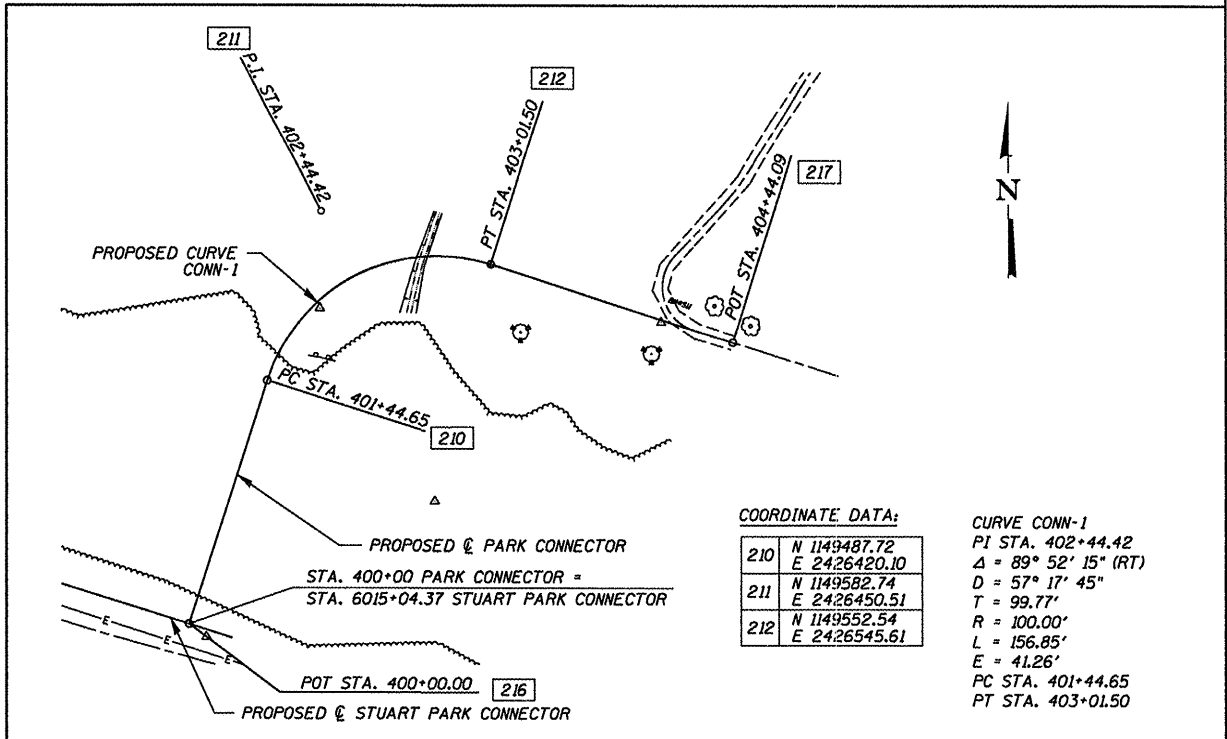

COORDINATE DATA:

210	N 1149487.72
	E 2426420.10
211	N 1149582.74
	E 2426450.51
212	N 1149552.54
	E 2426545.61

CURVE CONN-1
 PI STA. 402+44.42
 $\Delta = 89^\circ 52' 15''$ (RT)
 $D = 57^\circ 17' 45''$
 $T = 99.77'$
 $R = 100.00'$
 $L = 156.85'$
 $E = 41.26'$
 PC STA. 401+44.65
 PT STA. 403+01.50

COORDINATE DATA:

201	N 1149782.55
	E 2424960.90
202	N 1149780.06
	E 2424983.09
203	N 1149773.25
	E 2425004.36
204	N 1149466.45
	E 2425962.86
205	N 1149457.52
	E 2425990.76
206	N 1149456.03
	E 2426020.02

207	N 1149456.02
	E 2426020.14
208	N 1149454.54
	E 2426049.27
209	N 1149445.65
	E 2426077.04
214	N 1149786.53
	E 2424925.46
215	N 1149342.16
	E 2426400.36
216	N 1149349.96
	E 2426376.00

217	N 1149509.38
	E 2426681.50
219	N 1149568.66
	E 2425643.53
220	N 1149565.24
	E 2425654.22
221	N 1149560.77
	E 2425664.51
222	N 1149554.19
	E 2425679.67
223	N 1149545.23
	E 2425700.31

224	N 1149540.54
	E 2425722.32
225	N 1149537.09
	E 2425738.48
226	N 1149534.75
	E 2425749.45
227	N 1149531.33
	E 2425760.15

FILE NAME =	USER NAME =	DESIGNED - L.F.S.	REVISED -
84898-sht-alignments-elt1.dgn		DRAWN - TWK	REVISED -
	PLOT SCALE =	CHECKED - S.W.M.	REVISED -
	PLOT DATE = 5/27/2009	DATE - 02/09/09	REVISED -

SANGAMON VALLEY TRAIL

HLR HAMPTON, LENZINI & RENWICK, INC.
 CIVIL & STRUCTURAL ENGINEERS
 LAND SURVEYORS

ALIGNMENT

SECTION	COUNTY	TOTAL SHEETS	SHEET NO.
05-00173-00-BT	SANGAMON	173	19
CONTRACT NO.			
FED. ROAD DIST. NO. ILLINOIS FED. AID PROJECT			