

B.M. #19 Chiseled Square on top of Southwest Wingwall of RR Bridge No. 1865, Station 1122+69.8, 7.9' Lt., Elev. 580.76

Existing Structure: SN 084-9924, originally built in 1924 as C&NW Railway Bridge No. 1865 over Washington Street. The existing structure is a 3-span riveted deck plate girder bridge with precast concrete units on spread footing concrete piers and pile supported abutments. The structure is 196'-4" fc.-to-fc of abutment backwalls with a 14'-0" o.-o. of deck width. The existing structure will be rehabilitated to carry pedestrian traffic.

The Contractor will remove the existing precast concrete units, modify the existing abutments, construct a new timber deck and railing, and install fencing.

No Salvage.

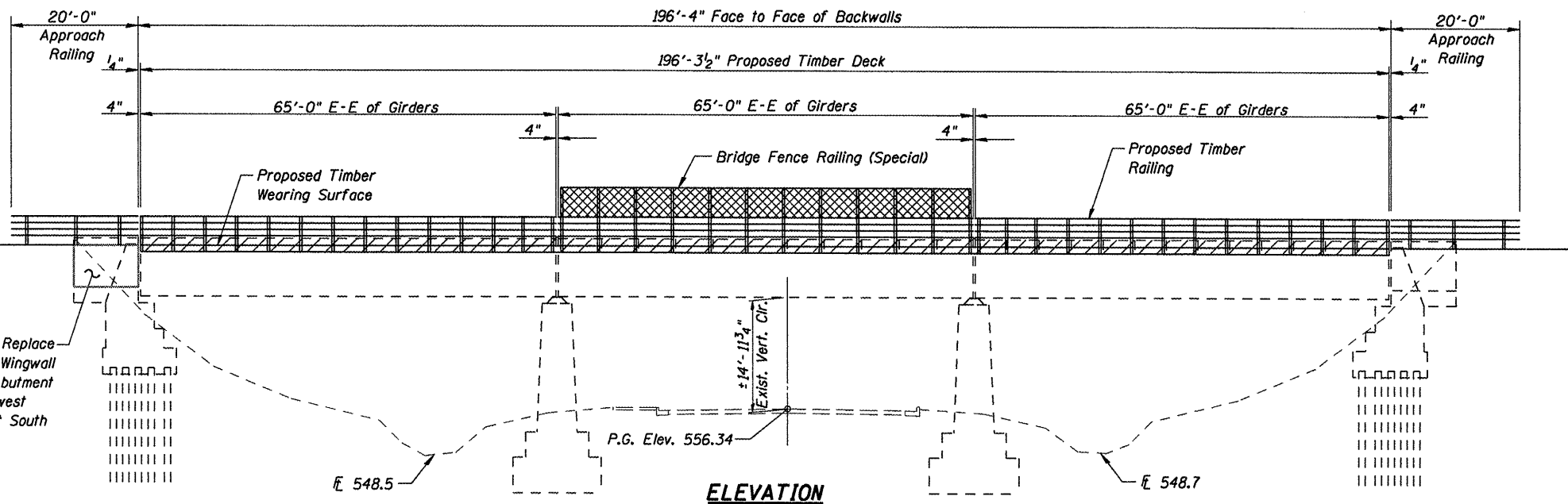

ELEVATION

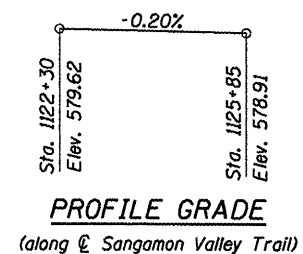

PROFILE GRADE
(along & Sangamon Valley Trail)

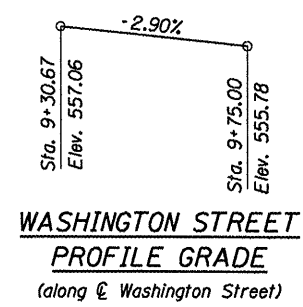

WASHINGTON STREET
PROFILE GRADE
(along & Washington Street)

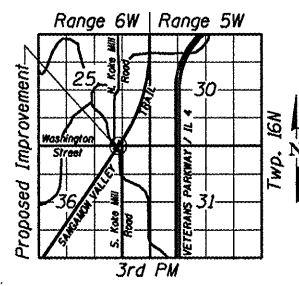

LOCATION SKETCH

Removal of Existing Precast Concrete Units

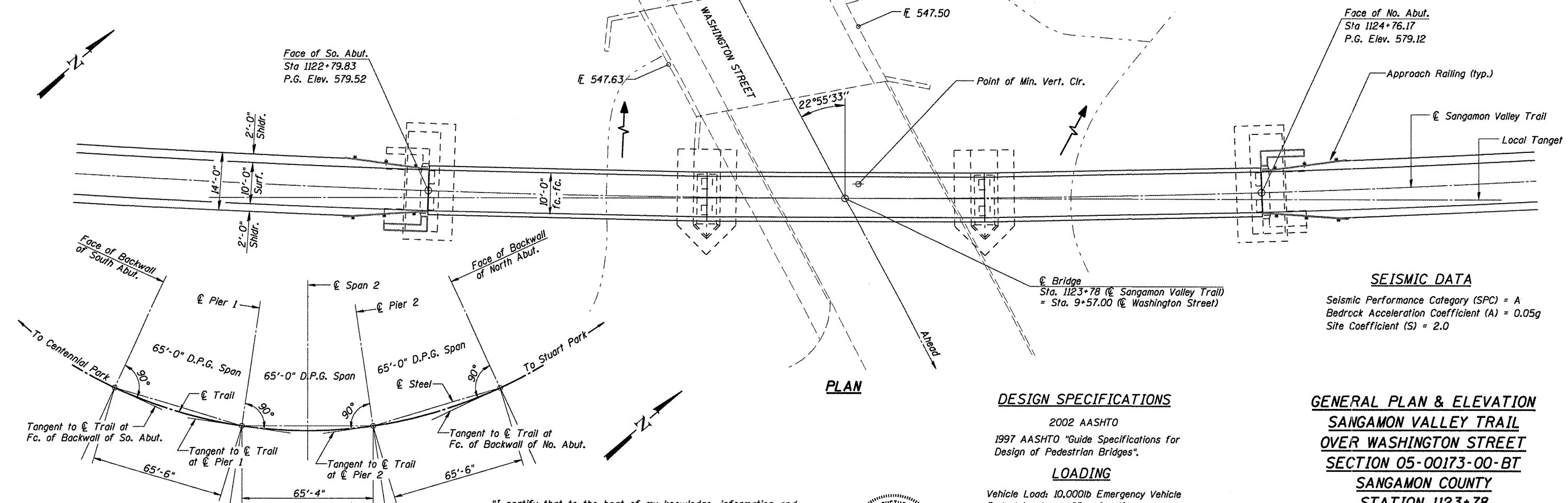

PLAN

LAYOUT SKETCH

Diagram showing substructure in relation to & Trail

SEISMIC DATA

Seismic Performance Category (SPC) = A
Bedrock Acceleration Coefficient (A) = 0.05g
Site Coefficient (S) = 2.0

DESIGN SPECIFICATIONS

2002 AASHTO
1997 AASHTO "Guide Specifications for Design of Pedestrian Bridges".

LOADING

Vehicle Load: 10,000lb Emergency Vehicle
Pedestrian Load: 85 psf uniform load

DESIGN STRESSES

f'_c = 3,500 psi (Substructure)
 f_y = 60,000 psi (Reinforcement)
 f_b = 1,500 psi (Timber)
 f_b = 1,850 psi (Timber Planking)

GENERAL PLAN & ELEVATION
SANGAMON VALLEY TRAIL
OVER WASHINGTON STREET
SECTION 05-00173-00-BT
SANGAMON COUNTY
STATION 1123+78
SVT BRIDGE NO. 13
STRUCTURE NO. 084-9924

"I certify that to the best of my knowledge, information and belief, this bridge design is structurally adequate for the design loading shown on the plans. The design is an economical one for the style of structure and complies with requirements of the current 'AASHTO Guide Specifications for Design of Pedestrian Bridges'."

Michael D. Cummins 6/9/09
ILLINOIS STRUCTURAL NO. 4822 (Expires 11/30/10)



JOB = 2192	DESIGNED	M.D.C.
FILE = 2192wash_gpe	CHECKED	A.A.N.
DATE = 6/8/2009	DRAWN	T.S.H.
	CHECKED	M.D.C.

Sheet 1 of 6	RTE.	SECTION	COUNTY	TOTAL SHEETS	SHEET NO.
	SVT	05-00173-00-BT	SANGAMON	173	88
	SANGAMON VALLEY TRAIL			CONTRACT NO.	
FED. ROAD DIST. NO. 6 ILLINOIS FED. AID PROJECT 93522					