

R 3 W, 3rd PM

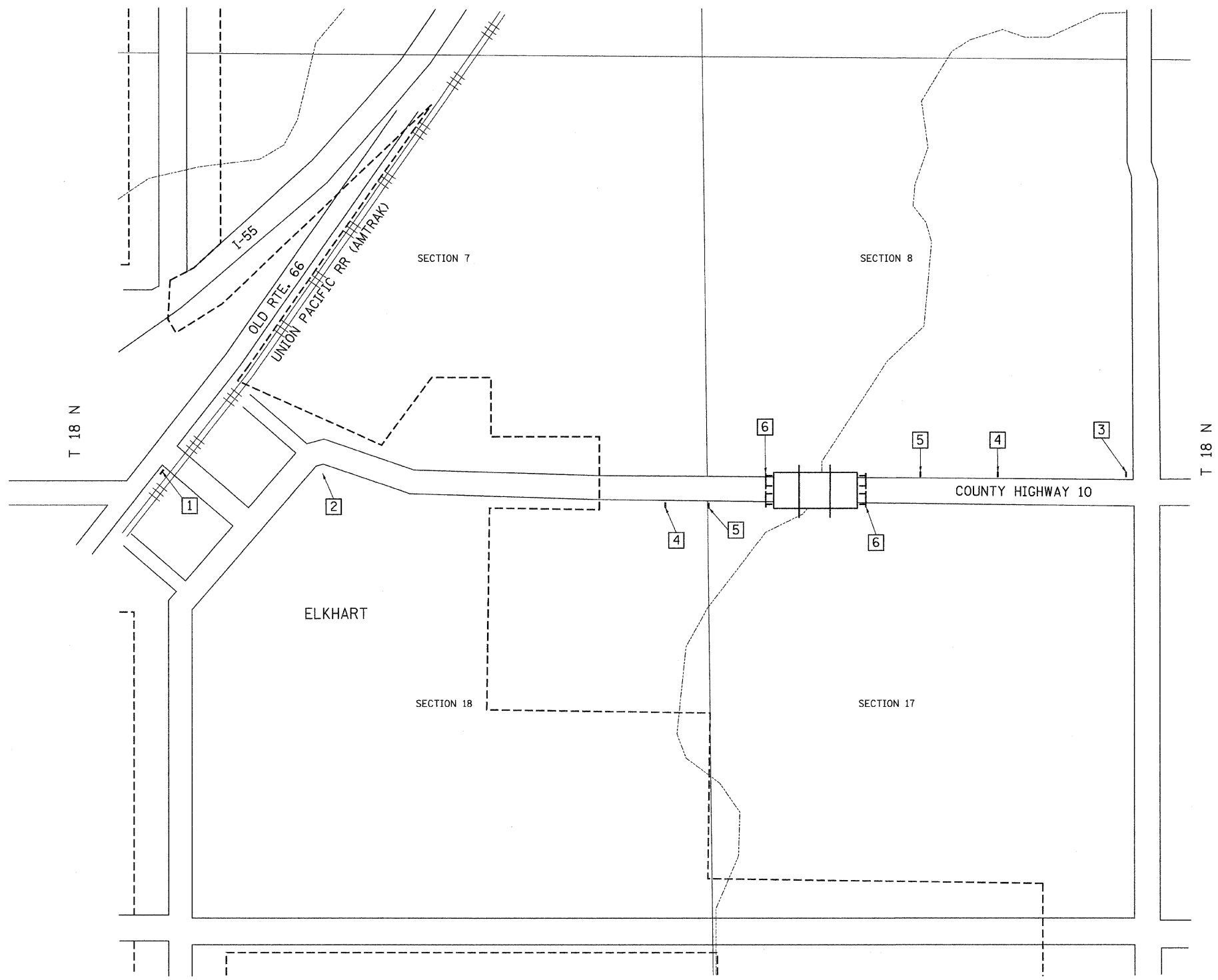

- 1

ROAD CLOSED
1 1/4 MILE AHEAD
LOCAL TRAFFIC ONLY
R11-3

ROAD CLOSED
1 1/4 MILE AHEAD
LOCAL TRAFFIC ONLY
R11-3
- 2

ROAD CLOSED
1 MILE AHEAD
LOCAL TRAFFIC ONLY
R11-3

ROAD CLOSED
1 MILE AHEAD
LOCAL TRAFFIC ONLY
R11-3
- 3

ROAD CLOSED
3/4 MILE AHEAD
LOCAL TRAFFIC ONLY
R11-3

ROAD CLOSED
3/4 MILES AHEAD
LOCAL TRAFFIC ONLY
R11-3
- 4

ROAD CLOSED
AHEAD
W20-3

ROAD CLOSED
AHEAD
W20-3
- 5

ROAD CLOSED
500 FT
W20-3

ROAD CLOSED
500 FT
W20-3
- 6

TYPE III BARRICADES

SEE STANDARD BLR 21
AND SPECIAL PROVISIONS

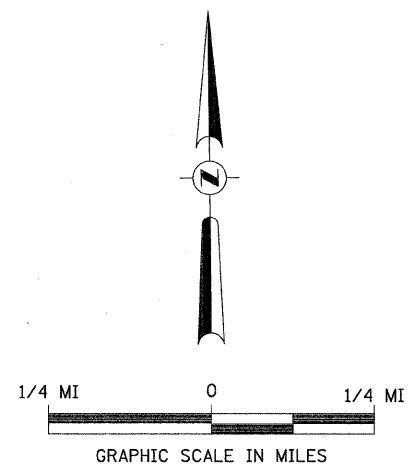

FILE NAME = V:\Bridges\2755-Logan\2755h\001.dgn	USER NAME = cthomas	DESIGNED -	REVISED -	LOGAN COUNTY			
		DRAWN -	REVISED -	COUNTY HIGHWAY 10 OVER	TRAFFIC CONTROL PLAN		
		CHECKED -	REVISED -	LAKE FORK CREEK TRIBUTARY	SCALE: NONE	SHEET NO. 1 OF 1 SHEETS	STA. 66+50.00 TO STA. 71+00.00
		DATE -	REVISED -				
					F.A.S. RTE. 566	SECTION 09-00119-00-BR	COUNTY LOGAN
					TOTAL SHEETS 17		SHEET NO. 4
					CONTRACT NO. 93525		
					FED. ROAD DIST. NO. 7 ILLINOIS FED. AID PROJECT BRS-0566107		