

DATE	
BY	
FINAL SURVEY	
NO. OF PLATS	
NOTE BOOK NO.	
AREAS CHECKED	

DATE	
BY	
ORIGINAL SURVEY	
NO. OF PLATS	
NOTE BOOK NO.	
AREAS CHECKED	

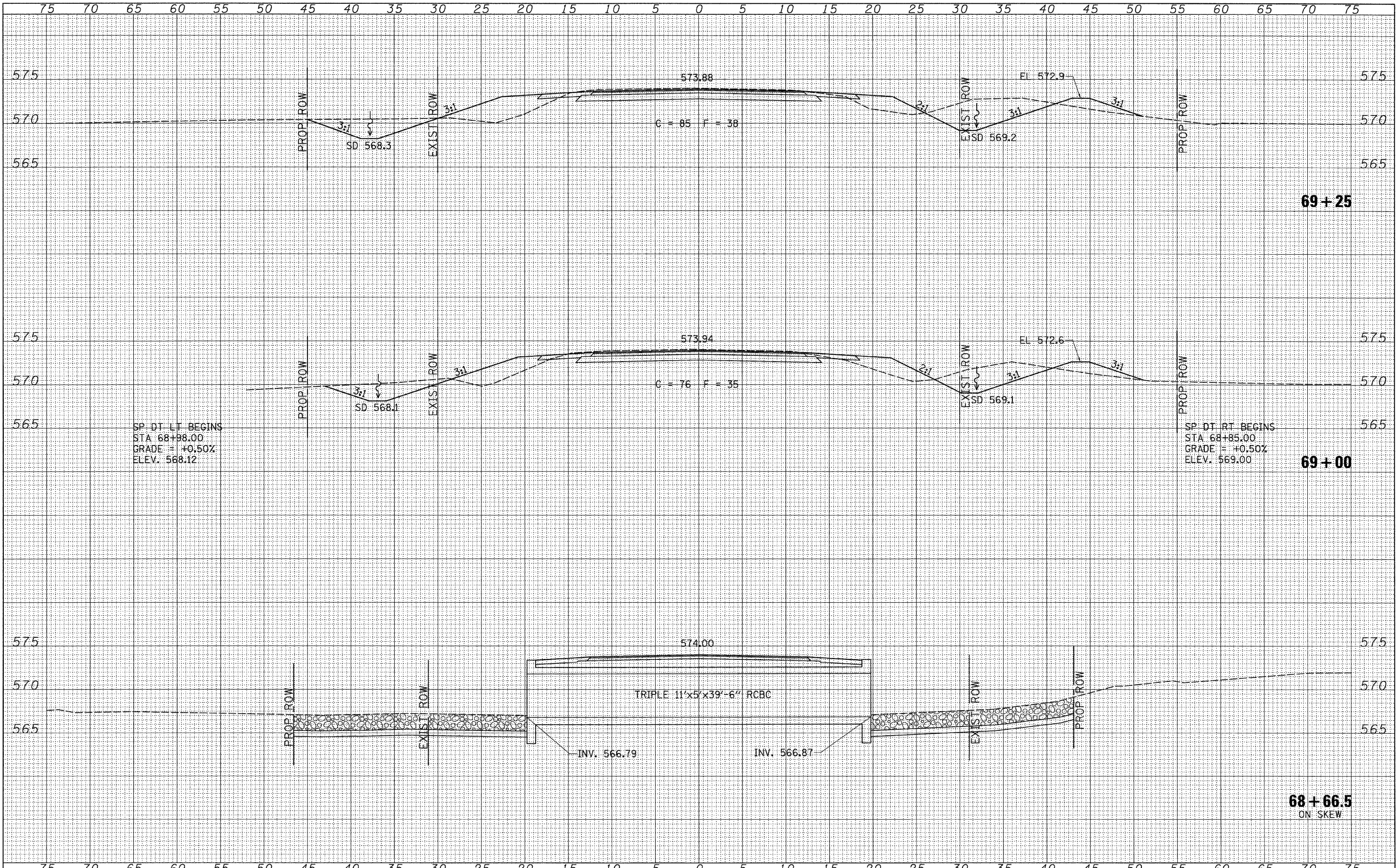

FILE NAME = V:\Bridge\2755-Logan\2755sheeta.dgn	USER NAME = othomas	DESIGNED -	REVISED -	<b>LOGAN COUNTY</b> <b>COUNTY HIGHWAY 10 OVER</b> <b>LAKE FORK CREEK TRIBUTARY</b>	<b>CROSS SECTIONS</b> SCALE: 1" = 5'-0" SHEET NO. 4 OF 7 SHEETS STA. 68+66.50 TO STA. 69+25.00	F.A.S. R.T.E. 566	SECTION 09-00119-00-BR	COUNTY LOGAN	TOTAL SHEETS 17	SHEET NO. 14
	PLOT SCALE = 5,0000' / IN.	CHECKED -	REVISED -			CONTRACT NO. 93525				
	PLOT DATE = 1/19/2010	DATE -	REVISED -			FED. ROAD DIST. NO. 7 ILLINOIS				
						FED. AID PROJECT BRS-0666(07)				