

DATE	
BY	
FINAL SURVEY	
NOTE BOOK	
NO.	
SURVEYED	
REVISIONS	
DATE	
AREAS CHECKED	

DATE	
BY	
ORIGINAL SURVEY	
NOTE BOOK	
NO.	
SURVEYED	
REVISIONS	
DATE	
AREAS CHECKED	

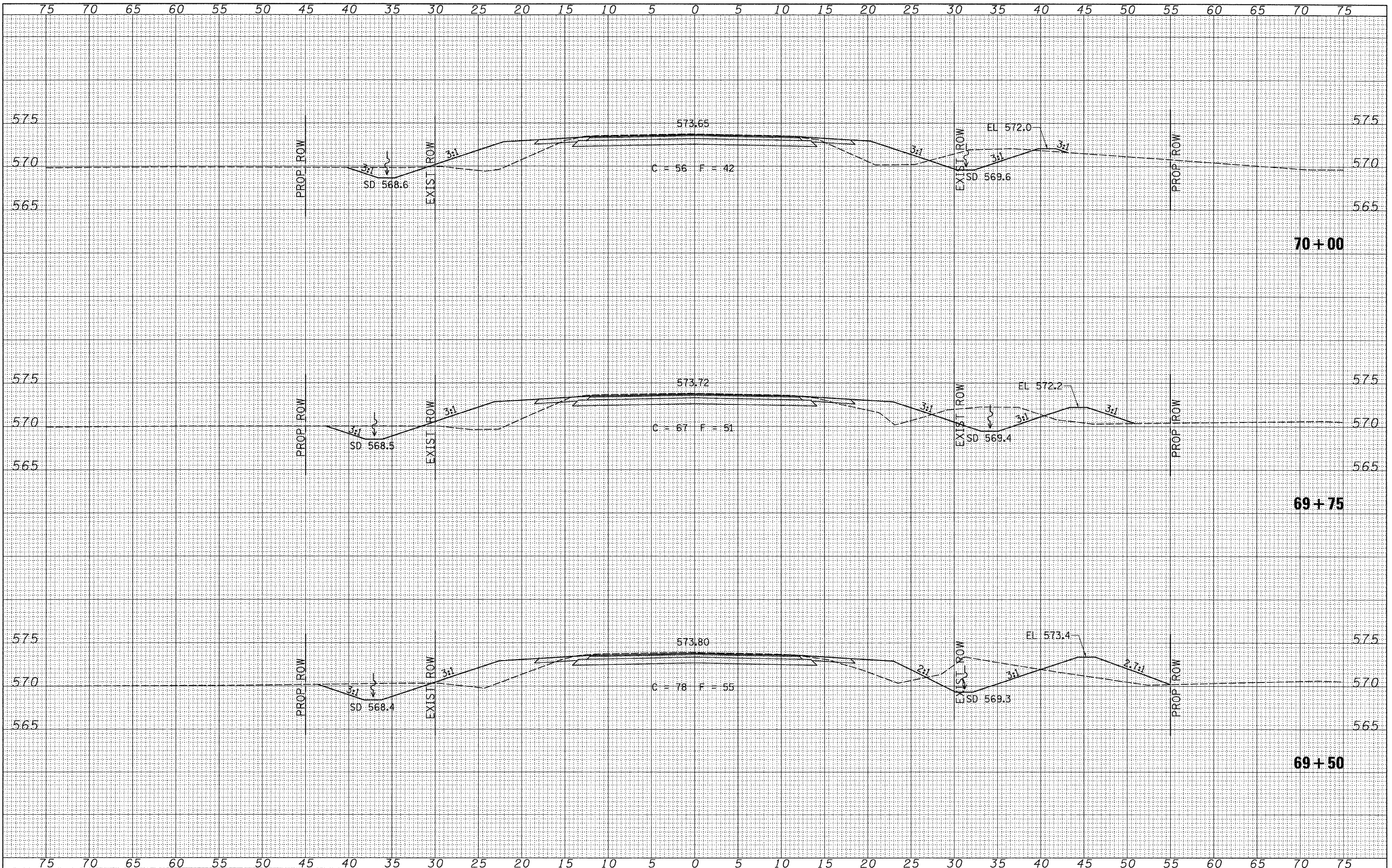

FILE NAME =	USER NAME = cthomas	DESIGNED -	REVISED -	LOGAN COUNTY COUNTY HIGHWAY 10 OVER LAKE FORK CREEK TRIBUTARY	CROSS SECTIONS		F.A.S. TOTAL	SECTION	COUNTY	TOTAL SHEETS	SHEET NO.
V:\Bridge\2755-Logan\2755sheeta.dgn		DRAWN -	REVISED -		566	09-00119-00-BR	LOGAN	17	15		
		CHECKED -	REVISED -		SCALE: 1" = 5'-0" SHEET NO. 5 OF 7 SHEETS STA. 69+50.00 TO STA. 70+00.00			CONTRACT NO. 93525			
		DATE -	REVISED -		FED. ROAD DIST. NO. 7 ILLINOIS		FED. AID PROJECT BR5-0566(107)				