

FINAL SURVEY	DATE
SURVEYED	BY
NOTE BOOK	
NO.	
TEMPLATE	
AREAS CHECKED	

ORIGINAL SURVEY	DATE
SURVEYED	BY
NOTE BOOK	
NO.	
TEMPLATE	
AREAS CHECKED	

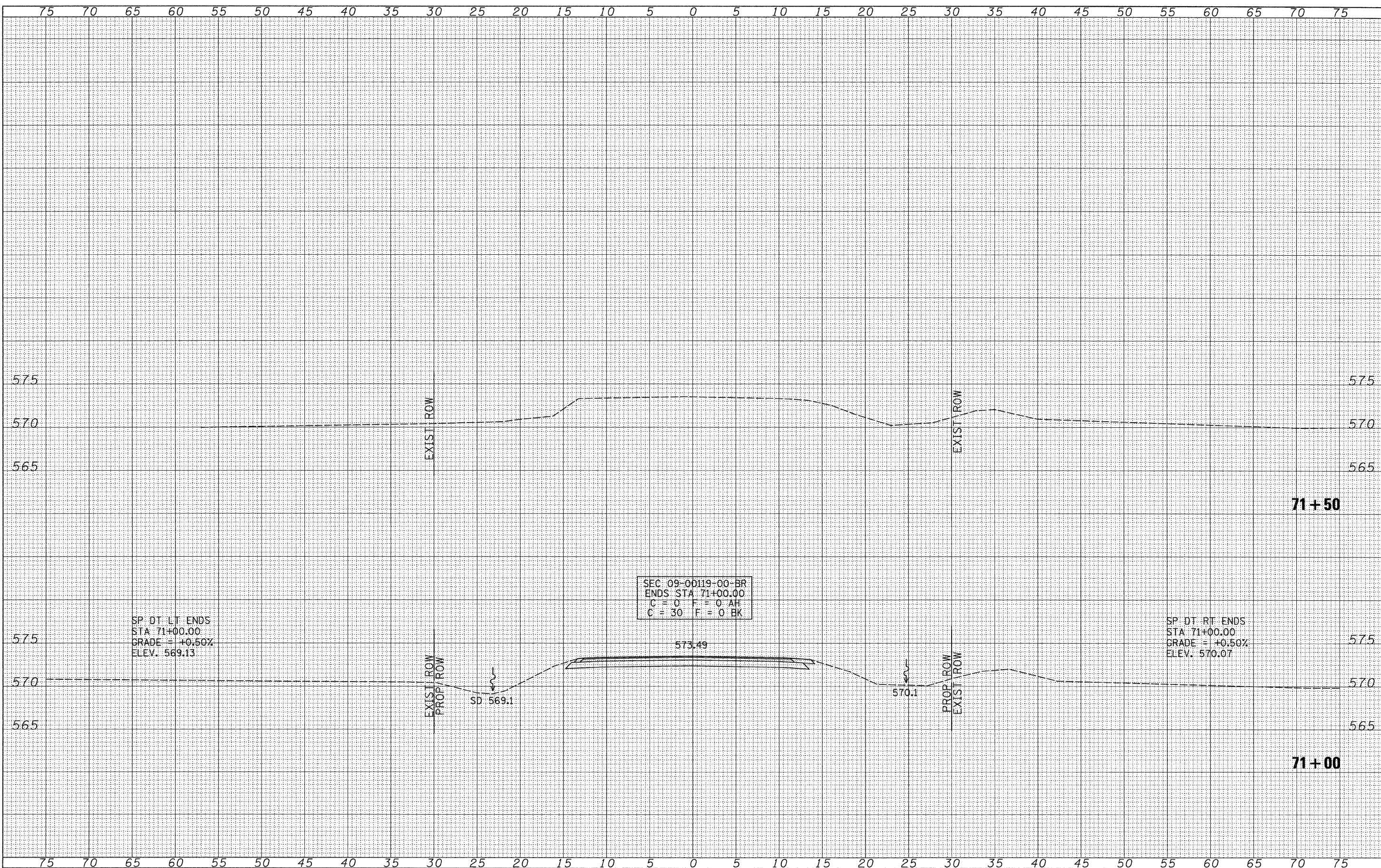

SP DT LT ENDS
 STA 71+00.00
 GRADE = +0.50%
 ELEV. 569.13

SEC 09-00119-00-BR
 ENDS STA 71+00.00
 C = 0 F = 0 AH
 C = 30 F = 0 BK

SP DT RT ENDS
 STA 71+00.00
 GRADE = +0.50%
 ELEV. 570.07

FILE NAME = V:\Brdge\2755-Logan\2755sheets.dgn	USER NAME = cthomas	DESIGNED -	REVISED -	LOGAN COUNTY COUNTY HIGHWAY 10 OVER LAKE FORK CREEK TRIBUTARY	CROSS SECTIONS			F.A.S. RTE. 566	SECTION 09-00119-00-BR	COUNTY LOGAN	TOTAL SHEETS 17	SHEET NO. 17
	PLOT SCALE = 5.0000' / IN.	DRAWN -	REVISED -		SCALE: 1" = 5'-0"	SHEET NO. 7 OF 7 SHEETS	STA. 71+00.00	TO STA. 71+50.00	CONTRACT NO. 93525			
	PLOT DATE = 1/19/2010	CHECKED -	REVISED -						FED. ROAD DIST. NO. 7 ILLINOIS		FED. AID PROJECT BRS-0566(107)	
		DATE -	REVISED -									