

**TRANSITION DETAIL**

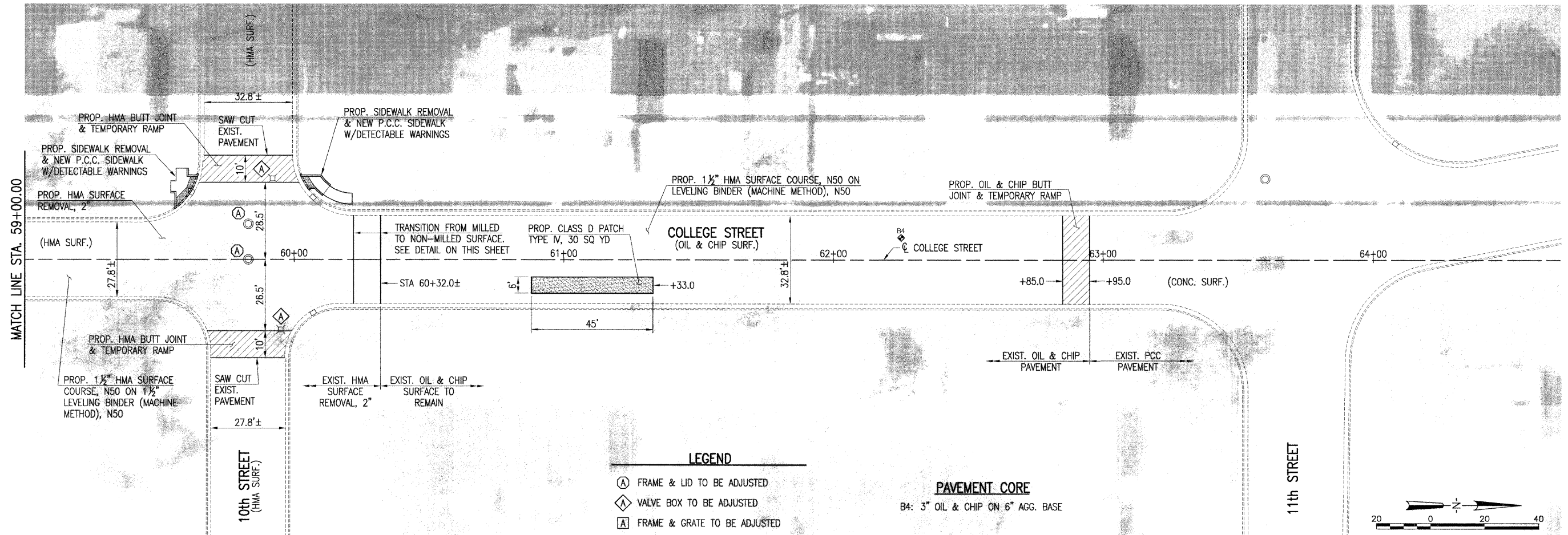

**LEGEND**

- (A) FRAME & LID TO BE ADJUSTED
- ◇ VALVE BOX TO BE ADJUSTED
- [A] FRAME & GRATE TO BE ADJUSTED

**PAVEMENT CORE**

B4: 3" OIL & CHIP ON 6" AGG. BASE

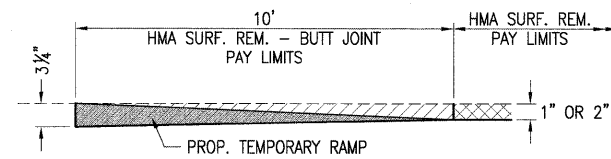
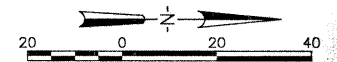

**HMA BUTT JOINT DETAIL**

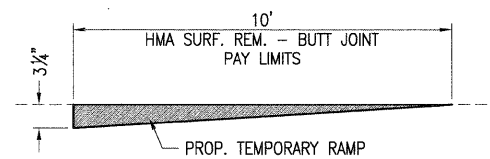

**OIL & CHIP BUTT JOINT DETAIL**

STA 62+85.0 TO STA 62+95.0 ONLY

JAN 28, 2010 11:58 PM  
 I:\09L0077\CADD\ROAD\SHEET\C-702001-COLL.DWG



DESIGNED	-	BJB	9/4/09	REVISED	-	LDK	11/04/09
DRAWN	-	BJB	9/4/09	REVISED	-		
CHECKED	-	LDK	10/20/09	REVISED	-		
DATE	-		2/01/2010	REVISED	-		

DESIGNED	-	BJB	9/4/09	REVISED	-	LDK	11/04/09
DRAWN	-	BJB	9/4/09	REVISED	-		
CHECKED	-	LDK	10/20/09	REVISED	-		
DATE	-		2/01/2010	REVISED	-		

DESIGNED	-	BJB	9/4/09	REVISED	-	LDK	11/04/09
DRAWN	-	BJB	9/4/09	REVISED	-		
CHECKED	-	LDK	10/20/09	REVISED	-		
DATE	-		2/01/2010	REVISED	-		

STATE OF ILLINOIS  
DEPARTMENT OF TRANSPORTATION

PLAN SHEET - COLLEGE STREET  
CITY OF LINCOLN  
LOGAN COUNTY, ILLINOIS

F.A.U. RTE.	SECTION	COUNTY	TOTAL SHEETS	SHEET NO.
7718	09-00094-00-RS	LOGAN	10	7
CONTRACT NO.			93526	
FED. ROAD DIST. NO.		ILLINOIS	FED. AID PROJECT	