

STATE OF ILLINOIS  
 DEPARTMENT OF TRANSPORTATION  
 DIVISION OF HIGHWAYS  
**CITY OF LINCOLN, LOGAN COUNTY**  
**FAU 7716 (COLLEGE STREET)**  
**FAU 7718 (STATE STREET)**  
 AMERICAN RECOVERY AND REINVESTMENT ACT  
 SECTION 09-00094-00-RS  
 LOCAL AGENCY PAVEMENT PRESERVATION

PROJECT NO. ARA-5038 (013)  
 JOB NO. C-96-256-10

- INDEX OF SHEETS**
- 1 COVER SHEET
  - 2 SUMMARY OF QUANTITIES & GENERAL NOTES
  - 3-4 TYPICAL SECTIONS
  - 5 SCHEDULE OF QUANTITIES
  - 6-7 PLAN SHEET - COLLEGE STREET
  - 8-10 PLAN SHEET - STATE STREET

- IDOT HIGHWAY STANDARDS**
- 000001-05 STANDARD SYMBOLS, ABBREVIATIONS AND PATTERNS
  - 420001-07 PAVEMENT JOINTS
  - 424001-05 CURB RAMPS FOR SIDEWALKS
  - 442201-03 CLASS C AND D PATCHES
  - 606001-04 CONCRETE CURB TYPE B AND COMBINATION CONCRETE CURB AND GUTTER
  - 701301-03 LANE CLOSURE, 2L, 2W, SHORT TIME OPERATIONS
  - 701501-05 URBAN LANE CLOSURE, 2L, 2W, UNDIVIDED
  - 701801-04 LANE CLOSURE MULTILANE 1W OR 2W CROSSWALK OR SIDEWALK CLOSURE
  - 701901-01 TRAFFIC CONTROL DEVICES
  - 780001-02 TYPICAL PAVEMENT MARKINGS



Know what's below.  
 Call before you dig.

**TOLL FREE**  
 JOINT UTILITY LOCATING INFORMATION FOR EXCAVATORS  
 (J.U.L.I.E.) TELEPHONE NUMBER  
 CALL 811 OR 1-800-892-0123

- |  |  |
|--|--|
| COMCAST<br>1102 KEOKUK STREET<br>LINCOLN, IL 62656<br>ROBERT DAVIS (217)424-4232                       | CITY OF LINCOLN<br>700 BROADWAY STREET<br>LINCOLN, IL 62656<br>MARK MATHON (217)732-7544           |
| AMEREN/CILCO<br>400 LIMIT STREET<br>LINCOLN, IL 62656<br>CHARLOTTE WALSCHLEGER (217)735-6909           | ILLINOIS AMERICAN WATER<br>1100 KEOKUK STREET<br>LINCOLN, IL 62656<br>DAVE SCHONAUER (217)735-1269 |
| VERIZON NORTH, INC.<br>110 E. MONROE STREET<br>BLOOMINGTON, IL 61702<br>MARY RUTH WILLIS (309)827-1617 | MCI<br>DEAN BOYERS (972)729-6322   |

**UTILITY NOTE**

THE LOCATIONS OF THOSE BURIED AND ABOVEGROUND UTILITIES SHOWN ARE APPROXIMATE, ARE SHOWN FOR CONTRACTOR INFORMATIONAL USE ONLY, AND ARE NOT TO BE REFERENCED FOR CONSTRUCTION PURPOSES. THE IMPLIED PRESENCE OR ABSENCE OF UTILITIES IS NOT TO BE CONSTRUED BY THE OWNER, ENGINEER, CONTRACTOR, OR SUBCONTRACTORS TO BE AN ACCURATE AND COMPLETE REPRESENTATION OF UTILITIES THAT MAY OR MAY NOT EXIST ON THE CONSTRUCTION SITE. BURIED AND ABOVEGROUND UTILITY LOCATION, IDENTIFICATION, AND MARKING ARE THE SOLE RESPONSIBILITY OF THE CONTRACTOR. REROUTING, DISCONNECTION, PROTECTION, ETC. OF ANY UTILITIES MUST BE COORDINATED BETWEEN THE CONTRACTOR, UTILITY COMPANY, AND OWNER. SITE SAFETY, INCLUDING THE AVOIDANCE OF HAZARDS ASSOCIATED WITH BURIED AND ABOVEGROUND UTILITIES, REMAIN THE SOLE RESPONSIBILITY OF THE CONTRACTOR.

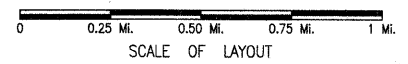
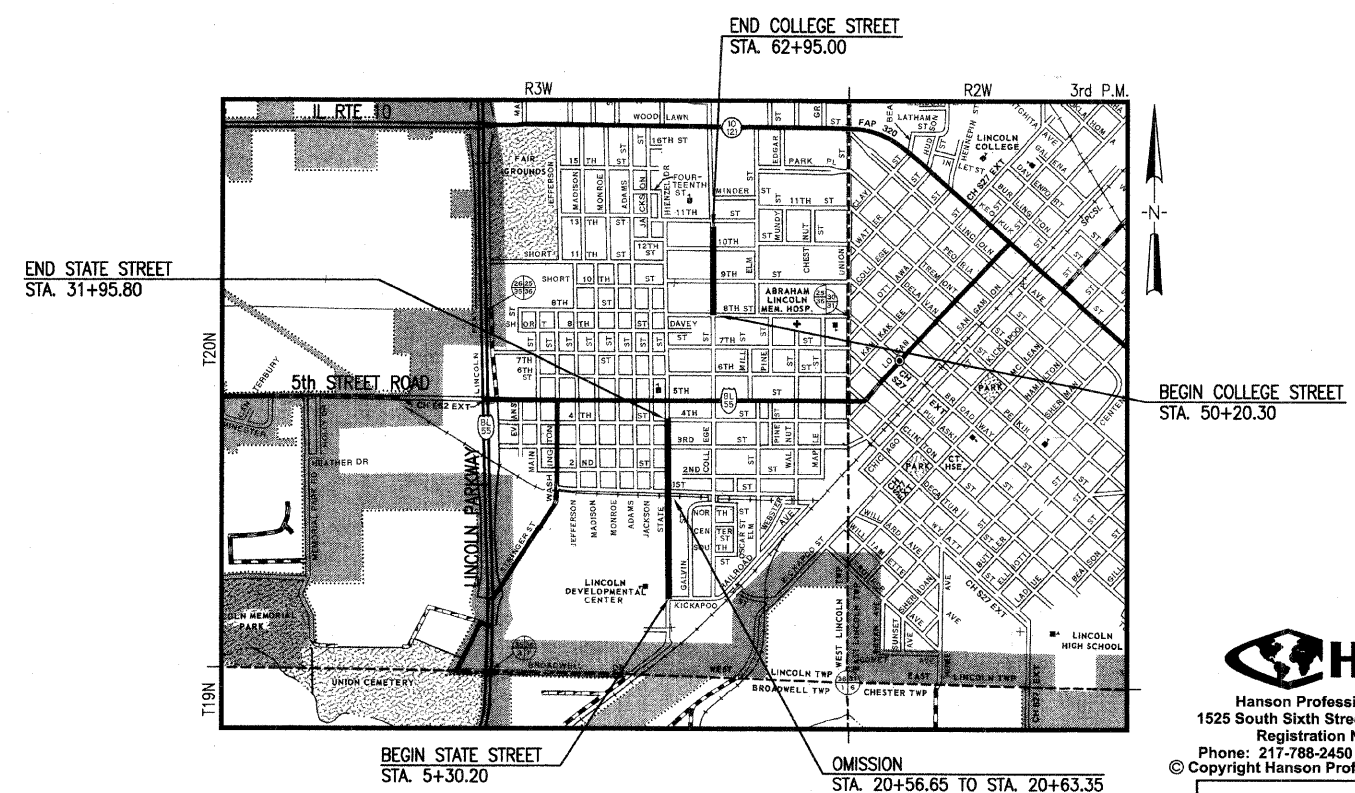
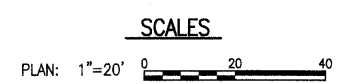

NET LENGTH OF PROJECT: COLLEGE STREET = 1,274.70 ft = 0.241 mi  
 STATE STREET = 2,658.90 ft = 0.504 mi  
 TOTAL = 3,933.60 ft = 0.745 mi

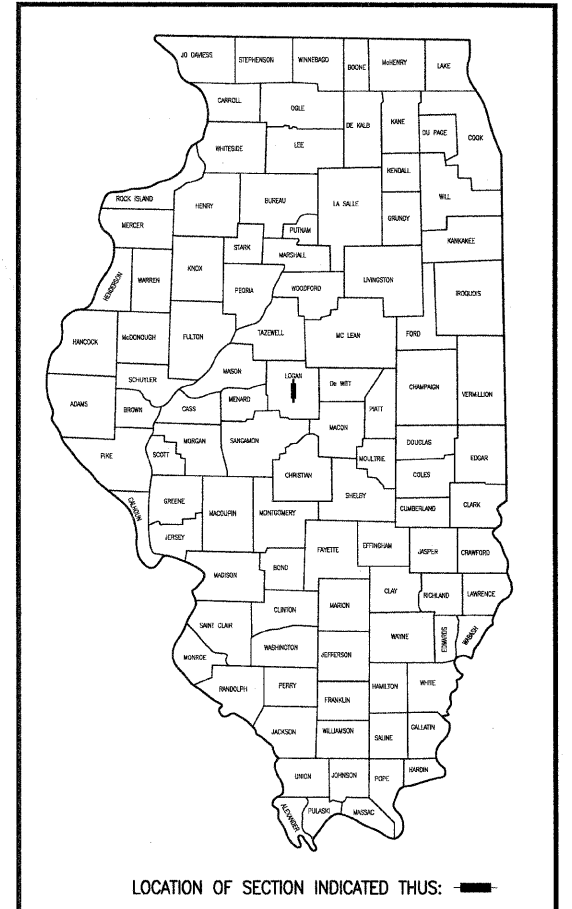

**HANSON**  
 Hanson Professional Services Inc.  
 1525 South Sixth Street, Springfield, IL 62703  
 Registration No. 184-001084  
 Phone: 217-788-2450 Fax: 217-788-2503  
 Copyright Hanson Professional Services Inc. 2010

62-52150  
 LICENSED  
 PROFESSIONAL  
 ENGINEER  
 STATE OF  
 ILLINOIS  
 SPRINGFIELD, ILL.

DATE SIGNED: 2/8/2010  
 LIC. EXP. DATE: 11/30/2011

APPROVED: [Signature] 2/5, 2010  
 MAYOR

PASSED: [Signature] 2-11, 2010  
 DISTRICT 6 ENGINEER OF LOCAL ROADS & STREETS

PASSED: [Signature] 2-11, 2010  
 DISTRICT 6 ENGINEER OF CONSTRUCTION

RELEASING FOR BID  
 BASED ON LIMITED  
 REVIEW

[Signature] 2-11, 2010  
 DEPT. DIRECTOR OF HIGHWAYS, REGION 4 ENGINEER  
 STATE OF ILLINOIS  
 DEPARTMENT OF TRANSPORTATION

2/01/2010

JAN 29, 2010 1:48 PM  
 P:\09\095\091\0077\CADD\ROAD\ROAD\SHEET\C-001\00V.DWG

COLLEGE STREET: URBAN COLLECTOR  
 ADT = 3,750

STATE STREET: URBAN COLLECTOR  
 ADT = 750

CONTRACT No. 93526





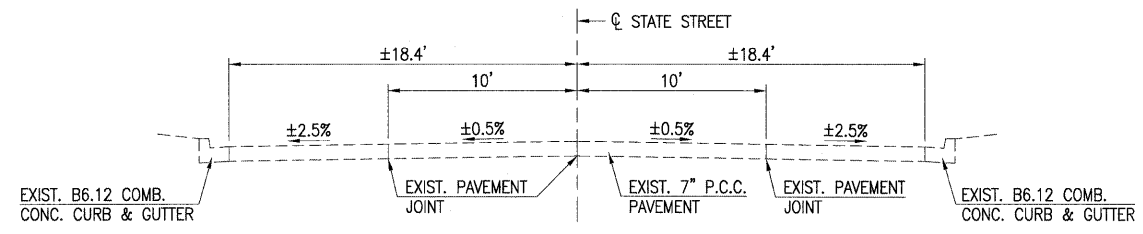

NOTE:  
EXISTING P.C.C. PAVEMENT CONTAINS 2'-6" LONG, 1/2" DIA. BARS AT ALL JOINTS AS WELL AS METAL LONGITUDINAL, TRANSVERSE, EXPANSION & CONTRACTION JOINTS.

STATE STREET  
EXISTING TYPICAL SECTION  
STA. 5+30.20 TO STA. 31+34.90

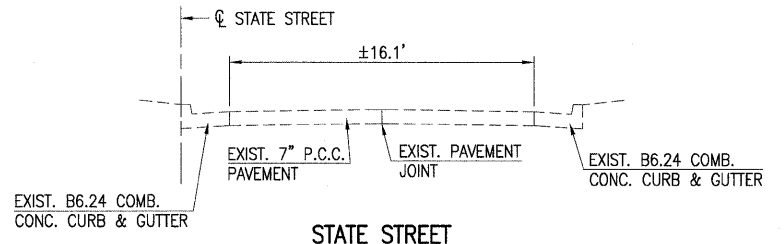

STATE STREET  
EXISTING TYPICAL SECTION  
STA. 31+34.90 TO STA. 31+53.20

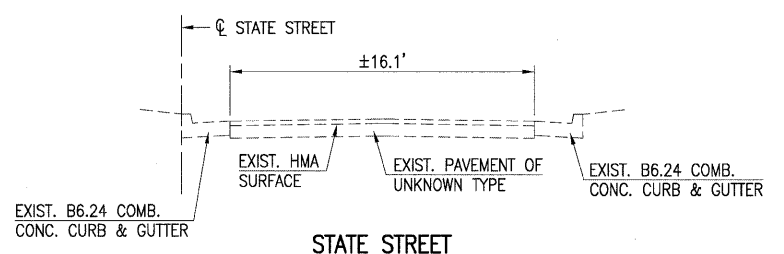

STATE STREET  
EXISTING TYPICAL SECTION  
STA. 31+53.20 TO STA. 31+95.80

ORIGINAL CONSTRUCTION SECTION: 4 C-S

**HOT-MIX ASPHALT MIXTURE REQUIREMENTS**

MIXTURE USE	SURFACE LIFT ①	LEVELING BINDER ②
AC/PG	PG 64-22	PG 64-22
DESIGN AIR VOIDS	4% @ N50	4% @ N50
MIXTURE COMPOSITION (GRADATION MIXTURE)	IL-12.5 OR IL-9.5	IL-9.5
FRICITION AGGREGATE	MIX "C"	N/A

- NOTES:
- MAX WEIGHT = 112 lbs/sq yd/in
  - BITUMINOUS PRIME/RC70 (FOG COAT) REQUIRED BETWEEN EACH LIFT.

**NOTES**

- THE NOMINAL COMPACTED THICKNESS OF BITUMINOUS CONCRETE PAVEMENT IS SHOWN IN THE TYPICAL SECTION. THE CONSTRUCTED THICKNESS SHALL NOT BE LESS THAN 90 PERCENT OF THE NOMINAL THICKNESS AT ANY LOCATION.
- THE PRIME COAT APPLICATION RATE SHALL BE 0.05 TO 0.10 GALLONS PER SQUARE YARD ON EXISTING PAVED SURFACES AND 0.02 GALLONS PER SQUARE YARD (FOG/TACK COAT) ON EACH SUCCESSIVE LIFT HOT-MIX ASPHALT. THE PRIME COAT SHALL BE PAID FOR AT THE UNIT PRICE BID FOR 'BITUMINOUS MATERIALS (PRIME COAT).'
- LEVELING BINDER (HAND METHOD) SHALL BE PLACED IN SPALLED AREAS OR DEPRESSIONS EXCEEDING 1 INCH IN DEPTH AFTER LOOSE PATCH MATERIAL HAS BEEN REMOVED AND THE PAVEMENT HAS BEEN CLEANED OF ALL DEBRIS.
- PERMANENT AND SHORT-TERM CROSS WALK AND STOP BAR PAVEMENT MARKINGS "BY OTHERS."

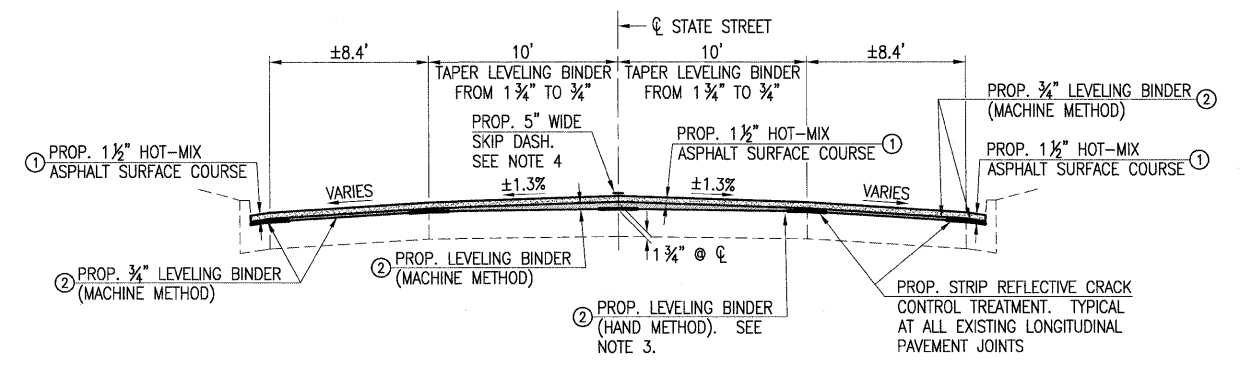

STATE STREET  
PROPOSED TYPICAL SECTION  
STA. 5+30.20 TO STA. 31+53.20

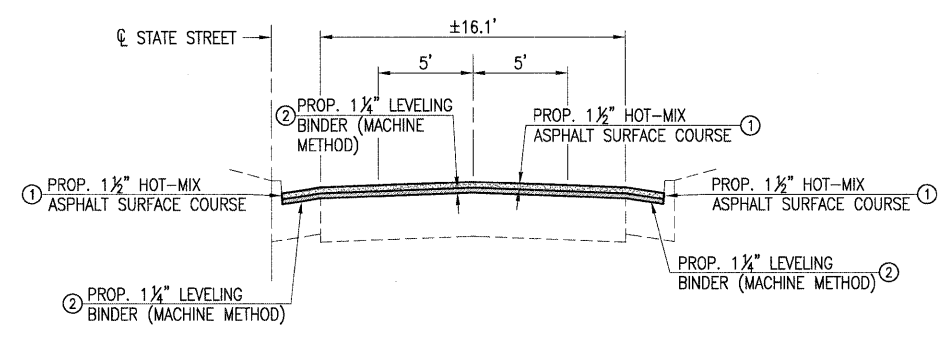

STATE STREET  
PROPOSED TYPICAL SECTION  
STA. 31+53.20 TO STA. 31+95.80

JAN 29, 2010 1:50 PM I:\09\095\0910077\CADD\ROAD\SHR1\0-C-502TYP.DWG



DESIGNED	-	BJB	9/4/09	REVISED	-	LDK	11/04/09
DRAWN	-	BJB	9/4/09	REVISED	-		
CHECKED	-	LDK	10/20/09	REVISED	-		
DATE	-		2/01/2010	REVISED	-		

STATE OF ILLINOIS  
DEPARTMENT OF TRANSPORTATION

TYPICAL SECTIONS - STATE STREET		SCALE:	
CITY OF LINCOLN		PAGE 2 OF 2	
LOGAN COUNTY, ILLINOIS		STA. TO STA.	

F.A.U. RT.:	SECTION	COUNTY	TOTAL SHEETS	SHEET NO.
7718	09-00094-00-RS	LOGAN	10	4
CONTRACT NO.			93526	
FED. ROAD DIST. NO. ILLINOIS FED. AID PROJECT				

HOT-MIX ASPHALT SURFACE REMOVAL - BUTT JOINT		
LOCATION		SQ. YD.
COLLEGE STREET		
50+20.3 TO 50+30.3, CL		67
50+28.5 TO 50+58.1, LT		32
50+28.5 TO 50+58.5, RT		32
54+97.8 TO 55+36.6, LT		40
54+97.5 TO 55+36.3, RT		39
59+64.6 TO 60+01.8, LT		38
59+67.8 TO 59+99.1, RT		32
62+85.0 TO 62+95.0, CL		36
STATE STREET		
5+42.2 TO 6+12.0, LT		59
31+85.8 TO 31+95.8, RT		18
<b>TOTAL</b>		<b>393</b>

PORTLAND CEMENT CONCRETE SURFACE REMOVAL - BUTT JOINT		
LOCATION		SQ. YD.
STATE STREET		
5+30.2 TO 5+40.2, CL		41
5+54.7 TO 5+85.6, RT		31
12+06.3 TO 12+79.7, LT		58
20+46.6 TO 20+56.6, CL		41
20+63.3 TO 20+73.3, CL		42
20+87.1 TO 21+28.3, LT		41
20+83.6 TO 21+13.2, RT		29
24+27.1 TO 24+53.9, LT		27
27+62.6 TO 27+95.4, LT		33
27+67.4 TO 28+04.4, RT		37
31+04.5 TO 31+34.9, LT		31
31+19.6 TO 31+80.7, RT		66
31+85.8 TO 31+95.8, RT		1
<b>TOTAL</b>		<b>478</b>

TEMPORARY RAMP		
LOCATION		SQ YD
COLLEGE STREET		
50+20.3 TO 50+30.3, CL		67
50+28.5 TO 50+58.1, LT		32
50+28.5 TO 50+58.5, RT		32
54+97.8 TO 55+36.6, LT		40
54+97.5 TO 55+36.3, RT		39
59+64.6 TO 60+01.8, LT		38
59+67.8 TO 59+99.1, RT		32
60+22.0 TO 60+32.0, CL		36
62+85.0 TO 62+95.0, CL		36
STATE STREET		
5+30.2 TO 5+40.2, CL		41
5+42.2 TO 6+12.0, LT		59
5+54.7 TO 5+85.6, RT		31
12+06.3 TO 12+79.7, LT		58
20+46.6 TO 20+56.6, CL		41
20+63.3 TO 20+73.3, CL		42
20+87.1 TO 21+28.3, LT		41
20+83.6 TO 21+13.2, RT		29
24+27.1 TO 24+53.9, LT		27
27+62.6 TO 27+95.4, LT		33
27+67.4 TO 28+04.4, RT		37
31+04.5 TO 31+34.9, LT		31
31+19.6 TO 31+80.7, RT		66
31+85.8 TO 31+95.8, RT		1
31+85.8 TO 31+95.8, RT		18
<b>TOTAL</b>		<b>907</b>

SAW CUTS		
LOCATION		FOOT
COLLEGE STREET		
50+20.3, CL		49
50+29.9 TO 50+58.1, LT		28
50+29.8 TO 50+58.2, RT		28
55+00.0 TO 55+34.2, LT		34
55+00.1 TO 55+33.9, RT		34
59+66.6 TO 59+99.4, LT		33
59+69.1 TO 59+96.4, RT		27
STATE STREET		
5+30.2, CL		35
5+48.6 TO 5+89.4, LT		41
5+56.6 TO 5+82.5, RT		26
12+23.7 TO 12+62.3, LT		39
20+88.5 TO 21+10.4, RT		22
20+93.5 TO 21+19.9, LT		26
24+29.8 TO 24+52.2, LT		22
27+65.1 TO 27+92.9, LT		28
27+70.1 TO 28+01.9, RT		32
31+08.6 TO 31+34.9, LT		26
31+21.2 TO 31+79.2, RT		58
31+95.8, RT		16
<b>TOTAL</b>		<b>604</b>

VALVE BOXES TO BE ADJUSTED		
LOCATION		EACH
COLLEGE STREET		
50+56.0, 34.8' LT	1	
50+74.6, 14.2' RT	1	
55+00.0, 13.0' RT	1	
55+03.0, 29.0' RT	1	
55+25.0, 29.3' LT	1	
55+25.0, 32.0' RT	1	
59+92.0, 30.0' LT	1	
59+95.0, 26.0' RT	1	
STATE STREET		
5+34.0, 1.0' RT	1	
6+33.0, 3.0' RT	1	
11+92.0, 11.5' RT	1	
12+00.0, 9.0' RT	1	
16+45.0, 8.5' RT	1	
21+15.0, 8.5' RT	1	
21+30.0, 10.0' RT	1	
27+95.0, 5.0' RT	1	
28+25.0, 8.0' RT	1	
31+27.0, 4.0' LT	1	
<b>TOTAL</b>		<b>18</b>

FRAMES AND GRATES TO BE ADJUSTED		
LOCATION		EACH
COLLEGE STREET		
53+37.0, LT	1	
STATE STREET		
9+37.1, RT	1	
9+40.0, LT	1	
12+65.0, RT	1	
20+19.0, LT	1	
20+19.0, RT	1	
20+50.0, LT	1	
20+50.0, RT	1	
21+17.8, RT	1	
21+28.0, LT	1	
27+95.5, LT	1	
31+02.0, RT	1	
31+02.7, LT	1	
31+36.0, LT	1	
31+80.6, RT	1	
<b>TOTAL</b>		<b>15</b>

FRAMES & LIDS TO BE ADJUSTED		
LOCATION		EACH
COLLEGE STREET		
50+35.0, 28.0' LT	1	
50+38.0, 2.0' LT	1	
52+91.0, CL	1	
55+17.0, CL	1	
56+90.0, 2.0' RT	1	
59+83.0, CL	1	
59+83.0, 13.2' LT	1	
STATE STREET		
12+81.0, 11.0' RT	1	
21+30.0, 8.0' RT	1	
24+55.0, 4.0' RT	1	
27+98.0, 24.0' RT	1	
30+13.0, 9.0' RT	1	
31+37.0, 15.0' RT	1	
31+74.8, 37.5' RT	1	
<b>TOTAL</b>		<b>14</b>

PAVING SCHEDULE				
LOCATION	PRIME COAT	LEVELING BINDER (HAND METHOD)	LEVELING BINDER (MACHINE METHOD)	HMA SURFACE COURSE
	GALLON	TON	TON	TON
COLLEGE STREET	597	0	425	417
STATE STREET	1472	14	682	1031
<b>TOTALS</b>	<b>2069</b>	<b>14</b>	<b>1107</b>	<b>1448</b>

CLASS C PATCHES, 7 INCH				
LOCATION	TYPE			SQ YD
	II	III	IV	
STATE STREET				
6+02.5 TO 6+09.5, RT	8			
6+05.5 TO 6+12.5, LT	8			
9+04.5 TO 9+11.5, LT	8			
11+79.0 TO 11+95.0, LT		18		
19+67.0 TO 19+75.0, LT	9			
19+96.1 TO 20+06.1, LT	11			
21+00.0 TO 21+08.0, LT			15	
21+00.0 TO 21+09.0, CL			20	
21+75.0 TO 21+88.0, RT	14			
26+85.0 TO 27+10.0, CL				56
<b>TOTALS</b>	<b>58</b>	<b>53</b>	<b>56</b>	

CLASS D PATCHES TYPE IV, 8 INCH	
LOCATION	SQ YD
COLLEGE STREET	
60+88.0 TO 61+33.0, RT	30
<b>TOTAL</b>	<b>30</b>

P.C.C. SIDEWALK			
LOCATION	P.C.C. SIDEWALK, 4 INCH	DETECTABLE WARNINGS	SIDEWALK REMOVAL
	SQ. FT.	SQ. FT.	SQ. FT.
COLLEGE STREET			
50+19.8, RT	45	11	34
50+20.8, LT	48	12	36
50+74.3, LT	36	9	27
54+95.2, RT	74	21	60
59+60.2, LT	85	21	71
60+10.8, LT	90	9	47
STATE STREET			
12+23.8, LT	41	10	31
12+63.0, LT	41	10	31
20+84.3, LT	31	8	25
24+23.9, LT	33	9	25
27+98.6, LT	35	8	26
28+11.6, LT	35	8	26
31+05.5, RT	34	9	26
31+15.1, RT	34	8	25
<b>TOTALS</b>	<b>662</b>	<b>153</b>	<b>490</b>

COMBINATION CONCRETE CURB & GUTTER REMOVAL & REPLACEMENT		
LOCATION		FOOT
COLLEGE STREET		
53+37.0, LT	5	
STATE STREET		
9+37.1, RT	5	
9+40.0, LT	5	
12+65.0, RT	5	
20+19.0, LT	5	
20+19.0, RT	5	
20+50.0, LT	5	
20+50.0, RT	5	
21+17.8, RT	5	
21+28.0, LT	5	
27+95.5, LT	5	
31+02.0, RT	5	
31+02.7, LT	5	
31+36.0, LT	5	
31+80.6, RT	5	
<b>TOTAL</b>		<b>75</b>

PAVEMENT MARKING				
LOCATION	SHORT-TERM PAVEMENT MARKING	WORK ZONE PAVEMENT MARKING REMOVAL	PAINT PAVEMENT MARKING - LINE 5"	FOOT
	FOOT	SQ FT	FOOT	
COLLEGE STREET	300	125	300	
STATE STREET	610	254	610	
<b>TOTALS</b>	<b>910</b>	<b>379</b>	<b>910</b>	

JAN 29, 2010 1:51 PM  
I:\09\095\09L0077\CADDY\ROAD\SHHEET\C-601SCH.DWG



DESIGNED - BJB 9/4/09	REVISED - LDK 11/04/09
DRAWN - BJB 9/4/09	REVISED -
CHECKED - LDK 10/20/09	REVISED -
DATE - 2/01/2010	REVISED -

DESIGNED - BJB 9/4/09	REVISED - LDK 11/04/09
DRAWN - BJB 9/4/09	REVISED -
CHECKED - LDK 10/20/09	REVISED -
DATE - 2/01/2010	REVISED -

STATE OF ILLINOIS  
DEPARTMENT OF TRANSPORTATION

SCHEDULE OF QUANTITIES  
CITY OF LINCOLN  
LOGAN COUNTY, ILLINOIS

SCALE: PAGE 1 OF 1 STA. TO STA.

F.A.U. RFE. 7718	SECTION 09-00094-00-RS	COUNTY LOGAN	TOTAL SHEETS 10	SHEET NO. 5
CONTRACT NO. 93526				
FED. ROAD DIST. NO. ILLINOIS FED. AID PROJECT				

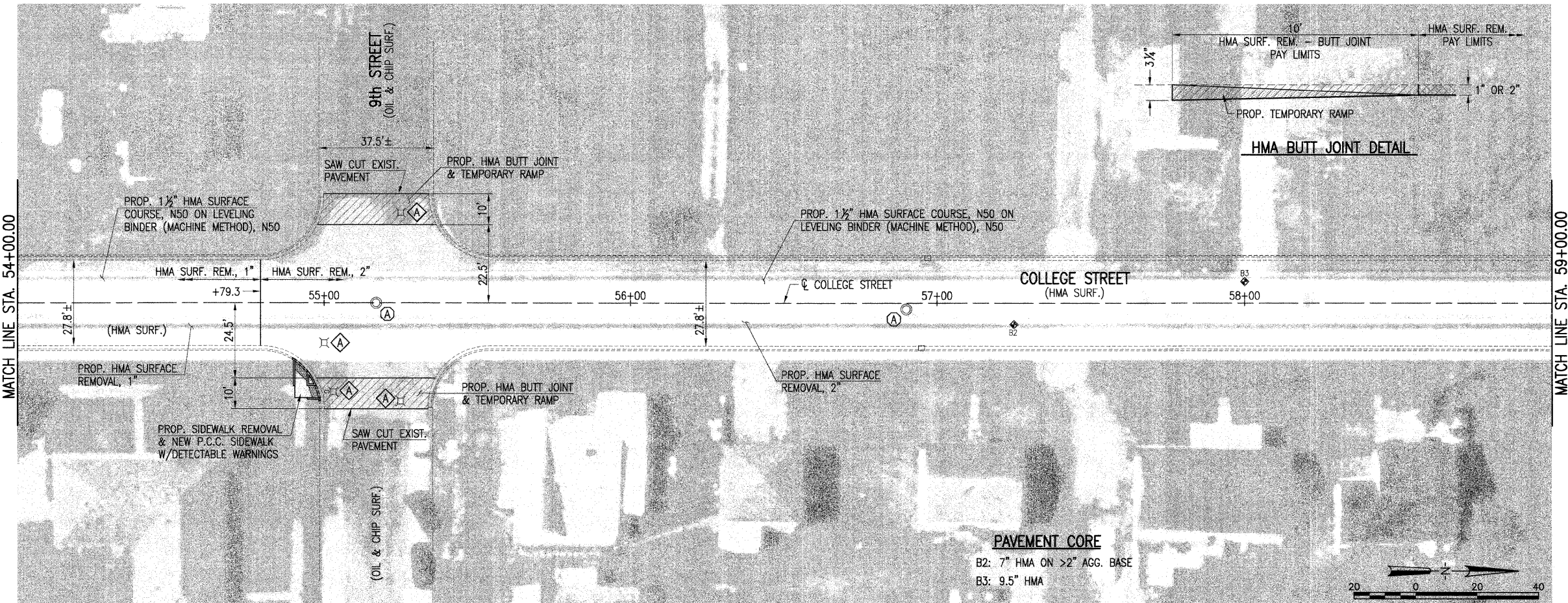
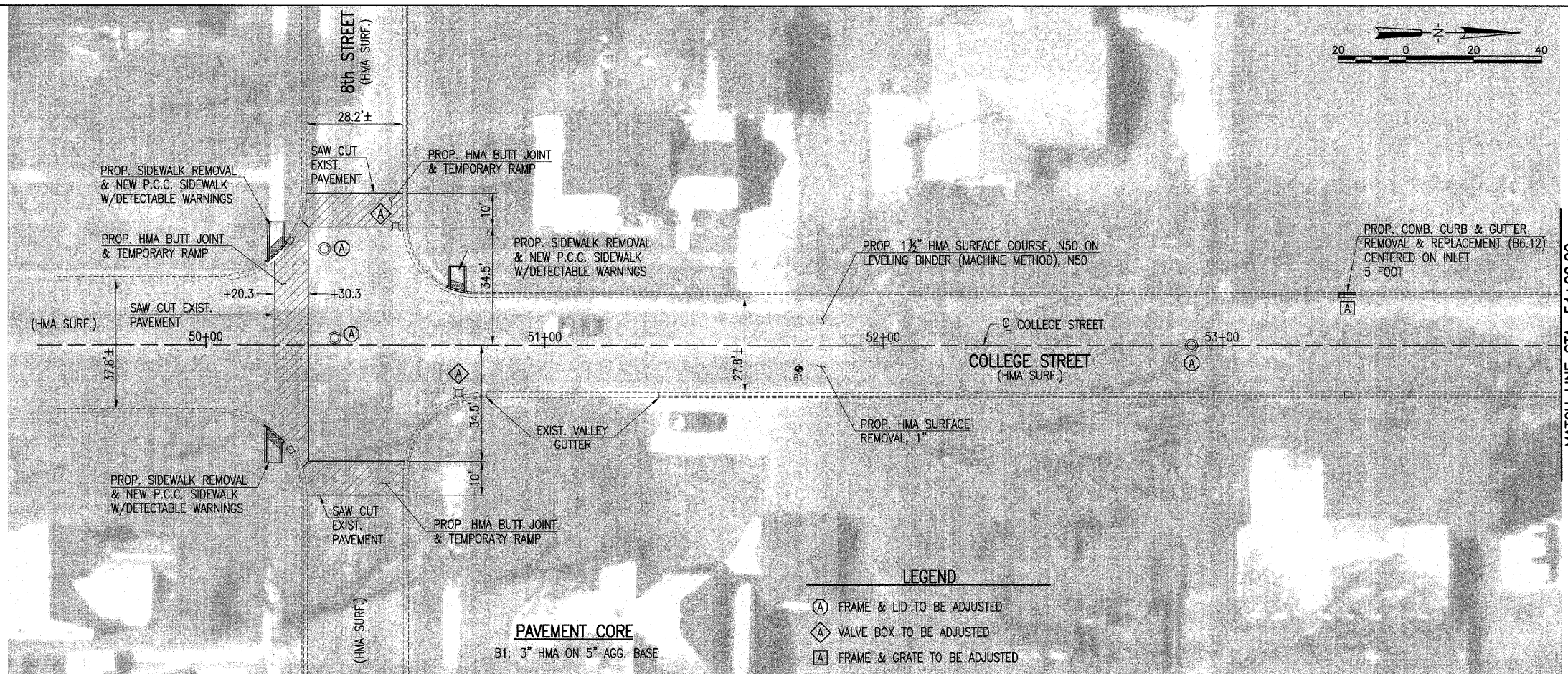

JAN 29, 2010 1:55 PM  
 I:\09\0905\09\0077\CADDY\ROAD\ROAD\SHEET\G-70\001-COLL.DWG

**HANSON**  
 Hanson Professional Services Inc.  
 1525 South Sixth Street, Springfield, IL 62703  
 Registration No. 184-001084  
 © Copyright Hanson Professional Services Inc. 2010

DESIGNED	-	BJB	9/4/09	REVISED	-	LDK	11/04/09
DRAWN	-	BJB	9/4/09	REVISED	-		
CHECKED	-	LDK	10/20/09	REVISED	-		
DATE	-		2/01/2010	REVISED	-		

**STATE OF ILLINOIS**  
**DEPARTMENT OF TRANSPORTATION**

**PLAN SHEET - COLLEGE STREET**  
**CITY OF LINCOLN**  
**LOGAN COUNTY, ILLINOIS**

SCALE: 1"=20'      PAGE 1 OF 2      STA. 50+00.00 TO STA. 59+00.00

F.A.U. RTE.	SECTION	COUNTY	TOTAL SHEETS	SHEET NO.
7718	09-00094-00-RS	LOGAN	10	6
CONTRACT NO.			93526	
FED. ROAD DIST. NO.		ILLINOIS	FED. AID PROJECT	

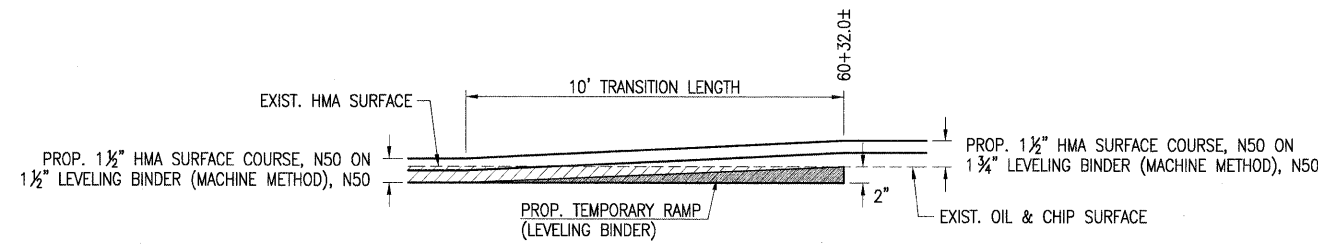

**TRANSITION DETAIL**

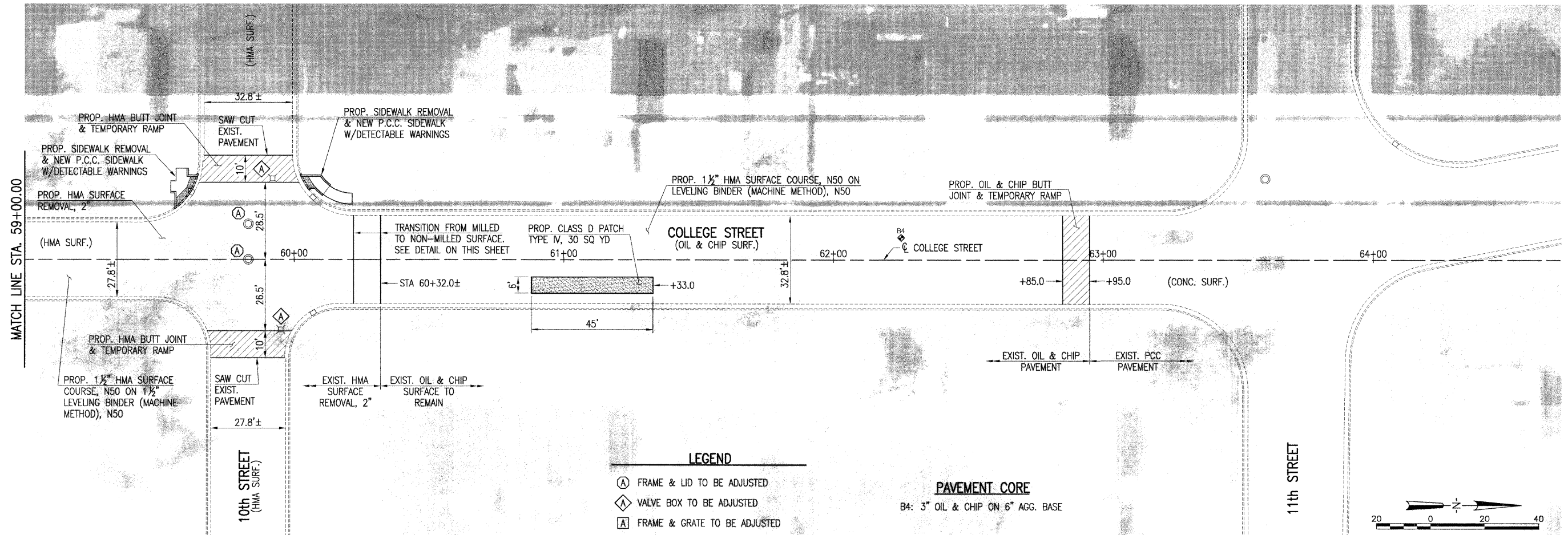

**LEGEND**

- (A) FRAME & LID TO BE ADJUSTED
- ◇ VALVE BOX TO BE ADJUSTED
- [A] FRAME & GRATE TO BE ADJUSTED

**PAVEMENT CORE**

B4: 3" OIL & CHIP ON 6" AGG. BASE

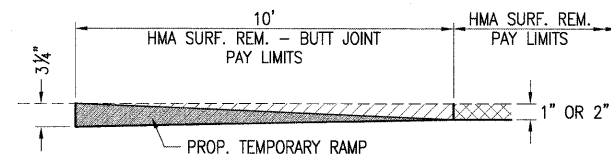
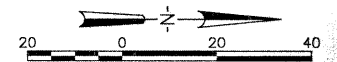

**HMA BUTT JOINT DETAIL**

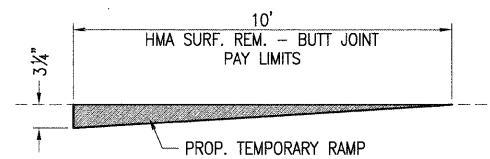

**OIL & CHIP BUTT JOINT DETAIL**

STA 62+85.0 TO STA 62+95.0 ONLY

JAN 28, 2010 11:58 PM  
 I:\09L0077\CADD\ROAD\ROAD\SHEET\C-702001-COLL.DWG



HANSON NO. 09L0077

DESIGNED	-	BJB	9/4/09	REVISED	-	LDK	11/04/09
DRAWN	-	BJB	9/4/09	REVISED	-		
CHECKED	-	LDK	10/20/09	REVISED	-		
DATE	-		2/01/2010	REVISED	-		

STATE OF ILLINOIS  
DEPARTMENT OF TRANSPORTATION

PLAN SHEET - COLLEGE STREET  
CITY OF LINCOLN  
LOGAN COUNTY, ILLINOIS

F.A.U. RTE.	SECTION	COUNTY	TOTAL SHEETS	SHEET NO.
7718	09-00094-00-RS	LOGAN	10	7
CONTRACT NO.			93526	
FED. ROAD DIST. NO.		ILLINOIS	FED. AID PROJECT	

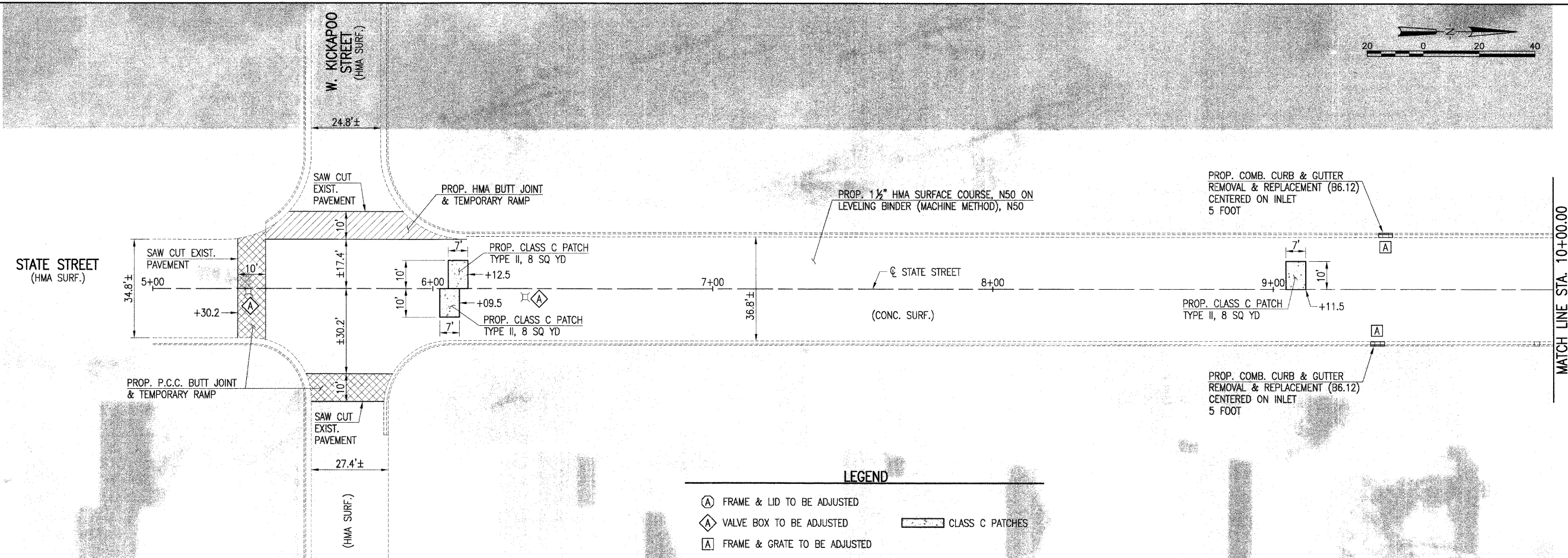

- LEGEND**
- (A) FRAME & LID TO BE ADJUSTED
  - (B) VALVE BOX TO BE ADJUSTED
  - (C) FRAME & GRATE TO BE ADJUSTED
  - CLASS C PATCHES

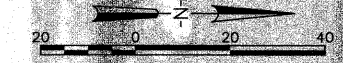
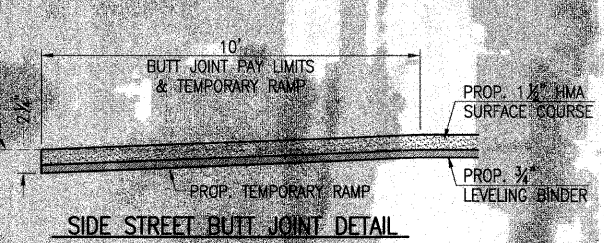
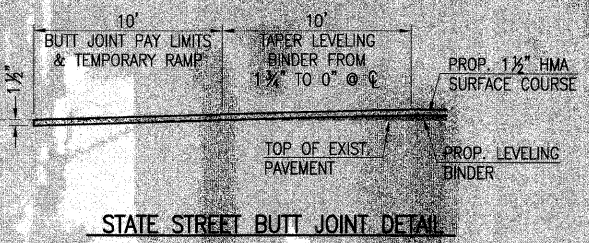
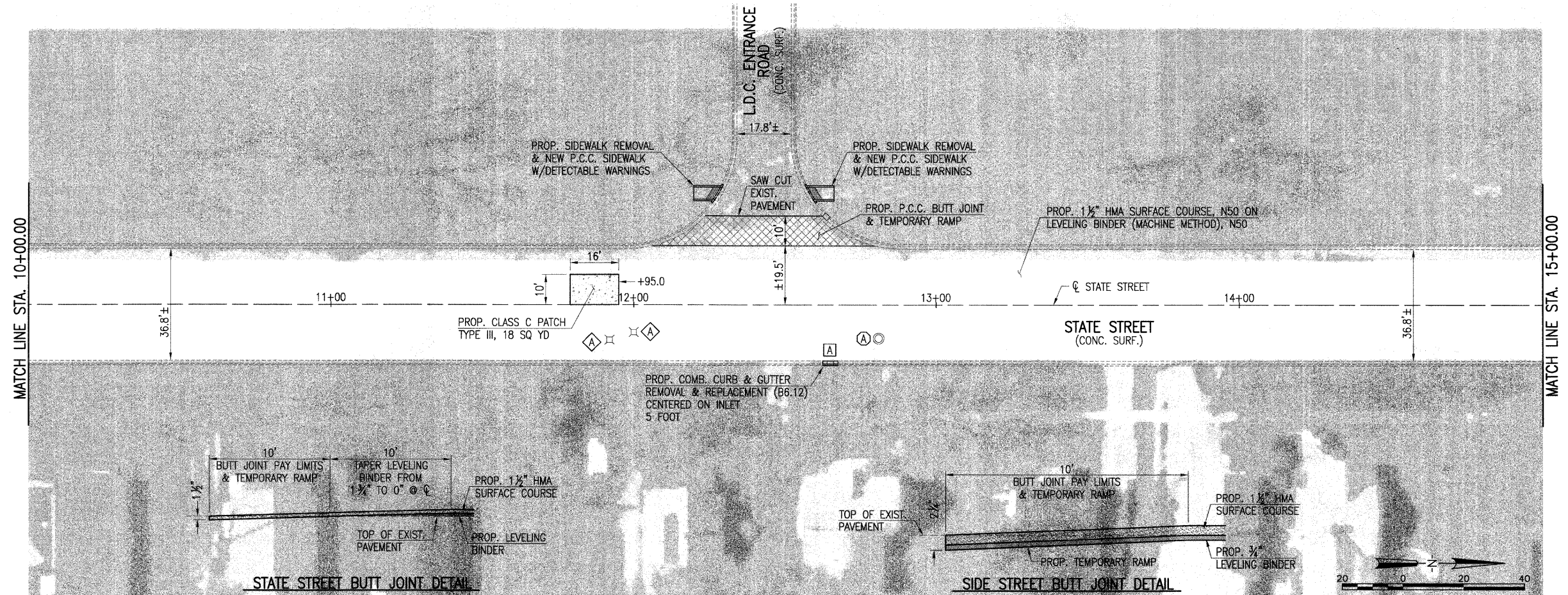

JAN 29, 2010 2:02 PM  
 I:\09\095\09L0077\CADD\ROAD\STATE.DWG

**HANSON**  
 Hanson Professional Services Inc.  
 1525 South Sixth Street, Springfield, IL 62703  
 Registration No. 194-001084  
 © Copyright Hanson Professional Services Inc. 2010

DESIGNED	- BJB	9/4/09	REVISED	- LDK	11/04/09
DRAWN	- BJB	9/4/09	REVISED	-	-
CHECKED	- LDK	10/20/09	REVISED	-	-
DATE	-	2/01/2010	REVISED	-	-

**STATE OF ILLINOIS**  
**DEPARTMENT OF TRANSPORTATION**

**PLAN SHEET - STATE STREET**  
**CITY OF LINCOLN**  
**LOGAN COUNTY, ILLINOIS**

SCALE: 1"=20'      PAGE 1 OF 3      STA. 5+00.00 TO STA. 15+00.00

F.A.U. RTE.	SECTION	COUNTY	TOTAL SHEETS	SHEET NO.
7718	09-00094-00-RS	LOGAN	10	8
CONTRACT NO.			93526	
FED. ROAD DIST. NO.		ILLINOIS	FED. AID PROJECT	



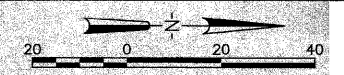
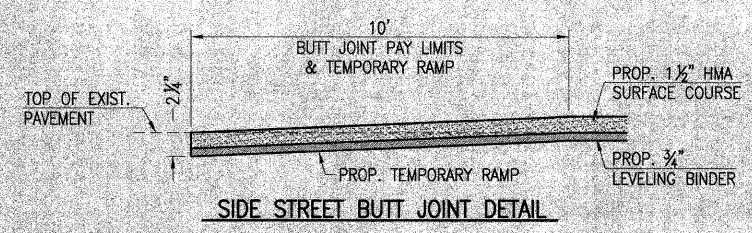
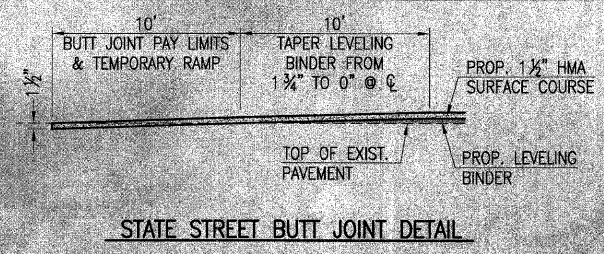

MATCH LINE STA. 15+00.00

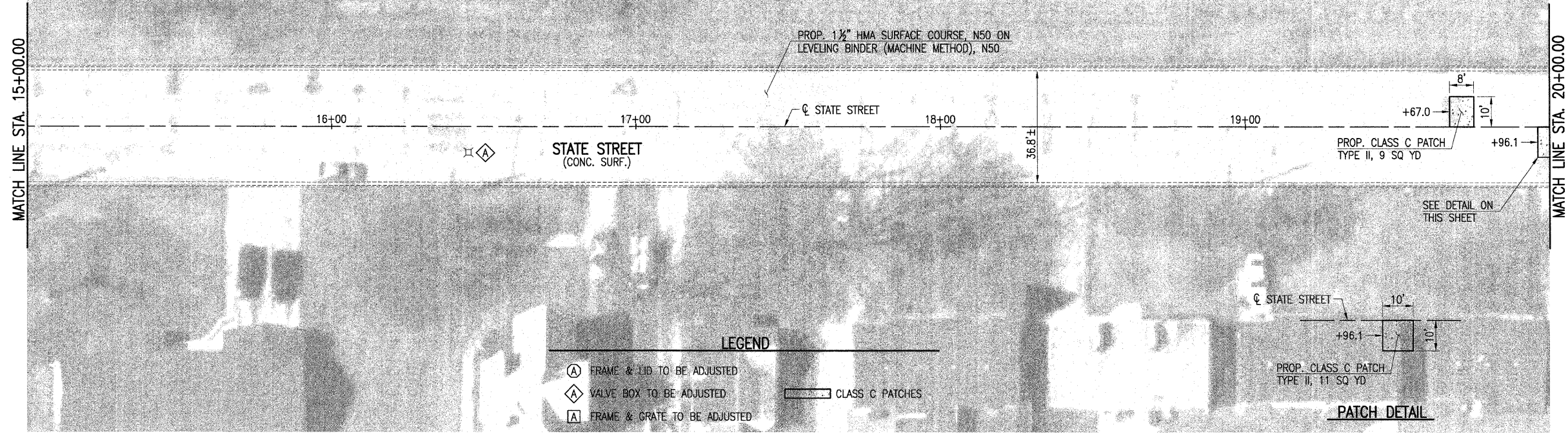

MATCH LINE STA. 20+00.00

MATCH LINE STA. 20+00.00

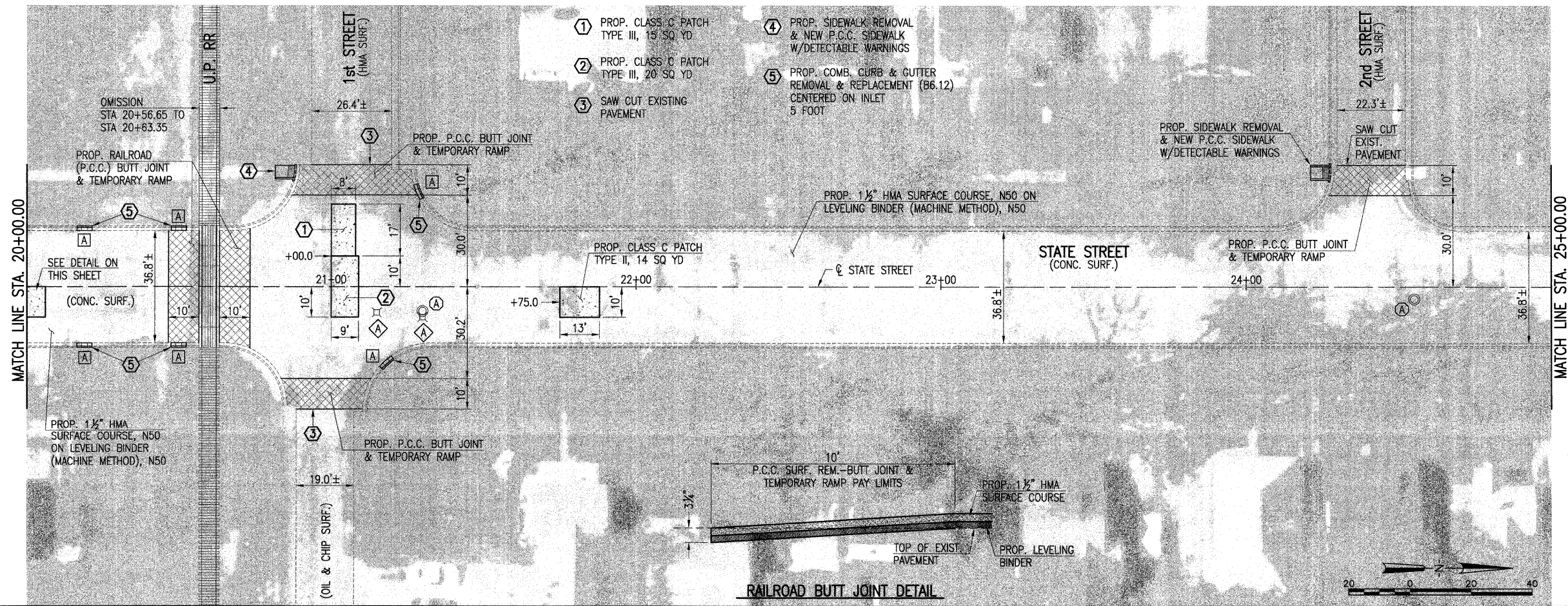

MATCH LINE STA. 25+00.00

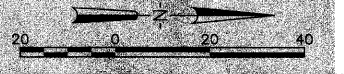
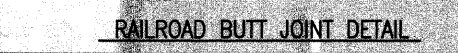

JAN 29, 2010 2:07 PM  
I:\0910095\0910077\CADD\ROAD\STATE\STATE.DWG



DESIGNED - BJB 9/4/09	REVISED - LDK 11/04/09
DRAWN - BJB 9/4/09	REVISED -
CHECKED - LDK 10/20/09	REVISED -
DATE - 2/01/2010	REVISED -

STATE OF ILLINOIS  
DEPARTMENT OF TRANSPORTATION

PLAN SHEET - STATE STREET  
CITY OF LINCOLN  
LOGAN COUNTY, ILLINOIS  
SCALE: 1"=20'  
PAGE 2 OF 3  
STA. 15+00.00 TO STA. 25+00.00

F.A.U. RTE. 7718	SECTION 09-00094-00-RS	COUNTY LOGAN	TOTAL SHEETS 10	SHEET NO. 9
CONTRACT NO. 93526				
FED. ROAD DIST. NO. ILLINOIS		FED. AID PROJECT		

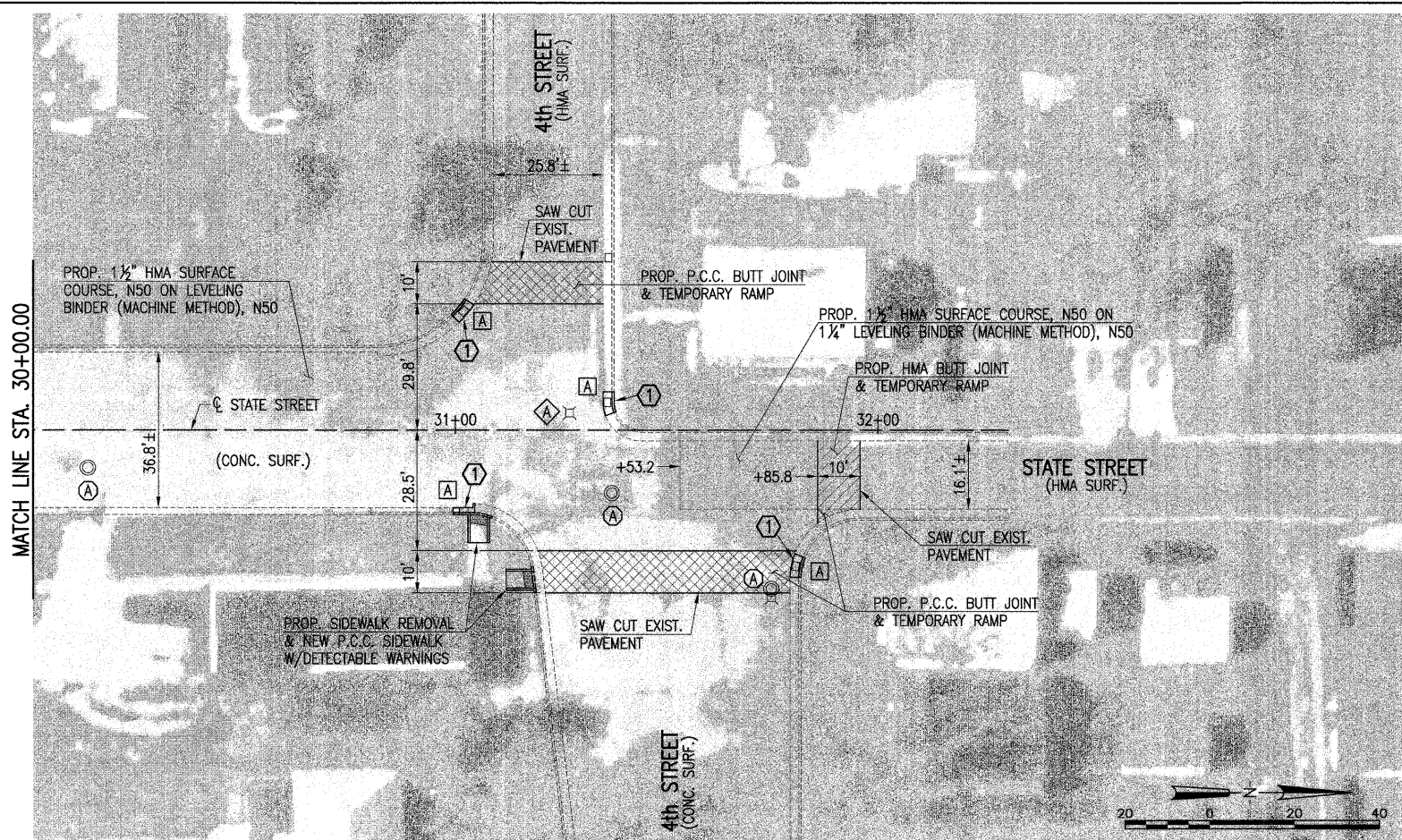
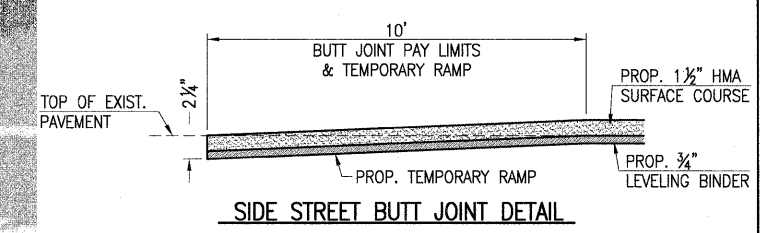
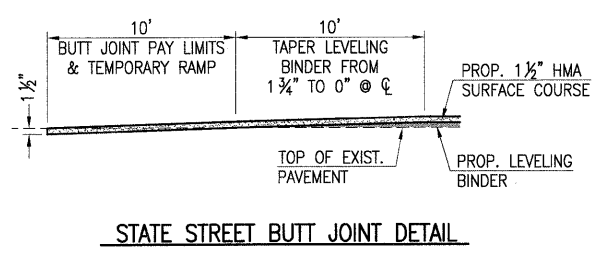
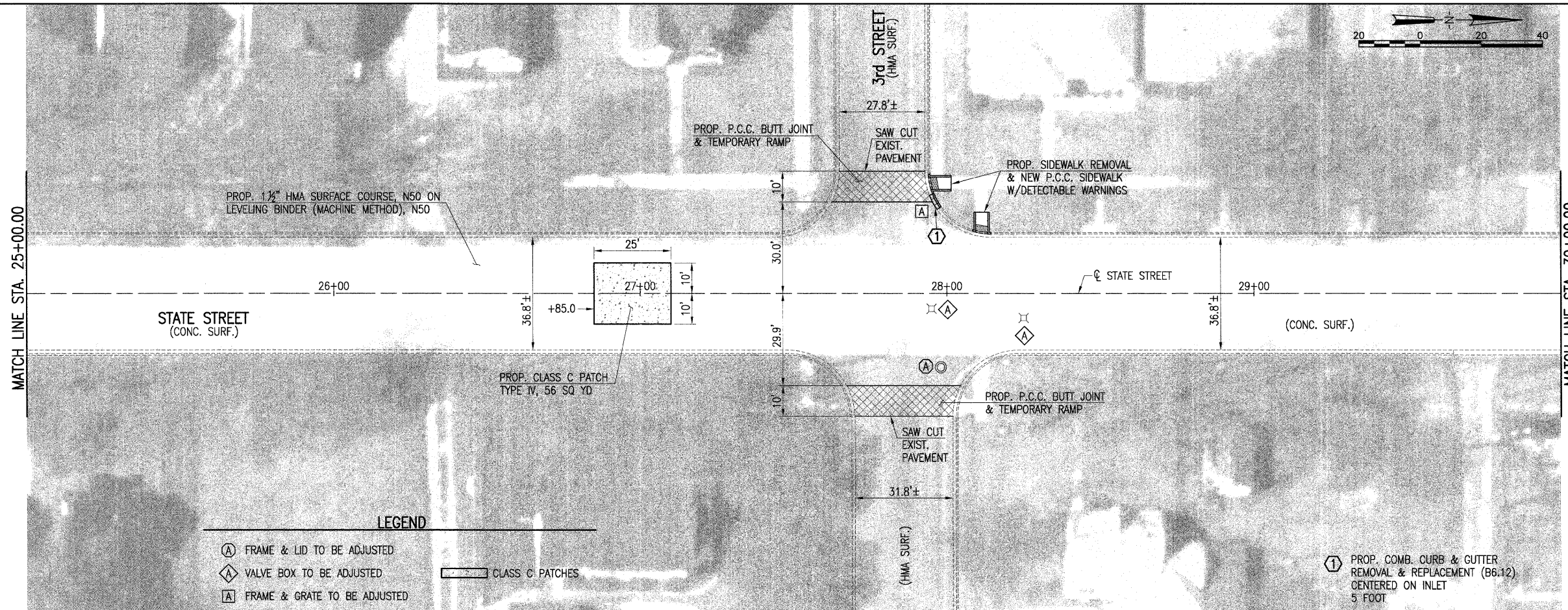

JAN 29, 2010 2:11 PM  
 I:\09\09\09\09\ROAD\STATE\STATE.DWG

**HANSON**  
 Hanson Professional Services Inc.  
 1525 South Sixth Street, Springfield, IL 62703  
 Registration No. 184-001084  
 © Copyright Hanson Professional Services Inc. 2010

DESIGNED	- BJB	9/4/09	REVISED	- LDK	11/04/09
DRAWN	- BJB	9/4/09	REVISED	-	
CHECKED	- LDK	10/20/09	REVISED	-	
DATE	-	2/01/2010	REVISED	-	

STATE OF ILLINOIS  
 DEPARTMENT OF TRANSPORTATION

PLAN SHEET - STATE STREET  
 CITY OF LINCOLN  
 LOGAN COUNTY, ILLINOIS  
 SCALE: 1"=20'  
 PAGE 3 OF 3  
 STA. 25+00.00 TO STA. 32+00.00

F.A.U. R.T.E.	SECTION	COUNTY	TOTAL SHEETS	SHEET NO.
7718	09-00094-00-RS	LOGAN	10	10
CONTRACT NO.			93526	
FED. ROAD DIST. NO.		ILLINOIS	FED. AID PROJECT	