

STATE OF ILLINOIS
DEPARTMENT OF TRANSPORTATION
DIVISION OF HIGHWAYS

PLANS FOR PROPOSED
LOCAL AGENCY PROJECT

FAU ROUTE 9168 (OLD COLLINSVILLE ROAD)
SECTION 05-00035-00-FP
SECTION 05-00056-00-FP
PROJECT NO. M-5011(241)
CITIES OF FAIRVIEW HEIGHTS / O'FALLON, ILLINOIS
ST. CLAIR COUNTY
JOB NO. C-98-342-07
STU PROGRAM

| F.A.U. ROUTE | SECTION | COUNTY | TOTAL SHEETS | SHEET NUMBER |
|---------------------|----------------------------------|----------------|--------------|--------------|
| 9168 | 05-00035-00-FP 05-00056-00-FP | ST. CLAIR | 60 | 1 |
| STA 24+17.37 TO | | STA. 79+10.00 | | |
| FEDERAL AID PROJECT | | CONTRACT 97360 | | |

INDEX OF SHEETS

1. COVER SHEET
2. GENERAL NOTES, HIGHWAY STANDARDS & TIE POINTS
3. SUMMARY OF QUANTITIES
4. TYPICAL SECTIONS
- 5.-7. SCHEDULES
- 8.-17. ROADWAY PLAN AND PROFILE
- 18.-23. REMOVAL ITEMS
- 24.-29. RIGHT-OF-WAY PLAN
30. TRAFFIC CONTROL DETAIL
- 31.-32. EROSION CONTROL
33. INTERSECTION DETAIL
- 34.-35. PAVEMENT MARKING PLAN
36. BOX CULVERT SECTION AND DETAIL
- 37.-38. ENTRANCE DETAILS
39. MISCELLANEOUS DETAILS
40. RAILROAD CROSSING LAYOUT
- 41.-60. CROSS SECTIONS

SCALES:

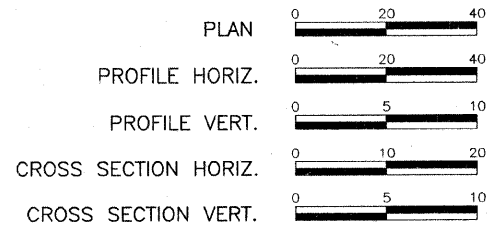

OLD COLLINSVILLE ROAD

ROADWAY DESIGNATION: URBAN LOCAL COLLECTOR
DESIGN SPEED: 30 M.P.H. STA. 24+17.37 TO 31+50.00
40 M.P.H. STA. 31+50.00 TO 79+10.00
ADT: CURRENT (2008) 5,100
20-YEAR (2028) 10,500
SU = 2.8%

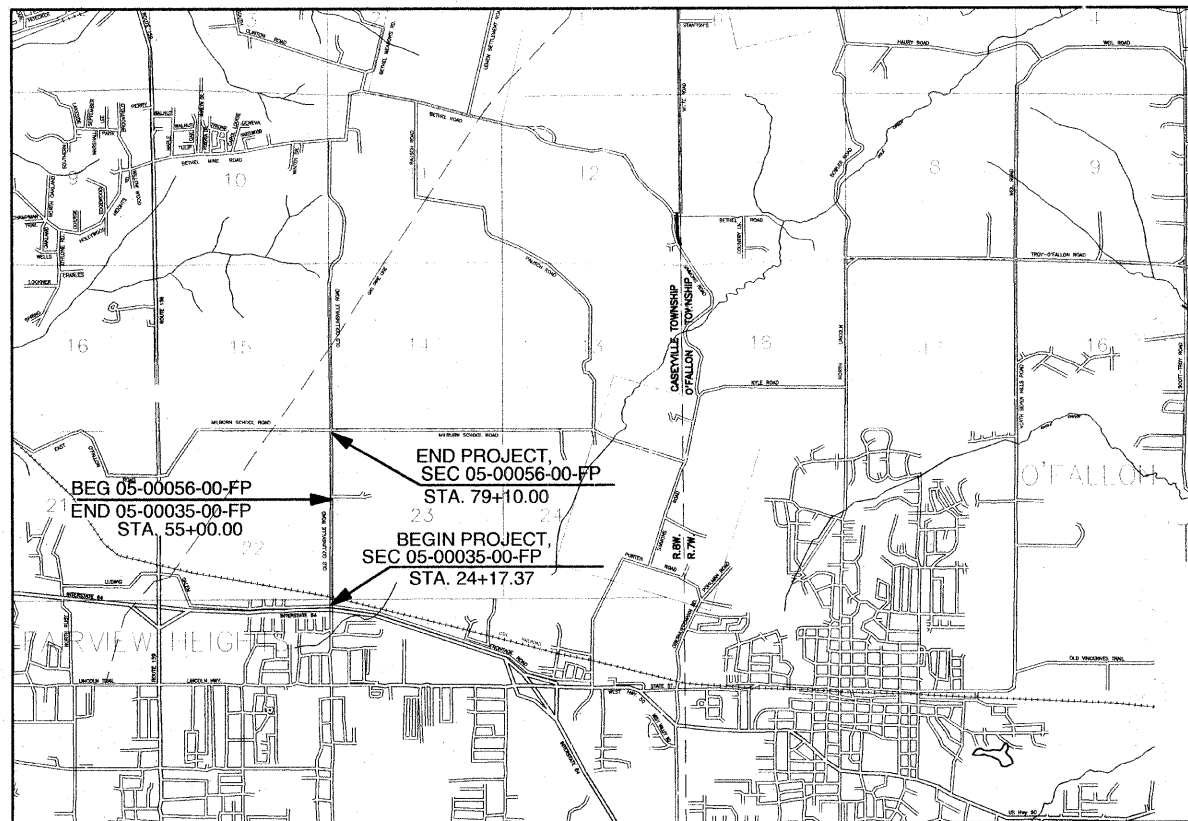

LOCATION MAP
NOT TO SCALE

SECTION 05-00035-00-FP OLD COLLINSVILLE ROAD 3,082.63 FT. = 0.584 MILES (45% TOTAL)
SECTION 05-00056-00-FP OLD COLLINSVILLE ROAD 2,410.00 FT. = 0.456 MILES (55% TOTAL)

OLD COLLINSVILLE RD. 5,492.63 FT. = 1.040 MILES
RR OMISSION -10.22 FT. = 0.002 MILES
NET LENGTH OF IMPROVEMENT 5,482.41 FT. = 1.038 MILES

HOLD IT ! CALL BEFORE YOU DIG !
Phone J.U.L.I.E.

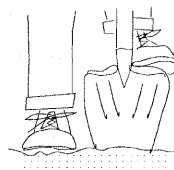

The owner would like to remind you that underground utility facilities can be damaged by shovel blades or other digging equipment. You can prevent damage or possible personal danger by phoning 800/892-0123 at least 48 hours before you dig. That's the toll-free number for "J.U.L.I.E.", which stands for Joint Utilities Location Information for Excavators.

If there are any pipes, cables, lines or mains in the excavation area, utility personnel will be out to mark the facilities so you can work around them.

Toll Free 800/892-0123



LOCATION OF PROJECT INDICATED THUS:

ILLINOIS
DEPARTMENT OF
TRANSPORTATION

APPROVED: *Feb 18, 2009* DATE
MAYOR, CITY OF FAIRVIEW HEIGHTS

APPROVED: *4/8/09* DATE
MAYOR, CITY OF O'FALLON

PASSED: *4/8/09* DATE
DISTRICT EIGHT ENGINEER OF LOCAL ROADS & STREETS

RELEASING FOR BID
BASED ON LIMITED
REVIEW: *4/8/09* DATE
DEPUTY DIRECTOR OF HIGHWAYS, REGION FIVE ENGINEER

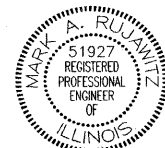

Mark A. Rujewitz
Mark A. Rujewitz
4/8/2009
Date of Signing
11/30/2009
Date of License Expiration



RHUTASEL and ASSOCIATES, INC.
CONSULTING ENGINEERS • LAND SURVEYORS
CORPORATE OFFICE: 4 INDUSTRIAL DRIVE, FREEBURG, ILLINOIS 62243 (618) 539-3178
REGIONAL OFFICE: 201 SOUTH LOCUST STREET, CENTRALIA, ILLINOIS 62801 (618) 532-1992