

F.A.U. ROUTE	SECTION	COUNTY	TOTAL SHEETS	SHEET NUMBER
916B	05-00035-00-FP 05-00056-00-FP	ST. CLAIR	60	30
STA 24+17.37		TO	STA. 79+10.00	
FEDERAL AID PROJECT			CONTRACT 97360	

MAINTENANCE OF TRAFFIC AND SEQUENCE OF CONSTRUCTION

GENERAL

THE CONTRACTOR SHALL USE TYPE III BARRICADES WITH FLASHING LIGHTS AND SIGNS "ROAD CLOSED TO THRU TRAFFIC" (R11-4) AT ALL CLOSURE POINTS. "ROAD CONSTRUCTION AHEAD" (W20-1(O)) AND "ROAD CLOSED AHEAD" (W20-3(O)) WARNING SIGNS WITH FLASHING LIGHTS SHALL BE PLACED IN CONFORMANCE WITH STANDARD BLR 22-6 AND AS DIRECTED BY THE ENGINEER TO ACCOMMODATE FIELD CONDITIONS. INITIAL WARNING SIGNS ON SALEM PLACE/FRONTAGE ROAD AND MILBURN SCHOOL ROAD SHALL HAVE FLASHING LIGHTS.

STAGE I

OLD COLLINSVILLE ROAD SHALL BE CLOSED TO THRU TRAFFIC FOR CONSTRUCTION FROM STA. 24+15.60 TO STA. 28+10. THE CONTRACTOR MUST PROVIDE RAILROAD RIGHT-OF-WAY ENTRY AND ACCESS TO ALL OTHER PROPERTIES AT ALL TIMES. THE CONTRACTOR SHALL ALSO COORDINATE DRIVEWAY PAVEMENT CONSTRUCTION WITH PLUMBER'S SUPPLY SO THAT PRODUCT DELIVERIES CAN BE MAINTAINED. UPON COMPLETION OF STAGE I, THE CONTRACTOR SHALL CONSTRUCT A TEMPORARY RAMP FROM STA. 28+10 TO THE ANDRIA'S RESTAURANT ENTRANCE. THE CONTRACTOR SHALL PROVIDE ALL TRAFFIC CONTROL DEVICES AS SET FORTH IN THE AGREEMENT WITH CSXT CORPORATION INCLUDED WITH THIS CONTRACT. TYPE III BARRICADES WILL BE STATIONED ACROSS THE ROADWAY ON BOTH SIDES OF THE TRACK TO PREVENT TRACK CROSSING AT ALL TIMES.

STAGE II

OLD COLLINSVILLE ROAD SHALL BE CLOSED TO THRU TRAFFIC FOR CONSTRUCTION FROM STA. 28+10 TO STA. 39+00. THE CONTRACTOR MUST PROVIDE ACCESS TO THE PROPERTIES SOUTH OF FOUNTAINS PARKWAY/CHESAPEAKE JUNCTION AT ALL TIMES. CHESAPEAKE JUNCTION ACCESS WILL BE MAINTAINED THRU THE ADJOINING SUBDIVISION. THE CONTRACTOR SHALL ALSO COORDINATE DRIVEWAY PAVEMENT CONSTRUCTION WITH ANDRIA'S STEAK SAUCE CO. SO THAT PRODUCT DELIVERIES CAN BE MAINTAINED.

STAGE III

OLD COLLINSVILLE ROAD SHALL BE CLOSED TO THRU TRAFFIC FOR CONSTRUCTION FROM STA. 39+00 TO STA. 54+50. ACCESS TO THE PRIVATE ENTRANCE AT STA. 48+92.31 AND TO THE CHURCH ON KILDEA LANE WILL BE MADE THRU THE SUBDIVISION VIA RIDGE POINTE DRIVE, STAFFORDSHIRE LANE AND STONE BRIAR DRIVE ACCESS WILL BE AVAILABLE THRU INTERCONNECTED SUBDIVISION TRAVEL. THE CONTRACTOR SHALL NOTIFY CASEYVILLE TOWNSHIP MAINTENANCE WHEN WORK WILL BE PERFORMED ON THEIR ENTRANCE SO TRAFFIC CAN BE ROUTED ONTO ROWE LANE AFTER THE NECESSARY FENCE REMOVAL.

STAGE IV

OLD COLLINSVILLE ROAD SHALL BE CLOSED TO THRU TRAFFIC FOR CONSTRUCTION FROM STA. 54+50 TO STA. 79+10. THE CONTRACTOR MUST PROVIDE ACCESS TO ROWE LANE AT ALL TIMES. ACCESS TO NORTHSORE DRIVE AND SAVANNAH HILLS DRIVE WILL BE MAINTAINED THRU ADJOINING SUBDIVISION TRAVEL OR THRU OUTLETS ONTO MILBURN SCHOOL ROAD

STAGE V

THE CONTRACTOR SHALL CONSTRUCT THE FINAL SURFACE COURSE LIFT UNDER TRAFFIC UTILIZING THE APPLICABLE SECTIONS FOR STANDARDS 701306 AND 701502.

NOTES:

- 1.) THE CONTRACTOR SHALL COORDINATE WORK IN STAGE I WITH RAILROAD CROSSING RECONSTRUCTION BY CSXT PERSONNEL.
- 2.) SHORT-TERM PAVEMENT MARKING SHALL BE INSTALLED AT THE END OF EACH STAGE BEFORE THE ROAD IS OPEN TO TRAFFIC. TEMPORARY PAVEMENT MARKING SHALL BE INSTALLED PER SECTION 703.
- 3.) WORK ON NON-ADJOINING STAGES MAY ALSO BE PERFORMED AT THE SAME TIME.

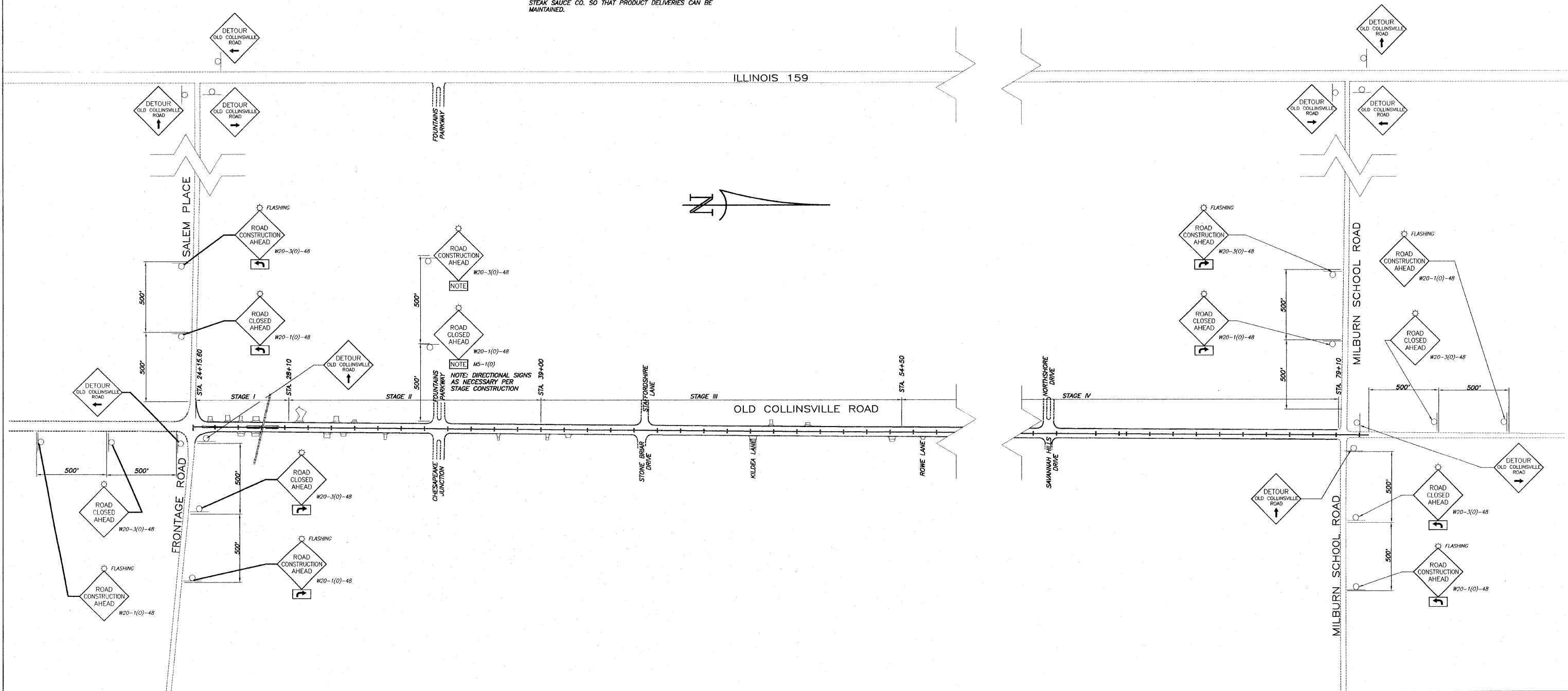

TRAFFIC CONTROL DETAIL OLD COLLINSVILLE ROAD IMPROVEMENTS
SECTION 05-00035-00-FP & 05-00056-00-FP ST. CLAIR COUNTY, ILLINOIS

E:\1105 - 07\plan - old collinsville road\1105 - 07.dwg, 11/20/00 4:47:28 PM, Revised by M.A.L.