

PLAN	SURVEYED	DATE
	NOTED	
	BY	
	NO.	
	NO.	
	NO.	
	NO.	

PROFILE	SURVEYED	DATE
	NOTED	
	BY	
	NO.	
	NO.	
	NO.	
	NO.	

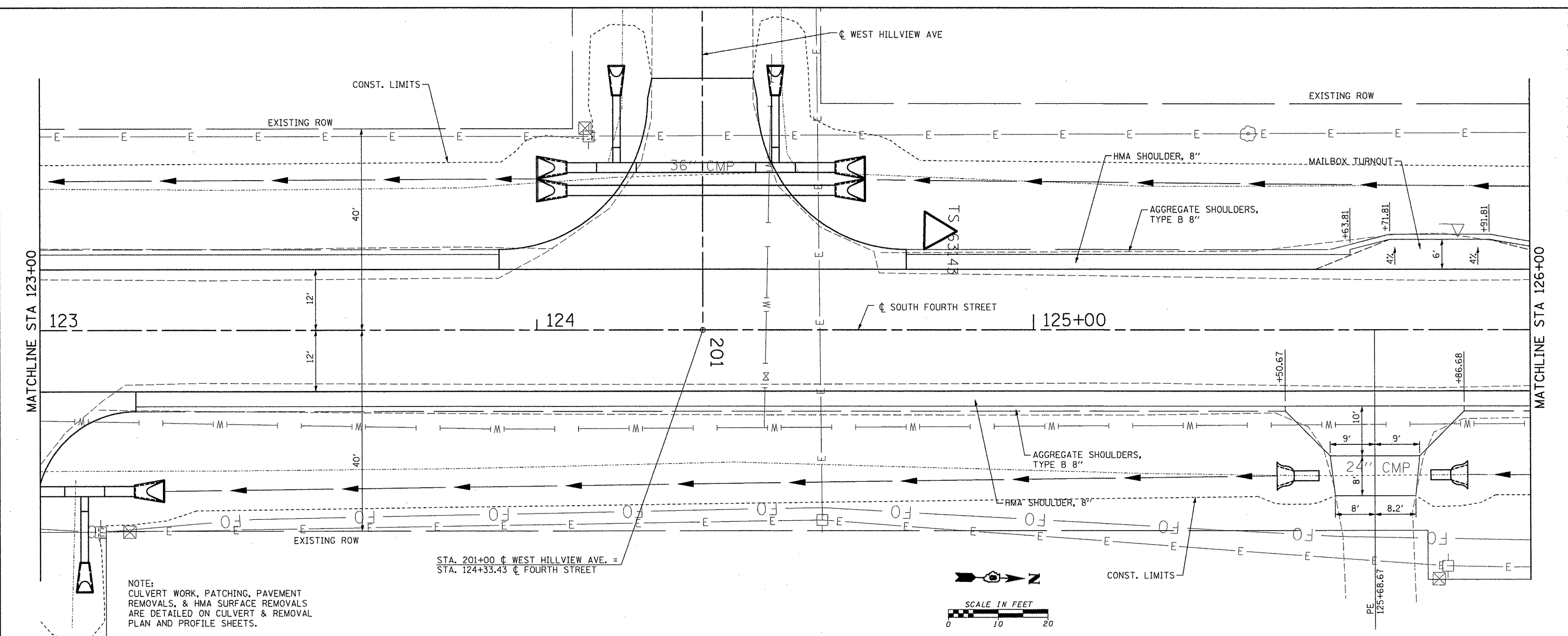

NOTE:
 CULVERT WORK, PATCHING, PAVEMENT
 REMOVALS, & HMA SURFACE REMOVALS
 ARE DETAILED ON CULVERT & REMOVAL
 PLAN AND PROFILE SHEETS.

STA. 201+00 C WEST HILLVIEW AVE. =
 STA. 124+33.43 C FOURTH STREET

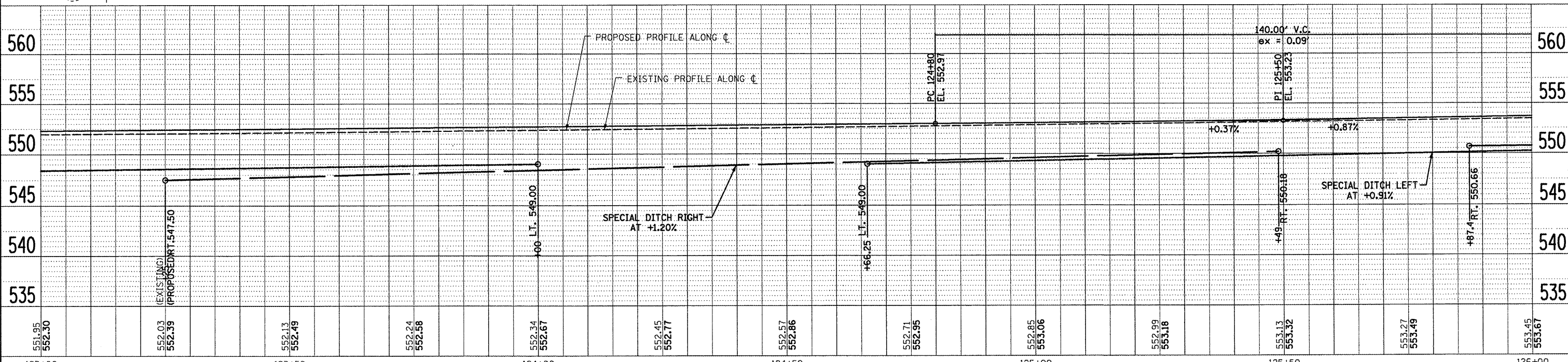
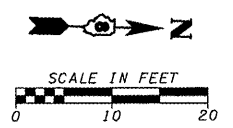

123+00	123+50	124+00	124+50	125+00	125+50	126+00
551.95 552.30	552.03 552.39	552.13 552.49	552.24 552.58	552.34 552.67	552.45 552.77	552.57 552.86
552.71 552.95	552.85 553.06	552.99 553.18	553.13 553.32	553.27 553.49	553.45 553.67	

STATE OF ILLINOIS
 DEPARTMENT OF TRANSPORTATION

PLAN & PROFILE - FOURTH STREET

F.A.U. RTE. 9833	SECTION 05-00016-02-WR	COUNTY BOND	TOTAL SHEET NO. 85	SHEET NO. 28
CONTRACT NO. 97426			ILLINOIS FED. AID PROJECT	

HENRY, MEISENHEIMER & GENDE, INC., 1070 LAKE RD. P.O. BOX 70, CARLYLE, IL. 62231 PHONE (618)594-3711 WWW.HMGENGINEERS.COM