

PLAN	SURVEYED	BY	DATE
	PLOTTED		
	CHECKED		
	NO. OF WAY CHECKED		
	NOTE BOOK		
	NO.		
	ADD FILE NAME		

PROFILE	SURVEYED	BY	DATE
	PLOTTED		
	CHECKED		
	NO. OF WAY CHECKED		
	NOTE BOOK		
	NO.		
	ADD FILE NAME		

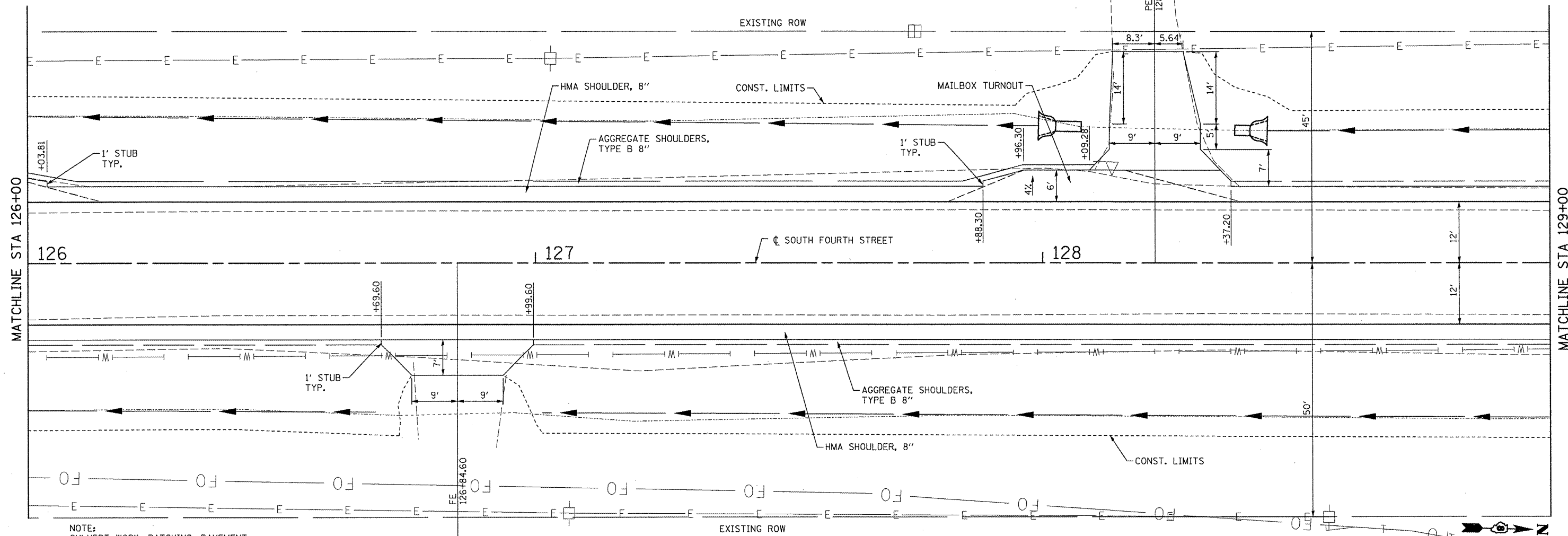

NOTE:  
CULVERT WORK, PATCHING, PAVEMENT  
REMOVALS, & HMA SURFACE REMOVALS  
ARE DETAILED ON CULVERT & REMOVAL  
PLAN AND PROFILE SHEETS.

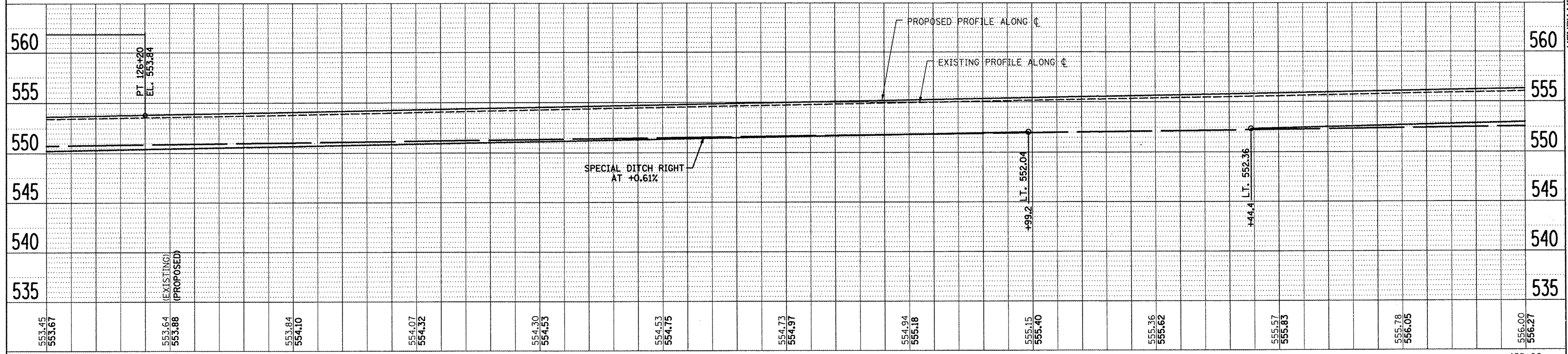
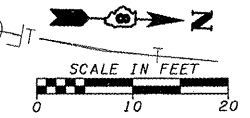

126+00	126+50	127+00	127+50	128+00	128+50	129+00
553.45 553.67	553.64 553.88	553.84 554.10	554.07 554.32	554.30 554.53	554.53 554.75	554.73 554.97
554.94 555.18	555.15 555.40	555.36 555.62	555.57 555.83	555.78 556.05	556.00 556.27	

FILE NAME = PP\_6314.10.DGN  
%FILEL%  
HMG JOB NO. 6314.1

DESIGNED	-	CRW	REVISED	-
DRAWN	-	EDW	REVISED	-
CHECKED	-		REVISED	-
DATE	-		REVISED	-

**STATE OF ILLINOIS  
DEPARTMENT OF TRANSPORTATION**

**PLAN & PROFILE - FOURTH STREET**

F.A.U. RTE. 9833  
SECTION 05-00016-02-WR  
COUNTY BOND  
TOTAL SHEETS 85  
SHEET NO. 29  
CONTRACT NO. 97426  
ILLINOIS FED. AID PROJECT