

NOTES:

- FOR A LIST OF WORK ITEMS FOR THE STAGES OF CONSTRUCTION, SEE THE SPECIAL PROVISIONS.
- ONE LANE OF S. FOURTH ST. SHALL REMAIN OPEN AT ALL TIMES DURING DAYTIME OPERATIONS, WITH APPROPRIATE TRAFFIC CONTROL PER HIGHWAY STANDARDS. TWO LANES OF S. FOURTH ST. SHALL REMAIN OPEN AT THE END OF EACH DAY'S OPERATIONS.
- THE SIGNING AND CLOSURES SHOWN THIS SHEET, FOR SIDE STREETS AND ENTRANCES SHALL BE IN PLACE UNTIL PLACEMENT OF HMA BINDER COURSES ON THE SIDE STREETS AND ENTRANCES.
- HIGHWAY STANDARD 701326 DETAILS TRAFFIC CONTROL ASSOCIATED WITH THE MOVING WORK ZONE. PERTINENT BDE SPECIAL PROVISIONS REQUIRE BARRICADES FOR DROP OFFS. THIS SHEET SHOWS REQUIRED BARRICADE PLACEMENT FOLLOWING UTILIZATION OF STD. 701326. DESCRIBED BARRICADE PLACEMENT SHALL BE IN PLACE UNTIL HMA SURFACE COURSE PLACEMENT, IF THERE ARE NO DROP OFFS GREATER THAN 3" BEYOND INSTALLED SHOULDERS AND PAVEMENT.

SHOWING REPRESENTATIVE SECTION, SEE STD. 701326 AND BDE SPECIAL PROVISIONS. TYPE II BARRICADES OR VERTICAL PANELS SHALL BE PLACED EVERY 50' (NOT 100' FOR 45 MPH AND LESS) AT EVERY LOCATION WHERE THE DROP-OFF FROM EDGE OF PAVEMENT WITHIN 3' IS GREATER THAN 3" AND SHALL REMAIN THERE UNTIL FINAL HMA SURFACE WORK. REMOVAL, SUB-BASE GRANULAR, 12", AND HMA WIDENING WORK ON ONLY ONE (1) SIDE, EAST OR WEST, OF S. FOURTH SHALL BE UNDERTAKEN BEFORE THE OPPOSITE SIDE OF S. FOURTH STREET IS BEGUN (SEE SPECIAL PROVISIONS). AFTER HMA WIDENING IS PLACED ON ONE SIDE, BARRICADES SHALL REMAIN IN PLACE. ADDITIONAL, SIMILAR BARRICADES AND SPACINGS SHALL BE INSTALLED ON THE SUBSEQUENT SIDE WHEN IT IS BEGUN THEREBY CAUSING BARRICADES TO BE INSTALLED ON BOTH SIDES OF S. FOURTH ST.

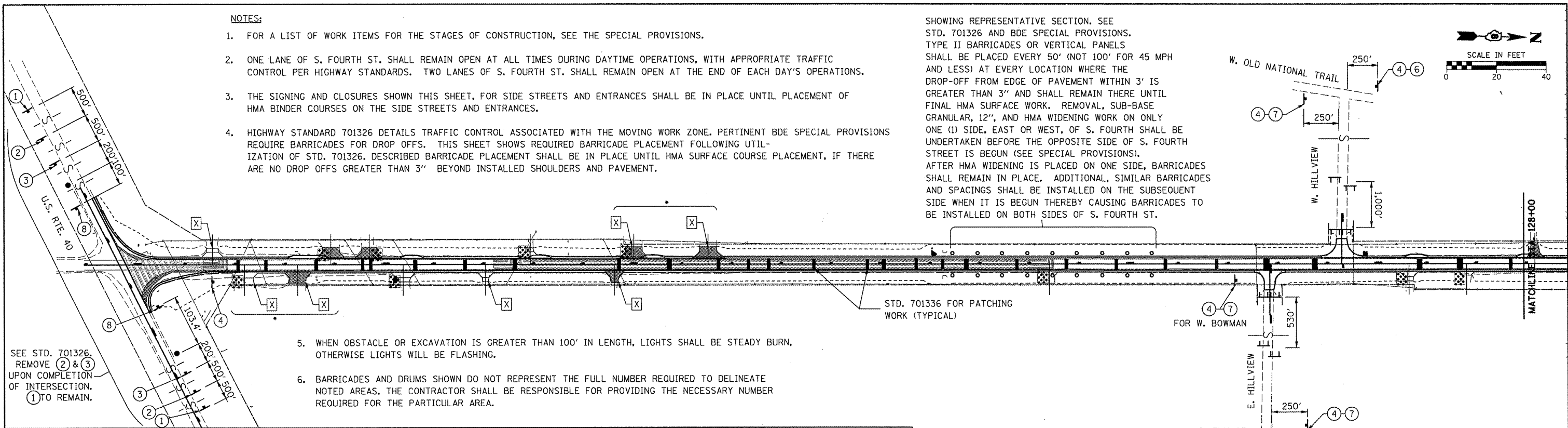

SEE STD. 701326. REMOVE (2) & (3) UPON COMPLETION OF INTERSECTION. (1) TO REMAIN.

- WHEN OBSTACLE OR EXCAVATION IS GREATER THAN 100' IN LENGTH, LIGHTS SHALL BE STEADY BURN, OTHERWISE LIGHTS WILL BE FLASHING.
- BARRICADES AND DRUMS SHOWN DO NOT REPRESENT THE FULL NUMBER REQUIRED TO DELINEATE NOTED AREAS. THE CONTRACTOR SHALL BE RESPONSIBLE FOR PROVIDING THE NECESSARY NUMBER REQUIRED FOR THE PARTICULAR AREA.

STD. 701336 FOR PATCHING WORK (TYPICAL)

① W20-1103(O)-48 (48" x 48")	② W20-4(O)-48 (48" x 48")	③ W20-1101(O)-48 (48" x 48")	④ W20-3(O)-48 (MODIFIED AS SHOWN, 48" x 48")	⑤ R11-4 (60" x 30")	⑥ M6-1(O) (30" x 18") OR M5-1L(O)	⑦ M6-1(O) (30" x 18") OR M5-1R(O)	⑧ W8-11 (48" x 48")

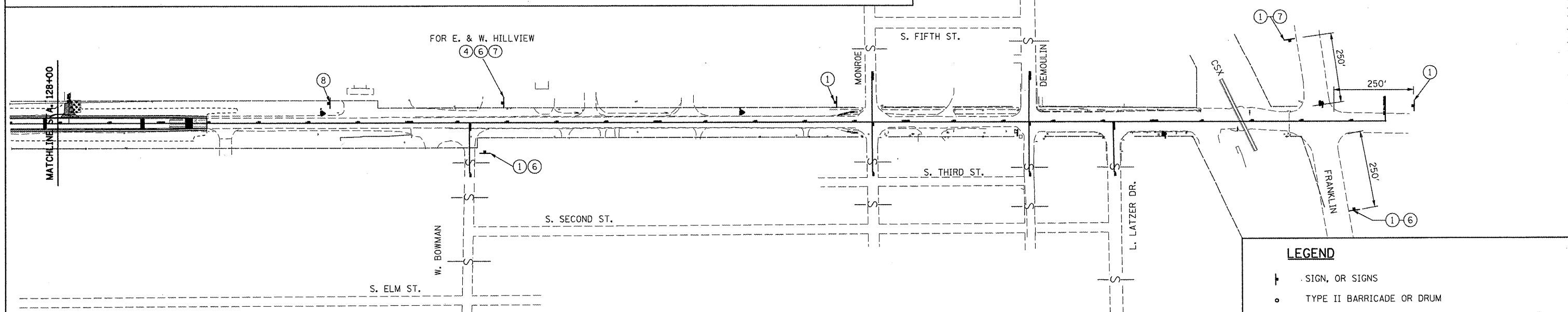

NOTES (CONTINUED):

- ALL ENTRANCES SHALL HAVE A MINIMUM NINE (9) FOOT INGRESS/EGRESS WIDTH OPEN TO TRAFFIC AT ALL TIMES THROUGHOUT CONSTRUCTION, EXCEPT THOSE DELINEATED WITH [X]. AGGREGATE FOR TEMPORARY ACCESS SHALL BE UTILIZED.
- " * " DELINEATES TWO (2) OR MORE ENTRANCES OR SIDE STREETS FOR WHICH ONE (1) OF THE TWO (2) SHALL REMAIN OPEN WHILE THE OTHER MAY BE CLOSED. SIDE STREETS TO REMAIN OPEN SHALL HAVE A MINIMUM OF TWO (2) ELEVEN (11) FOOT LANES.

LEGEND

- SIGN, OR SIGNS
- TYPE II BARRICADE OR DRUM
- TYPE III BARRICADES WITH FLASHING LIGHTS & (5) EXCEPT NO SIGN AT BARRICADES NEAREST CLOSURE
- AGGREGATE FOR TEMPORARY ACCESS
- LOCATION/DIRECTION OF TRAFFIC
- FLAGGER

FILE NAME = STAGECONST.DBLPN.6314.DGN	USER NAME = #USER#	DESIGNED - CRW	REVISED -	STATE OF ILLINOIS DEPARTMENT OF TRANSPORTATION	CONSTRUCTION STAGING & DETAILS - FOURTH STREET	F.A.U. RTE. 9833	SECTION 05-00016-02-WR	COUNTY BOND	TOTAL SHEETS 85	SHEET NO. 33		
#FILE#	PLOT SCALE = #SCALE#	DRAWN - EDW	REVISED -			SCALE:	SHEET NO. OF SHEETS STA. TO STA.	CONTRACT NO. 97426				
HMG JOB NO. 6314.1	PLOT DATE = #DATE#	CHECKED -	REVISED -			ILLINOIS FED. AID PROJECT						
		DATE -	REVISED -									

HENRY, MEISENHEIMER & GENDE, INC., 1070 LAKE RD. P.O. BOX 70, CARLYLE, ILL. 62231 PHONE (618)594-3711 WWW.HMGENGINEERS.COM