

PLAN	DATE
BY	
REVIEWED	
ALIGNED	
CHECKED	
RT. OF WAY	
CHECKED	
NO.	
NO.	
NO.	

PROFILE	DATE
BY	
REVIEWED	
PLotted	
CHECKED	
B.M. NOTED	
STRUCTURE NOTATIONS	
CPWD	
NO.	
NO.	
NO.	

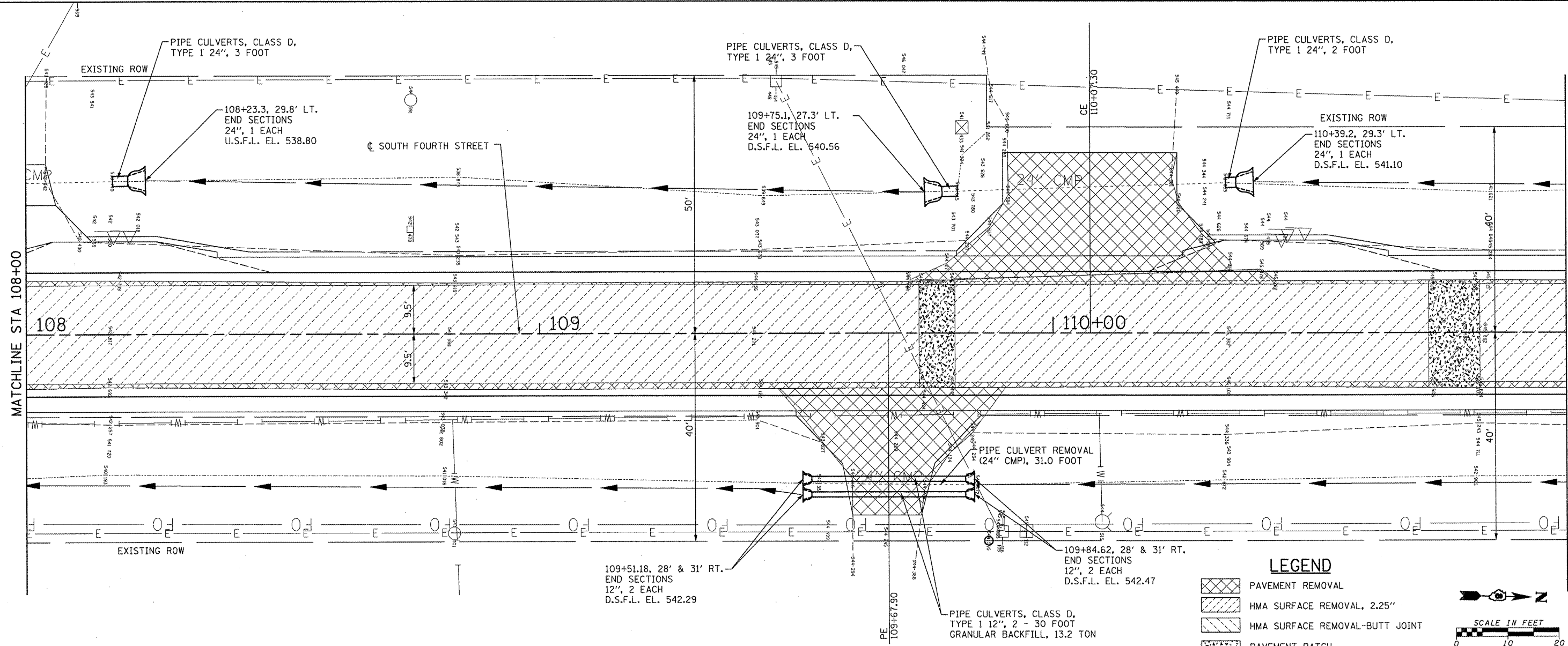

**LEGEND**

- PAVEMENT REMOVAL
- HMA SURFACE REMOVAL, 2.25"
- HMA SURFACE REMOVAL-BUTT JOINT
- PAVEMENT PATCH

SCALE IN FEET  
0 10 20

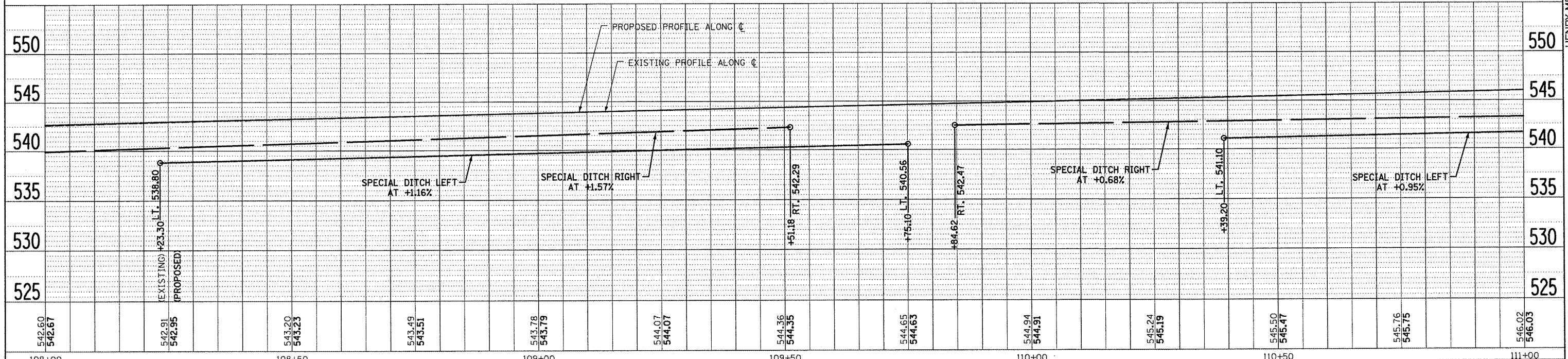

108+00	108+50	109+00	109+50	110+00	110+50	111+00											
542.60 542.67	542.91 542.95	543.20 543.23	543.49 543.51	543.78 543.79	544.07 544.07	544.36 544.35	544.65 544.63	544.94 544.91	545.24 545.19	545.50 545.47	545.76 545.75	546.02 546.03					
FILE NAME = SS_RM_PP_6314_4.DGN		USER NAME = #USER#		DESIGNED - CRW		REVISED -		F.A.I. RTE. 9833		SECTION 05-00016-02-WR		COUNTY BOND		TOTAL SHEETS 85		SHEET NO. 40	
#FILE#		PLOT SCALE = #SCALE#		CHECKED - EDW		REVISED -		SCALE:		SHEET NO. OF SHEETS		STA. TO STA.		CONTRACT NO. 97426		ILLINOIS FED. AID PROJECT	
HMG JOB NO. 6314.1		PLOT DATE = #DATE#		DATE -		REVISED -		STATE OF ILLINOIS DEPARTMENT OF TRANSPORTATION		CULVERT & REMOVAL PLAN & PROFILE - FOURTH STREET							

HENRY, MEISENHEIMER & GENDE, INC., 1070 LAKE RD., P.O. BOX 70, CARLYLE, IL. 62231 PHONE (618) 594-3711 WWW.HMGENGINEERS.COM