

DATE	BY	NO.

DATE	BY	NO.

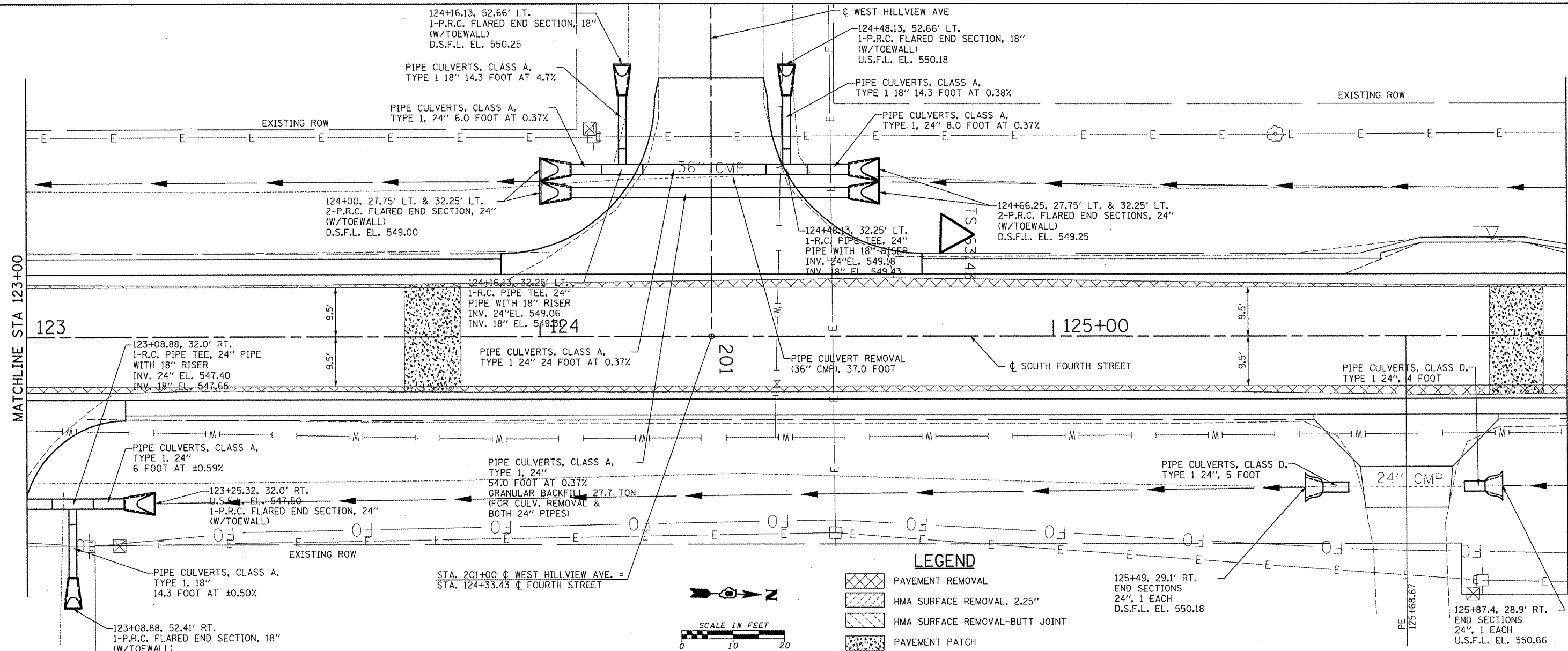

LEGEND

- [Pattern] PAVEMENT REMOVAL
- [Pattern] HMA SURFACE REMOVAL, 2.25"
- [Pattern] HMA SURFACE REMOVAL-BUTT JOINT
- [Pattern] PAVEMENT PATCH

125+49, 29.1' RT. END SECTIONS 24", 1 EACH D.S.F.L. EL. 550.18

125+87.4, 28.9' RT. END SECTIONS 24", 1 EACH U.S.F.L. EL. 550.66

SCALE IN FEET

0 10 20

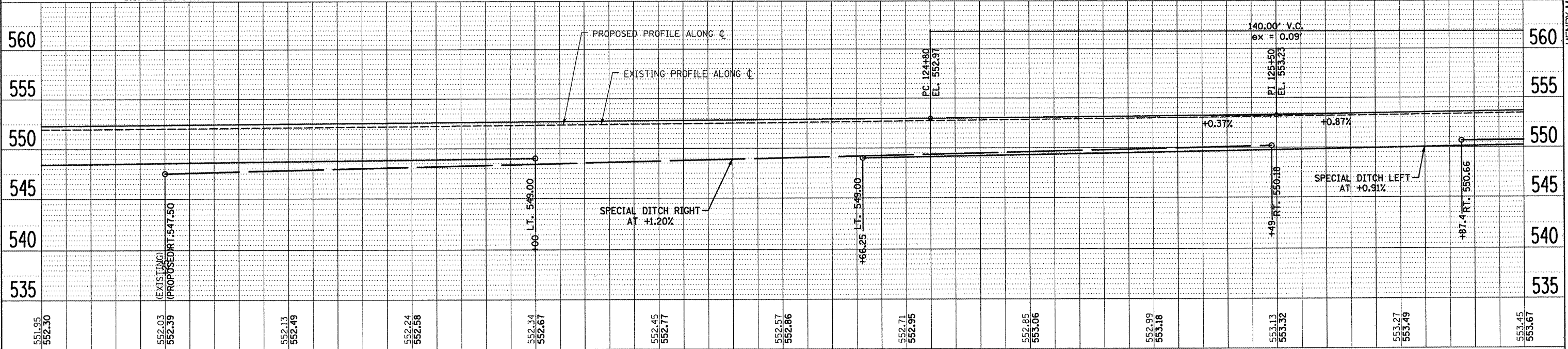

FILE NAME = SS_RM_PP_6314_9.DGN	USER NAME = #USERS	DESIGNED - CRW	REVISED -	STATE OF ILLINOIS DEPARTMENT OF TRANSPORTATION	CULVERT & REMOVAL		F.A.U. RTE.	SECTION	COUNTY	TOTAL SHEETS	SHEET NO.	
#FILE#	PLOT SCALE = #SCALE#	DRAWN - EDW	REVISED -		SCALE:	SHEET NO. OF SHEETS	STA. TO STA.	9833	05-00016-02-WR	BOND	85	45
HMG JOB NO. 6314.1	PLOT DATE = #DATE#	DATE	REVISED -					CONTRACT NO. 97426				
								ILLINOIS FED. AID PROJECT				

HENRY, WEISENHEIMER & GENDE, INC., 1070 LAKE RD., P.O. BOX 70, CARLYLE, IL. 62231 PHONE (618) 594-3711 WWW.HMGENGINEERS.COM