

STATE OF ILLINOIS
 DEPARTMENT OF TRANSPORTATION
 DIVISION OF HIGHWAYS

**PROPOSED
 HIGHWAY PLANS**

FAP ROUTE 853 (IL 14)
 SECTION D9 MITIGATE WETLAND SUGAR CAMP

FRANKLIN COUNTY
 C-99-019-05

F.A.P. RTE.	SECTION	COUNTY	TOTAL SHEETS	SHEET NO.
853		FRANKLIN	34	1
FED. ROAD DIST. NO.	ILLINOIS	CONTRACT NO. 98907		
• D9 MITIGATE WETLAND SUGAR CAMP				

FOR INDEX OF SHEETS, SEE SHEET NO. 3

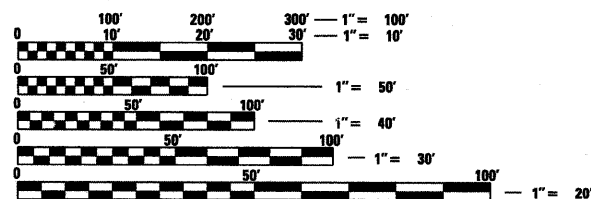
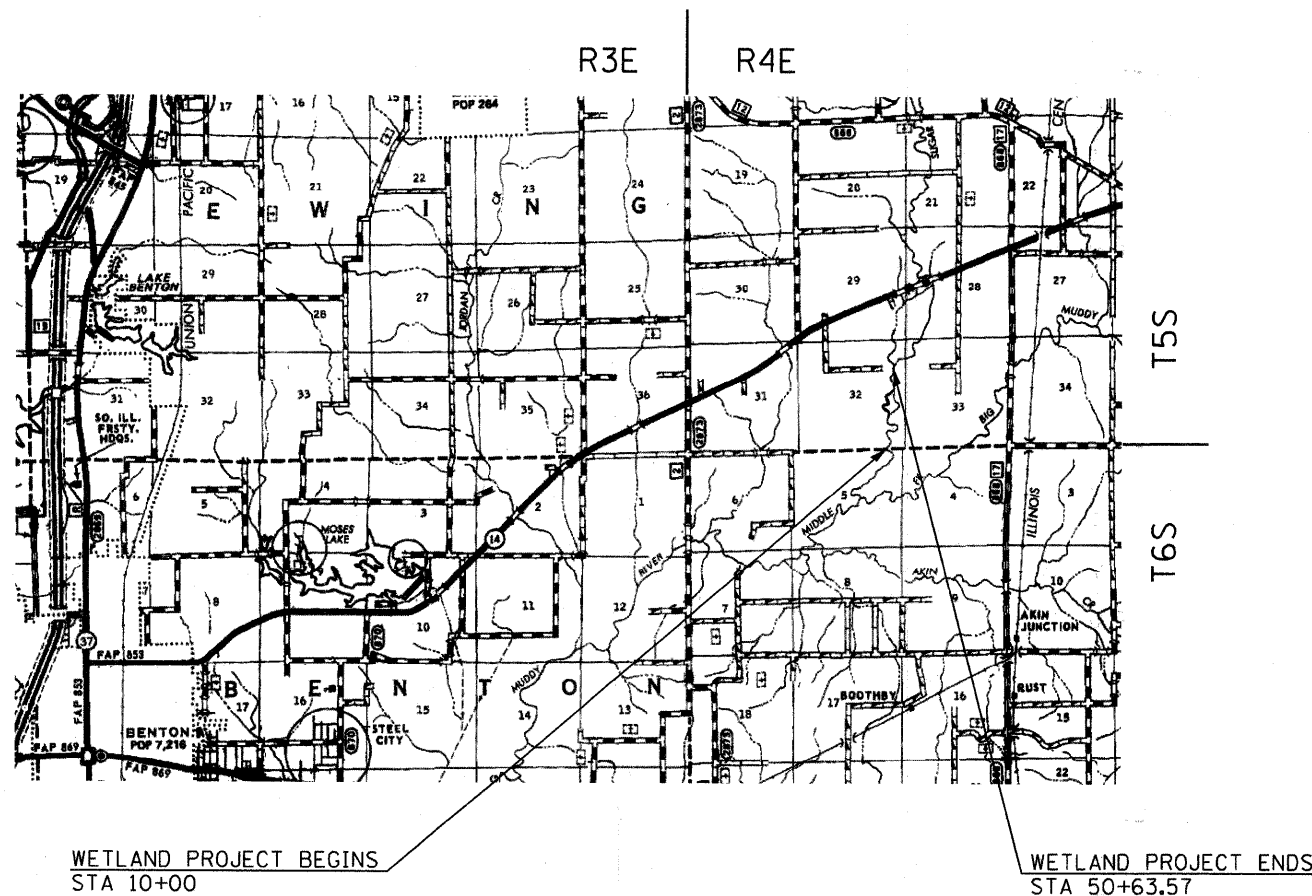
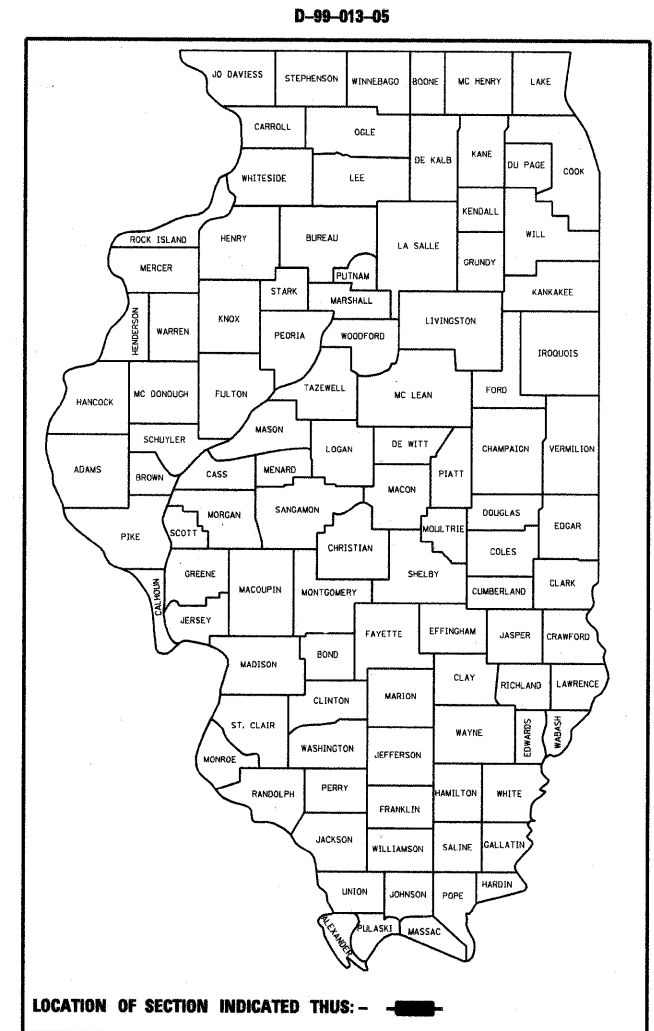

FULL SIZE PLANS HAVE BEEN PREPARED USING STANDARD ENGINEERING SCALES. REDUCED SIZED PLANS WILL NOT CONFORM TO STANDARD SCALES. IN MAKING MEASUREMENTS ON REDUCED PLANS, THE ABOVE SCALES MAY BE USED.

J.U.L.I.E.
 JOINT UTILITY LOCATION INFORMATION FOR EXCAVATION
 1-800-892-0123

TOWNSHIPS: NORTHERN
 PROJECT ENGINEER: CHARLES STEIN
 DESIGNER: VALERIE ROLLA

CONTRACT NO. 98907

STATE OF ILLINOIS
 DEPARTMENT OF TRANSPORTATION
 DIVISION OF HIGHWAYS

SUBMITTED Dec 7 2009

Mary C. Damie
 DEPUTY DIRECTOR OF HIGHWAYS, REGION ENGINEER

January 29 20 10
Scott E. Still P.E./e
 ENGINEER OF DESIGN AND ENVIRONMENT

January 29 20 10
Christine M. Redler
 DIRECTOR OF HIGHWAYS, CHIEF ENGINEER

PRINTED BY THE AUTHORITY
 OF THE STATE OF ILLINOIS