

F.A.S. RTE.	SECTION	COUNTY	TOTAL SHEETS	SHEET NO.
854 C.H. 8	18-00052-06-RS	MONROE	16	1
		ILLINOIS	CONTRACT NO. 97748	

INDEX OF SHEETS 04-23-2021 LETTING ITEM 109

1. COVER SHEET
2. GENERAL NOTES, COMMITMENTS AND HIGHWAY STANDARDS
3. SUMMARY OF QUANTITIES
- 4-5. TYPICAL SECTIONS
6. SCHEDULE OF QUANTITIES
- 7-14. PLAN AND PROFILE - PHASE II RESURFACING
15. ENTRANCE SCHEDULE AND DETAILS
16. SIDEROAD SCHEDULE AND DETAILS

STATE OF ILLINOIS
DEPARTMENT OF TRANSPORTATION
PLANS FOR PROPOSED
FEDERAL AID HIGHWAY

STR FUNDING
FAS 854 - HANOVER ROAD - C.H. 8
HANOVER ROAD PHASE II RESURFACING
SECTION 18-00052-06-RS
PROJECT NO. T2TY(365)

COUNTY OF MONROE
JOB NO. C-98-026-22

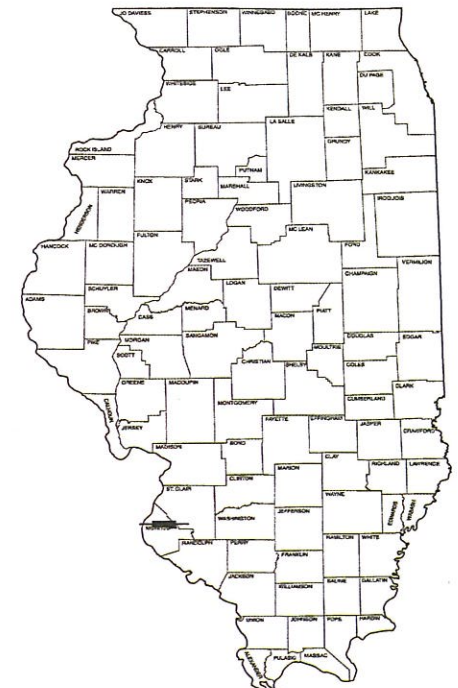

LOCATION OF SECTION INDICATED THUS:

STRUCTURE NUMBERS
067-3200

SCALES

PLAN 1" = 100'
PROFILE 1" = 10'



DESIGN CLASSIFICATION

ROAD CLASSIFICATION = MAJOR COLLECTOR
2020 ADT = 2800 VPD
DESIGN SPEED: 50 MPH-3R DESIGN STANDARDS
POSTED SPEED: 55 MPH

UTILITIES

CALL J.U.L.I.E. BEFORE YOU DIG
800-892-0123

ELECTRIC:

AMEREN ILLINOIS
BELLEVILLE, IL 62221
(618) 236-4372

MONROE COUNTY ELECTRIC CO-OP
WATERLOO, IL 62298
(618) 939-7171

TELEPHONE:

HARRISONVILLE TELEPHONE COMPANY
WATERLOO, IL 62298
(618) 939-6112

FIBER OPTIC:

HARRISONVILLE TELEPHONE COMPANY
WATERLOO, IL 62298
(618) 939-6112

WATER:

FOUNTAIN WATER DISTRICT
VALMEYER, IL 62295
(618) 935-2121

ILLINOIS AMERICAN WATER
EAST ST. LOUIS, IL 62201
(618) 874-0523

CABLE TV:

CHARTER COMMUNICATIONS
MARYVILLE, IL 62062
(618) 345-8003

GAS:

AMEREN ILLINOIS
BELLEVILLE, IL 62221
(618) 236-4372

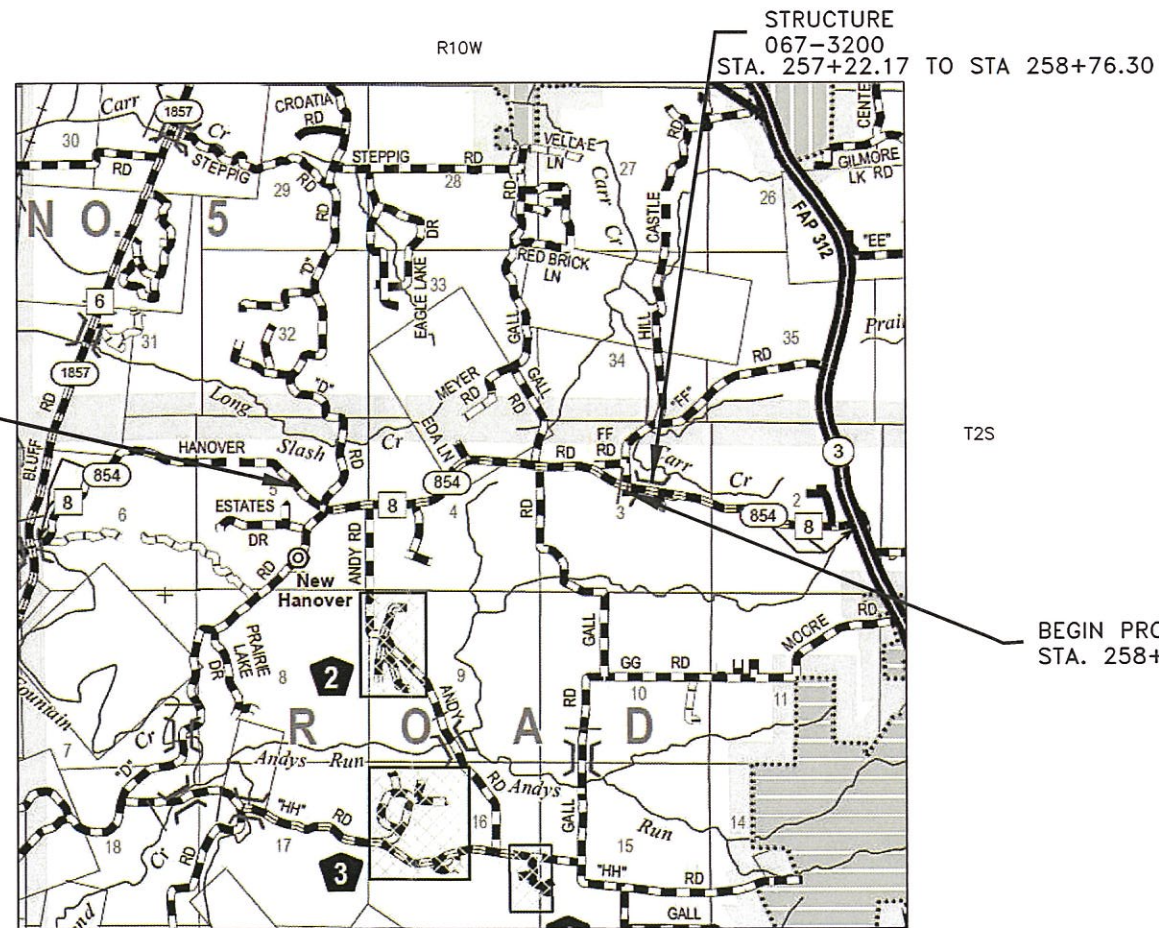

LOCATION MAP

GROSS LENGTH = 11423.70 FEET = 2.164 MILES
NET LENGTH = 11423.70 FEET = 2.164 MILES

DRAWN BY CASEY L. CARNAHAN DATE 09/29/2020

CHECKED BY AARON W. METZGER DATE 10/02/2020

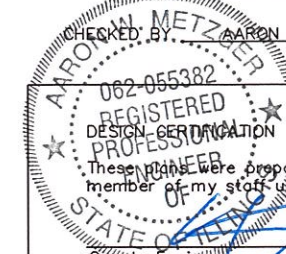

These plans were prepared by me or a full time member of my staff under my personal supervision.
Date 12/9/2020
County Engineer
Illinois Registered Professional Engineer No. 055382
Expiration Date: 11/30/21

STATE OF ILLINOIS
DEPARTMENT OF TRANSPORTATION
APPROVED December 9, 2020

Monroe County Engineer
Monroe County Highway Department

Passed January 15, 2021

District 8 Engineer
Local Roads and Streets

Released for Bid Based on Limited Review
January 15, 2021

Region 5 Engineer

PRINTED BY THE AUTHORITY
OF THE STATE OF ILLINOIS

GENERAL NOTES

1. TRAFFIC CONTROL AND PROTECTION AND PROPER BARRICADES SHALL BE MAINTAINED BY THE CONTRACTOR.
2. THE CONTRACTOR WILL BE REQUIRED TO HAVE TWO FLAGGERS ON-SITE DURING ALL MAINLINE PAVING OPERATIONS.
3. THE CONTRACTOR IS RESPONSIBLE FOR CONTACTING THE MONROE COUNTY HIGHWAY DEPARTMENT AT LEAST 48 HOURS IN ADVANCE PRIOR TO COMMENCEMENT OF ANY CONSTRUCTION ACTIVITIES OR WORK REQUIRING INSPECTION OR APPROVAL.
4. USE ALL FLUORESCENT ORANGE 48" CONSTRUCTION SIGNS.
5. NO OVERNIGHT LANE CLOSURES WILL BE ALLOWED ON THIS PROJECT.
6. FACTORS USED FOR QUANTITY CALCULATIONS ARE AS FOLLOWS:
 ALL HOT-MIX ASPHALT - 112.0 LBS/SQ YD PER 1" THICKNESS
 ALL BITUMINOUS MATERIAL (TACK COAT) - 0.05 LB/SQ FT
7. THE THICKNESS OF THE BITUMINOUS MIXTURE SHOWN ON THE PLANS IS THE NOMINAL THICKNESS, DEVIATIONS FROM THE NOMINAL THICKNESS WILL BE PERMITTED WHEN SUCH DEVIATIONS OCCUR DUE TO IRREGULARITIES IN THE EXISTING SURFACE OR BASE ON WHICH THE BITUMINOUS MIXTURE IS PLACED.
8. ALL TEMPORARY PAVEMENT MARKINGS WILL BE PLACED IN SUCH A MANNER SO AS NOT TO INTERFERE WITH THE PLACEMENT OF PERMANENT PAVEMENT MARKINGS.
9. THERMOPLASTIC PAVEMENT MARKINGS SHALL MATCH EXISTING EXCEPT WHERE INDICATED ON THE PLANS AND AS DIRECTED BY THE ENGINEER.
10. ACCESS SHALL BE PROVIDED TO/FROM PRIVATE ENTRANCES AT ALL LOCATIONS DURING ALL STAGES.
11. ALL EXCAVATION ADJACENT TO THE EDGE OF PAVEMENT SHALL BE PROTECTED BY TYPE 1 OR 2 BARRICADES
12. SEEDING IS NOT ANTICIPATED, ANY AREA DISTURBED OUTSIDE THE CONSTRUCTION LIMITS DURING CONSTRUCTION SHALL BE RESTORED TO ITS ORIGINAL CONDITION AT THE CONTRACTORS EXPENSE.
13. NO WORK WILL BE PERFORMED ON MAILBOX TURNOUTS BEYOND THE NEW 3 FOOT HMA SHOULDER.
14. HOT-MIX ASPHALT SHOULDERS SHALL BE 8" THICK ACROSS ENTRANCES, EXCEPT WHERE INDICATED ON THE PLANS AND DETAILS AND AS DIRECTED BY THE ENGINEER.
15. AN ESTIMATED QUANTITY OF 100 TONS OF AGGREGATE SURFACE COURSE, TYPE B IS ANTICIPATED FOR USE AS DIRECTED BY THE ENGINEER ON AGGREGATE ENTRANCES BEYOND THE NEW HMA SHOULDER.

SALVAGE: ASPHALT MILLINGS - SEE SPECIAL PROVISIONS

COMMITMENTS: NONE

HIGHWAY STANDARDS

STANDARD SYMBOLS	000001-08
HMA SHOULDER	482001-02
TRAFFIC CONTROL	701201-05 701301-04 701306-04 701311-03 701326-04 701901-08 BLR 21-9
PAVEMENT MARKING	780001-05 781001-04

HOT-MIX ASPHALT MIXTURE REQUIREMENTS					
LOCATIONS	ALL				
MIXTURE USE	SURFACE	BINDER	SHOULDER BASE	SHOULDER SURFACE	INCIDENTAL
AC/PG	PG 64-22	PG 64-22	PG 64-22	PG 64-22	PG 64-22
RAP % (MAX)	SEE SPECIAL PROVISIONS	SEE SPECIAL PROVISIONS	SEE SPECIAL PROVISIONS	SEE SPECIAL PROVISIONS	SEE SPECIAL PROVISIONS
DESIGN AIR VOIDS	4.0% @ Ndes= 70	4.0% @ Ndes= 70	4.0% @ Ndes= 30	4.0% @ Ndes=30	4.0% @ Ndes=70
MIXTURE COMPOSITION (GRADATION MIXTURE)	IL 9.5	IL 9.5	IL 19.0 L	IL 9.5 L	IL 9.5
FRICITION AGGREGATE	MIXTURE D	MIXTURE C	MIXTURE C	MIXTURE C	MIXTURE D

DRAWING FILE: S:\HANOVER ROAD RESURFACING 2019\Phase II\COVER PHASE II

USER NAME =	DESIGNED -	REVISED -
	DRAWN -	REVISED -
PLOT SCALE = 100,000' / in.	CHECKED -	REVISED -
PLOT DATE =	DATE -	REVISED -

MONROE COUNTY
HIGHWAY DEPARTMENT

GENERAL NOTES, COMMITMENTS AND HIGHWAY STANDARDS

SCALE: NA SHEET 1 OF 1 SHEETS STA. TO STA.

F.A.S. RTE. 854 C.H.B.	SECTION 18-00052-06-RS	COUNTY MONROE	TOTAL SHEETS 16	SHEET NO. 2
CONTRACT NO. 97748			ILLINOIS FED. AID PROJECT	

DRAWING FILE: S:\HANOVER ROAD RESURFACING 2019\Phase II\COVER PHASE II

SUMMARY OF QUANTITIES			
CODE	ITEM	UNIT	QUANTITY
20200600	EXCAVATING AND GRADING EXISTING SHOULDER	UNIT	228
40200800	AGGREGATE SURFACE COURSE, TYPE B	TON	100
40600290	BITUMINOUS MATERIALS (TACK COAT)	POUND	16543
40600982	HOT-MIX ASPHALT SURFACE REMOVAL - BUTT JOINT	SQ YD	97.8
40600990	TEMPORARY RAMP	SQ YD	32.8
40602985	HOT-MIX ASPHALT BINDER COURSE, IL-9.5 N70	TON	444
40604062	HOT-MIX ASPHALT SURFACE COURSE, IL-9.5 MIX "D" N70	TON	3128
40800029	BITUMINOUS MATERIALS (TACK COAT)	POUND	294
40800050	INCIDENTAL HOT-MIX ASPHALT SURFACING	TON	292
44000100	PAVEMENT REMOVAL	SQ YD	652
44000155	HOT-MIX ASPHALT SURFACE REMOVAL, 1 1/2"	SQ YD	27827
48203100	HOT-MIX ASPHALT SHOULDERS	TON	2634
67100100	MOBILIZATION	L SUM	1
70300100	SHORT TERM PAVEMENT MARKING	FT	2078
70300150	SHORT TERM PAVEMENT MARKING REMOVAL	SQ FT	346.3
70300220	TEMPORARY PAVEMENT MARKING - LINE 4"	FT	42031
Δ 78000200	THERMOPLASTIC PAVEMENT MARKING - LINE 4"	FT	42031
Δ 78100100	RAISED REFLECTIVE PAVEMENT MARKER	EACH	143
X7010216	TRAFFIC CONTROL AND PROTECTION (SPECIAL)	L SUM	1
X7030005	TEMPORARY PAVEMENT MARKING REMOVAL	SQ FT	14010.3
# 20076600	TRAINEES	Hour	1500
# 20076604	TRAINING PROGRAM GRADUATE	Hour	1500

Δ SPECIALTY ITEMS
= 0042

USER NAME =	DESIGNED -	REVISED -	MONROE COUNTY HIGHWAY DEPARTMENT	SUMMARY OF QUANTITIES		F.A.S. RTE.	SECTION	COUNTY	TOTAL SHEETS	SHEET NO.
PLOT SCALE = 100,000' / in.	DRAWN -	REVISED -				854 C.H.B.	18-00052-06-RS	MONROE	16	3
PLOT DATE =	CHECKED -	REVISED -		SCALE: NA	SHEET 1 OF 1 SHEETS	STA.	TO STA.	CONTRACT NO. 97748		
	DATE -	REVISED -		ILLINOIS FED. AID PROJECT						

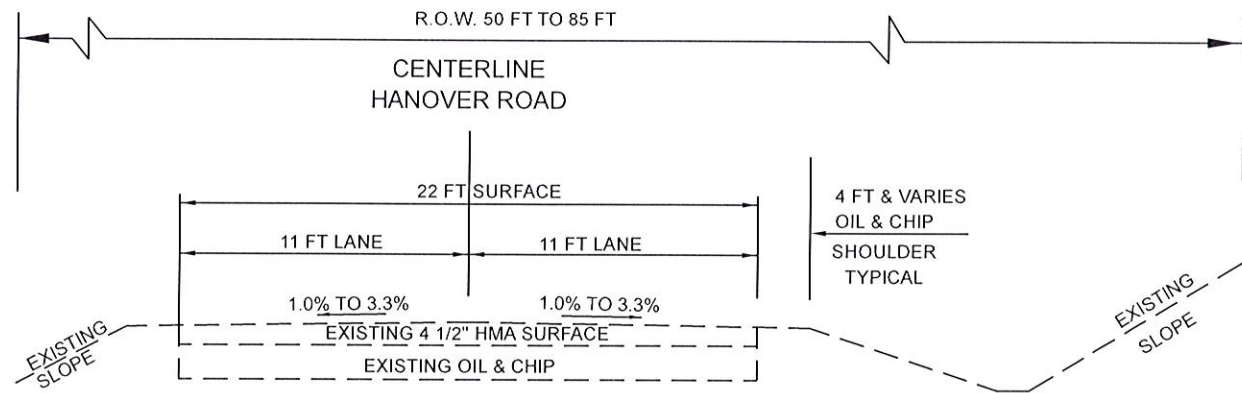

EXISTING TYPICAL SECTION

- STA 258+76.30 TO STA 264+35.28
- STA 273+88.20 TO STA 275+89.42
- STA 284+84.00 TO STA 294+50.00
- STA 298+57.71 TO STA 299+87.33
- STA 301+51.65 TO STA 315+19.64
- STA 326+11.97 TO STA 329+04.35
- STA 337+53.06 TO STA 345+50.17
- STA 348+12.65 TO STA 354+21.90
- STA 357+14.35 TO STA 365+39.46
- STA 371+92.80 TO STA 373+00.00

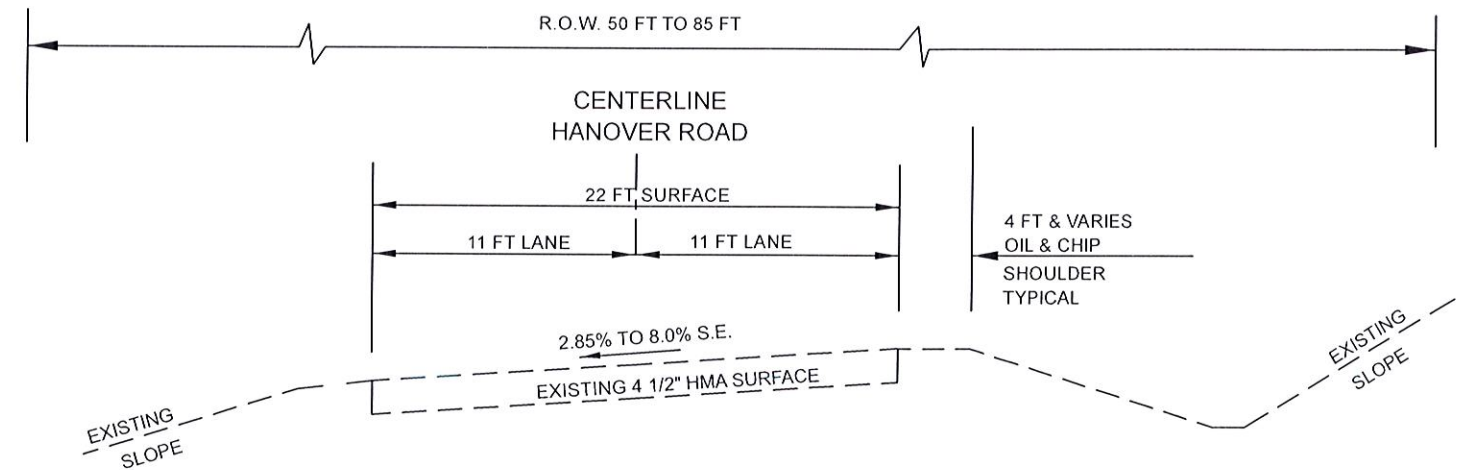

EXISTING SUPERELEVATED SECTION

- STA 264+35.28 TO STA 273+88.20
- STA 275+89.42 TO STA 284+84.00
- STA 294+50.00 TO STA 298+57.71
- STA 299+87.33 TO STA 301+51.65
- STA 315+19.64 TO STA 326+11.97
- STA 329+04.35 TO STA 337+53.06
- STA 345+50.17 TO STA 348+12.65
- STA 354+21.90 TO STA 357+14.35
- STA 365+39.46 TO STA 371+92.80

DRAWING FILE: S:\HANOVER ROAD RESURFACING 2019\Phase II\typical_sections_phase_II

USER NAME *	DESIGNED -	REVISED -
	DRAWN -	REVISED -
PLOT SCALE = 50 000' / in.	CHECKED -	REVISED -
PLOT DATE *	DATE -	REVISED -

MONROE COUNTY
HIGHWAY DEPARTMENT

TYPICAL SECTIONS - PHASE II RESURFACING

SCALE NTS SHEET 1 OF 2 SHEETS STA. 258+76.30 TO STA. 373+00

F A S RTE. 854 C H 8	SECTION 18-00052-06-RS	COUNTY MONROE	TOTAL SHEETS 16	SHEET NO. 4
				CONTRACT NO. 97748
ILLINOIS FED AID PROJECT				

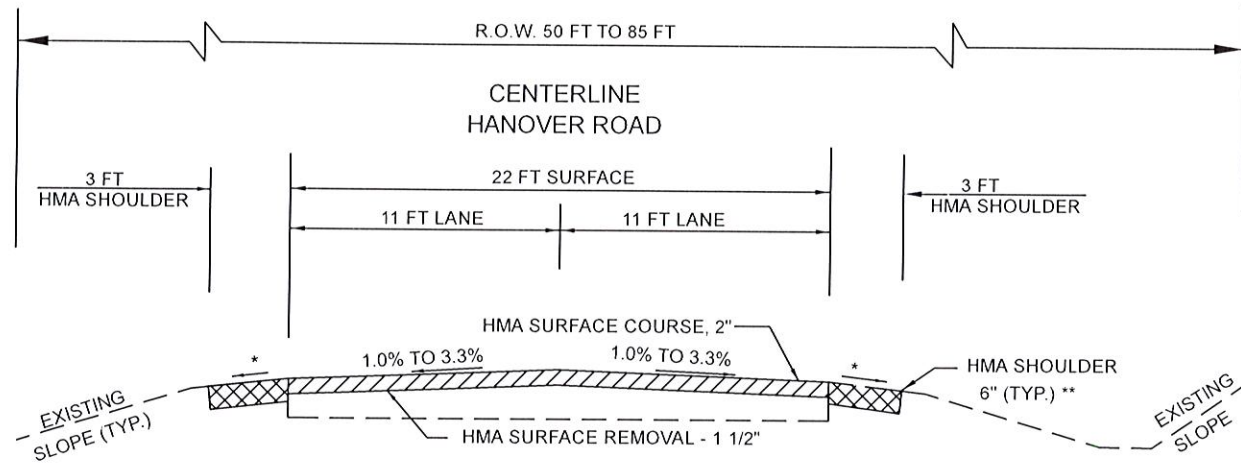

PROPOSED SECTION

- STA 258+76.30 TO STA 264+35.28
- STA 273+88.20 TO STA 275+89.42
- STA 284+84.00 TO STA 294+50.00
- STA 298+57.71 TO STA 299+87.33
- STA 301+51.65 TO STA 315+19.64
- STA 326+11.97 TO STA 329+04.35
- STA 337+53.06 TO STA 345+50.17
- STA 348+12.65 TO STA 354+21.90
- STA 357+14.35 TO STA 363+00.00

** HMA SHOULDER 6" (TYP.)
 SHALL BE PLACED IN 2 LIFTS
 FIRST LIFT TO MATCH MILLED SURFACE.
 SECOND LIFT TO MATCH NEW HMA SURFACE.

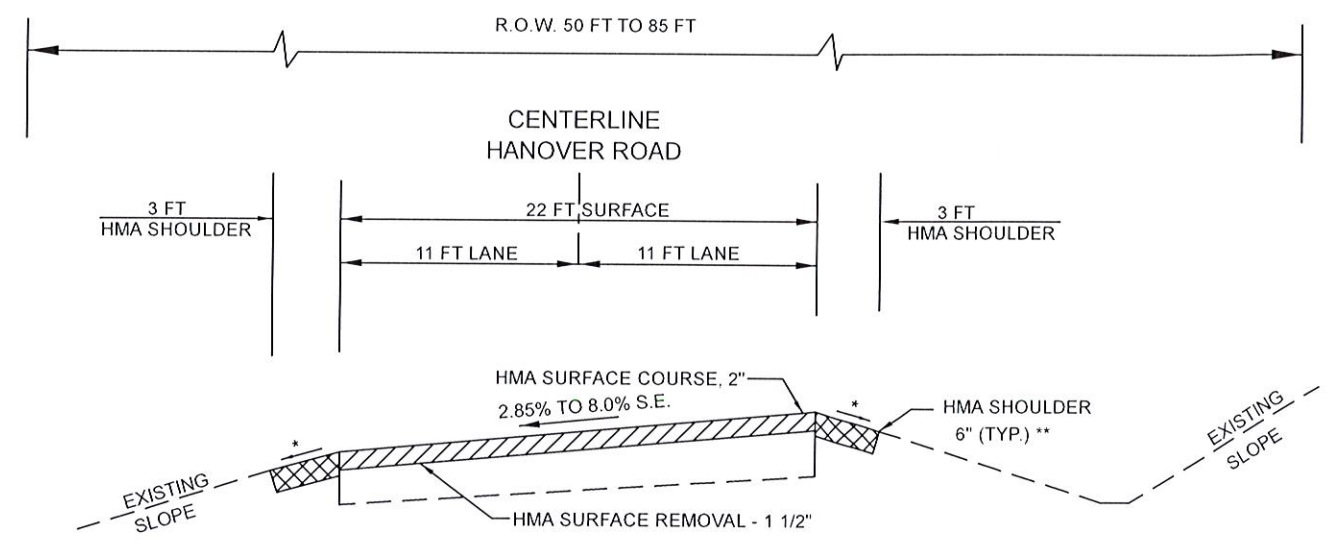

PROPOSED SUPERELEVATED SECTION

- STA 264+35.28 TO STA 273+88.20
- STA 275+89.42 TO STA 284+84.00
- STA 294+50.00 TO STA 298+57.71
- STA 299+87.33 TO STA 301+51.65
- STA 315+19.64 TO STA 326+11.97
- STA 329+04.35 TO STA 337+53.06
- STA 345+50.17 TO STA 348+12.65
- STA 354+21.90 TO STA 357+14.35

* 8% ROLLOVER FACTOR
 SHOULDER SLOPE 4% & VARIES

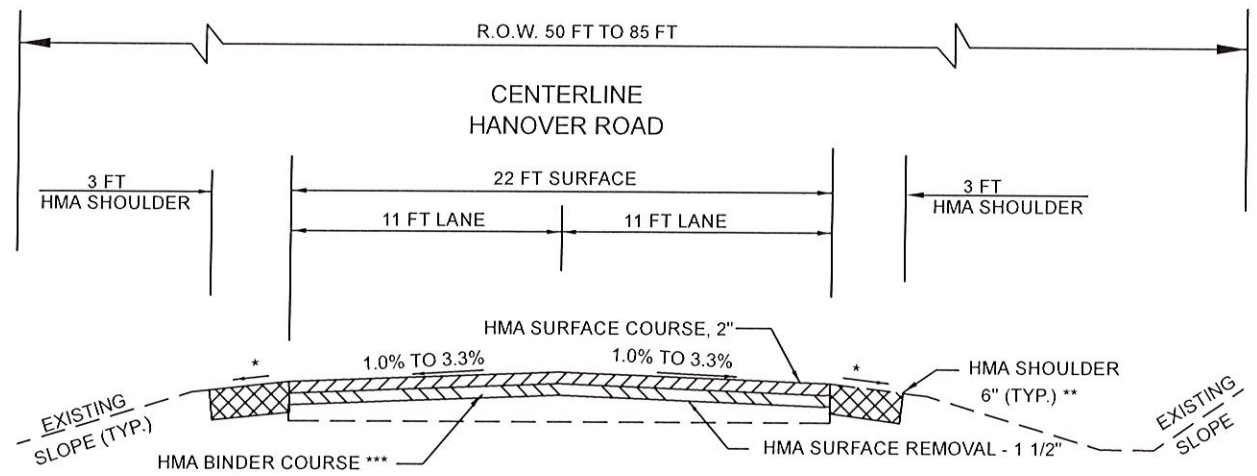

PROPOSED PROFILE CORRECTION SECTION

- STA 363+00.00 TO STA 365+39.46
- STA 371+92.80 TO STA 373+00.00

*** BINDER THICKNESS VARIES TO CORRECT PROFILE
 SHALL BE PLACED IN LIFTS NOT TO EXCEED 4"
 SEE SHEET 14 FOR THICKNESS DETAILS

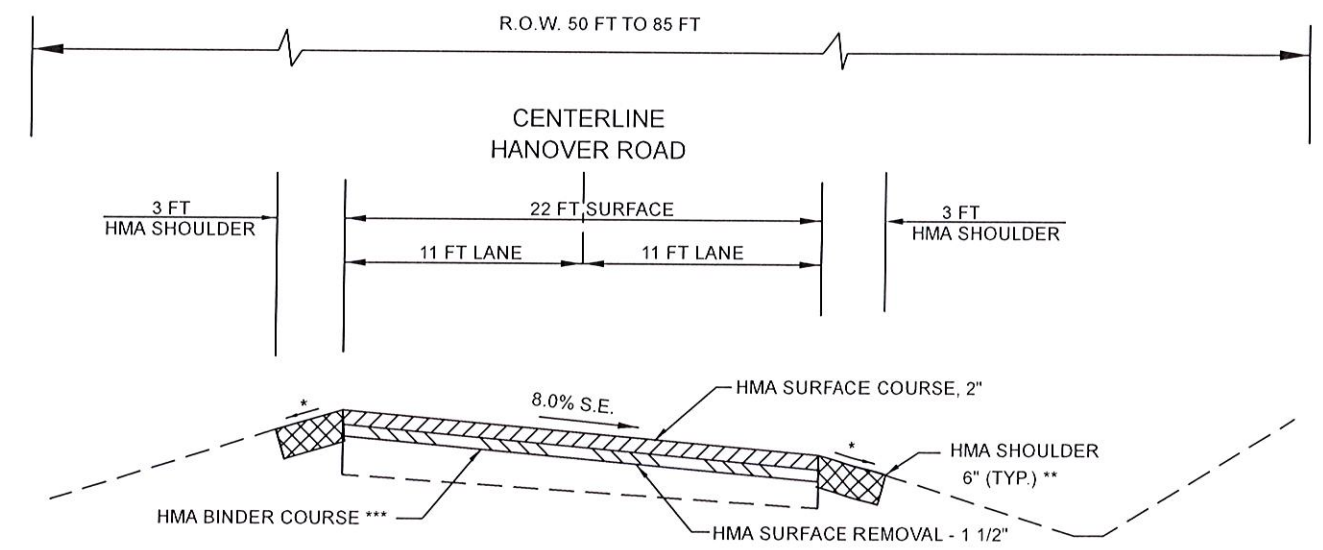

PROPOSED SUPERELEVATED PROFILE CORRECTION SECTION

- STA 365+39.46 TO STA 371+92.80

DRAWING FILE: S:\HANOVER ROAD RESURFACING 2019\Phase II\typical_sections_phase II

USER NAME *	DESIGNED -	REVISED -	MONROE COUNTY HIGHWAY DEPARTMENT	TYPICAL SECTIONS - PHASE II RESURFACING	F.A.S. RTE. 854 C.H. 8	SECTION 18-00052-06-RS	COUNTY MONROE	TOTAL SHEETS 16	SHEET NO. 5	
PLOT SCALE * 50,000' / in	DRAWN -	REVISED -			SCALE: NTS	SHEET 2 OF 2 SHEETS	STA. 258+76.30 TO STA. 373+00	CONTRACT NO. 97748		
PLOT DATE =	CHECKED -	REVISED -			ILLINOIS FED. AID PROJECT					
	DATE -	REVISED -								

EARTH EXCAVATION QUANTITIES	
LOCATION	EXCAVATING AND GRADING EXISTING SHOULDER
	UNIT
STA. 258+76.30 TO STA.373+00	228
TOTAL	228

*ALL EXCESS MATERIAL EXCAVATED SHALL BECOME PROPERTY OF THE CONTRACTOR. THE COST FOR HAULING AND DISPOSAL OF EXCESS MATERIAL SHALL BE INCLUDED IN THE COST OF EXCAVATING AND GRADING EXISTING SHOULDER.

HOT-MIX ASPHALT QUANTITIES										
LOCATION	HMA SURFACE COURSE IL - 9.5 MIX "D" N70	HMA BINDER COURSE IL - 9.5 N70	HMA SHOULDER	HMA REMOVAL 1 1/2"	HMA REMOVAL BUTT-JOINT	PAVEMENT REMOVAL	BITUMINOUS MATERIALS (TACK COAT)	INCIDENTAL HMA SURFACING	TEMPORARY RAMP	INCIDENTAL BITUMINOUS MATERIALS (TACK COAT)
	TON	TON	TON	SQ YD	SQ YD	SQ YD	LB	TON	SQ YD	LB
STA. 258+76.30 TO STA. 373+00.00	3128	444	2634	27827	97.8		16543		32.8	
SIDEROAD SCHEDULE QUANTITIES ON SHEET 16						652		292		294
TOTAL	3128	444	2634	27827	97.8	652	16543	292	32.8	294

PAVEMENT MARKING QUANTITIES												
LOCATION	SHORT TERM PAVEMENT MARKING	SHORT TERM PAVEMENT MARKING REMOVAL	TEMPORARY PAVEMENT MARKING - LINE 4"				TEMPORARY PAVEMENT MARKING REMOVAL	THERMOPLASTIC PAVEMENT MARKING - LINE 4"				RAISED REFLECTIVE PAVEMENT MARKERS 2-WAY AMBER
			YELLOW SKIP-DASH	YELLOW SOLID	WHITE SOLID	WHITE SKIP-DASH		YELLOW SKIP-DASH	YELLOW SOLID	WHITE SOLID	WHITE SKIP-DASH	
			FOOT	FOOT	FOOT	FOOT		FOOT	FOOT	FOOT	FOOT	
STA. 258+76.30 TO STA. 270+00	204	34	280	1124	2075	40	1173	280	1124	2075	40	14
STA. 270+00 TO STA. 277+00	128	21.3		1400	1400		933.3		1400	1400		9
STA. 277+00 TO STA. 294+60	320	53.3	440	1760	3520		1906.7	440	1760	3520		22
STA. 294+60 TO STA. 334+50	726	121		7980	7754	52	5262		7980	7754	52	50
STA. 334+50 TO STA. 340+90	116	19.3	160	640	1280		693.3	160	640	1280		8
STA. 340+90 TO STA. 352+00	202	33.7		2220	2118	24	1454		2220	2118	24	14
STA. 352+00 TO STA. 358+00	110	18.3	150	600	1122	18	630	150	600	1122	18	7
STA. 358+00 TO STA. 373+00	272	45.3		3000	2836	38	1958		3000	2836	38	19
SUBTOTAL			1030	18724	22105	172		1030	18724	22105	172	
TOTAL	2078	346.3		42031			14010.3		42031			143

DRAWING FILE: S:\HANOVER ROAD RESURFACING 2019\Phase II\Cover Phase II

USER NAME =	DESIGNED -	REVISED -
PLOT SCALE = 100,000' / in.	DRAWN -	REVISED -
PLOT DATE =	CHECKED -	REVISED -
	DATE -	REVISED -

MONROE COUNTY
HIGHWAY DEPARTMENT

SCHEDULE OF QUANTITIES

SCALE: NA SHEET 1 OF 1 SHEETS STA. TO STA.

F.A.S. RTE. 854 C.H.8	SECTION 18-00052-06-RS	COUNTY MONROE	TOTAL SHEETS 16	SHEET NO. 6
				CONTRACT NO. 97748
ILLINOIS FED. AID PROJECT				

CURVE NO 6

L = 952.92'
 R = 2206.12'
 $\Delta = 24^\circ 44' 55''$
 T = 484.01'
 D = 2°35'50"
 S.E. = 4.67%

 HOT-MIX ASPHALT SURFACE REMOVAL - BUTT JOINT

* SEE SHEET 16 FOR SIDEROAD DETAILS

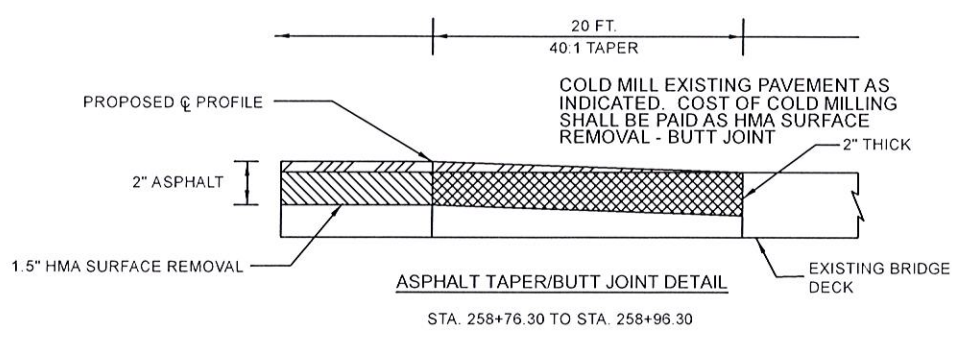
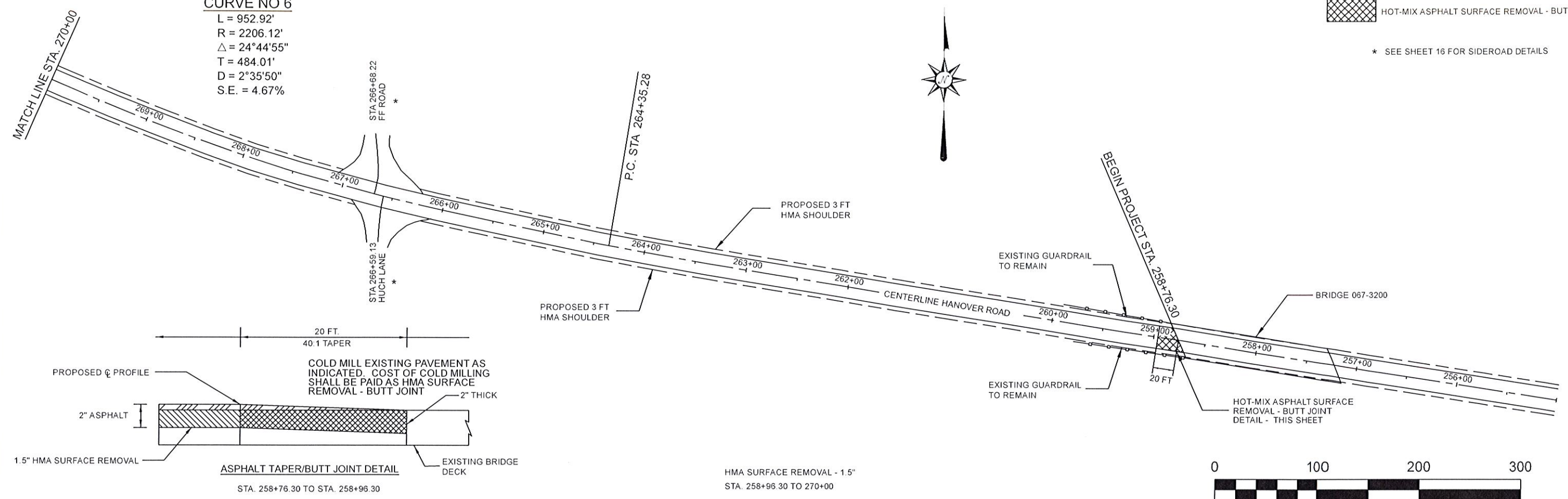

HMA SURFACE REMOVAL - 1.5"
 STA. 258+96.30 TO 270+00

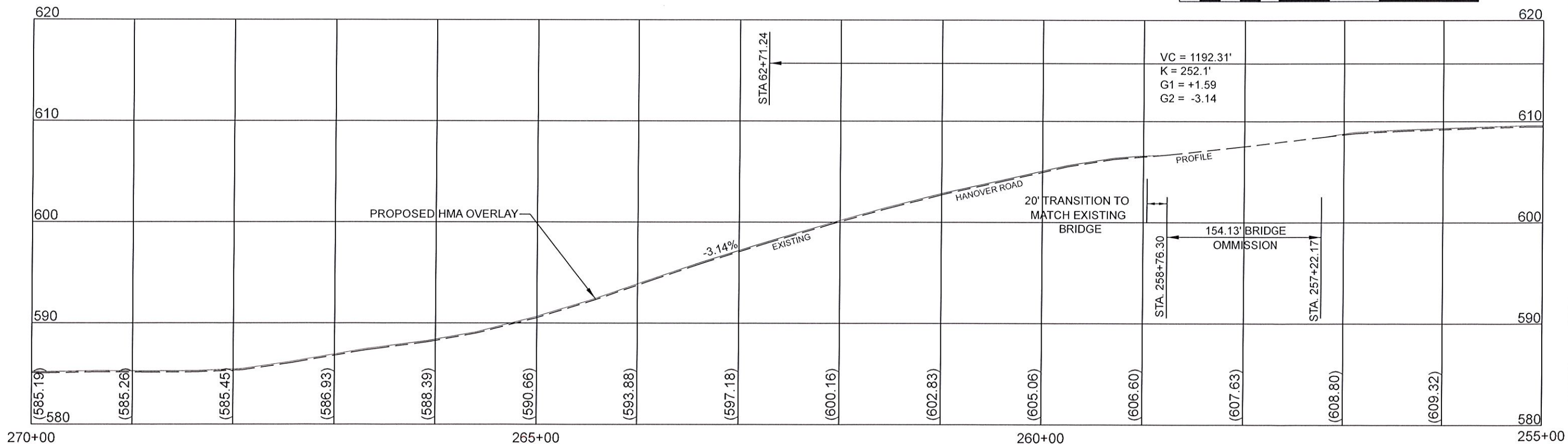

DRAWING FILE: S:\HANOVER ROAD RESURFACING 2019\Phase II\Hanover Resurfacing Plan and Profile Phase II

USER NAME =	DESIGNED -	REVISED -
PLOT SCALE = 100 000' / in.	DRAWN -	REVISED -
PLOT DATE =	CHECKED -	REVISED -
	DATE -	REVISED -

MONROE COUNTY
 HIGHWAY DEPARTMENT

PLAN AND PROFILE - PHASE II RESURFACING

SCALE: 1" = 100' SHEET 1 OF 8 SHEETS STA. 258+76.30 TO STA. 270+00

F.A.S. RTE #34 C.H. 8	SECTION 18-00052-06-RS	COUNTY MONROE	TOTAL SHEETS 16	SHEET NO. 7
ILLINOIS FED AID PROJECT			CONTRACT NO. 97748	

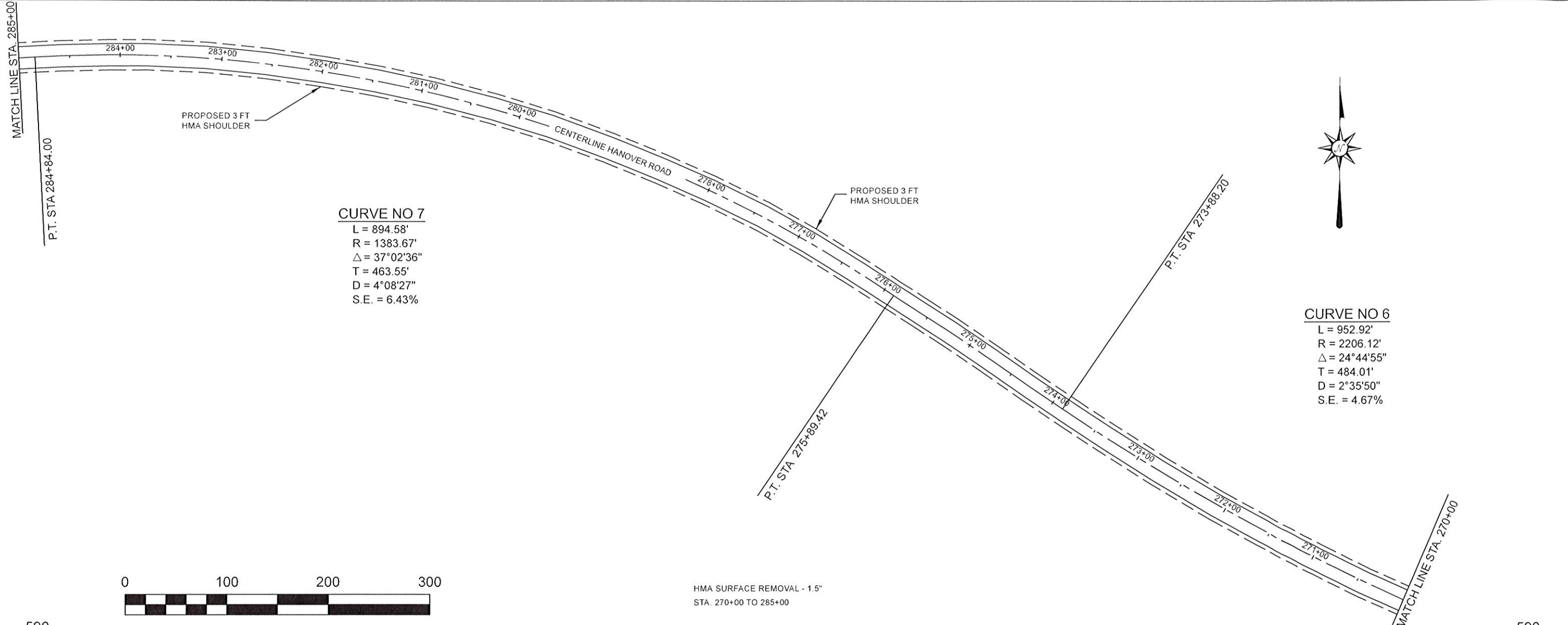

HMA SURFACE REMOVAL - 1.5"
STA. 270+00 TO 285+00

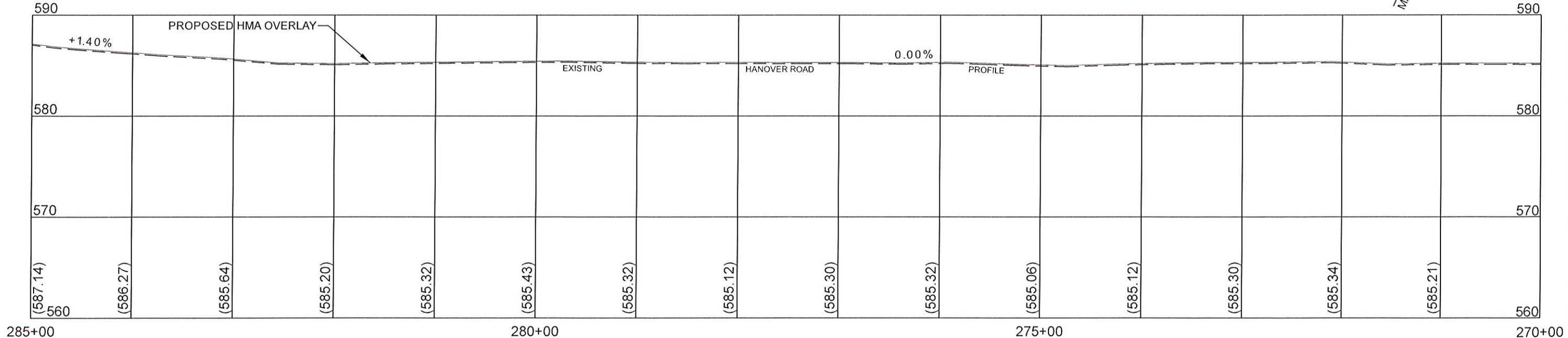

DRAWING FILE: S:\HANOVER ROAD RESURFACING 2018\Phase II\Hanover Resurfacing Plan and Profile Phase II

USER NAME =	DESIGNED -	REVISED -
	DRAWN -	REVISED -
PLOT SCALE = 100 000' / in.	CHECKED -	REVISED -
PLOT DATE =	DATE -	REVISED -

MONROE COUNTY
HIGHWAY DEPARTMENT

PLAN AND PROFILE - PHASE II RESURFACING
SCALE: 1" = 100' SHEET 2 OF 8 SHEETS STA. 270+00 TO STA. 285+00

F.A.S. RTE. 854 C.H. 8	SECTION 18-00052-06-RS	COUNTY MONROE	TOTAL SHEETS 16	SHEET NO. 8
			CONTRACT NO. 97748	
ILLINOIS FED AID PROJECT				



CURVE NO 8
 L = 507.71'
 R = 2046.77'
 Δ = 11°24'47"
 T = 204.53'
 D = 2°47'58"
 S.E. = 4.3%

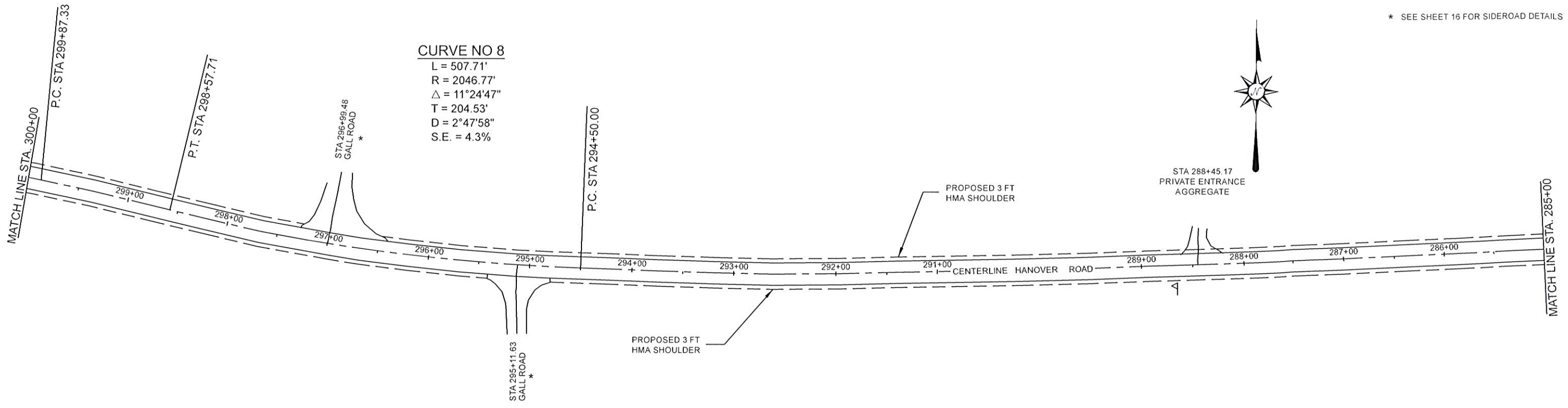

HMA SURFACE REMOVAL - 1.5"
 STA. 285+00 TO 300+00

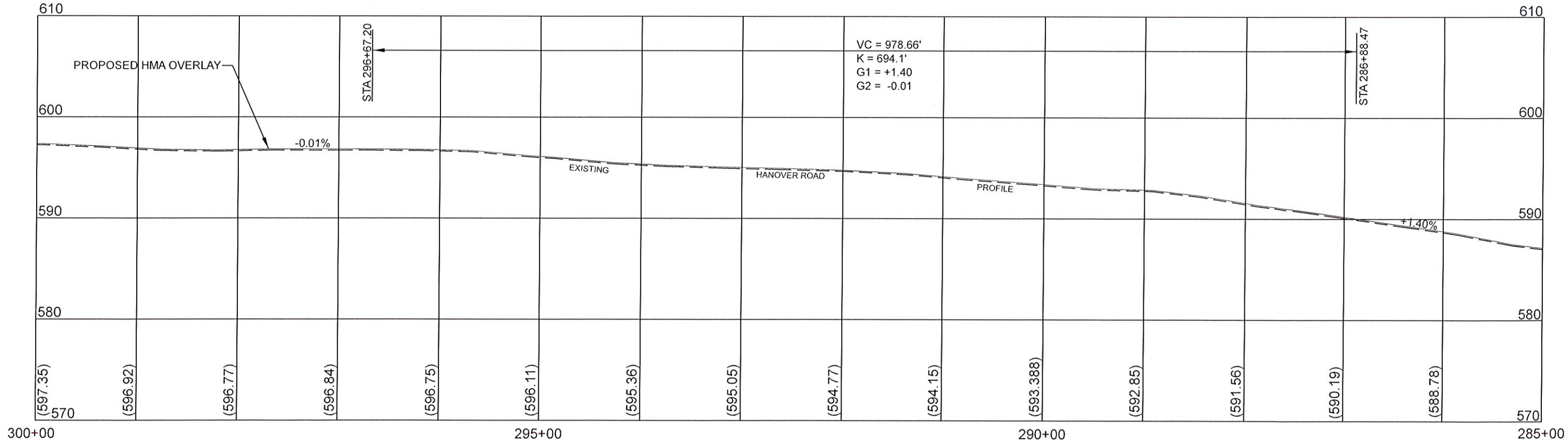

DRAWING FILE: S:\HANOVER ROAD RESURFACING 2019\Phase II\Hanover Resurfacing Plan and Profile Phase II

USER NAME =	DESIGNED -	REVISED -	
	DRAWN -	REVISED -	
PLOT SCALE = 100.000' / in.	CHECKED -	REVISED -	
PLOT DATE =	DATE -	REVISED -	

MONROE COUNTY
 HIGHWAY DEPARTMENT

PLAN AND PROFILE - PHASE II RESURFACING

SCALE: 1" = 100' SHEET 3 OF 8 SHEETS STA. 285+00 TO STA. 300+00

F.A.S. RTE 854 C.H. 8	SECTION 18-00052-06-RS	COUNTY MONROE	TOTAL SHEETS 16	SHEET NO. 9	CONTRACT NO. 97748
ILLINOIS FED AID PROJECT					

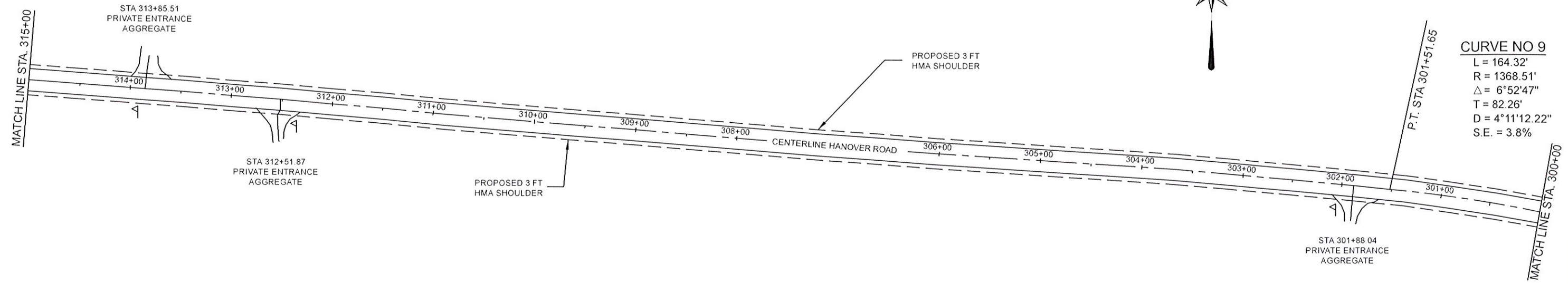

HMA SURFACE REMOVAL - 1.5"
STA. 300+00 TO 315+00

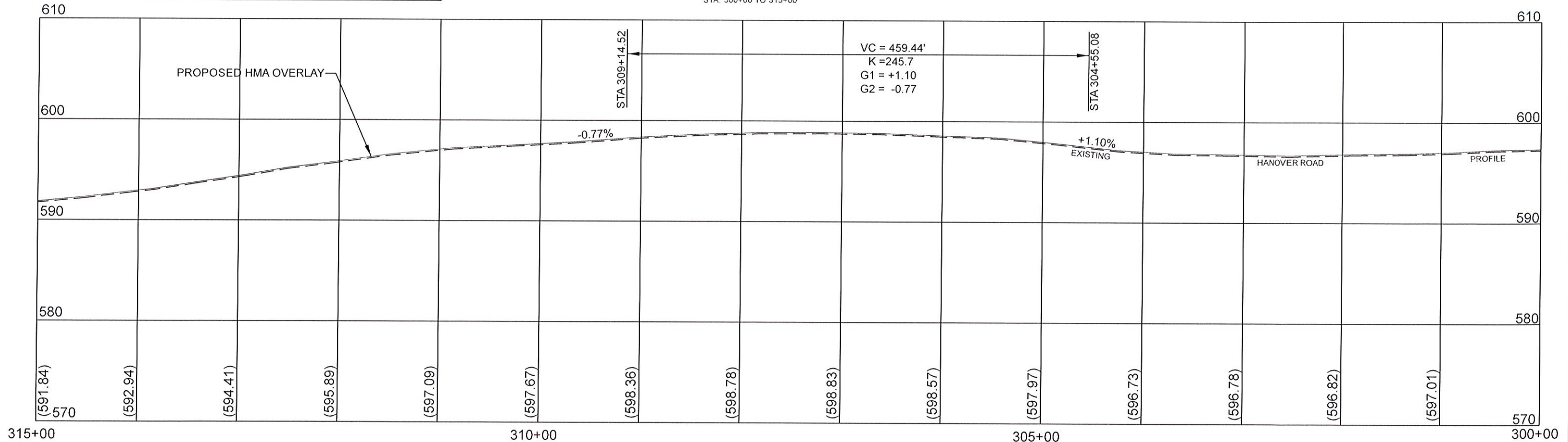

DRAWING FILE: S:\HANOVER ROAD RESURFACING 2019\Phase II\Hanover Resurfacing Plan and Profile Phase II

USER NAME =	DESIGNED -	REVISED -
PLOT SCALE = 100' 000' / in	DRAWN -	REVISED -
PLOT DATE =	CHECKED -	REVISED -
	DATE -	REVISED -

MONROE COUNTY
HIGHWAY DEPARTMENT

PLAN AND PROFILE - PHASE II RESURFACING

SCALE: 1" = 100' SHEET 4 OF 8 SHEETS STA. 300+00 TO STA. 315+00

F.A.S. RTE. 854 C.H. 8	SECTION 18-00052-06-RS	COUNTY MONROE	TOTAL SHEETS 16	SHEET NO. 10
CONTRACT NO. 97748			ILLINOIS FED. AID PROJECT	

* SEE SHEET 16 FOR SIDEROAD DETAILS

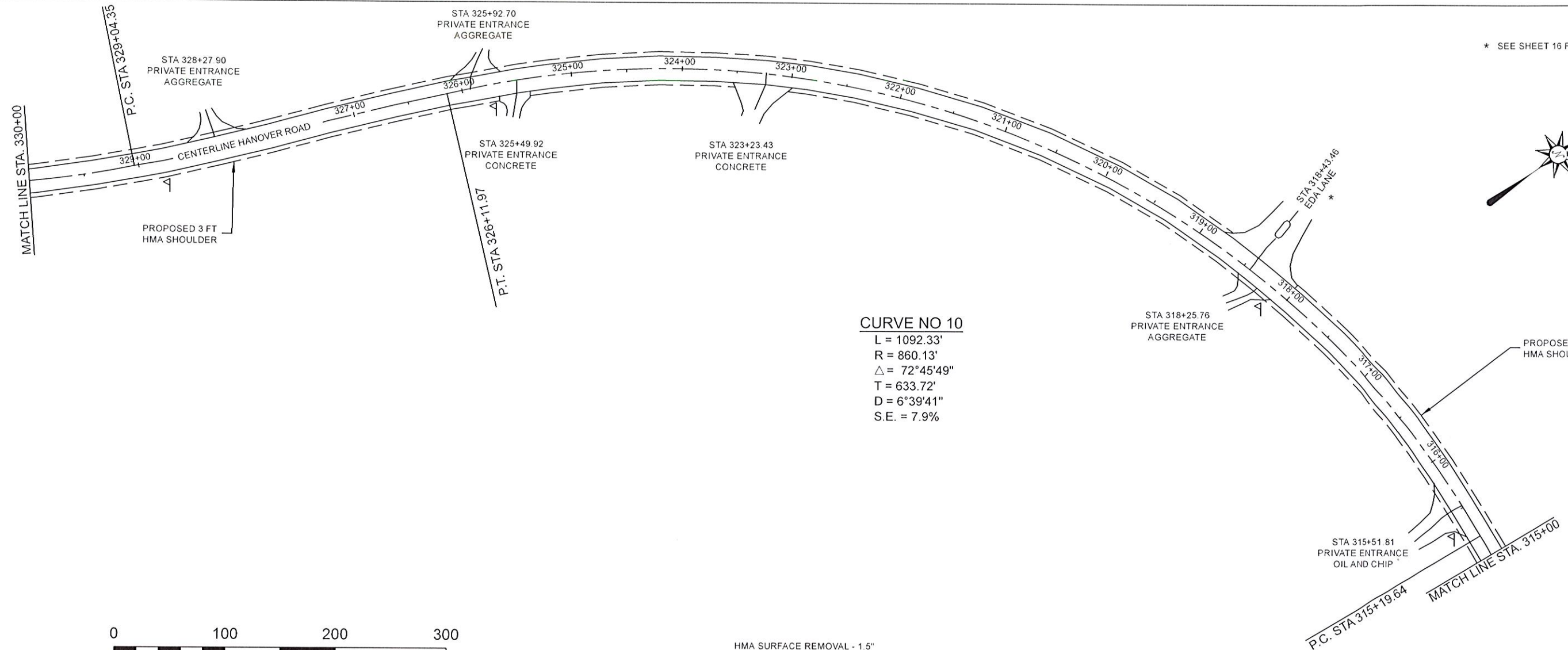
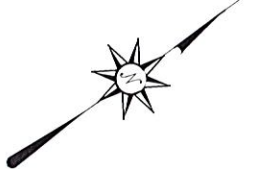

HMA SURFACE REMOVAL - 1.5"
 STA. 315+00 TO 330+00

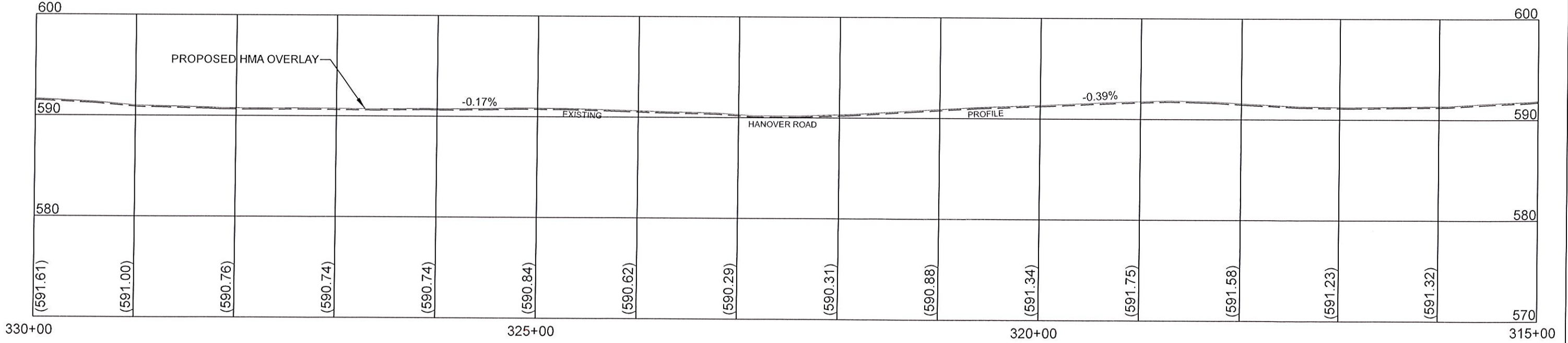

DRAWING FILE: S:\HANOVER ROAD RESURFACING 2019\Phase II\Hanover Resurfacing Plan and Profile Phase II

USER NAME =	DESIGNED -	REVISED -
PLOT SCALE = 100 000' / in.	DRAWN -	REVISED -
PLOT DATE =	CHECKED -	REVISED -
	DATE -	REVISED -

MONROE COUNTY
 HIGHWAY DEPARTMENT

PLAN AND PROFILE - PHASE II RESURFACING
 SCALE: 1" = 100' SHEET 5 OF 8 SHEETS STA. 315+00 TO STA. 330+00

F.A.S. RTE. 854 C.H. 8	SECTION 18-00052-06-RS	COUNTY MONROE	TOTAL SHEETS 16	SHEET NO. 11
CONTRACT NO. 97748			ILLINOIS FED AID PROJECT	



CURVE NO 11

L = 848.71'
 R = 797.87'
 $\Delta = 60^{\circ}56'48''$
 T = 469.48'
 D = 7^{\circ}10'52''
 S.E. = 8.0%

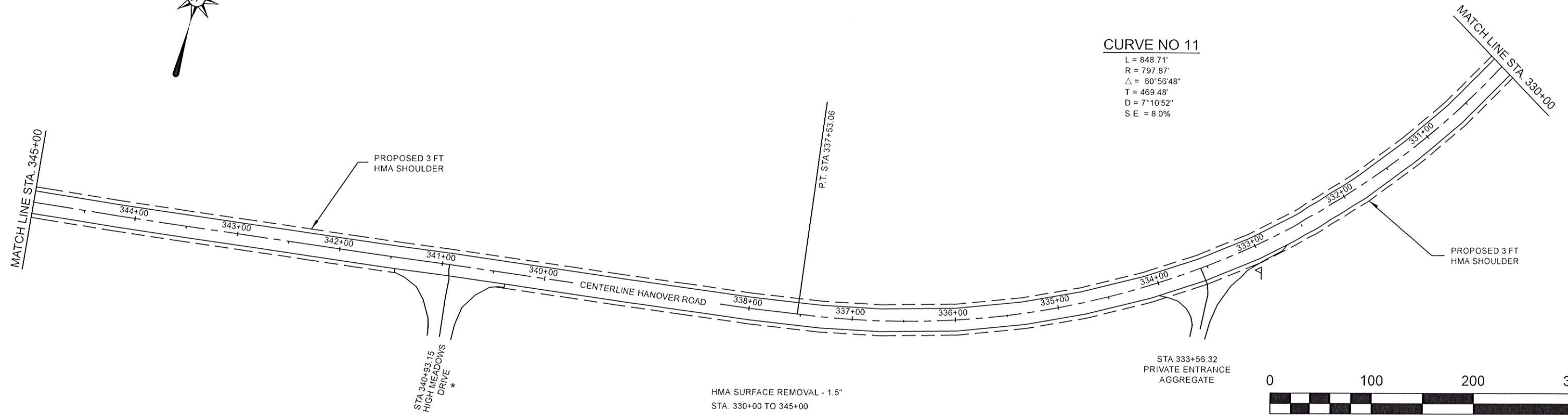

HMA SURFACE REMOVAL - 1.5"
 STA. 330+00 TO 345+00

VC = 657.08'
 K = 353.3
 G1 = -0.03
 G2 = -1.89

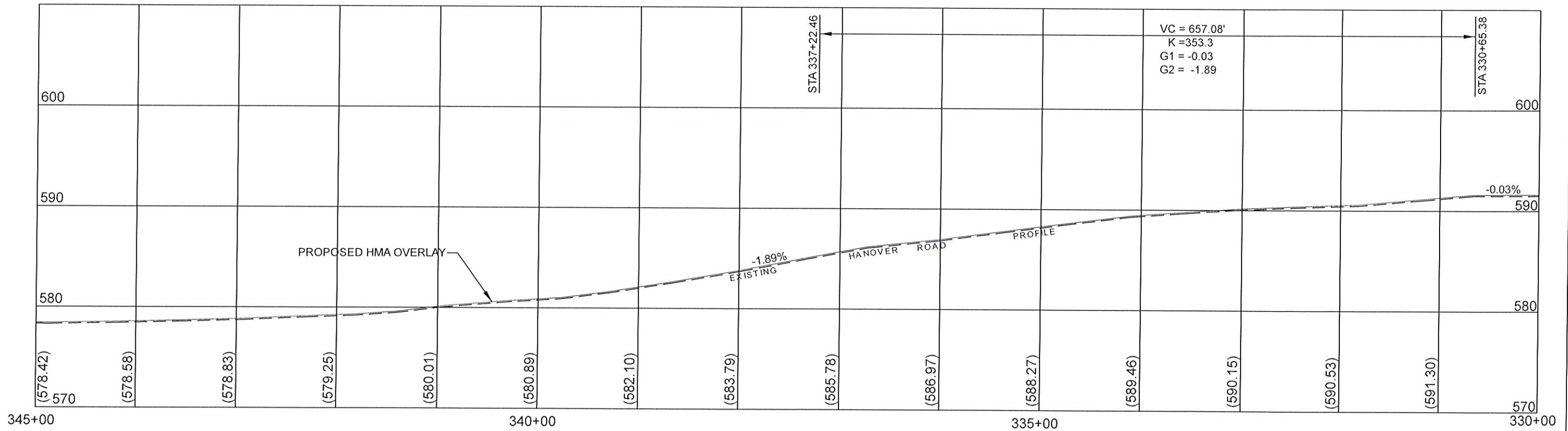

DRAWING FILE: S:\HANOVER ROAD RESURFACING 2019\Phase II\Hanover Resurfacing Plan and Profile Phase II

USER NAME =	DESIGNED -	REVISED -
PLOT SCALE = 100,000' / in.	DRAWN -	REVISED -
PLOT DATE =	CHECKED -	REVISED -
	DATE -	REVISED -

MONROE COUNTY
 HIGHWAY DEPARTMENT

PLAN AND PROFILE - PHASE II RESURFACING

SCALE: 1" = 100' SHEET 6 OF 8 SHEETS STA. 330+00 TO STA. 345+00

F.A.S. RTE. 854 C.H. 8	SECTION 18-00052-06-RS	COUNTY MONROE	TOTAL SHEETS 16	SHEET NO. 12
CONTRACT NO. 97748				ILLINOIS FED AID PROJECT



CURVE NO 13

L = 292.45'
 R = 1764.11'
 $\Delta = 9^{\circ}29'11''$
 T = 146.56'
 D = 3^{\circ}14'52''
 S.E. = 4.8%

CURVE NO 12

L = 262.48'
 R = 2168.56'
 $\Delta = 6^{\circ}56'06''$
 T = 131.40'
 D = 2^{\circ}38'32''
 S.E. = 2.85%

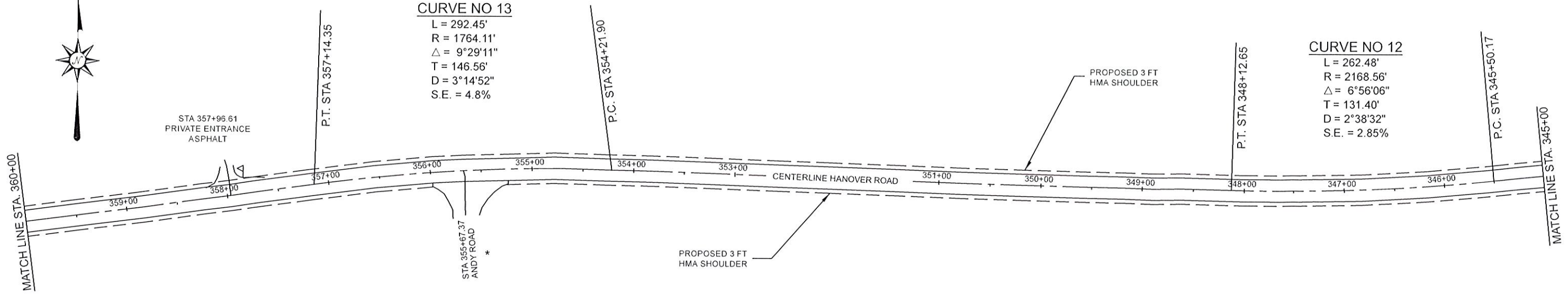

HMA SURFACE REMOVAL - 1.5"
 STA. 345+00 TO 360+00

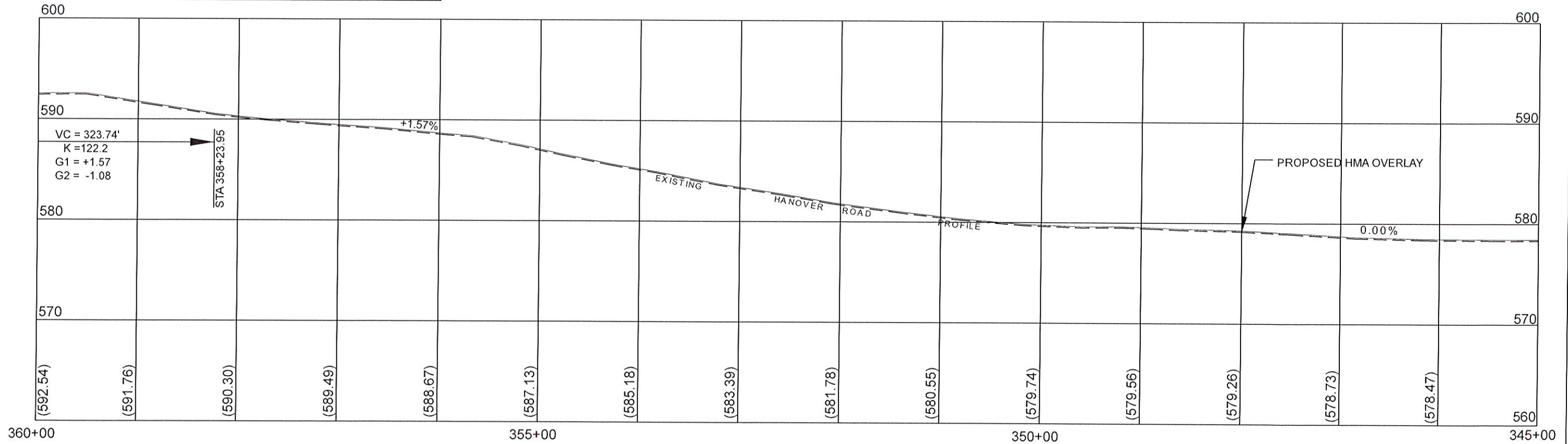

DRAWING FILE: S:\HANOVER ROAD RESURFACING 2019\Phase II\Hanover Resurfacing Plan and Profile Phase II

USER NAME =	DESIGNED -	REVISED -
PLOT SCALE = 100'000' / in	DRAWN -	REVISED -
PLOT DATE =	CHECKED -	REVISED -
	DATE -	REVISED -

MONROE COUNTY
 HIGHWAY DEPARTMENT

PLAN AND PROFILE - PHASE II RESURFACING

SCALE: 1" = 100' SHEET 7 OF 8 SHEETS STA. 345+00 TO STA. 360+00

F.A.S. RTE.	SECTION	COUNTY	TOTAL SHEETS	SHEET NO.
854 C.H. 8	18-00052-06-RS	MONROE	16	13
CONTRACT NO. 97748			ILLINOIS FED AID PROJECT	



HOT-MIX ASPHALT SURFACE REMOVAL - BUTT JOINT

* SEE SHEET 16 FOR SIDEROAD DETAILS

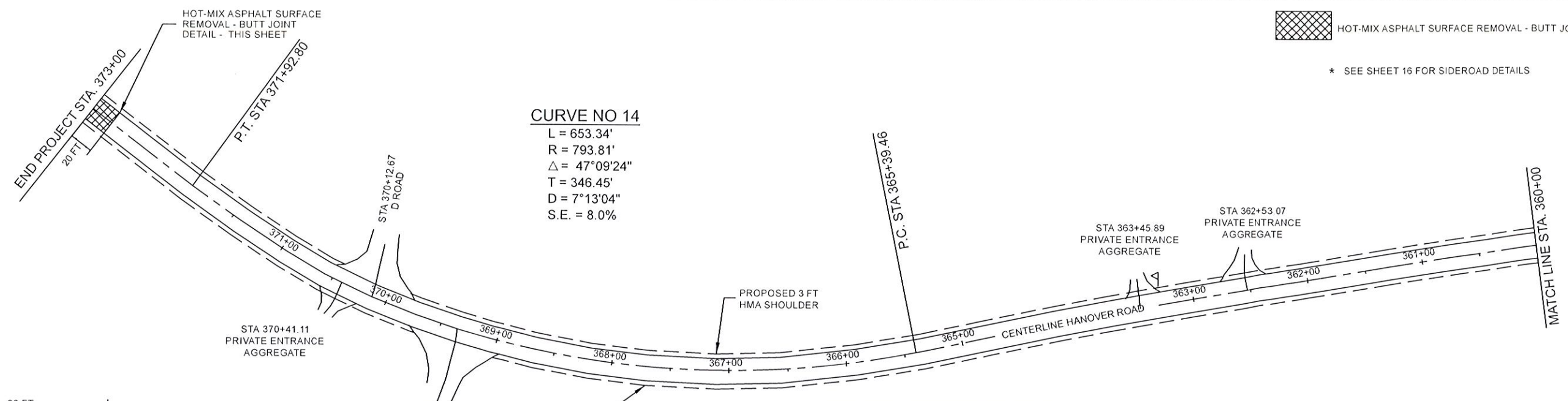

CURVE NO 14
 L = 653.34'
 R = 793.81'
 $\Delta = 47^{\circ}09'24''$
 T = 346.45'
 D = $7^{\circ}13'04''$
 S.E. = 8.0%

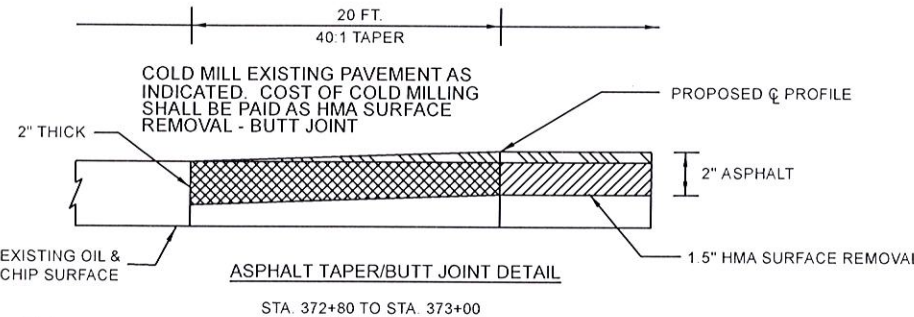

PROFILE CORRECTION		
STATION	HMA SURFACE THICKNESS (INCH)	HMA BINDER THICKNESS (INCH)
363+00	2.0	0.0
364+00	2.0	1.7
365+00	2.0	2.5
366+00	2.0	2.5
367+00	2.0	3.8
368+00	2.0	5.2
369+00	2.0	4.7
370+00	1.5	0.0
371+00	2.0	3.6
372+00	2.0	8.5
373+00	2.0	0.0

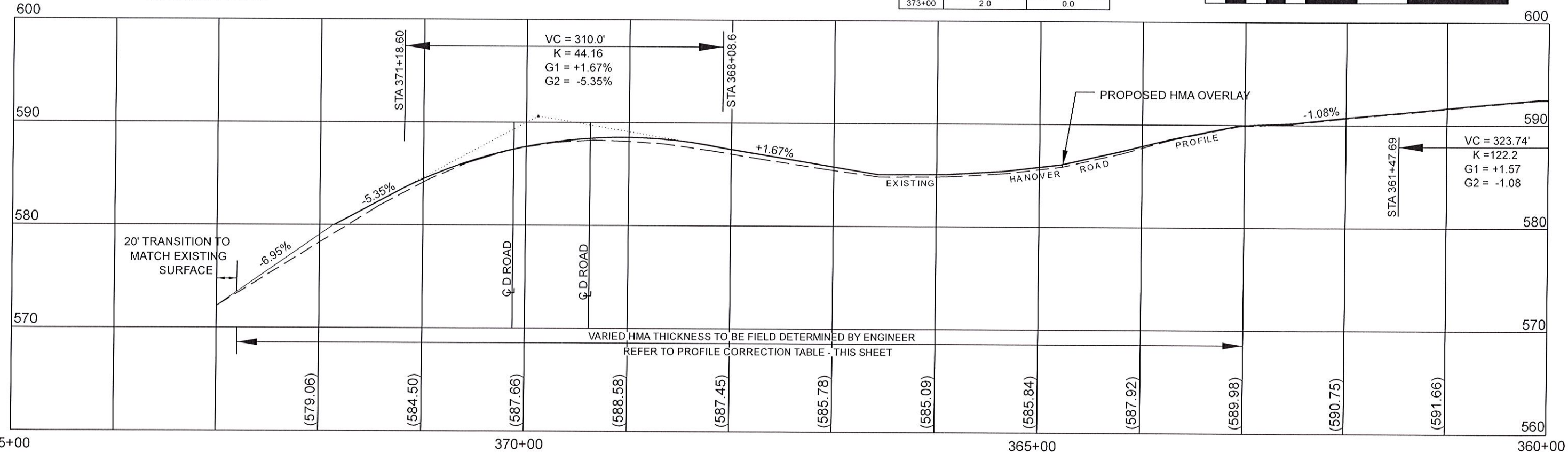

DRAWING FILE: S:\HANOVER ROAD RESURFACING 2019\Phase II\Hanover Resurfacing Plan and Profile Phase II

USER NAME =	DESIGNED -	REVISED -
PLOT SCALE = 100 000 / in.	DRAWN -	REVISED -
PLOT DATE =	CHECKED -	REVISED -
	DATE -	REVISED -

MONROE COUNTY
HIGHWAY DEPARTMENT

PLAN AND PROFILE - PHASE II RESURFACING
 SCALE: 1" = 100' SHEET 8 OF 8 SHEETS STA. 360+00 TO STA. 373+00

F.A.S. RTE 854 C.H. 8	SECTION 18-00052-06-RS	COUNTY MONROE	TOTAL SHEETS 16	SHEET NO. 14
				CONTRACT NO. 97748
ILLINOIS FED AID PROJECT				

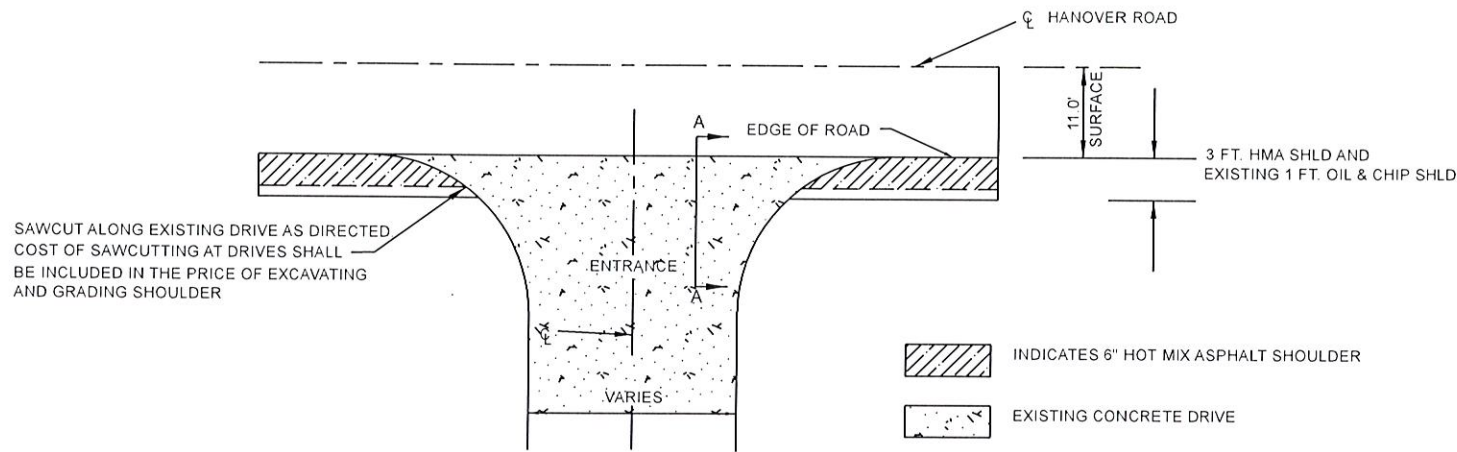

SAWCUT ALONG EXISTING DRIVE AS DIRECTED
COST OF SAWCUTTING AT DRIVES SHALL
BE INCLUDED IN THE PRICE OF EXCAVATING
AND GRADING SHOULDER

INDICATES 6" HOT MIX ASPHALT SHOULDER
EXISTING CONCRETE DRIVE

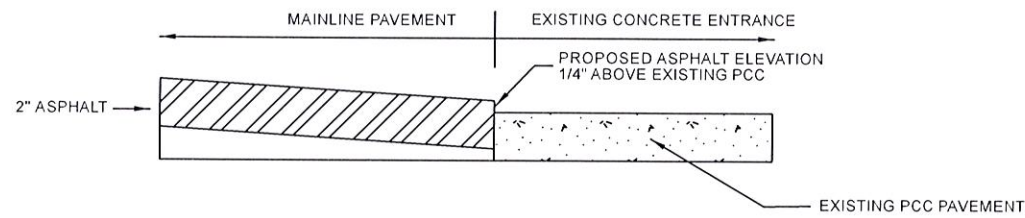

SECTION A-A
TYPICAL SECTION PRIVATE CONCRETE ENTRANCES

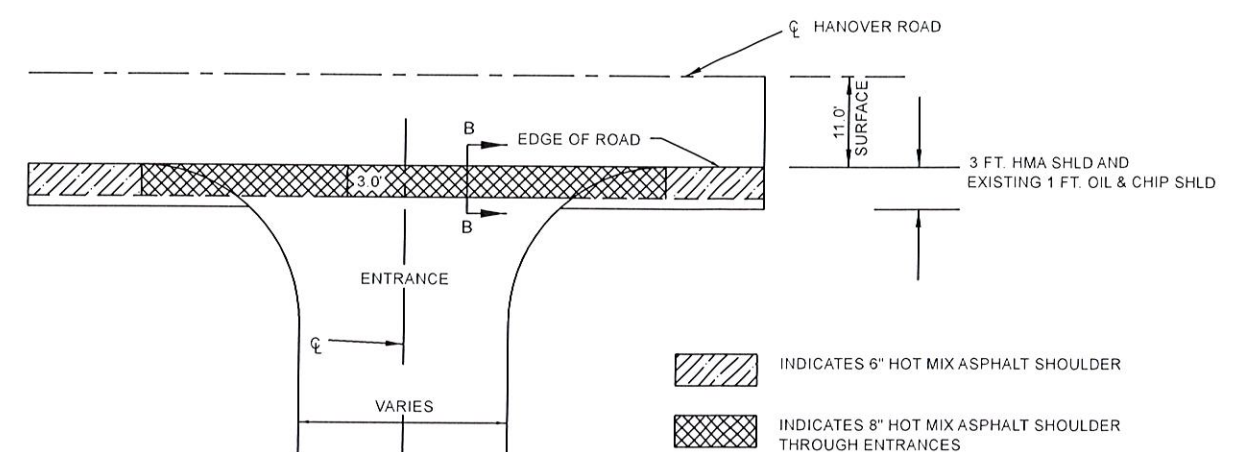

INDICATES 6" HOT MIX ASPHALT SHOULDER
INDICATES 8" HOT MIX ASPHALT SHOULDER
THROUGH ENTRANCES

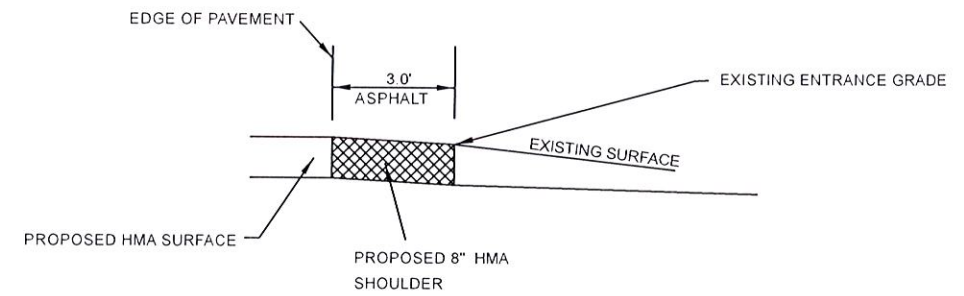

SECTION B-B
TYPICAL SECTION ENTRANCE
ASPHALT, OIL & CHIP AND AGGREGATE DRIVES

ENTRANCE SCHEDULE

LOCATION	SIDE	EXISTING SURFACE	TYPE OF ENTRANCE	WIDTH	LENGTH
STATION	LT/RT			FOOT	FOOT
288+45.17	RT	AGGREGATE	PRIVATE	14	0
301+88.04	LT	AGGREGATE	PRIVATE	12	0
312+51.87	LT	AGGREGATE	PRIVATE	12	0
313+85.51	RT	AGGREGATE	PRIVATE	17.5	0
315+51.81	LT	OIL & CHIP	PRIVATE	18	0
318+25.76	LT	AGGREGATE	PRIVATE	14	0
323+23.43	LT	CONCRETE	PRIVATE	18	0
325+49.92	LT	CONCRETE	PRIVATE	12	0
325+92.70	RT	AGGREGATE	PRIVATE	12	0
328+27.90	RT	AGGREGATE	PRIVATE	12	0
333+56.32	LT	AGGREGATE	PRIVATE	15	0
357+96.61	RT	ASPHALT	PRIVATE	13	0
362+53.07	RT	AGGREGATE	PRIVATE	12	0
363+45.89	RT	AGGREGATE	PRIVATE	12.5	0
370+41.11	LT	AGGREGATE	PRIVATE	13.5	0

DRAWING FILE: S:\HANOVER ROAD RESURFACING 2019\Phase II\Hanover Resurfacing Plan and Profile Phase II

USER NAME =	DESIGNED -	REVISED -
PLOT SCALE = 100 000' / in.	DRAWN -	REVISED -
PLOT DATE =	CHECKED -	REVISED -
	DATE -	REVISED -

MONROE COUNTY
HIGHWAY DEPARTMENT

ENTRANCE SCHEDULE AND DETAILS

SCALE: NTS SHEET 1 OF 1 SHEETS STA. TO STA.

F.A.S. RTE. 554 C.H.S.	SECTION 18-00052-06-RS	COUNTY MONROE	TOTAL SHEETS 16	SHEET NO. 15
CONTRACT NO. 97748				ILLINOIS FED. AID PROJECT

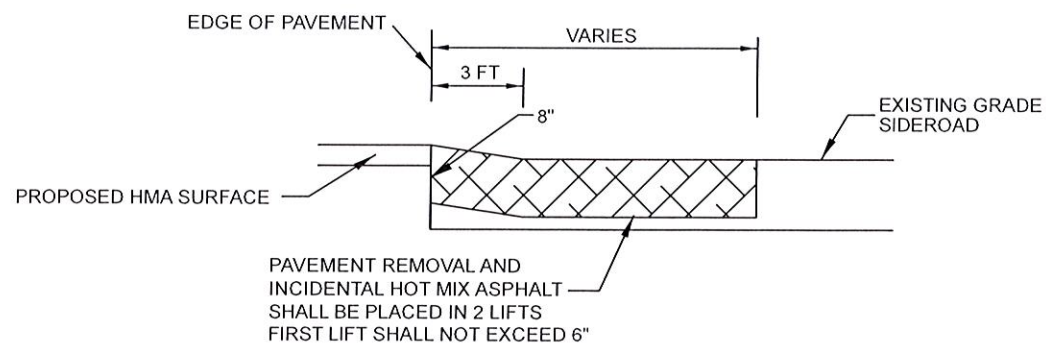
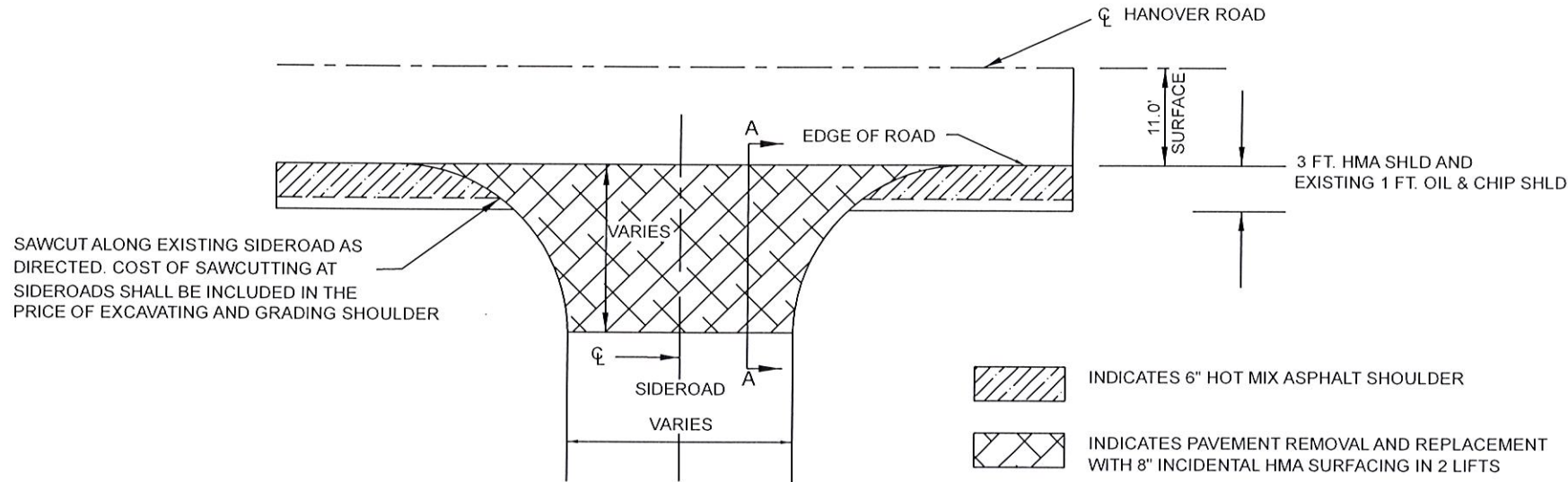

SECTION A-A
TYPICAL SECTION SIDEROAD

SIDEROAD SCHEDULE							
ROAD NAME	LOCATION	SIDE	WIDTH	LENGTH	INCIDENTAL HOT-MIX ASPHALT SURFACING	PAVEMENT REMOVAL	BITUMNIOUS MATERIALS (TACK COAT)
	STATION	LT/RT	FOOT	FOOT	TON	SQUARE YARD	LB
HUCH LANE	266+59.13	LT	21.0	10.0	21.5	48.1	21.7
FF ROAD	266+68.22	RT	24.0	10.0	25.4	56.7	25.5
GALL ROAD	295+11.63	LT	20.0	15.0	30.7	68.8	30.9
GALL ROAD	296+99.48	RT	22.0	18.5	48.3	107.9	48.7
EDA LANE	318+43.46	RT	30.0	13.0	34.0	75.8	34.1
HIGH MEADOWS DRIVE	340+93.15	LT	22.0	13.0	39.5	88.1	39.8
ANDY ROAD	355+67.37	LT	24.0	10.0	24.4	54.4	24.5
D ROAD	369+35.24	LT	25.0	15.0	36.2	80.7	36.5
D ROAD	370+12.67	RT	22.0	15.5	32.0	71.5	32.3
					292.0	652.0	294.0

DRAWING FILE: S:\HANOVER ROAD RESURFACING 2019\Phase II\Hanover Resurfacing Plan and Profile Phase II

USER NAME =	DESIGNED -	REVISED -
PLOT SCALE = 100 000' / in	DRAWN -	REVISED -
PLOT DATE =	CHECKED -	REVISED -
	DATE -	REVISED -

MONROE COUNTY
HIGHWAY DEPARTMENT

SIDEROAD SCHEDULE AND DETAILS

SCALE NTS SHEET 1 OF 1 SHEETS STA. TO STA.

F.A.S. RTE. 554 C.H. 8	SECTION 18-00052-06-RS	COUNTY MONROE	TOTAL SHEETS 16	SHEET NO. 16
				CONTRACT NO. 97748
ILLINOIS FED. AID PROJECT				