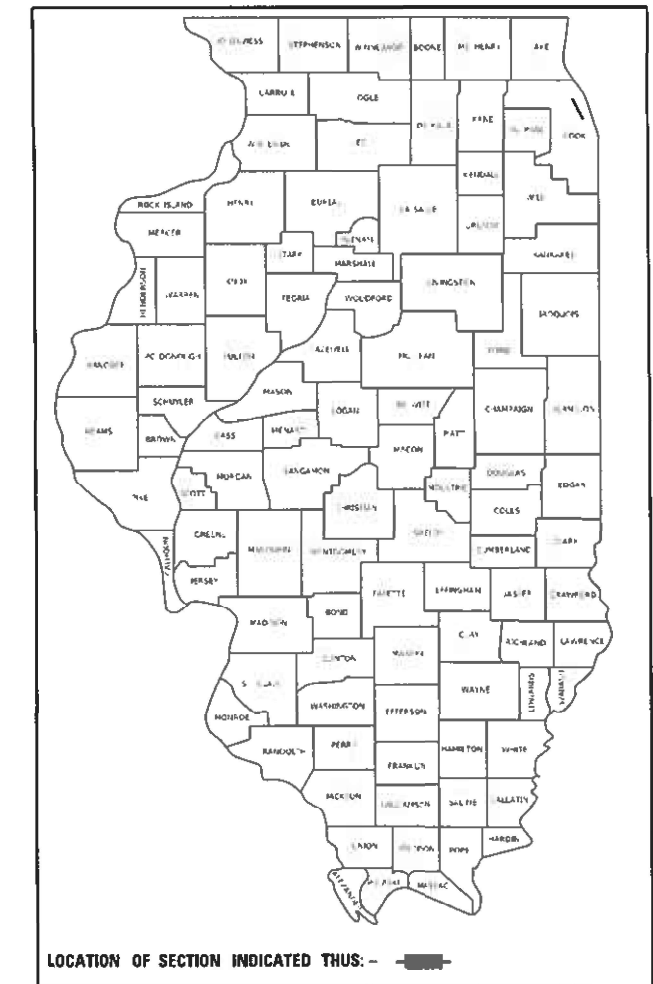


STATE OF ILLINOIS  
DEPARTMENT OF TRANSPORTATION

F.A.U. RTE	SECTION	COUNTY	TOTAL SHEETS	SHEET NO.
3729	2020-074-1	COOK	14	1
ILLINOIS			CONTRACT NO. 62L52	

\* 14 + 1 = 15 TOTAL SHEETS

D-91-473-20



LOCATION OF SECTION INDICATED THIS: - [Symbol] -

FOR INDEX OF SHEETS, SEE SHEET NO. 2

THE IMPROVEMENT IS LOCATED  
IN THE CITY OF CHICAGO

# PROPOSED HIGHWAY PLANS

FAU ROUTE 3729: LINCOLN AVE  
DIVERSEY PKWY TO WELLS ST  
SECTION: 2020-074-1  
CRACK AND JOINT SEALING  
COOK COUNTY

C-91-271-20

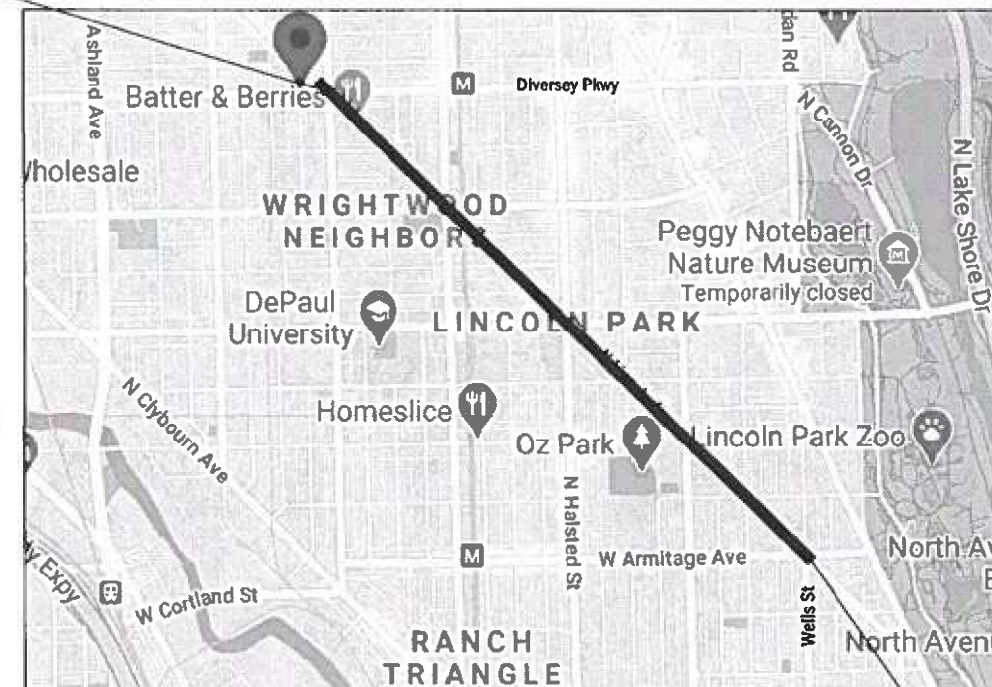
TRAFFIC DATA

2018 ADT = 10300

POSTED SPEED LIMIT = 30 MPH

PROJECT BEGINS  
STA 11+58

R 14 E



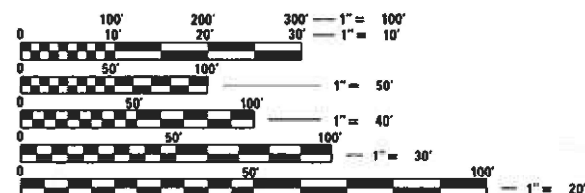
T 40 N

LAKE AND NORTH CHICAGO TOWNSHIPS



PROJECT ENDS  
STA 105+65.5

GROSS LENGTH = 9304 FT. = 1.762 MILE



FULL SIZE PLANS HAVE BEEN PREPARED USING STANDARD ENGINEERING SCALES. REDUCED SIZED PLANS WILL NOT CONFORM TO STANDARD SCALES. IN MAKING MEASUREMENTS ON REDUCED PLANS, THE ABOVE SCALES MAY BE USED.

C.U.A.N.  
CHICAGO UTILITY ALERT NETWORK  
(312) 744-7000

PROJECT MANAGER: J. ALAIN MIDY (847) 221-3056

CONTRACT NO. 62L52

STATE OF ILLINOIS  
DEPARTMENT OF TRANSPORTATION

SUBMITTED March 4, 2021  
Jose Rios REGIONAL ENGINEER  
March 19, 2021  
[Signature] ENGINEER OF DESIGN AND ENVIRONMENT  
March 19, 2021  
[Signature] DIRECTOR OF HIGHWAYS PROJECT IMPLEMENTATION

PRINTED BY THE AUTHORITY  
OF THE STATE OF ILLINOIS

**INDEX OF SHEETS**

<u>SHEET NO.</u>	<u>DESCRIPTION</u>
1	TITLE SHEET
2	INDEX OF SHEETS, STATE STANDARDS AND GENERAL NOTES
3	SUMMARY OF QUANTITIES
4-7	PROPOSED PLANS AND PAVEMENT MARKING PLANS
8	CRACK & JOINT SEALING DETAIL
9	TRAFFIC CONTROL AND PROTECTION FOR SIDE ROADS, INTERSECTIONS, AND DRIVEWAYS (TC-10)
10	TRAFFIC CONTROL AND PROTECTION AT TURN BAYS (TO REMAIN OPEN TO TRAFFIC) (TC-14)
11	ARTERIAL ROAD INFORMATION SIGNING (TC-22)
12-14	CITY OF CHICAGO TYPICAL PAVEMENT MARKINGS (TC-24)
14A	DRIVEWAY ENTRANCE SIGNING (TC-26)

**STANDARDS**

701006-05	OFF ROAD OPERATIONS, 2L, 2W, 15' TO 24" FROM PAVEMENT EDGE
701011-04	OFF ROAD MOVING OPERATIONS, 2L, 2W, DAY ONLY
701301-04	LANE CLOSURE, 2L, 2W, SHORT TIME OPERATIONS
701311-03	LANE CLOSURE, 2L, 2W, MOVING OPERATIONS-DAY ONLY
701501-06	URBAN LANE CLOSURE, 2L, 2W UNDIVIDED
701701-10	URBAN SINGLE LANE CLOSURE, MULTILANE INTERSECTION
701801-06	SIDEWALK, CORNER OR CROSSWALK CLOSURE
701901-08	TRAFFIC CONTROL DEVICES

**GENERAL NOTES**

BEFORE STARTING ANY EXCAVATION, THE CONTRACTOR SHALL CALL "C.U.A.N." (CHICAGO UTILITY ALERT NETWORK) AT (312) 744-7000 FOR FIELD LOCATIONS OF BURIED ELECTRIC, TELEPHONE AND GAS UTILITIES. 48 HOUR NOTIFICATION IS REQUIRED.

THE CONTRACTOR SHALL COORDINATE CONSTRUCTION ACTIVITIES WITH UTILITY COMPANIES AND THE CITY OF CHICAGO.

ALL DAMAGE TO EXISTING PAVEMENT MARKINGS OR RAISED REFLECTIVE PAVEMENT MARKERS OUTSIDE THE REMOVAL LINE SHOWN ON THE PLANS SHALL BE REPLACED AT NO ADDITIONAL COST TO THE DEPARTMENT.

BEFORE BEGINING ANY WORK, THE CONTRACTOR SHALL RETAIN AND RECORD FOR FUTURE REFERENCE, ALL EXISTING PAVEMENT MARKING LINES (AND RAISED REFLECTIVE PAVEMENT MARKERS) IN ORDER THAT THESE LOCATIONS CAN BE RE-ESTABLISHED FOR STRIPPING. EXACT LOCATIONS OF ALL PAVEMENT MARKINGS SHALL BE AS DIRECTED BY THE ENGINEER.

THE CONTRACTOR WILL NOT BE ALLOWED TO SET UP A YARD OR FIELD OFFICE ON STATE PROPERTY WITHOUT WRITTEN PERMISSION FROM THE DEPARTMENT.

IT SHALL BE THE CONTRACTOR'S RESPONSIBILITY TO VERIFY ALL DIMENSIONS AND CONDITIONS EXISTING IN THE FIELD PRIOR TO CONSTRUCTION AND ORDERING OF MATERIALS.

THE CONTRACTOR SHALL CONTACT THE DISTRICT ONE TRAFFIC CONTROL SUPERVISOR VIA EMAIL Kalpana.Kannan-Hosadurgo@illinois.gov A MINIMUM OF 72 HOURS IN ADVANCE OF BEGINNING WORK.

THE ENGINEER SHALL CONTACT EMAD ALHUSSEINI AREA TRAFFIC FIELD ENGINEER AT Emad.ALHusseini@illinois.gov A MINIMUM OF TWO (2) WEEKS PRIOR TO THE PLACEMENT OF PERMANENT PAVEMENT MARKINGS.

THE CONTRACTOR SHALL BE REQUIRED TO PROVIDE ACCESS TO ABUTTING PROPERTY AT ALL TIMES DURING THE CONSTRUCTION OF THIS PROJECT.

ALL CRACK ROUTING & CRACK SEALING LOCATIONS WILL BE DETERMINED IN THE FIELD BY THE ENGINEER. CRACK ROUTING SHALL BE OMITTED WHERE VEHICLE DETECTOR LOOPS & RAISED REFLECTIVE PAVEMENT MARKERS ARE PRESENT IN THE PAVEMENT.

ALL MATERIALS, OLD SEALANTS REMOVED PRIOR TO ROUTING SHALL BE DISPOSED AS SPECIFIED IN ARTICLE 202.03 OF THE STANDARD SPECIFICATIONS. THIS WORK WILL NOT BE PAID FOR SEPARATELY, BUT THE COST SHALL BE CONSIDERED AS INCLUDED IN THE CONTRACT UNIT PRICE FOR THE CONSTRUCTION ITEMS INVOLVED, AND NO ADDITIONAL COMPENSATION WILL BE ALLOWED.

MODIFIED URETHANE PAVEMENT MARKING SHALL BE PLACED IMMEDIATELY AFTER C & J SEALER TEMPERATURE HAS COOLED DOWN AND DOES NOT AFFECT THE APPLICATION OF MODIFIED URETHANE PAVEMENT MARKING.

DO NOT SCALE PLANS FOR CONSTRUCTION DIMENSIONS.

**STATE OF ILLINOIS  
DEPARTMENT OF TRANSPORTATION**

**INDEX OF SHEETS, STATE STANDARDS AND GENERAL NOTES  
LINCOLN AVE. (DIVERSEY PKWY TO WELLS ST.)**

F.A.U. RTE.	SECTION	COUNTY	TOTAL SHEETS	SHEET NO.
3729	2020-074-I	COOK	14	2
			CONTRACT NO. 62L52	
		ILLINOIS	FED. AID PROJECT	

SCALE: SHEET OF SHEETS STA. TO STA.

SUMMARY OF QUANTITIES			CONSTRUCTION TYPE CODE 0005						
CODE NO	ITEM	UNIT	URBAN TOTAL QUANTITIES 0005	100% STATE 0005					
45100100	CRACK ROUTING (PAVEMENT)	FOOT	45230	45230					
45100200	CRACK FILLING	POUND	12935	12935					
67000400	ENGINEER'S FIELD OFFICE, TYPE A	CAL MO	6	6					
67100100	MOBILIZATION	L SUM	1	1					
70102620	TRAFFIC CONTROL AND PROTECTION, STANDARD 701501	L SUM	1	1					
70102635	TRAFFIC CONTROL AND PROTECTION, STANDARD 701701	L SUM	1	1					
70102640	TRAFFIC CONTROL AND PROTECTION, STANDARD 701801	L SUM	1	1					
78009000	MODIFIED URETHANE PAVEMENT MARKING - LETTERS AND SYMBOLS	SO FT	4300	4300					
78009004	MODIFIED URETHANE PAVEMENT MARKING - LINE 4"	FOOT	6460	6460					
78009006	MODIFIED URETHANE PAVEMENT MARKING - LINE 6"	FOOT	15340	15340					
78009008	MODIFIED URETHANE PAVEMENT MARKING - LINE 8"	FOOT	400	400					
78009012	MODIFIED URETHANE PAVEMENT MARKING - LINE 12"	FOOT	350	350					

SUMMARY OF QUANTITIES			CONSTRUCTION TYPE CODE 0005						
CODE NO	ITEM	UNIT	URBAN TOTAL QUANTITIES 0005	100% STATE 0005					
78009024	MODIFIED URETHANE PAVEMENT MARKING - LINE 24"	FOOT	6800	6800					
Z0030850	TEMPORARY INFORMATION SIGNING	SO FT	102.8	102.8					

\* SPECIALTY ITEM

REV-SEP

MODEL: Default  
FILE: 2020-07-11 11:30:20  
C:\Users\gorengautab\OneDrive\Documents\Illinois\Projects\2020\07-11 11:30:20\2020-07-11 11:30:20.dwg

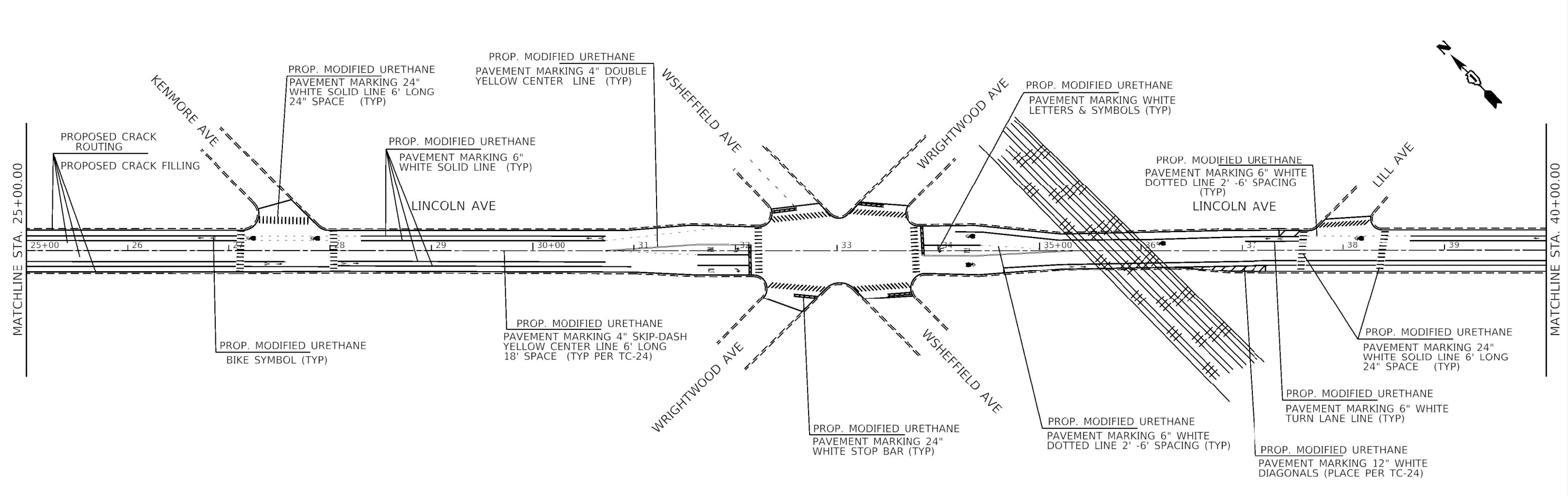
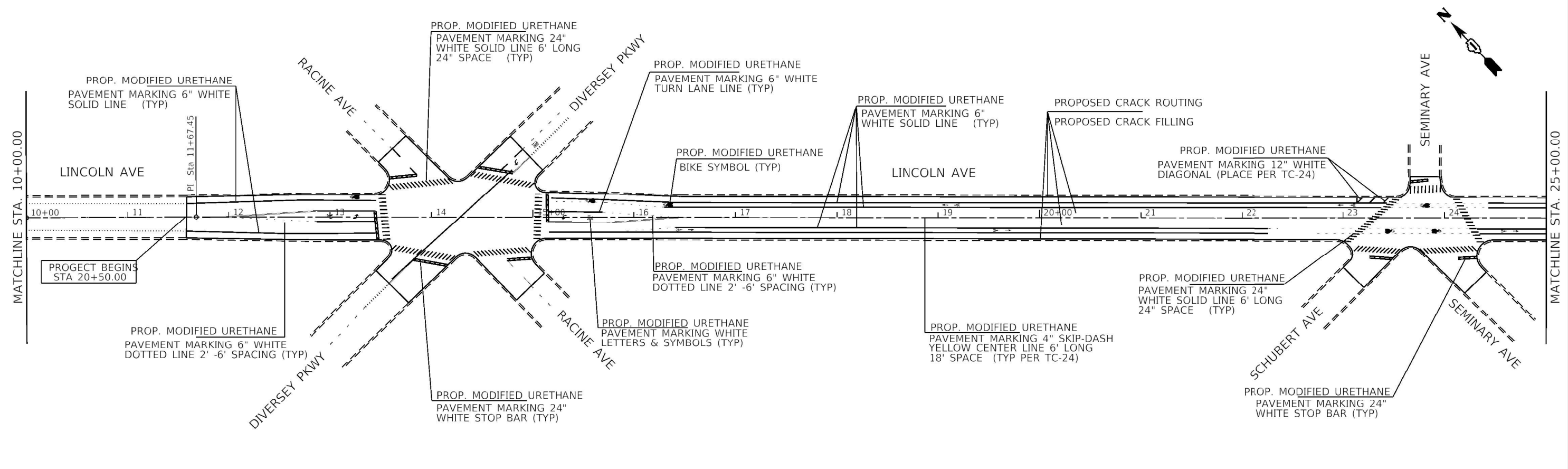
USER NAME = gorengautab	DESIGNED =	REVISED =
	DRAWN =	REVISED =
PLOT SCALE = 100.0000' / in.	CHECKED =	REVISED =
PLOT DATE = 11/30/2020	DATE =	REVISED =

**STATE OF ILLINOIS  
DEPARTMENT OF TRANSPORTATION**

**SUMMARY OF QUANTITIES**

SCALE: NONE SHEET OF SHEETS STA. TO STA.

F.A.U. RTE.	SECTION	COUNTY	TOTAL SHEETS	SHEET NO.
3729	2020-074-I	COOK	14	3
CONTRACT NO. 62L52			ILLINOIS FED. AID PROJECT	



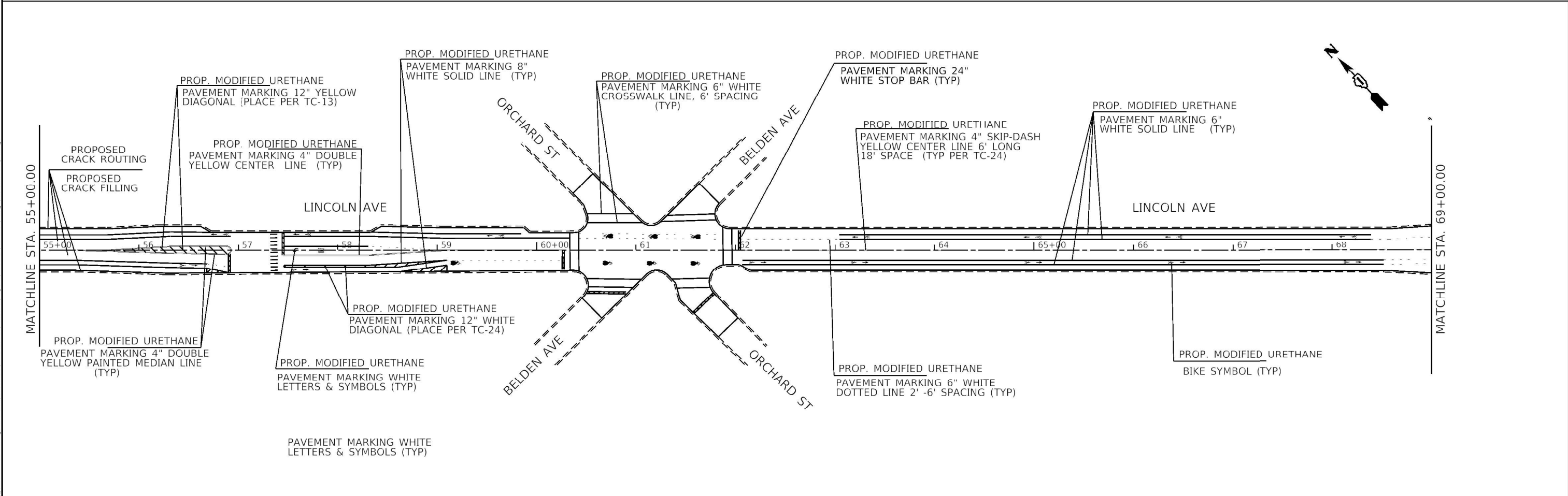
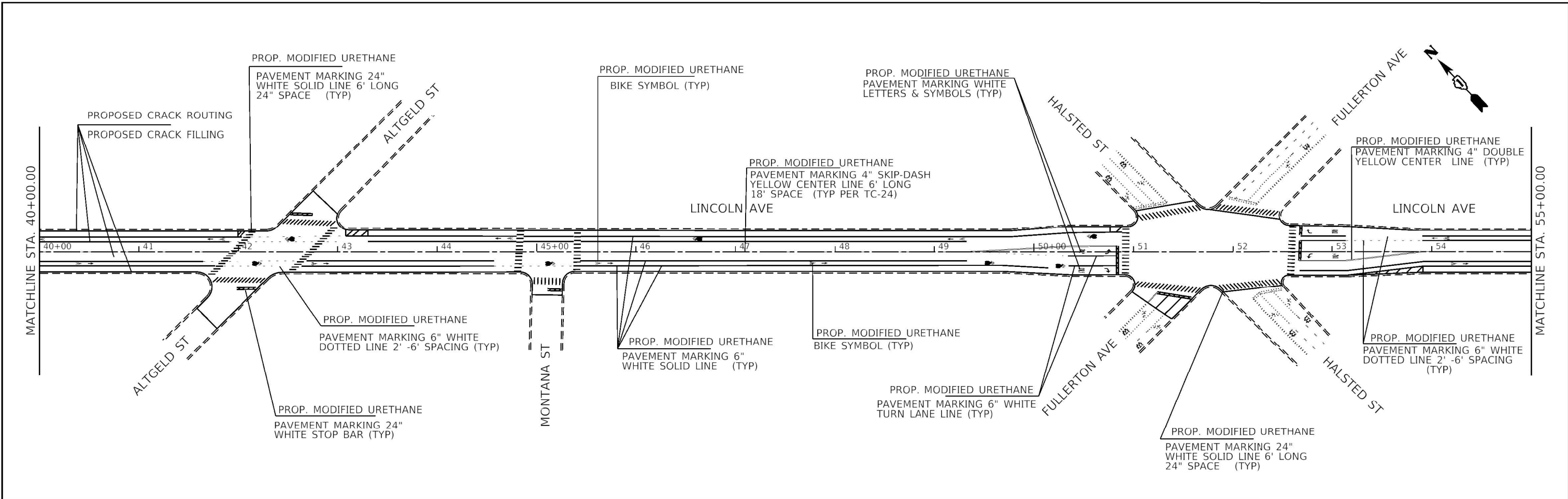
MODEL - Default  
 FILE - Model - 11012019.dwg  
 PROJECT - 11012019.dwg  
 USER - gorenautab  
 DATE - 11/30/2020  
 SCALE - 100.0000 / in.  
 STATUS - Design  
 SHEET - 14 of 4  
 CONTRACT - 62L52

USER NAME = gorenautab	DESIGNED -	REVISED -
DRAWN -	REVISED -	
CHECKED -	REVISED -	
DATE -	REVISED -	

**STATE OF ILLINOIS**  
**DEPARTMENT OF TRANSPORTATION**

**EXISTING AND PROPOSED ROADWAY PLAN**  
**LINCOLN AVE. (DIVERSEY PKWY TO WELLS ST.)**  
 SCALE: 1" = 50'  
 SHEET OF SHEETS STA. TO STA.

F.A.U. RTE.	SECTION	COUNTY	TOTAL SHEETS	SHEET NO.
3729	2020-074-I	COOK	14	4
CONTRACT NO. 62L52				
ILLINOIS FED. AID PROJECT				



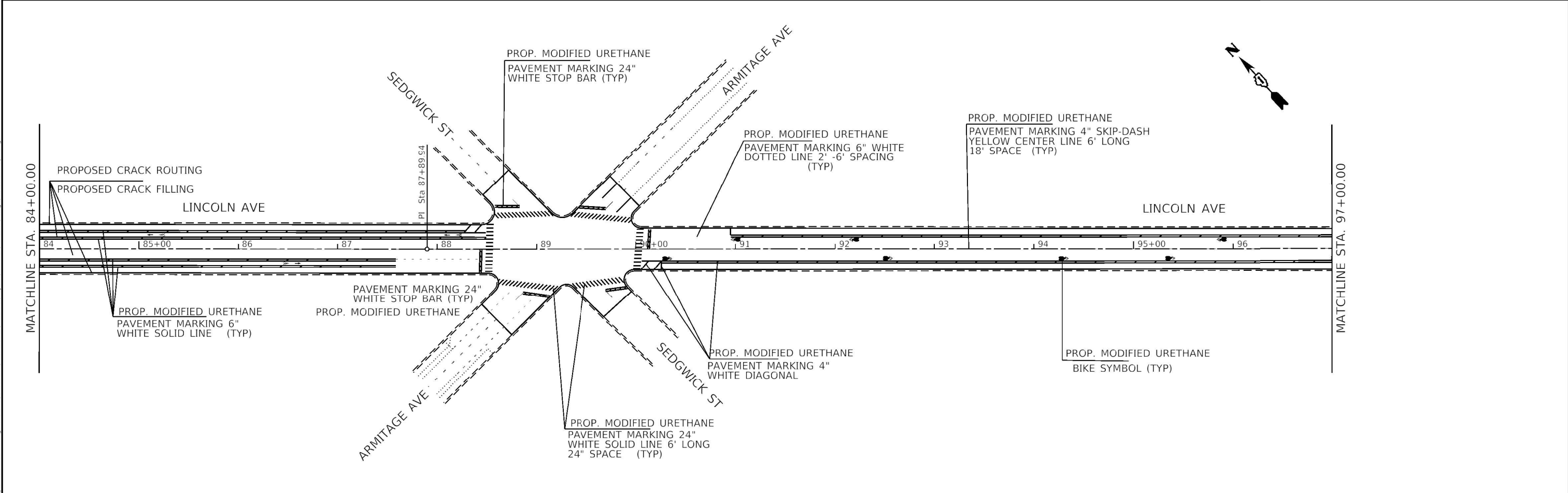
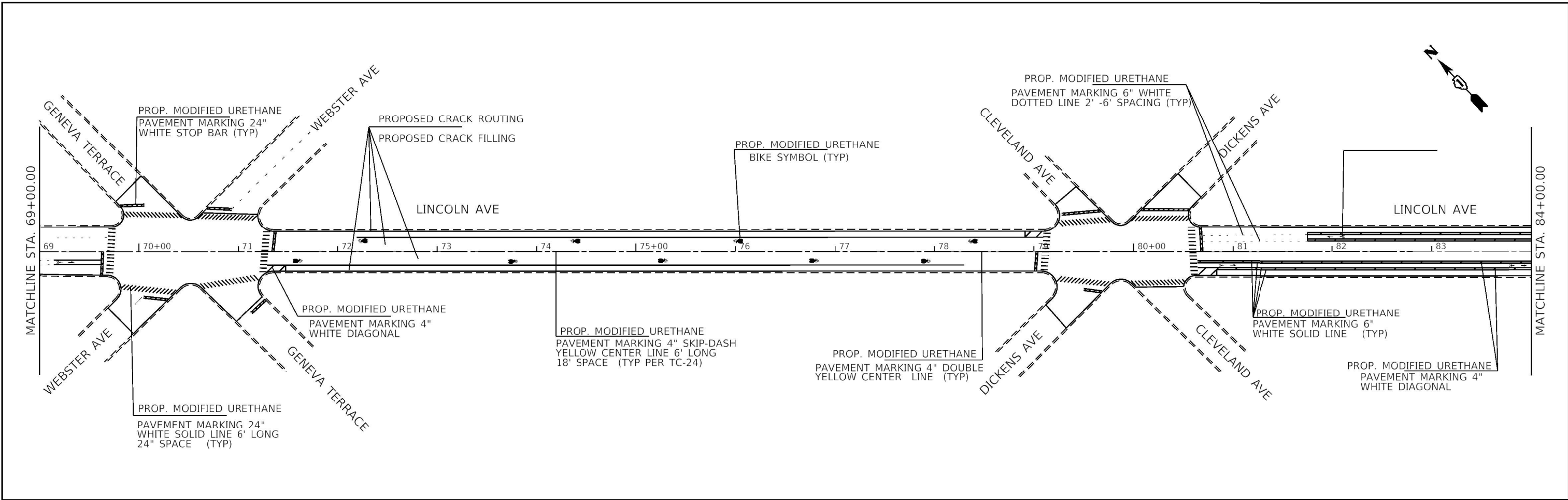
MODEL: Defaul...  
 FILE: Model...  
 PROJECT: ...  
 DATE: 11/30/2020

USER NAME = gorengautab	DESIGNED -	REVISED -
	DRAWN -	REVISED -
PLOT SCALE = 100.0000 "/td> <td>CHECKED -</td> <td>REVISED -</td>	CHECKED -	REVISED -
PLOT DATE = 11/30/2020	DATE -	REVISED -

**STATE OF ILLINOIS**  
**DEPARTMENT OF TRANSPORTATION**

**EXISTING AND PROPOSED ROADWAY PLAN**  
**LINCOLN AVE. (DIVERSEY PKWY TO WELLS ST.)**  
 SCALE: 1" = 50'    SHEET    OF    SHEETS    STA.    TO    STA.

F.A.U. RTE.	SECTION	COUNTY	TOTAL SHEETS	SHEET NO.
3729	2020-074-I	COOK	14	5
CONTRACT NO. 62L52				
ILLINOIS FED. AID PROJECT				



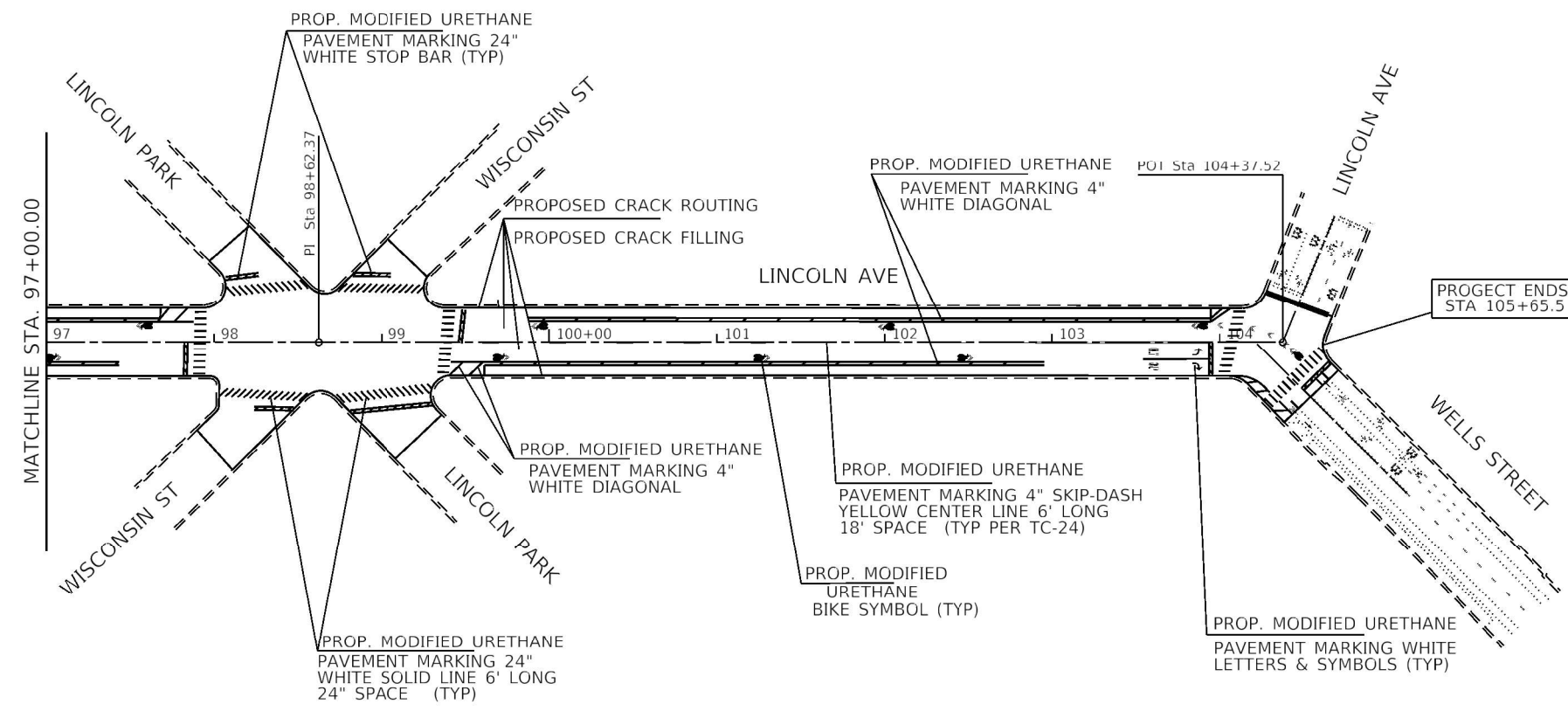
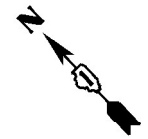
MODEL: Default  
 FILE: Model - Pavement.dwg  
 PROJECT: I:\Projects\147220\CADD\Drawings\147220.dwg  
 USER: gorenautab  
 DATE: 11/30/2020

USER NAME = gorenautab	DESIGNED -	REVISED -
	DRAWN -	REVISED -
PLOT SCALE = 100.0000' / in.	CHECKED -	REVISED -
PLOT DATE = 11/30/2020	DATE -	REVISED -

**STATE OF ILLINOIS**  
**DEPARTMENT OF TRANSPORTATION**

<b>EXISTING AND PROPOSED ROADWAY PLAN</b> <b>LINCOLN AVE. (DIVERSEY PKWY TO WELLS ST.)</b>			
SCALE: 1" = 50'	SHEET	OF SHEETS	STA. TO STA.

F.A.U. RTE.	SECTION	COUNTY	TOTAL SHEETS	SHEET NO.
3729	2020-074-I	COOK	14	6
CONTRACT NO. 62L52				
ILLINOIS FED. AID PROJECT				



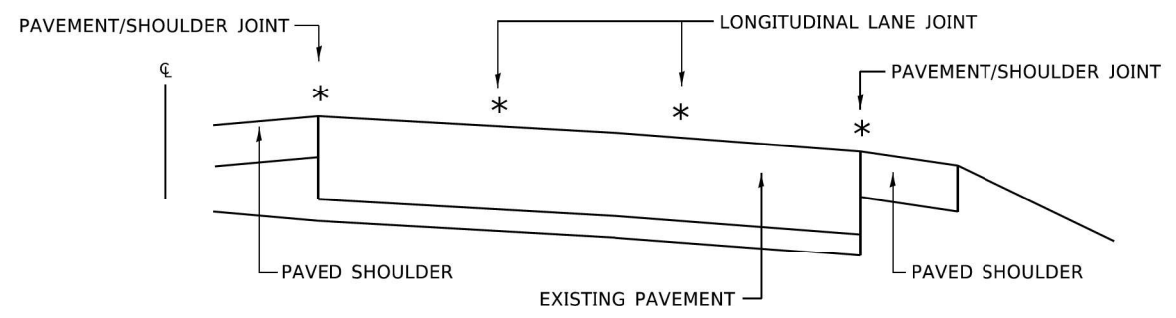
Model: Default  
 File: Model - Pavement.dwg  
 User: gorengautab  
 Date: 11/30/2020  
 Project: 2020-074-1  
 Sheet: 7 of 14

USER NAME = gorengautab	DESIGNED -	REVISED -
PLOT SCALE = 100.0000' / in.	DRAWN -	REVISED -
PLOT DATE = 11/30/2020	CHECKED -	REVISED -
	DATE -	REVISED -

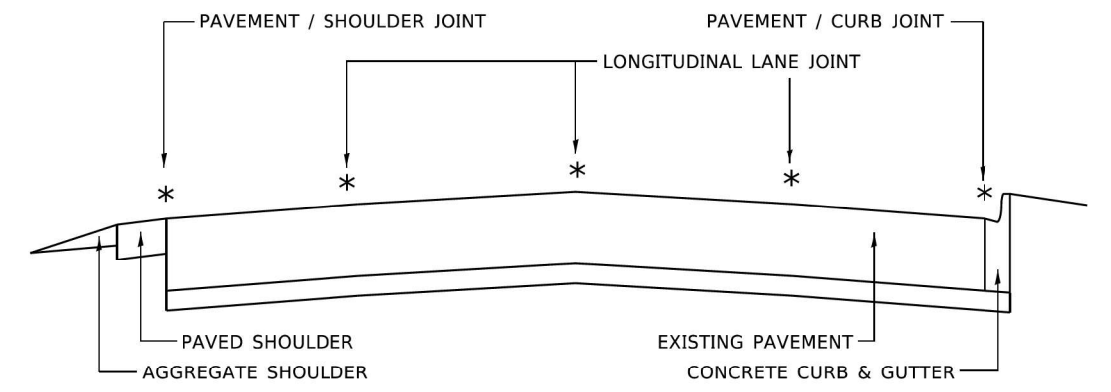
**STATE OF ILLINOIS**  
**DEPARTMENT OF TRANSPORTATION**

<b>EXISTING AND PROPOSED ROADWAY PLAN</b> <b>LINCOLN AVE. (DIVERSEY PKWY TO WELLS ST.)</b>			
SCALE: 1" = 50'	SHEET	OF SHEETS	STA. TO STA.

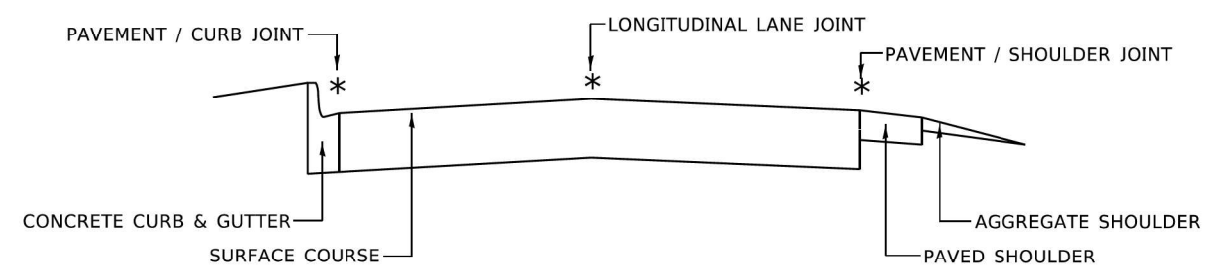
F.A.U. RTE.	SECTION	COUNTY	TOTAL SHEETS	SHEET NO.
3729	2020-074-1	COOK	14	7
CONTRACT NO. 62L52				
ILLINOIS FED. AID PROJECT				



**MULTI-LANE DIVIDED PAVEMENT**



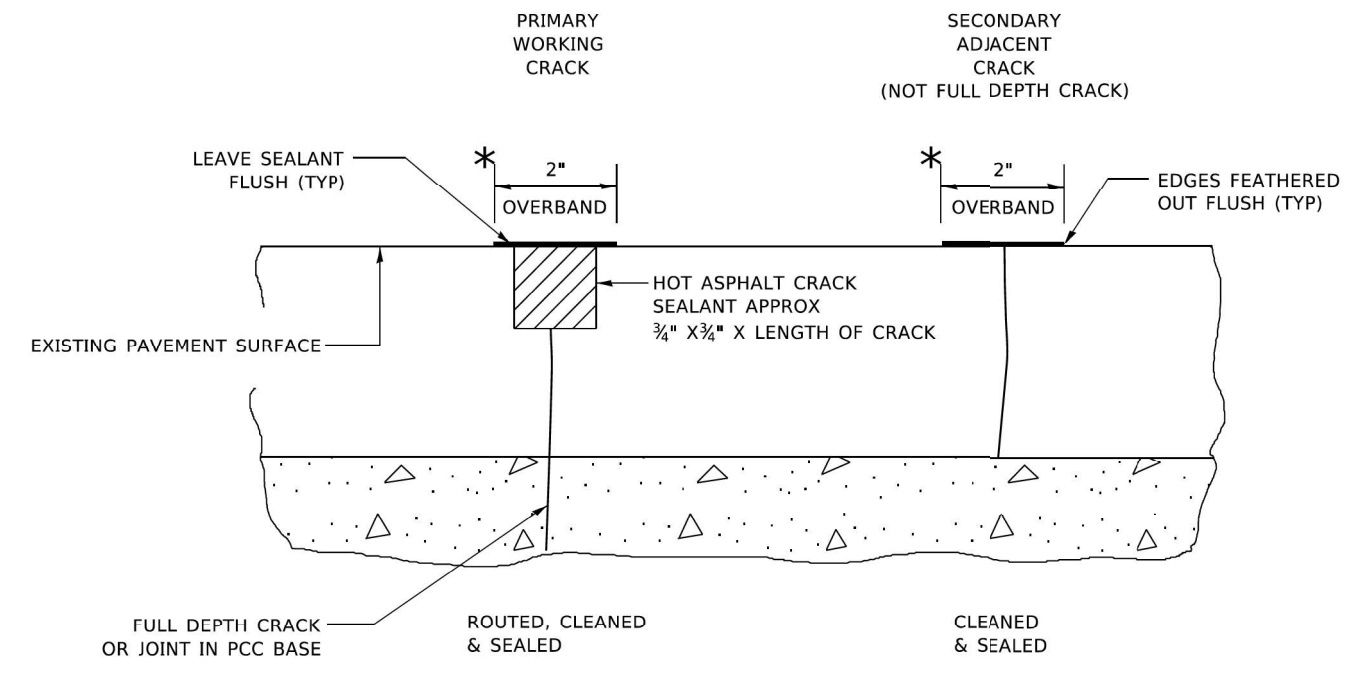
**MULTI-LANE UNDIVIDED PAVEMENT**



**TWO-LANE PAVEMENT**

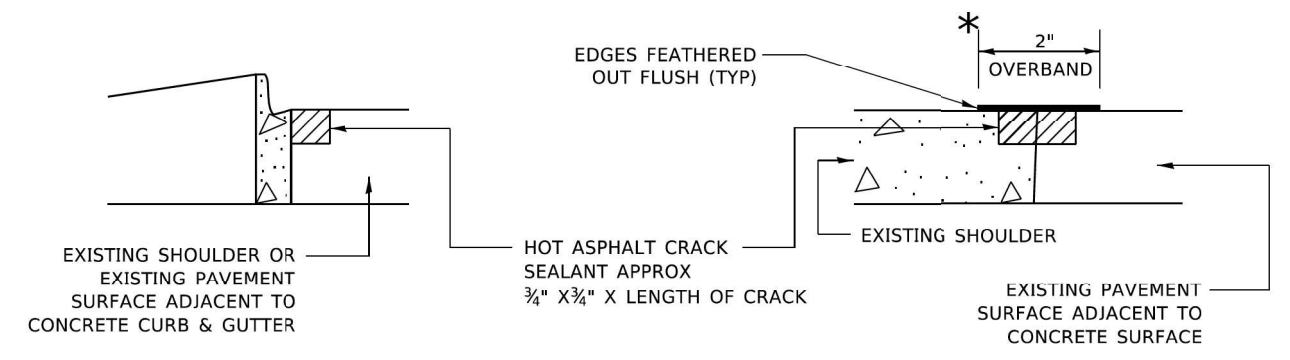
\* PROPOSED LONGITUDINAL CRACK ROUTING (PAVEMENT) & CRACK FILLING LOCATIONS

**GENERAL EXISTING TYPICAL SECTIONS  
(APPLIES TO HMA AND PCC PAVEMENTS)**



\* IN ALL LOCATIONS WHERE THE LONGITUDINAL CRACK CONFLICTS WITH EXISTING PAVEMENT MARKINGS (EITHER EDGE LINE OR LANE LINE) THE CRACK SHALL BE ROUTED & THE RESULTING RESERVOIR FILLED WITH SEALANT. ALL DAMAGES TO EXISTING RAISED REFLECTIVE PAVEMENT MARKERS SHALL BE REPLACED AT THE EXPENSE OF THE CONTRACTOR. ALL EXISTING PAVEMENT MARKINGS WITHIN THE PROJECT LIMITS SHALL BE RESTORED WITH MODIFIED URETHANE PAVEMENT MARKINGS.

**LONGITUDINAL JOINT**



**CRACK & JOINT SEALING DETAIL**

MODEL: Default  
 FILE: Model - Pavement.dwg  
 PROJECT: I:\Projects\2020\2020-074-1\Projects\2020\2020-074-1\Drawings\2020-074-1.dwg  
 USER: gorenautab  
 DATE: 11/30/2020

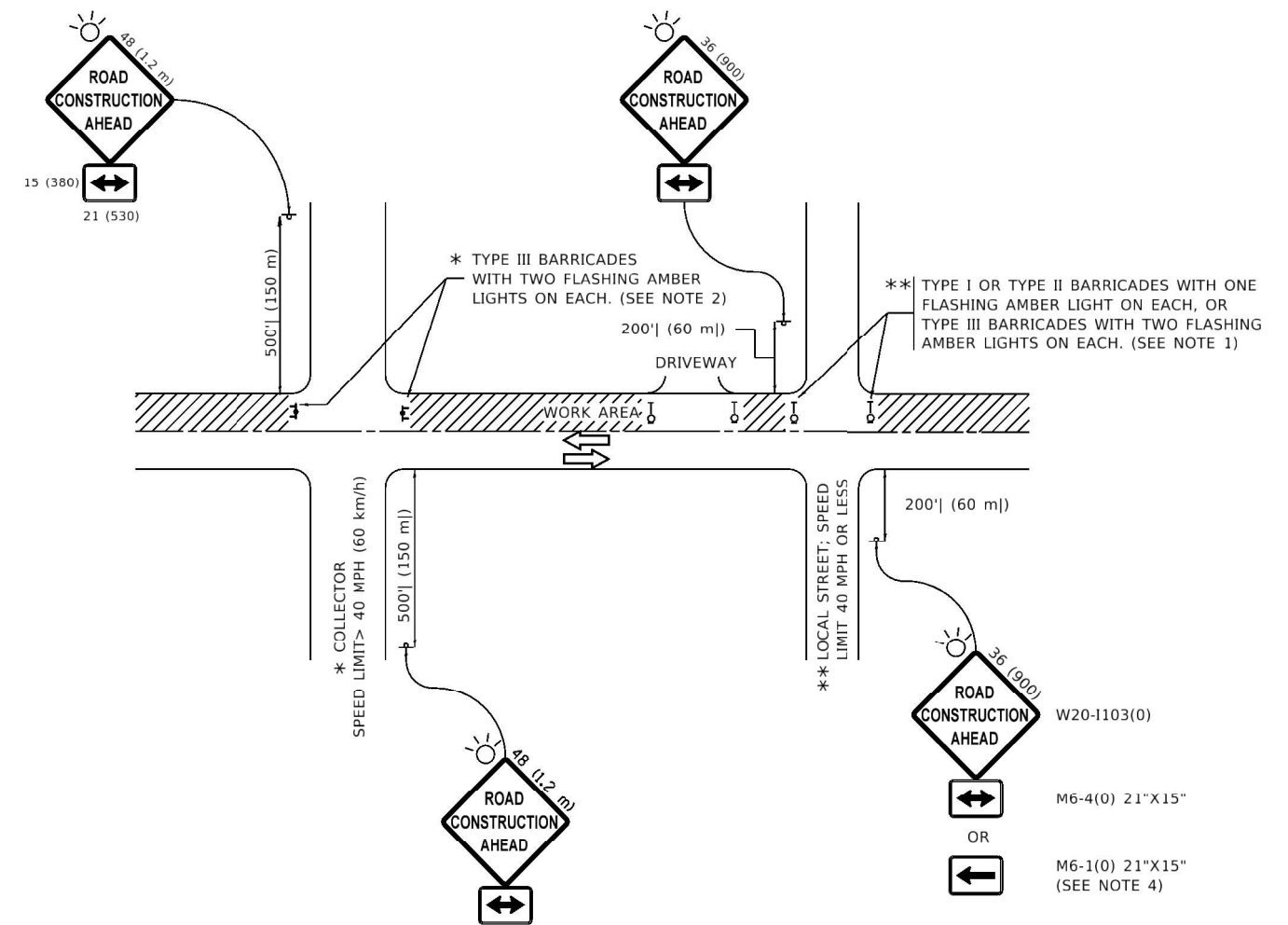
USER NAME = gorenautab	DESIGNED -	REVISED -
	DRAWN -	REVISED -
PLOT SCALE = 100.0000' / in.	CHECKED -	REVISED -
PLOT DATE = 11/30/2020	DATE -	REVISED -

**STATE OF ILLINOIS  
DEPARTMENT OF TRANSPORTATION**

<b>CRACK &amp; JOINT SEALING DETAIL</b>			
<b>LINCOLN AVE. (DIVERSEY PKWY TO WELLS ST.)</b>			
SCALE:	SHEET	OF SHEETS	STA. TO STA.

F.A.U. RTE.	SECTION	COUNTY	TOTAL SHEETS	SHEET NO.
3729	2020-074-1	COOK	14	8
ILLINOIS FED. AID PROJECT				





**NOTES:**

- SIDE ROAD WITH A SPEED LIMIT OF 40 MPH (60 km/h) OR LESS AS SHOWN ON THE DRAWING AND AS DIRECTED BY THE ENGINEER:
  - ONE "ROAD CONSTRUCTION AHEAD" SIGN 36 x 36 (900x900) WITH A FLASHER MOUNTED ON IT APPROXIMATELY 200' (60 m) IN ADVANCE OF THE MAIN ROUTE.
  - THE CLOSED PORTION OF THE MAIN ROUTE SHALL BE PROTECTED BY BLOCKING WITH TYPE I, TYPE II OR TYPE III BARRICADES, 1/3 OF THE CROSS SECTION OF THE CLOSED PORTION.
- SIDE ROAD WITH A SPEED LIMIT GREATER THAN 40 MPH (60 km/h) AS SHOWN ON THE DRAWING AND AS DIRECTED BY THE ENGINEER.
  - ONE "ROAD CONSTRUCTION AHEAD" SIGN 48 x 48 (1.2 m x 1.2 m) WITH A FLASHER MOUNTED ON IT APPROXIMATELY 500' (150 m) IN ADVANCE OF THE MAIN ROUTE.
  - THE CLOSED PORTION OF THE MAIN ROUTE SHALL BE PROTECTED BY BLOCKING WITH TYPE III BARRICADES, 1/2 OF THE CROSS SECTION OF THE CLOSED PORTION.
- CONES MAY BE SUBSTITUTED FOR BARRICADES OR DRUMS AT HALF THE SPACING DURING DAY OPERATIONS. CONES SHALL BE A MINIMUM OF 28 (710) IN HEIGHT.
- SIGNING AND THE WORK ZONE, A SINGLE HEADED ARROW (M6-1) SHALL BE USED IN LIEU OF THE DOUBLE HEADED ARROW (M6-4).
- WHEN WORK IS BEING PERFORMED ON A SIDE ROAD OR DRIVEWAY, FOLLOW THE APPLICABLE STANDARD(S). THE DIRECTIONAL ARROW (M6-1 OR M6-4) SHALL BE COVERED OR REMOVED WHEN NO LONGER CONSISTENT WITH THE TRAFFIC CONTROL SET-UP.
- ADVANCE WARNING SIGNS ARE TO BE OMITTED ON DRIVEWAYS UNLESS OTHERWISE SPECIFIED IN THE PLANS OR BY THE ENGINEER.
- THE TRAFFIC CONTROL AND PROTECTION FOR SIDE ROADS, INTERSECTIONS, AND DRIVEWAYS SHALL BE INCLUDED IN THE COST OF SPECIFIED TRAFFIC CONTROL STANDARDS OR ITEMS.

All dimensions are in inches (millimeters) unless otherwise shown.

M:\REL - Default...  
 FILE NAME: p:\pub\harcam\dat\_illinois\pvt\WJDOT\Documents\DOT\_Offices\District 1\Projects\CD14720\CD00\plan\Design\TCS\Std.dgn

USER NAME = gorengautab	DESIGNED - L.H.A.	REVISED - A. HOUSEH 10-15-96
	DRAWN -	REVISED - T. RAMMACHER 01-06-00
PLOT SCALE = 100.0000" / in.	CHECKED -	REVISED - A. SCHUETZE 07-01-13
PLOT DATE = 11/30/2020	DATE - 06-89	REVISED - A. SCHUETZE 09-15-16

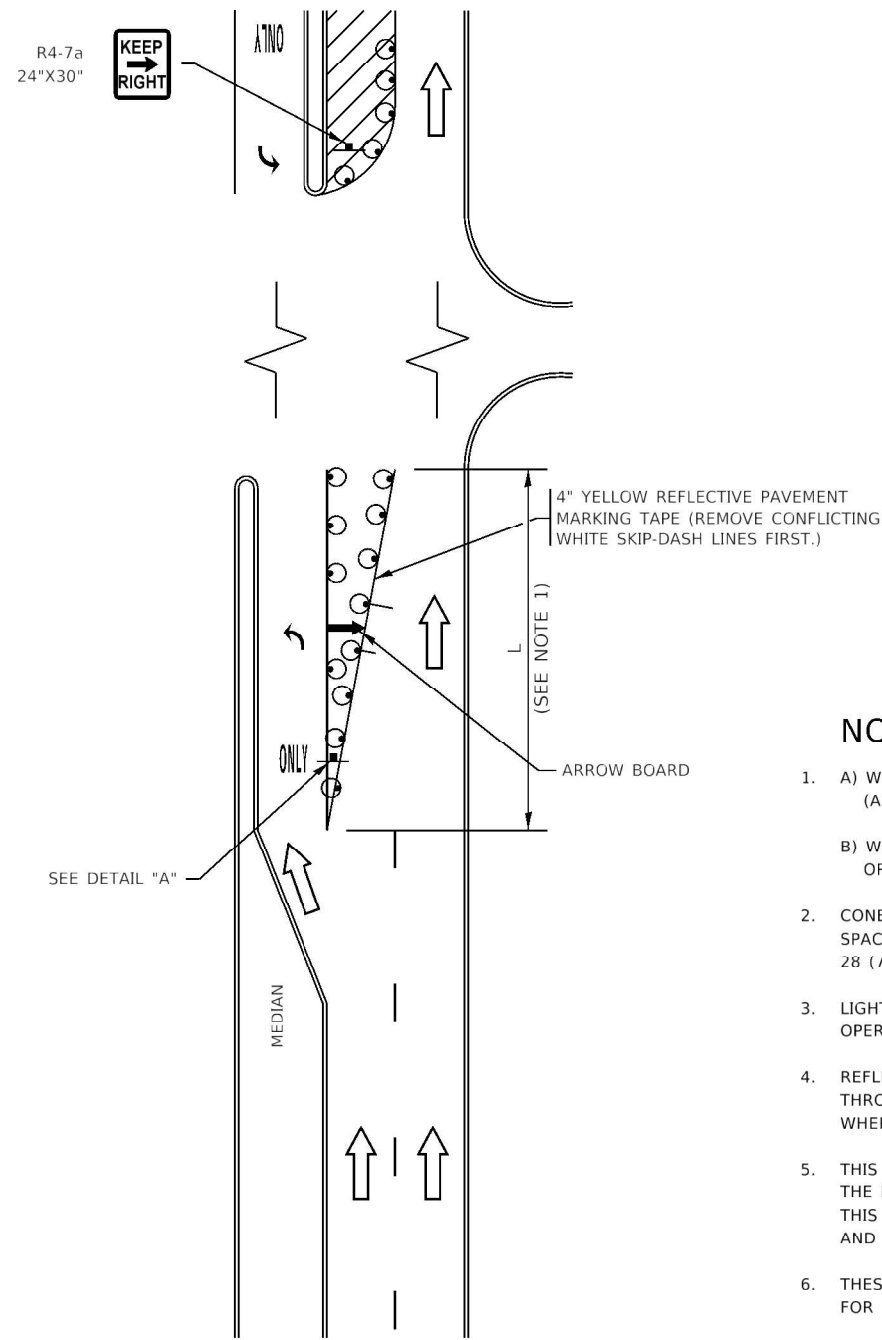
**STATE OF ILLINOIS  
 DEPARTMENT OF TRANSPORTATION**

**TRAFFIC CONTROL AND PROTECTION FOR  
 SIDE ROADS, INTERSECTIONS, AND DRIVEWAYS**

SCALE: NONE SHEET 1 OF 1 SHEETS STA. TO STA.

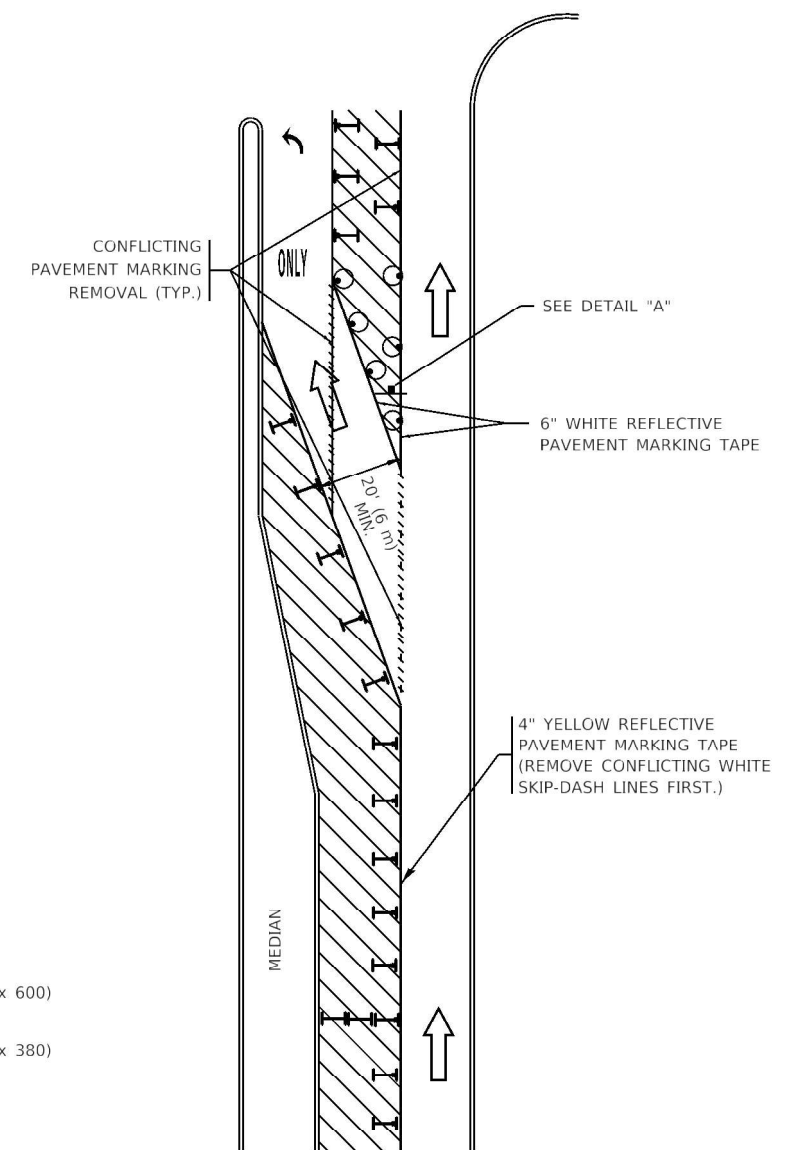
F.A.U. RTE.	SECTION	COUNTY	TOTAL SHEETS	SHEET NO.
3729	2020-074-I	COOK	14	9
TC-10			CONTRACT NO. 62L52	
ILLINOIS FED. AID PROJECT				

**TURN BAY ENTRANCE AT START  
OF LANE CLOSURE TAPER**

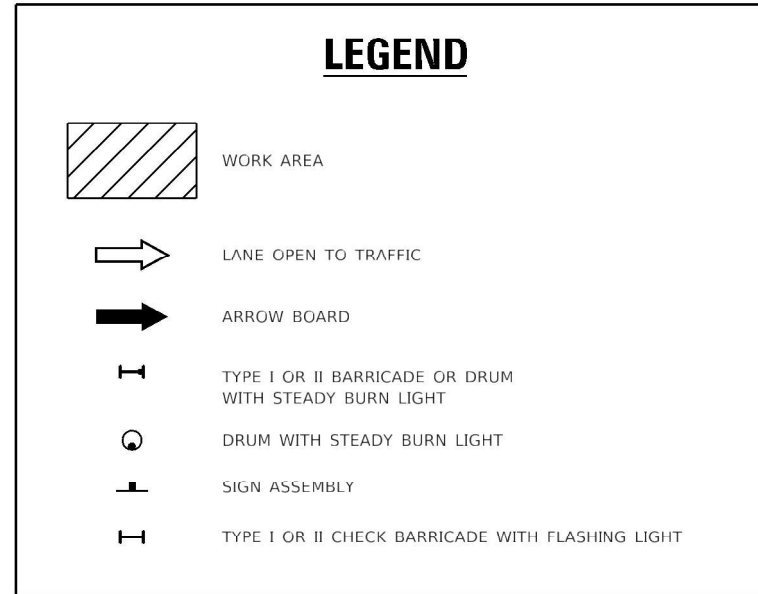


**FIGURE 1**

**TURN BAY ENTRANCE  
WITHIN A LANE CLOSURE**

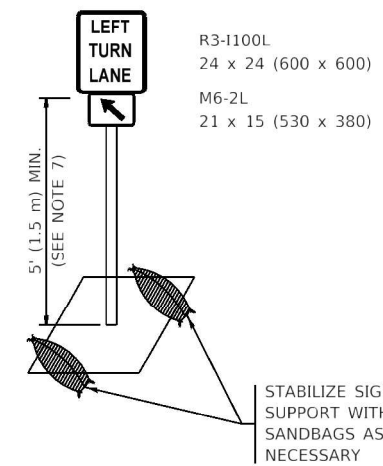


**FIGURE 2**



**NOTES:**

1. A) WHEN "L" IS ≤ THE STORAGE LENGTH OF THE TURN LANE (AS SHOWN IN FIG. 1), USE FIGURE 1.  
B) WHEN "L" IS > THE STORAGE LENGTH OF THE TURN LANE OR THE TURN LANE IS WITHIN THE LANE CLOSURE, USE FIGURE 2.
2. CONES MAY BE SUBSTITUTED FOR BARRICADES OR DRUMS AT HALF THE SPACING DURING DAY OPERATIONS. CONES SHALL BE A MINIMUM OF 28 (10) IN HEIGHT.
3. LIGHTS WILL NOT BE REQUIRED ON BARRICADES OR DRUMS FOR DAY OPERATIONS. ALL LIGHTS SHALL BE MONODIRECTIONAL.
4. REFLECTIVE TEMPORARY PAVEMENT MARKINGS SHALL BE PLACED THROUGHOUT THE BARRICADED AREAS OF EACH TURN BAY AS SHOWN WHERE THE CLOSURE TIME IS GREATER THAN FOURTEEN (14) DAYS.
5. THIS APPLICATION ALSO APPLIES WHEN WORK IS BEING PERFORMED IN THE RIGHT LANE(S) AND THE RIGHT TURN BAY IS TO REMAIN OPEN. UNDER THIS CONDITION, "RIGHT TURN LANE" R3-1100R 24 x 24 (600 x 600) AND M6-2R 21 x 15 (530 x 380) SHALL BE USED.
6. THESE CONTROLS SHALL SUPPLEMENT MAINLINE TRAFFIC CONTROL FOR LANE CLOSURES.
7. THE SIGNS SHALL BE MOUNTED ABOVE THE BARRICADES/DRUMS ON SEPARATE SIGN SUPPORTS THAT MEET NCHRP 350 OR MASH REQUIREMENTS.
8. TRAFFIC CONTROL AND PROTECTION AT TURN BAYS (TO REMAIN OPEN TO TRAFFIC) SHALL BE INCLUDED IN THE COST OF SPECIFIED TRAFFIC CONTROL STANDARDS OR ITEMS.



**DETAIL A**

All dimensions are in inches (millimeters) unless otherwise shown.

M:\REL - Default - 10\p\harcourt.dwg, P:\PROJECTS\11-20-20\11-20-20\CADD\DATA\Design\11-20-20.dwg

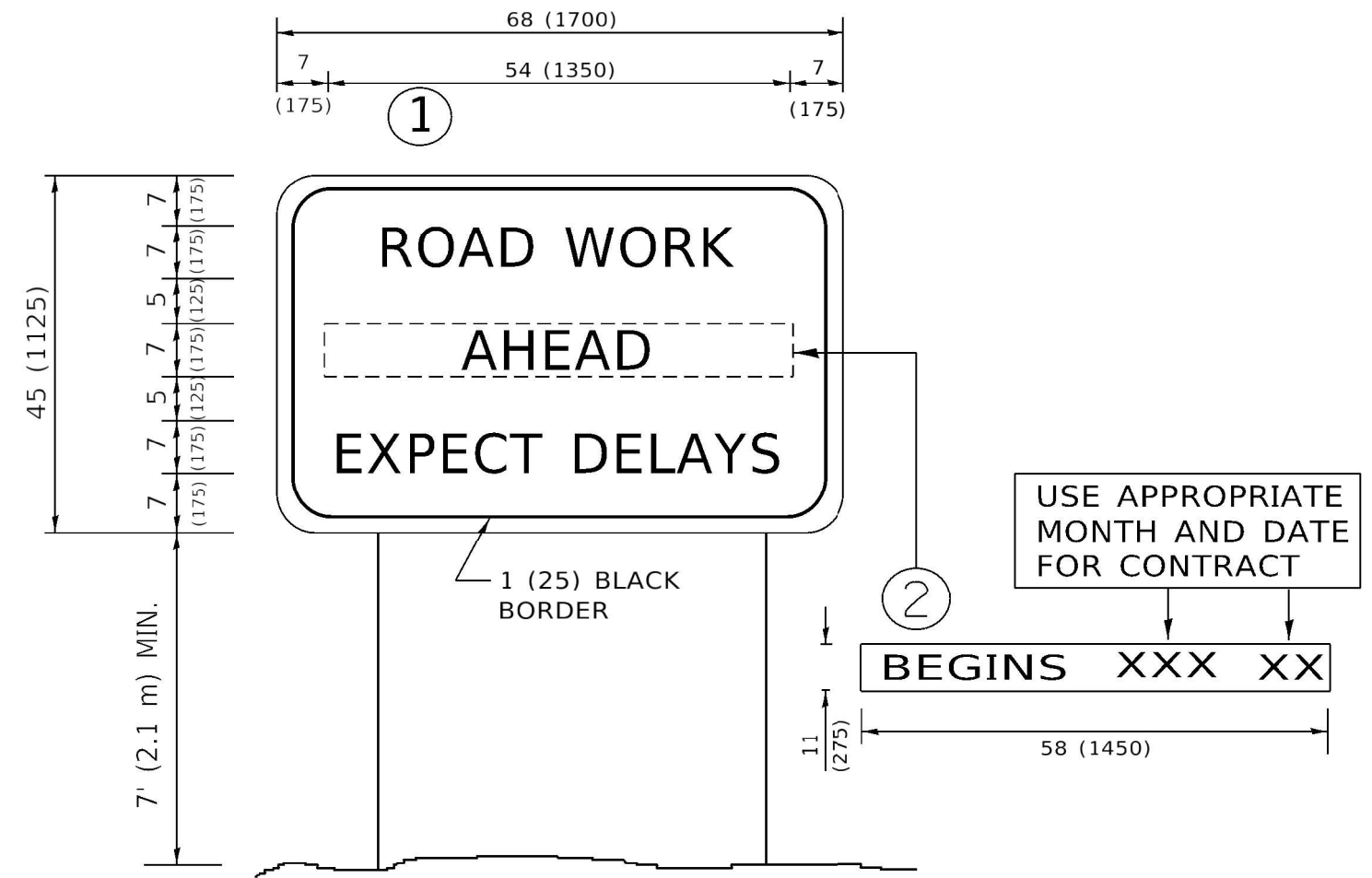
USER NAME = gorenautab	DESIGNED - T. RAMMACHER 09-08-94	REVISED - R. BORO 09-14-09
	DRAWN - A. HOUSEH 11-07-95	REVISED - A. SCHUETZE 07-01-13
PLOT SCALE = 100.0000" / in.	CHECKED - A. HOUSEH 10-12-96	REVISED - A. SCHUETZE 09-15-16
PLOT DATE = 11/30/2020	DATE - T. RAMMACHER 01-06-00	REVISED -

**STATE OF ILLINOIS  
DEPARTMENT OF TRANSPORTATION**

**TRAFFIC CONTROL AND PROTECTION AT TURN BAYS  
(TO REMAIN OPEN TO TRAFFIC)**

SCALE: NONE SHEET 1 OF 1 SHEETS STA. TO STA.

F.A.U. RTE.	SECTION	COUNTY	TOTAL SHEETS	SHEET NO.
3729	2020-074-1	COOK	14	10
TC-14		CONTRACT NO. 62L52		
		ILLINOIS FED. AID PROJECT		



**NOTES:**

1. USE BLACK LETTERING ON ORANGE BACKGROUND.
2. ERECT SIGNS IN ADVANCE OF THE LOCATION FOR THE "ROAD CONSTRUCTION AHEAD" SIGN AT LOCATIONS AS DIRECTED BY THE ENGINEER.
3. ERECT SIGN ① WITH INSTALLED PANEL ② ONE WEEK PRIOR TO THE START OF CONSTRUCTION.
4. REMOVE PANEL ② SOON AFTER THE START OF CONSTRUCTION.
5. SEE SPECIAL PROVISION FOR "TEMPORARY INFORMATION SIGNING" FOR ADDITIONAL INFORMATION.
6. ONE SIGN ASSEMBLY EQUALS 25.70 SQ. FT. (2.3 SQ. M.)
7. SHALL BE PAID FOR AS TEMPORARY INFORMATION SIGNING.

ALL DIMENSIONS ARE IN INCHES (MILLIMETERS) UNLESS OTHERWISE SHOWN.

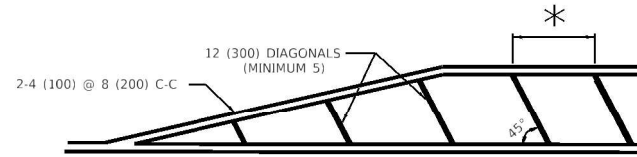
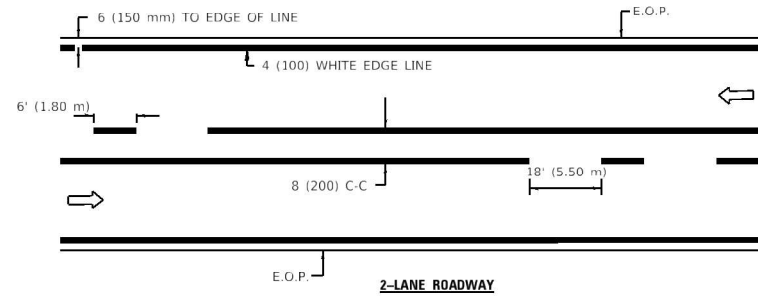
Model: Default  
File: \\maple-px1pblsarcam001.illinois.gov\PI\DOT\Documents\DOT\_Offices\District\_1\Projects\14720(CADData)\Design\DS\Sig.dgn

USER NAME = gorengautab	DESIGNED -	REVISED - R. MIRS 09-15-97
	DRAWN -	REVISED - R. MIRS 12-11-97
PLOT SCALE = 100.0000" / in.	CHECKED -	REVISED - T. RAMMACHER 02-02-99
PLOT DATE = 11/30/2020	DATE -	REVISED - C. JUCIUS 01-31-07

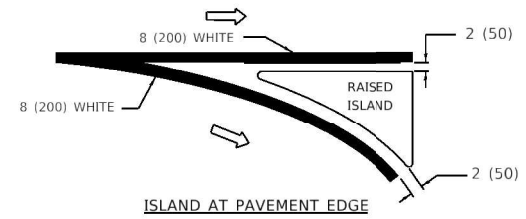
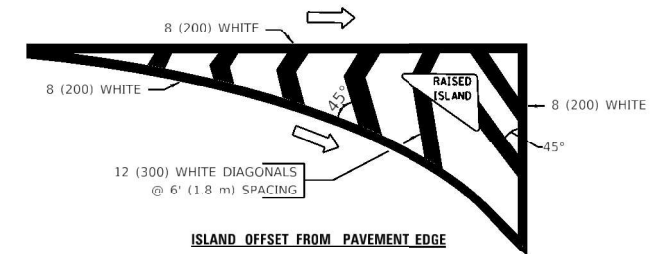
**STATE OF ILLINOIS  
DEPARTMENT OF TRANSPORTATION**

**ARTERIAL ROAD  
INFORMATION SIGN**

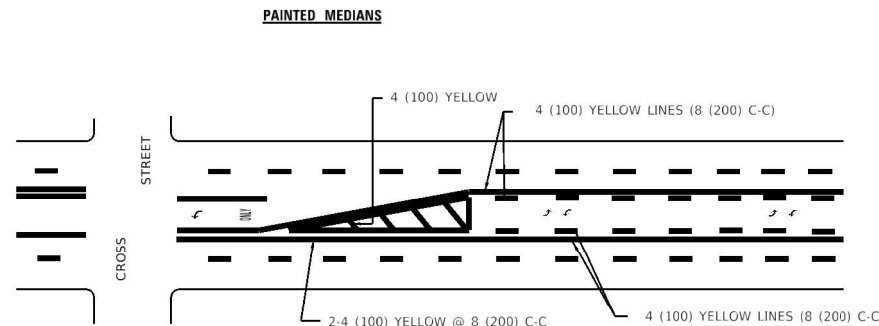
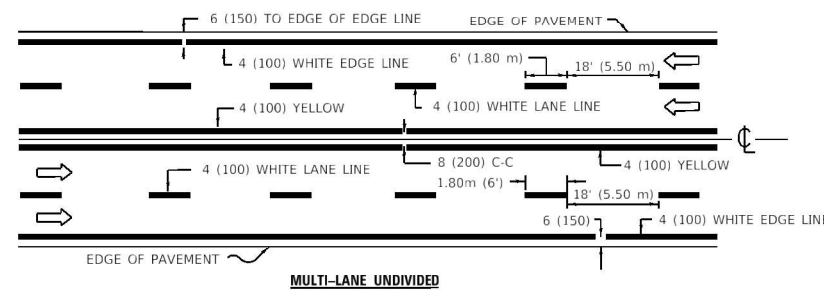
SCALE: NONE	SHEET 1	OF 1 SHEETS	STA.	TO STA.	F.A.U. RTE. 3729	SECTION 2020-074-1	COUNTY COOK	TOTAL SHEETS 12	SHEET NO. 11
								ILLINOIS FED. AID PROJECT	



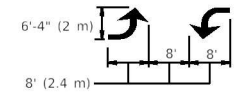
\* FOR MEDIAN LENGTHS WHERE DIAGONAL SPACING CANNOT BE ATTAINED, USE 5 (FIVE) EQUALLY SPACED DIAGONAL LINES.  
 \* DIAGONAL LINE SPACING: 20' (6.1 m) C-C



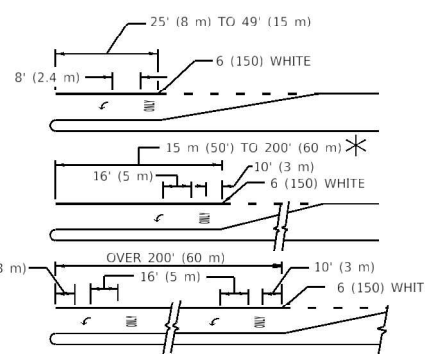
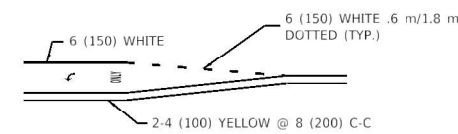
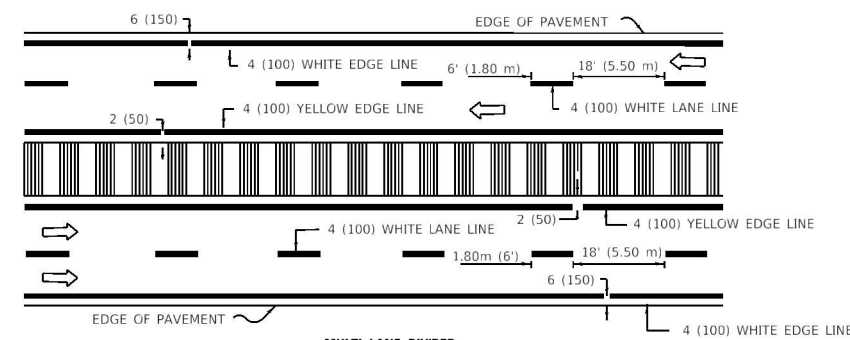
TYPICAL ISLAND MARKING



A MINIMUM OF TWO PAIRS OF TURN ARROWS SHALL BE USED, WHITE IN COLOR. ADDITIONAL PAIRS SHALL BE PLACED AT 200' (60 m) TO 300' (90 m) INTERVALS.



TYPICAL PAINTED MEDIAN MARKING



FULL SIZE LETTERS 8' (2.4 m) AND ARROWS SHALL BE USED.  
 AREA = 15.8 SQ. FT. (1.47 m<sup>2</sup>) ONLY AREA = 22.9 SQ. FT. (2.13 m<sup>2</sup>)  
 \* TURN LANES IN EXCESS OF 400' (120 m) IN LENGTH MAY HAVE AN ADDITIONAL SET OF ARROW - "ONLY" INSTALLED MIDWAY BETWEEN THE OTHER TWO SETS OF ARROW - "ONLY".

TYPICAL LEFT (OR RIGHT) TURN LANE

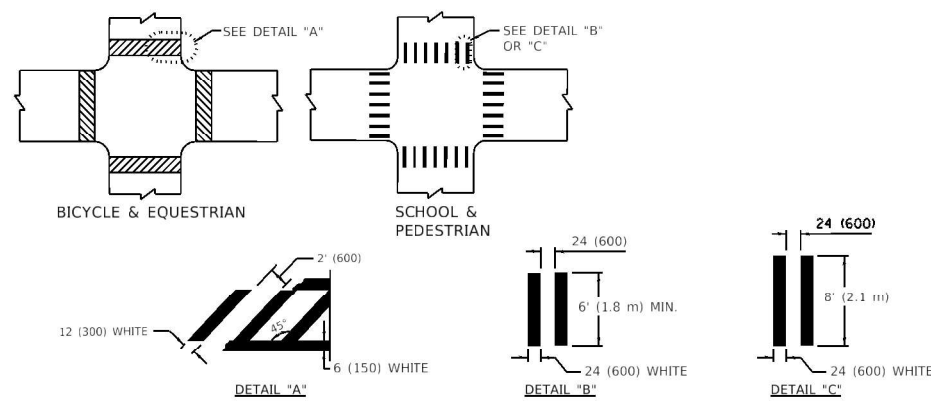
TYPICAL TURN LANE MARKING

TYPE OF MARKING	WIDTH OF LINE	PATTERN	COLOR	SPACING / REMARKS
CENTERLINE ON 2 LANE PAVEMENT	4 (100)	SKIP-DASH	YELLOW	6' (1.80 m) LINE WITH 18' (5.50 m) SPACE
CENTERLINE ON MULTI-LANE UNDIVIDED PAVEMENT	2 @ 4 (100)	SOLID	YELLOW	8 (200) C-C
NO PASSING ZONE LINES: FOR ONE DIRECTION FOR BOTH DIRECTIONS	4 (100) 2 @ 4 (100)	SOLID SOLID	YELLOW YELLOW	8 (200) C-C
LANE LINES	4 (100) 5 (125) ON FREEWAYS	SKIP-DASH SKIP-DASH	WHITE WHITE	6' (1.80 m) LINE WITH 18' (5.50 m) SPACE
DOTTED LINES (EXTENSIONS OF CENTER, LANE OR TURN LANE MARKINGS)	SAME AS LINE BEING EXTENDED	SKIP-DASH	SAME AS LINE BEING EXTENDED	2' (600) LINE WITH 6' (1.8) SPACE
FDG F INFS	4 (100)	SOLID	YELLOW-LEFT WHITE-RIGHT	OUTLINE MOUNTABLE MEDIANS IN YELLOW; EDGE LINES ARE NOT USED NEXT TO BARRIER CURB
TURN LANE MARKINGS	6 (150) LINE, FULL SIZE LETTERS & SYMBOLS (8' (2.4 m))	SOLID	WHITE	SEE TYPICAL TURN LANE MARKING DETAIL
TWO WAY LEFT TURN MARKING	2 @ 4 (100) EACH DIRECTION 8' (2.4 m) LEFT ARROW	SKIP-DASH AND SOLID IN PAIRS	YELLOW WHITE	6' (1.8 m) LINE WITH 18' (5.50 m) SPACE FOR SKIP-DASH; 8 (200) C-C BETWEEN SOLID LINE AND SKIP-DASH LINE SEE TYPICAL TWO-WAY LEFT TURN MARKING DETAIL
CROSSWALK LINES A. DIAGONALS (BIKE & EQUESTRIAN) B. LONGITUDINAL BARS (SCHOOL & PEDESTRIAN)	12 (300) @ 45° 24 (600) @ 90°	SOLID SOLID	WHITE WHITE	2' (600) APART 2' (600) APART SEE TYPICAL CROSSWALK MARKING DETAILS.
STOP LINES	24 (600)	SOLID	WHITE	PLACE 4 (1.2 m) IN ADVANCE OF AND PARALLEL TO CROSSWALK, IF PRESENT. OTHERWISE, PLACE AT DESIRED STOPPING POINT. PARALLEL TO CROSSROAD CENTERLINE, WHERE POSSIBLE
PAINTED MEDIANS	2 @ 4 (100) WITH 12 (300) DIAGONALS @ 45°	SOLID	YELLOW: TWO WAY TRAFFIC WHITE: ONE WAY TRAFFIC	8 (200) C-C FOR THE DOUBLE LINE SEE TYPICAL PAINTED MEDIAN MARKING.
GORE MARKING AND CHANNELIZING LINES	8 (200) WITH 12 (300) DIAGONALS @ 45°	SOLID	WHITE	DIAGONALS: 20' (6.1 m) (LESS THAN 30 MPH (50 km/h))
RAILROAD CROSSING	24 (600) TRANSVERSE LINES; "RR" IS 6' (1.8 m) LETTERS; 16 (400) LINE FOR "X"	SOLID	WHITE	SEE STATE STANDARD 780001 AREA OF: "R"=3.6 SQ. FT. (0.33m <sup>2</sup> ) EACH "X"=54.0 SQ. FT. (5.0 m <sup>2</sup> )

FOR FURTHER DETAILS ON PAVEMENT MARKING REFER TO STREET MARKING STANDARDS, PRINTED BY CITY OF CHICAGO, DEPARTMENT OF TRANSPORTATION, BUREAU OF TRAFFIC.

ALL DIMENSIONS ARE IN INCHES (MILLIMETERS) UNLESS OTHERWISE SHOWN.

TYPICAL LANE AND EDGE LINE MARKING



TYPICAL CROSSWALK MARKING

Model: Default  
 File: \\miller\pub\pavement\miller\pav\DOT\Documents\DOT - Office\District 1\Projects\14720\CADD\Design\Design\DOT\Std.dgn

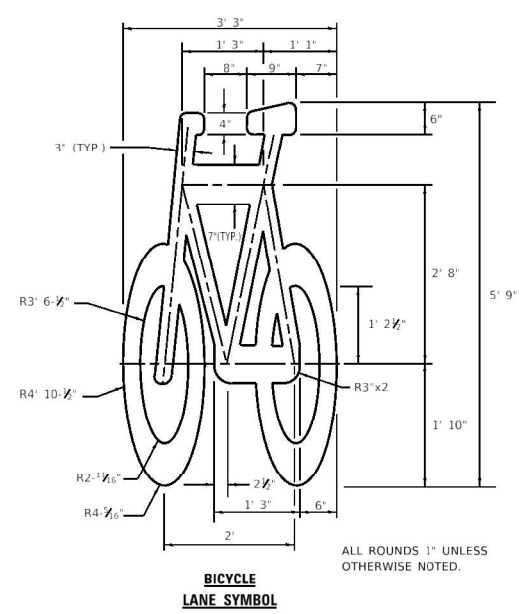
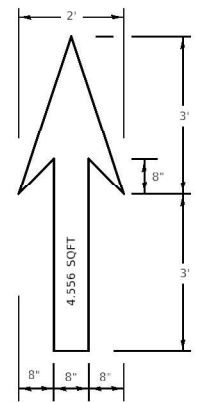
USER NAME = gorenautab	DESIGNED -	REVISED - T. RAMMACHER 12-07-00
	DRAWN -	REVISED - K. ENG 02-28-12
PLOT SCALE = 100.0000" / in.	CHECKED -	REVISED -
PLOT DATE = 11/30/2020	DATE -	REVISED -

STATE OF ILLINOIS  
 DEPARTMENT OF TRANSPORTATION

CITY OF CHICAGO  
 TYPICAL PAVEMENT MARKINGS

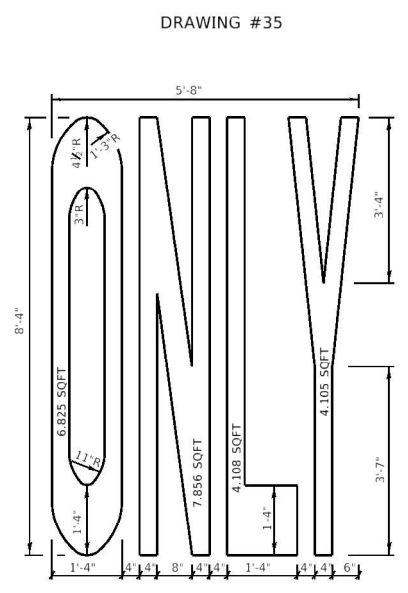
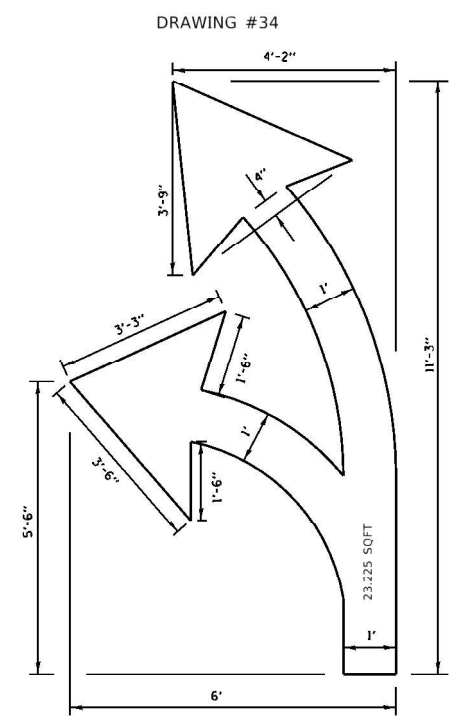
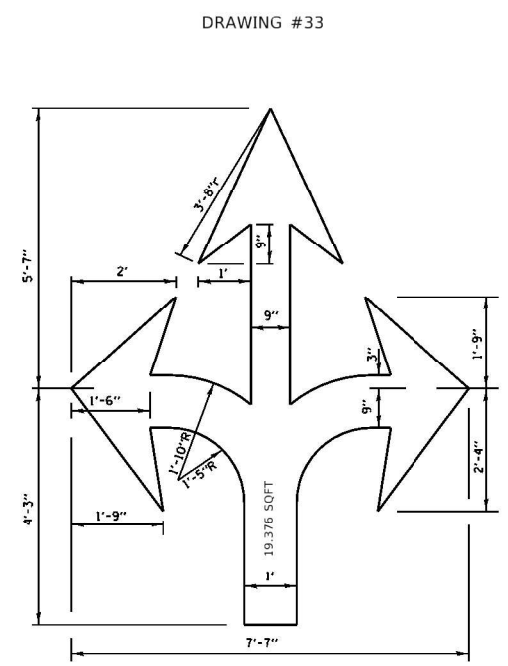
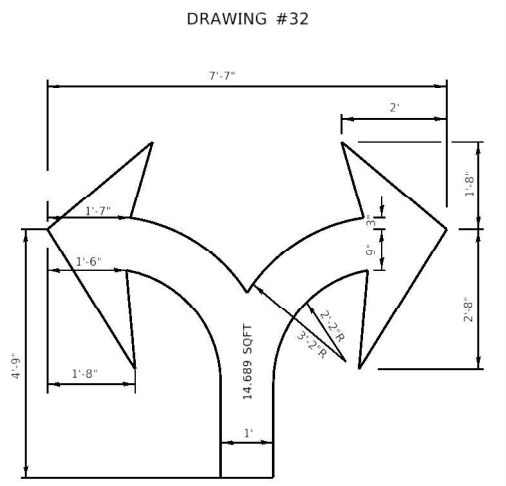
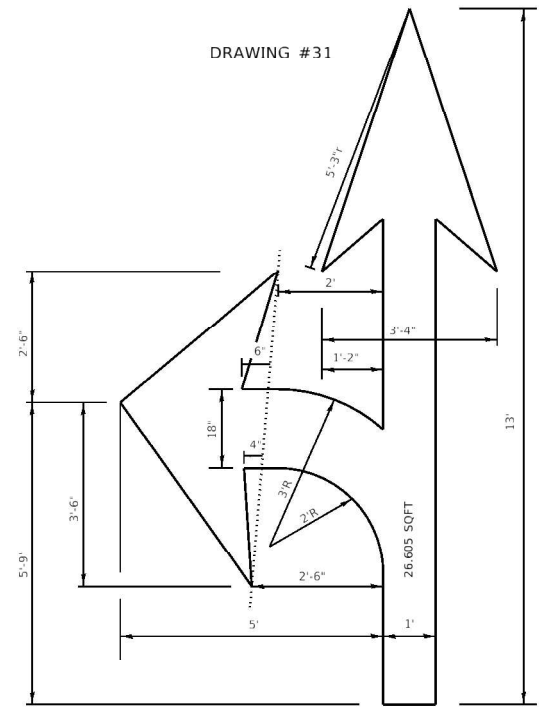
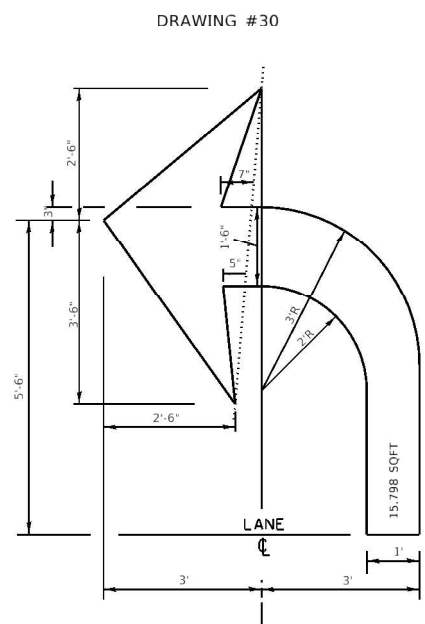
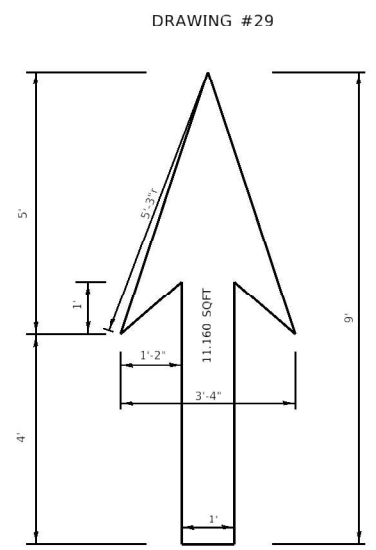
SCALE: NONE SHEET 1 OF 3 SHEETS STA. TO STA.

F.A.U. RTE.	SECTION	COUNTY	TOTAL SHEETS	SHEET NO.
3729	2020-074-1	COOK	14	12
TC-24		CONTRACT NO. 62152		
ILLINOIS FED. AID PROJECT				



- NOTE:
- FOR BIKE LANE SYMBOLS ONLY, USE PRE-FORMED THERMOPLASTIC WITH A MINIMUM THICKNESS OF 90 MILS, MINIMUM SKID RESISTANCE VALUE OF 60 BPN, & A MINIMUM INDEX OF REFRACTION OF 1.50.
  - THE RESIDENT ENGINEER SHALL CONTACT MR. BEN GOMBERG AT 312-744-8093 AT LEAST ONE CALENDAR WEEK PRIOR TO INSTALLING BIKE LANE SYMBOLS.

TYPICAL BIKE LANE SYMBOLS  
DRAWING #28



NOTE:  
ALL MARKINGS SHALL BE SOLID WHITE UNLESS OTHERWISE NOTED IN THE PLANS

M:\REL - Default - Proj\pavement.dwg: 11/30/2020 11:30:20 AM

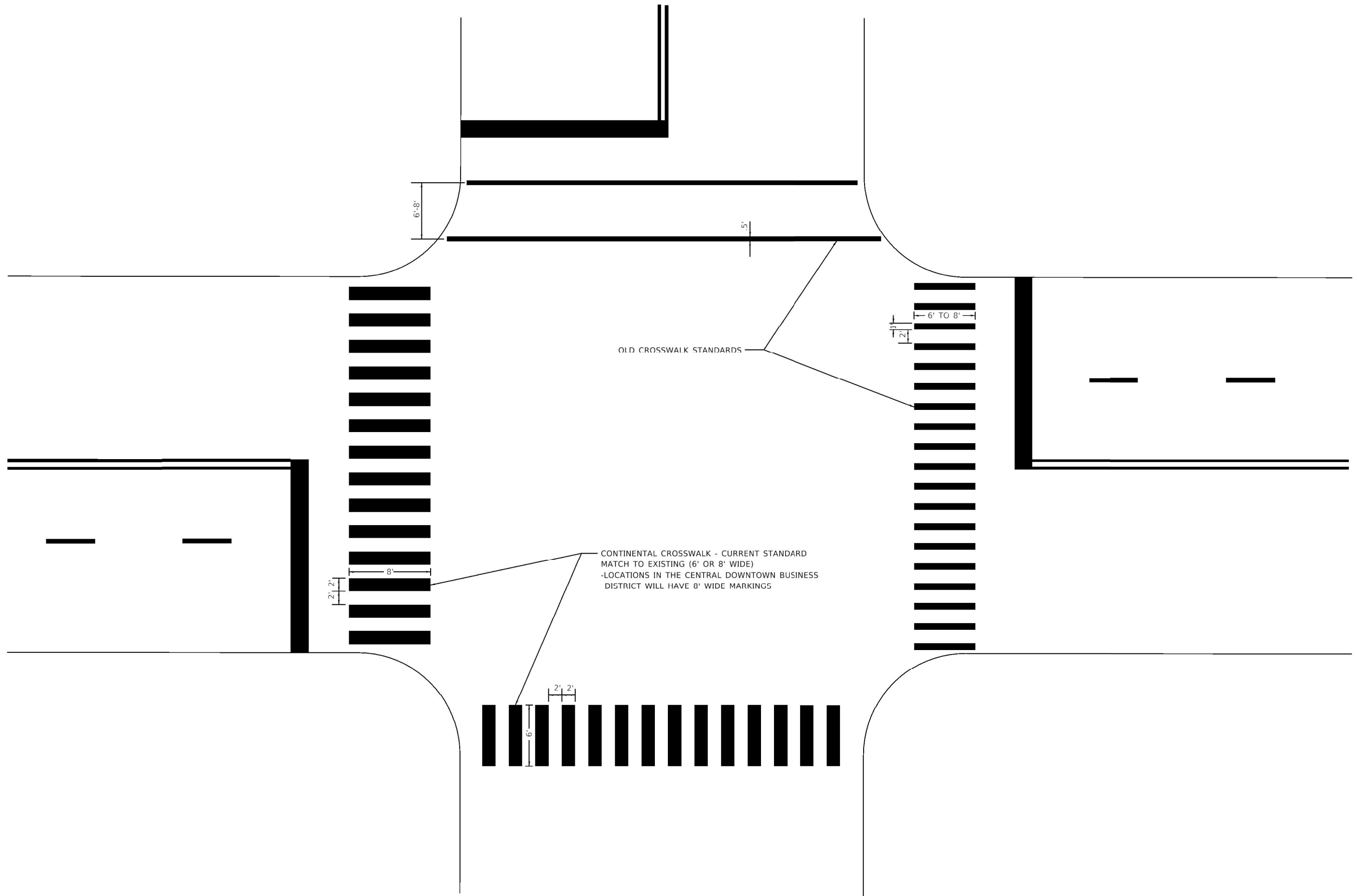
USER NAME = gorenautab	DESIGNED -	REVISED - T. RAMMACHER 12-07-00
	DRAWN -	REVISED -
PLOT SCALE = 100.0000' / in.	CHECKED -	REVISED -
PLOT DATE = 11/30/2020	DATE -	REVISED -

STATE OF ILLINOIS  
DEPARTMENT OF TRANSPORTATION

CITY OF CHICAGO			
TYPICAL PAVEMENT MARKINGS			
SCALE: NONE	SHEET 2	OF 3 SHEETS	STA. TO STA.

F.A.U. RTE.	SECTION	COUNTY	TOTAL SHEETS	SHEET NO.
3729	2020-074-1	COOK	14	13
TC-24		CONTRACT NO. 62L52		
ILLINOIS FED. AID PROJECT				

Model - Default  
 File - Model - pavelpavement.dwg  
 Illinois.gov - PW\DOT\Documents\DOT - Offices\District 1\Projects\14720\CADD\Drawings\Design\Dist1\Std.dgn



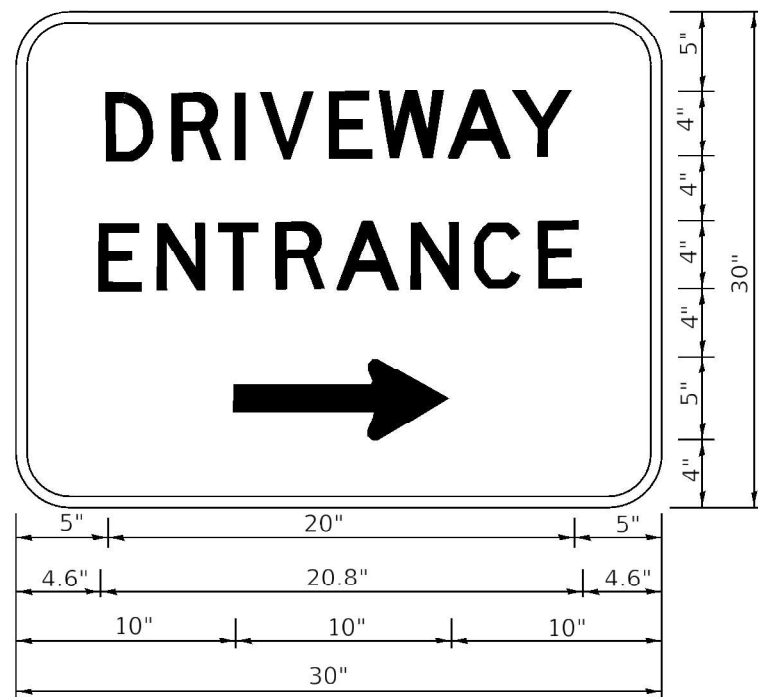
USER NAME = gorengautab	DESIGNED -	REVISED - T. RAMMACHER 12-07-00
	DRAWN -	REVISED -
PLOT SCALE = 100.0000" / in.	CHECKED -	REVISED -
PLOT DATE = 11/30/2020	DATE -	REVISED -

**STATE OF ILLINOIS**  
**DEPARTMENT OF TRANSPORTATION**

**CITY OF CHICAGO**  
**TYPICAL PAVEMENT MARKINGS**

SCALE: NONE    SHEET 3 OF 3 SHEETS    STA.    TO STA.

F.A.U. RTE.	SECTION	COUNTY	TOTAL SHEETS	SHEET NO.
3729	2020-074-1	COOK	14	14
<b>TC-24</b>		CONTRACT NO. 62152		
		ILLINOIS	FED. AID PROJECT	



3.0" RADIUS, 0.5" BORDER, WHITE ON GREEN; REFLECTORIZED  
 "DRIVEWAY" D; "ENTRANCE" D; STANDARD ARROW CUSTOM 12.0" x 5.0"

NOTES:

1. HALF OF THE SIGNS WILL REQUIRE A LEFT HAND FACING ARROW.
2. TWO SIGNS SHALL BE USED AT EACH COMMERCIAL ENTRANCE PLACED BACK-TO-BACK: ONE WITH A RIGHT HAND ARROW (SHOWN) SHALL BE PLACED ON THE NEAR RIGHT SIDE THE DRIVEWAY AND ONE WITH A LEFT HAND ARROW SHALL BE PLACED ON THE FAR LEFT SIDE OF THE DRIVEWAY.
3. SIGNS TO BE PAID FOR AS ITEM "TEMPORARY INFORMATION SIGNING".

MODEL: Default  
 FILE NAME: p:\u\h\room.dot\illinois.gov\PI\DOT\Documents\DOT - Off\ces\District 1\Project\147320\CADD\ta\Design\Std.dgn

USER NAME = gorengautab	DESIGNED -	REVISED - C. JUCIUS 02-15-07
	DRAWN -	REVISED -
PLOT SCALE = 98.5294' / in.	CHECKED -	REVISED -
PLOT DATE = 1/8/2021	DATE -	REVISED -

**STATE OF ILLINOIS  
 DEPARTMENT OF TRANSPORTATION**

**DRIVEWAY ENTRANCE SIGNING**

SCALE: NONE SHEET 1 OF 2 SHEETS STA. TO STA.

F.A. U. RTE.	SECTION	COUNTY	TOTAL SHEETS	SHEET NO.
3729	2020-074-I	COOK	14	14A
<b>TC-26</b>			CONTRACT NO. 62L52	
ILLINOIS		FED. AID PROJECT		