

SOUTH GRAND AVE-WABASH SUBWAY
 DETAIL OF SECTIONS OF RETAINING WALL ON SOUTH
 SIDE OF SOUTH GRAND AVE AND EAST OF WABASH RY.
 SCALE 1/2" = 1'

All reinforcing to be 1/2" round deformed bars placed
 on V centers both ways.

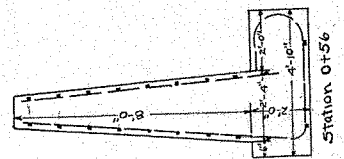

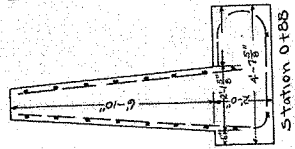

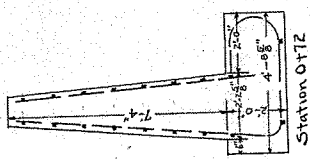
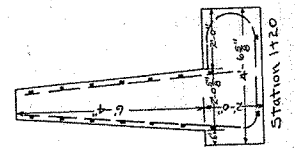
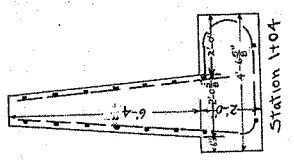
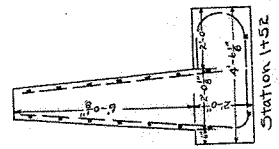
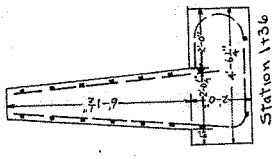
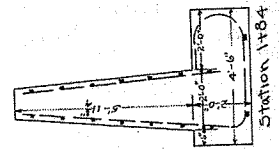
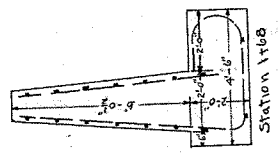
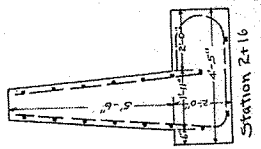
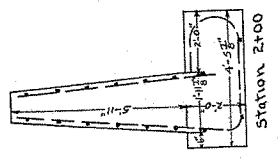
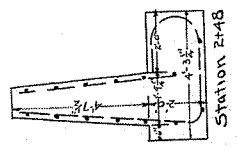
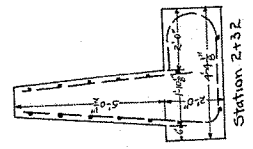
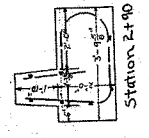
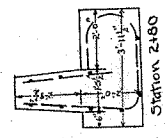
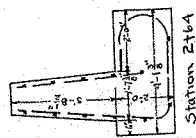
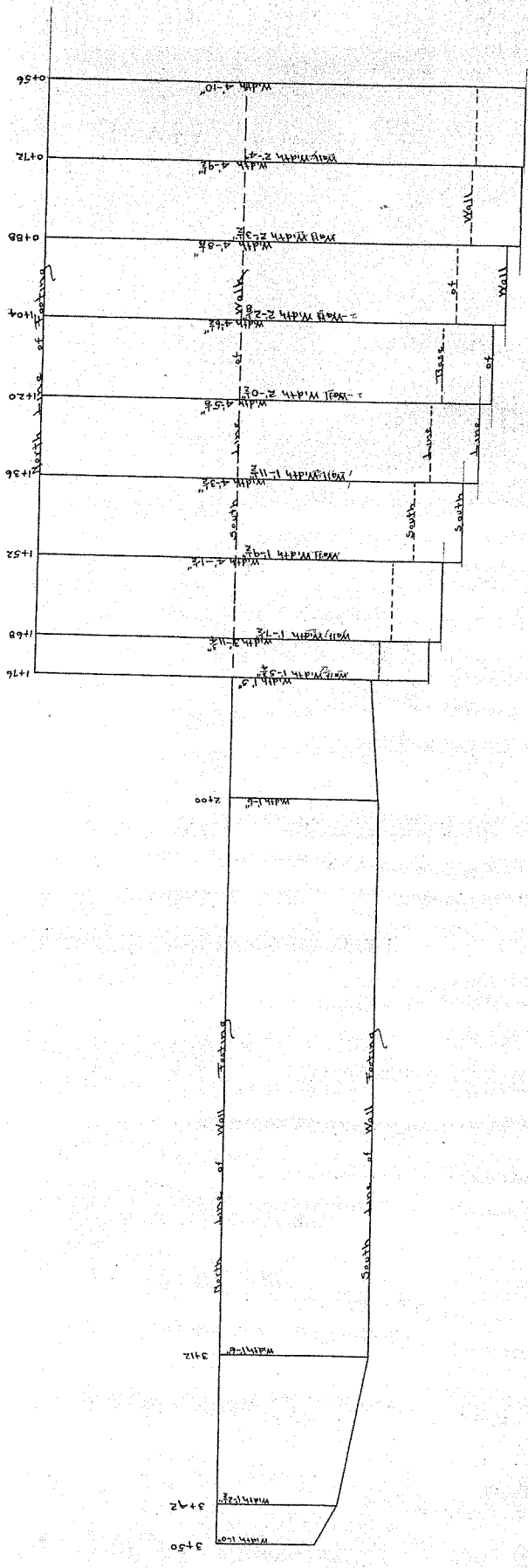
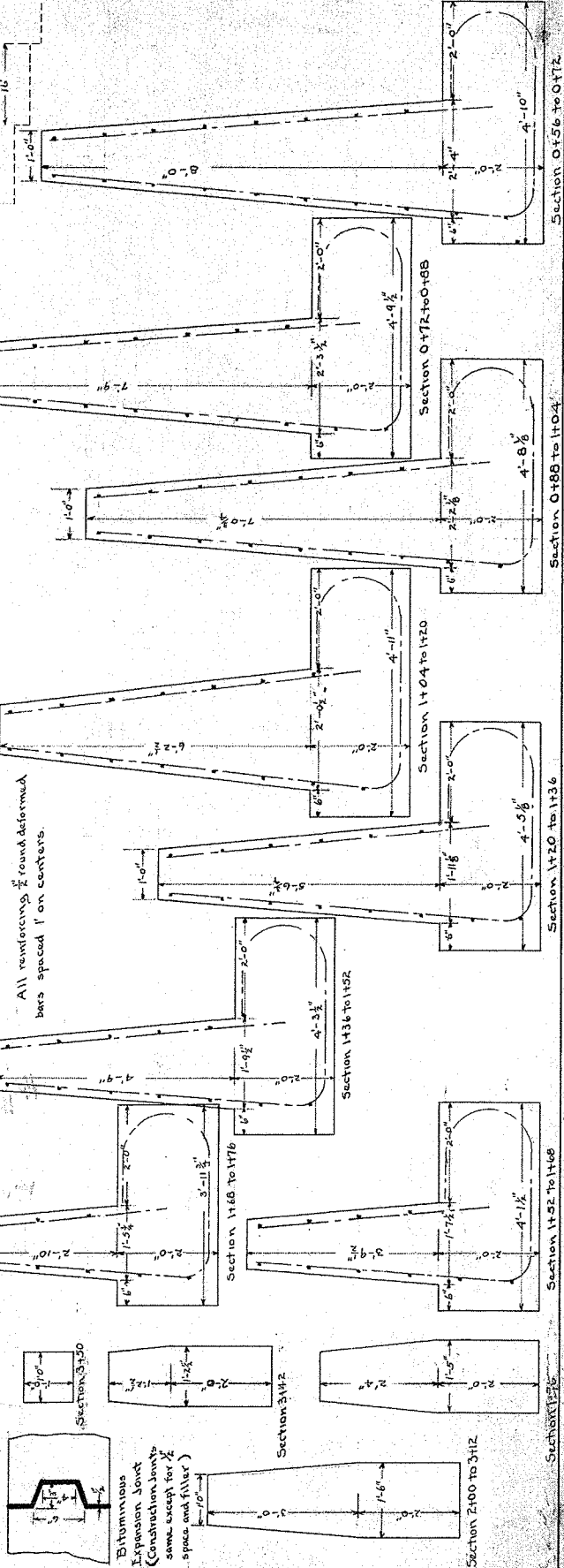
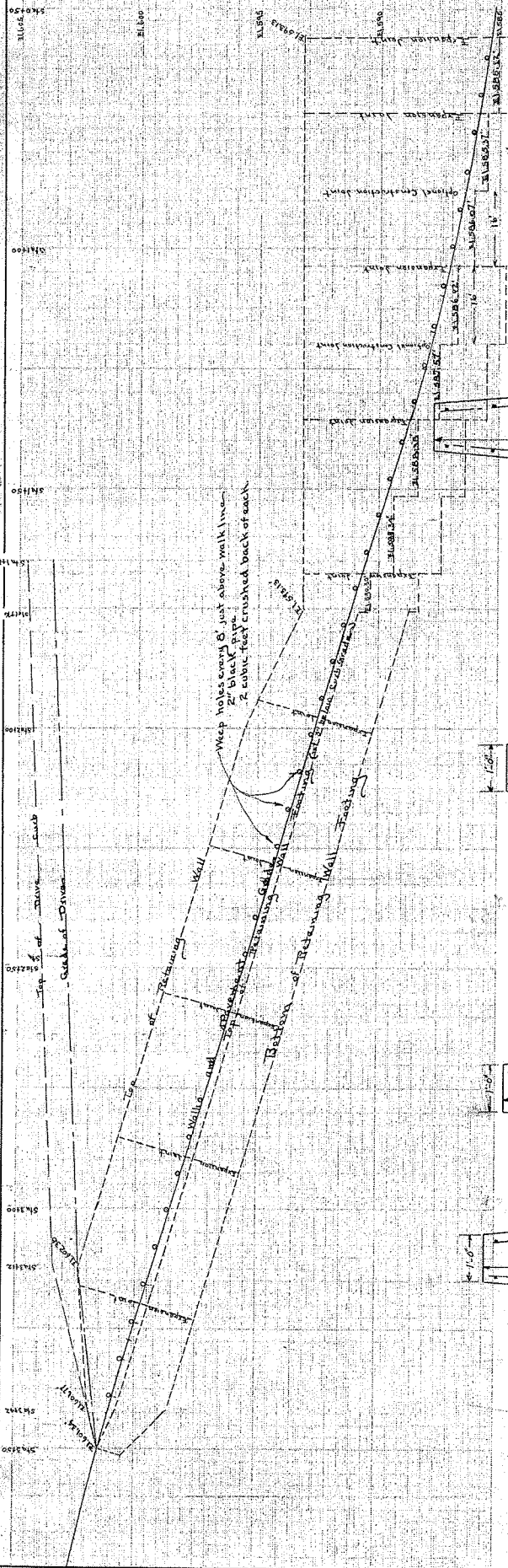

All reinforcing $\frac{1}{2}$ " round deformed bars spaced 1' on centers.

