

F.A.S. RTE.	SECTION	COUNTY	TOTAL SHEETS	SHEET NO.
331	CM21-5013	VERMILION	11	1
		ILLINOIS	CONTRACT NO. 70F10	

FOR INDEX OF SHEETS, SEE SHEET NO. 2  
FOR SUMMARY OF QUANTITIES, SEE SHEETS NO. 3

STATE OF ILLINOIS 04-23-2021 LETTING ITEM 192  
DEPARTMENT OF TRANSPORTATION

# PROPOSED HIGHWAY PLANS

FAS ROUTE 331 (CH 10)  
SECTION CM21-5013  
PROJECT  
CONTRACT MAINTENANCE PATCHING  
VERMILION COUNTY

C-95-022-21

US 150 IN OAKWOOD TO CATLIN HOMER RD

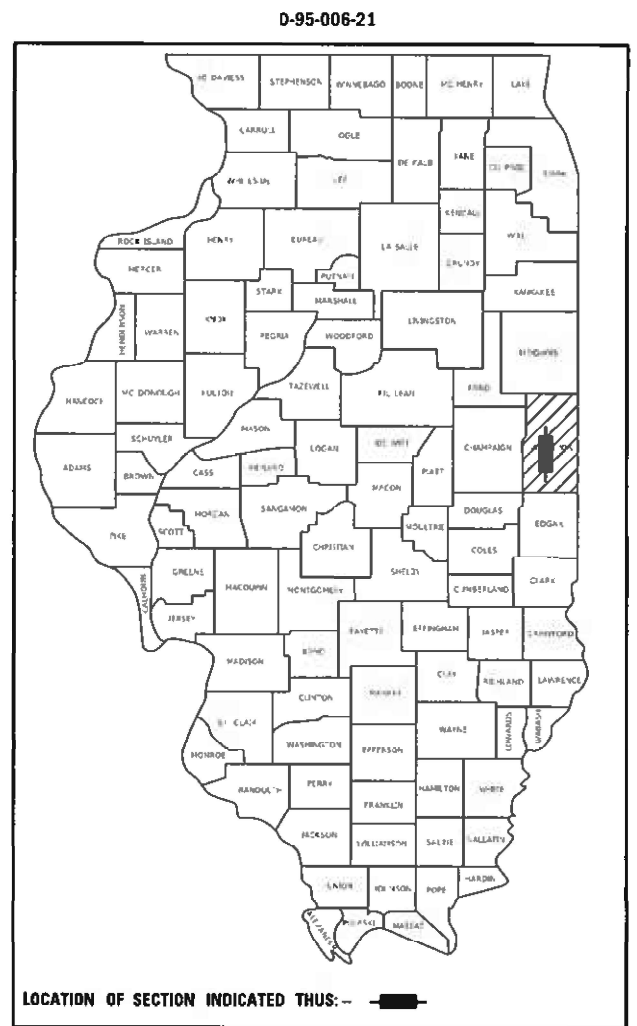

**TRAFFIC DATA**

	LEG -A-	LEG -B-	LEG -C-
2020 ADT =	2,600 0	2,100 0	1,700 0
PL% =	83 5	89 0	88 8
SU% =	7 7	6 7	6 5
RL% =	3 8	4 3	4 7

**TRAFFIC DATA LOCATIONS**

LEG -A- = FAS 331 FROM US 150 TO LEE ST IN OAKWOOD  
LEG -B- = FAS 331 FROM LEE ST IN OAKWOOD TO TR 317  
LEG -C- = FAS 331 FROM TR 317 TO CATLIN/HOMER RD

**FUNCTIONAL CLASSIFICATION**  
MAJOR COLLECTOR

**TOWNSHIP:**  
OAKWOOD

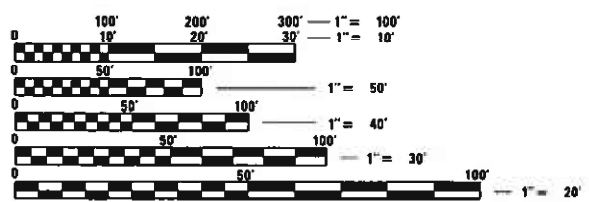

FULL SIZE PLANS HAVE BEEN PREPARED USING STANDARD ENGINEERING SCALES. REDUCED SIZED PLANS WILL NOT CONFORM TO STANDARD SCALES. IN MAKING MEASUREMENTS ON REDUCED PLANS, THE ABOVE SCALES MAY BE USED.

J.U.L.I.E.  
JOINT UTILITY LOCATION INFORMATION FOR EXCAVATORS  
1-800-892-0123  
OR 811

**PROJECT ENGINEER: JASON W. STULTS**  
**DESIGNERS: ROBERT A. HODGSON**  
**BRANDON C. SCHULTZ**  
**PHONE: (217)-465-4181**  
**CONTRACT NO. 70F10**

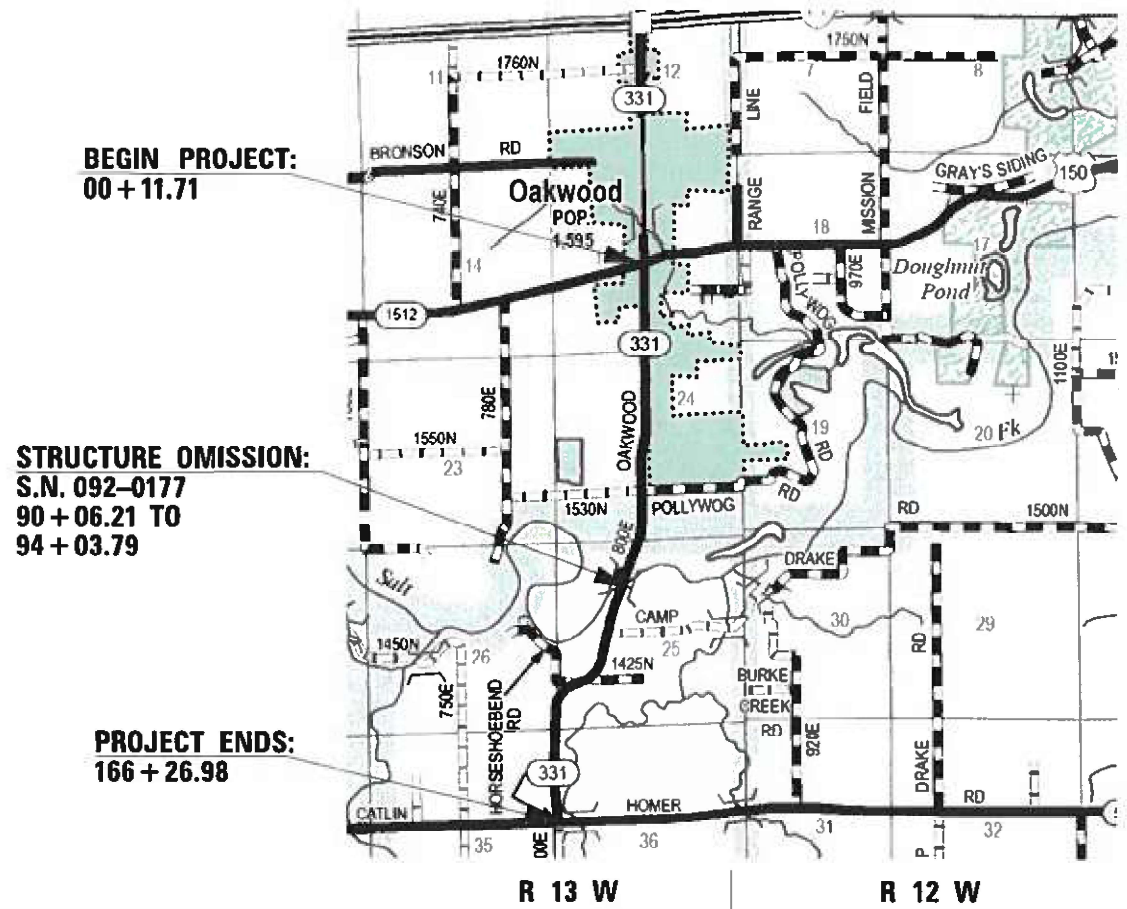

GROSS LENGTH = 16,615.27 FT. = 3.147 MILES  
NET LENGTH = 16,217.69 FT. = 3.072 MILES

STATE OF ILLINOIS  
DEPARTMENT OF TRANSPORTATION

SUBMITTED 11/9 2021  
Kensila Barnett  
REGIONAL ENGINEER

March 19, 2021  
Jason W. Stults  
ENGINEER OF DESIGN AND ENVIRONMENT

March 19, 2021  
Jason W. Stults  
DIRECTOR OF HIGHWAYS PROJECT IMPLEMENTATION

**PRINTED BY THE AUTHORITY  
OF THE STATE OF ILLINOIS**





# 1 EXISTING TYPICAL SECTION F.A.S. 331

STATION 00+11.71 TO STATION 24+10.00

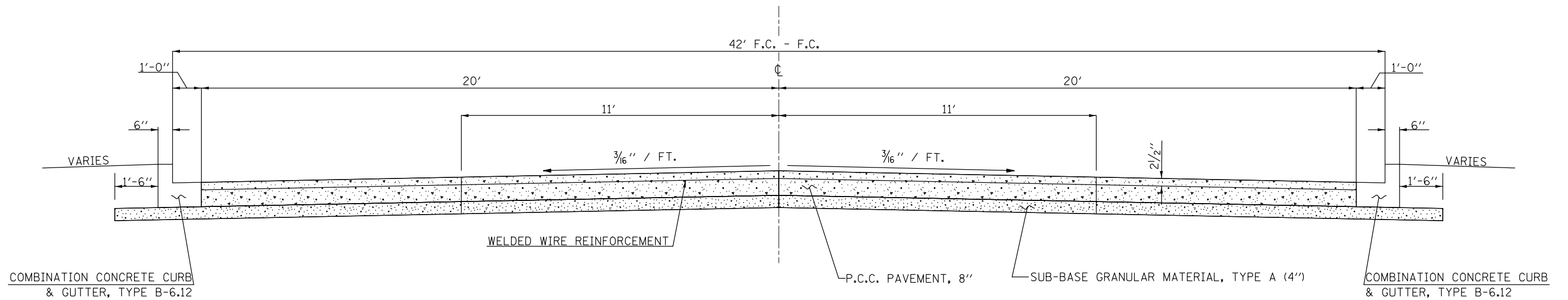

# 2 EXISTING TYPICAL SECTION F.A.S. 331

STATION 24+10.00 TO STATION 25+00.00

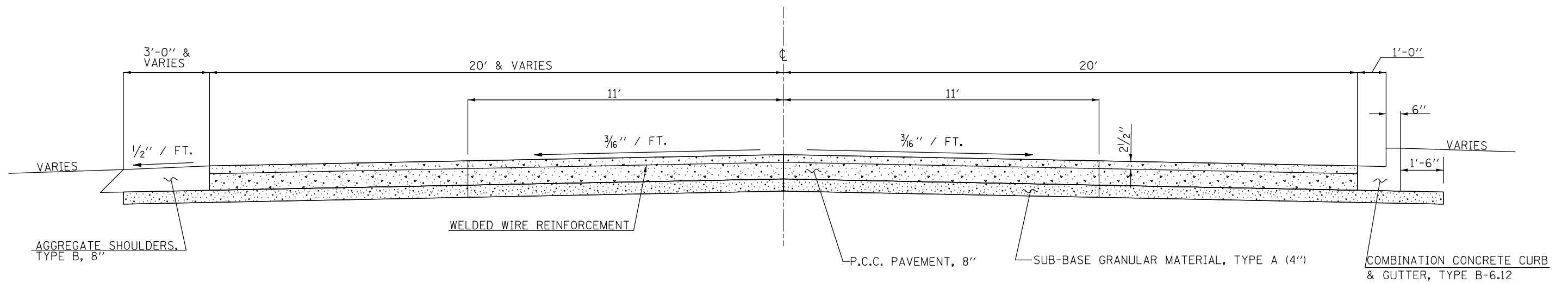

FILE NAME =	USER NAME = DietzCB	DESIGNED -	REVISED -	<b>STATE OF ILLINOIS DEPARTMENT OF TRANSPORTATION</b>	<b>TYPICAL SECTIONS</b>			F.A.S. RTE.	SECTION	COUNTY	TOTAL SHEETS	SHEET NO.	
pw:\planroom.dot.illinois.gov\PIDOT\Documents\IDOT Offices\District 5\Projects\0570F10\Drawings\CAD\Drawings\0570F10-sh-typical.dwg		DRAWN -	REVISED -		SCALE:	SHEET 1 OF 5 SHEETS	STA.	TO STA.	331	CM21-5013	VERMILION	11	4
#MODELNAME#	PLOT DATE = 1/15/2021	CHECKED -	REVISED -					CONTRACT NO. 70F10			ILLINOIS FED. AID PROJECT		
		DATE -	REVISED -										



### 3 EXISTING TYPICAL SECTION F.A.S. 331

STATION 25+00.00 TO STATION 28+50.00

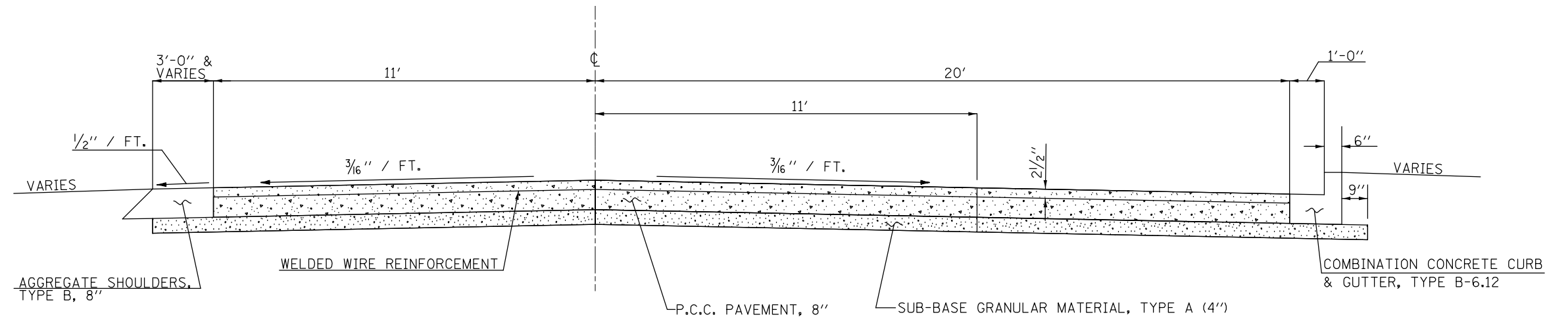

### 4 EXISTING TYPICAL SECTION F.A.S. 331

STATION 28+50.00 TO STATION 30+00.00

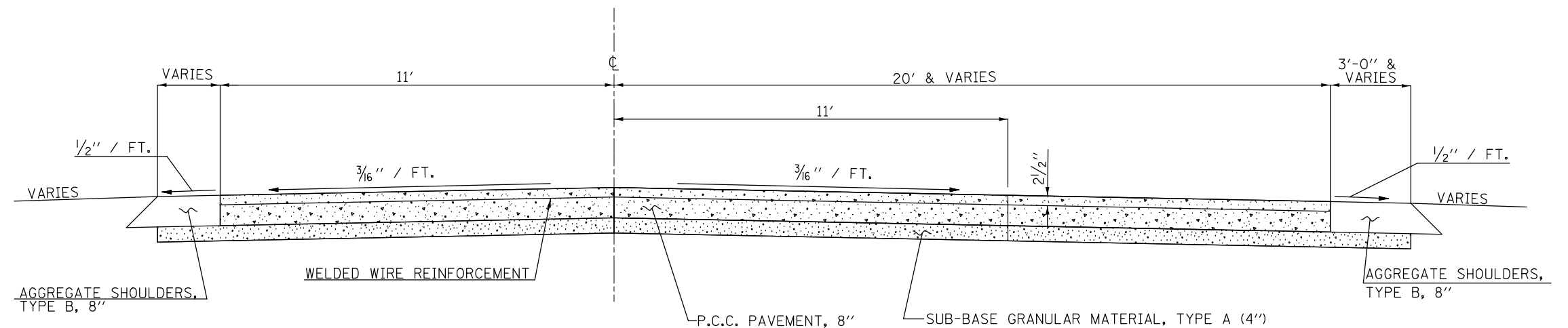

FILE NAME =	USER NAME = DietzCB	DESIGNED -	REVISED -	<b>STATE OF ILLINOIS DEPARTMENT OF TRANSPORTATION</b>	<b>TYPICAL SECTIONS</b>			F.A.S. RTE.	SECTION	COUNTY	TOTAL SHEETS	SHEET NO.		
p:\planning\dot.illinois.gov\PIDOT\Documents\IDOT Offices\District 5\Projects\0570F\00DRAWING\CADsheets\0570F10-sh-typical.dwg		CHECKED -	REVISED -		SCALE:	SHEET 2	OF 5 SHEETS	STA.	TO STA.	331	CM21-5013	VERMILION	11	5
#MODELNAME#	PLOT SCALE = 40.0000' / in.	DATE -	REVISED -								CONTRACT NO. 70F10			
	PLOT DATE = 1/15/2021										ILLINOIS FED. AID PROJECT			

### 5 EXISTING TYPICAL SECTION F.A.S. 331

STATION TO STATION  
30+00.00 45+19.34

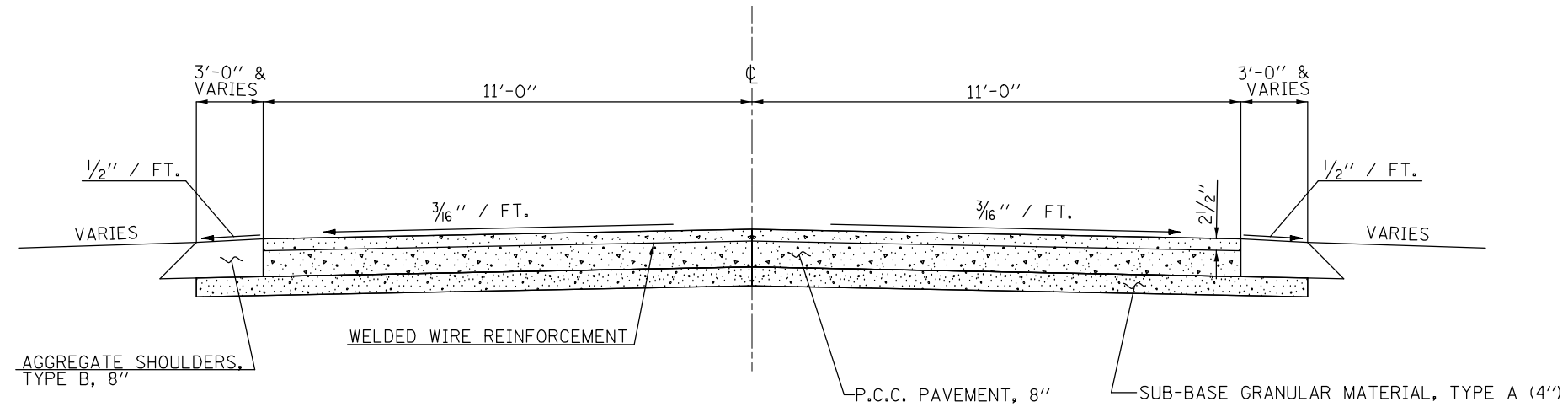

### 6 EXISTING TYPICAL SECTION F.A.S. 331

\*STRUCTURE OMISSION 90+06.21 TO 94+03.79 - S.N. 092-0177

STATION TO STATION  
45+19.34 90+06.21\*  
\*94+03.79 102+50.00  
107+00.00 166+26.98

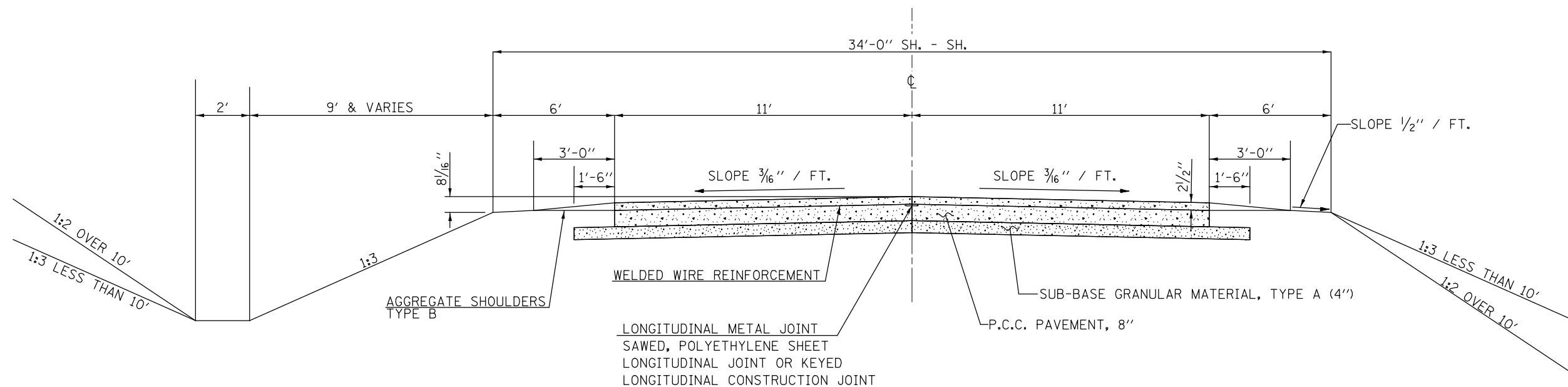

FILE NAME =	USER NAME = DietzCB	DESIGNED -	REVISED -	<b>STATE OF ILLINOIS DEPARTMENT OF TRANSPORTATION</b>	<b>TYPICAL SECTIONS</b>			F.A.S. R.E.	SECTION	COUNTY	TOTAL SHEETS	SHEET NO.
p:\planning\dot.illinois.gov\PIDOT\Documents\IDOT Offices\District 5\Projects\0570F10\Drawings\CAD\Drawings\0570F10-sh-typical.dwg		DRAWN -	REVISED -		331	CM21-5013	VERMILION	11	6			
	PLOT SCALE = 40.0000' / in.	CHECKED -	REVISED -		CONTRACT NO. 70F10							
#MODELNAME#	PLOT DATE = 1/15/2021	DATE -	REVISED -		ILLINOIS FED. AID PROJECT							

SCALE: SHEET 3 OF 5 SHEETS STA. TO STA.

# 6.A EXISTING TYPICAL SECTION F.A.S. 331

STATION 96+29.33 TO STATION 98+20.00

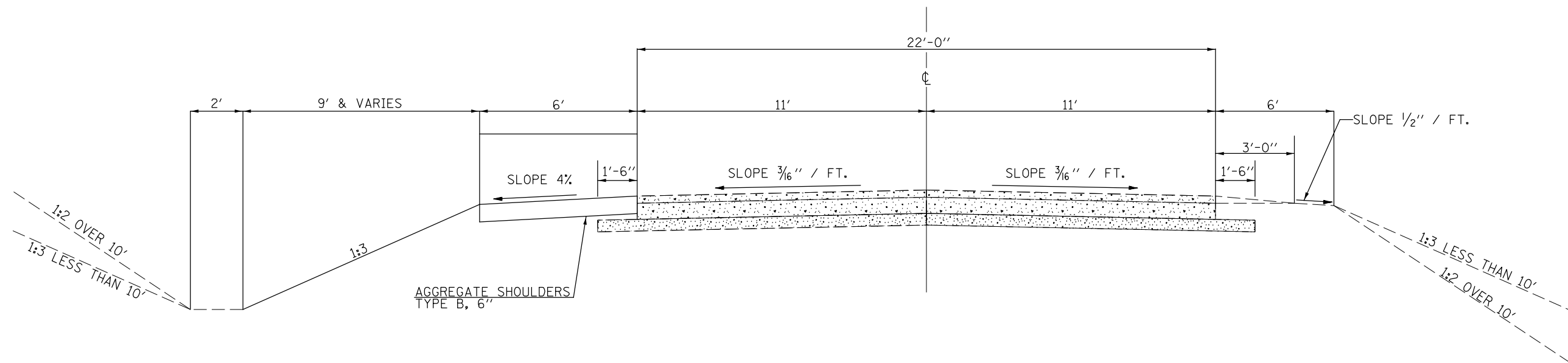

# 6.B EXISTING TYPICAL SECTION F.A.S. 331

STATION 98+20.00 TO STATION 102+11.83

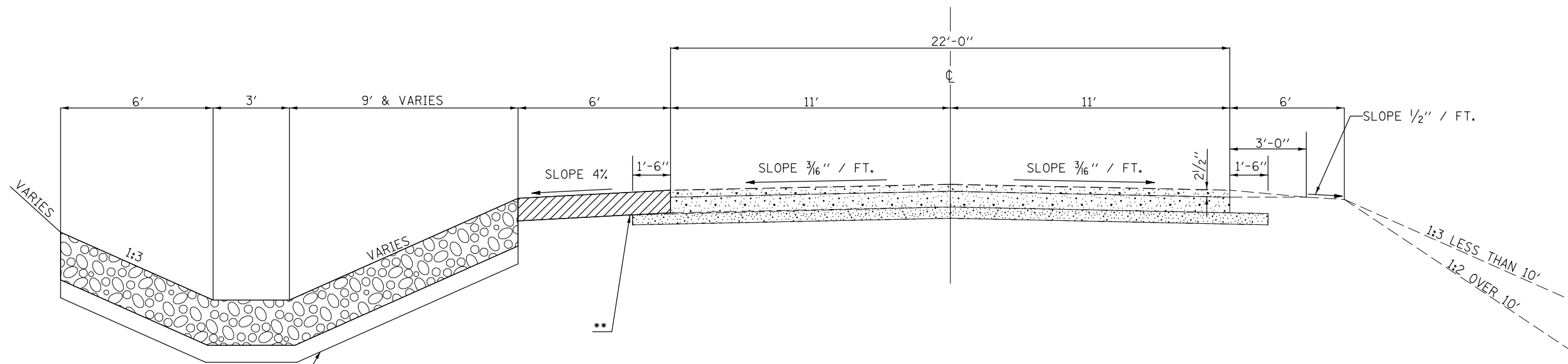

STONE RIPRAP CLASS A4, 16"  
W/ 6" BEDDING STONE AND  
FILTER FABRIC

\*\* AGGREGATE SHOULDERS, TYPE B, 6" FROM STA. 98+20.00 TO STA. 98+50.00  
HOT-MIX ASPHALT SHOULDERS, 8" FROM STA. 98+50.00 TO STA. 102+11.83

FILE NAME =	USER NAME = DietzCB	DESIGNED -	REVISED -	<b>STATE OF ILLINOIS DEPARTMENT OF TRANSPORTATION</b>	<b>TYPICAL SECTIONS</b>			F.A.S. RTE.	SECTION	COUNTY	TOTAL SHEETS	SHEET NO.
pw:\planroom.dot.illinois.gov\PIDOT\Documents\IDOT Offices\District 5\Projects\0570F10\Drawings\CAD\Sheets\0570F10-sh-typical.dgn	DESIGNED -	REVISED -	331					CM21-5013	VERMILION	11	7	
#MODELNAME#	PLOT SCALE = 40.0000' / in.	CHECKED -	REVISED -		SCALE: SHEET 4 OF 5 SHEETS STA. TO STA.			CONTRACT NO. 70F10				
	PLOT DATE = 1/15/2021	DATE -	REVISED -		ILLINOIS FED. AID PROJECT							

## 7 EXISTING TYPICAL SECTION F.A.S. 331

STATION 102+50.00 TO STATION 106+22.00 ⑧

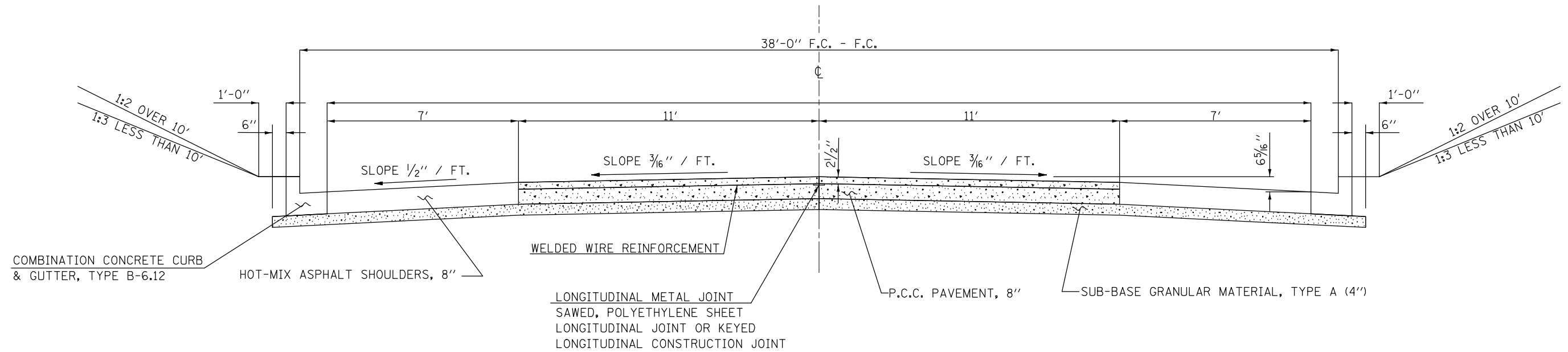

## 8 EXISTING TYPICAL SECTION F.A.S. 331

STATION 106+22.00 TO STATION 107+00.00 ⑥

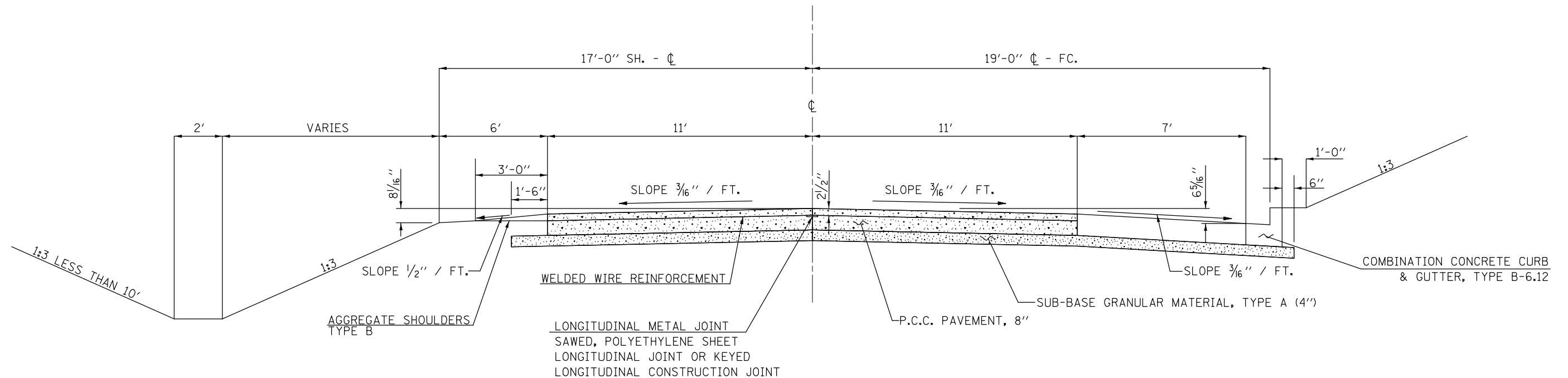

FILE NAME =	USER NAME = DietzCB	DESIGNED -	REVISED -	<b>STATE OF ILLINOIS DEPARTMENT OF TRANSPORTATION</b>	<b>TYPICAL SECTIONS</b>	F.A.S. RTE. 331	SECTION CM21-5013	COUNTY VERMILION	TOTAL SHEETS 11	SHEET NO. 8
<p style="font-size: small;">p:\planningroom\dot.illinois.gov\PIDOT\Documents\IDOT Offices\District 5\Projects\0570F10\Drawings\CAD\Drawings\0570F10-sh-typical.dwg</p>				SCALE: SHEET 5 OF 5 SHEETS STA. TO STA.		CONTRACT NO. 70F10				
<p style="font-size: small;">#MODELNAME#</p>						ILLINOIS FED. AID PROJECT				

# SCHEDULE OF QUANTITIES PATCHING SCHEDULE

DIRECTION	STATION	LENGTH (FOOT)	WIDTH (FOOT)	44200934 CLASS B PATCHES, TYPE II, 8 INCH (SQ YD)	44200942 CLASS B PATCHES, TYPE III, 8 INCH (SQ YD)	44201298 DOWEL BARS (EACH)	44213200 SAW CUTS (FOOT)	44200050 WELDED WIRE REINFORCEMENT (SQ YD)
NB	74+04.00	6	12	8.0	--	20	48	--
NB	78+24.00	6	12	8.0	--	20	48	--
NB	79+46.00	6	12	8.0	--	20	48	--
NB	82+92.00	6	12	8.0	--	20	48	--
NB	83+24.00	6	12	8.0	--	20	48	--
NB	83+65.00	6	12	8.0	--	20	48	--
NB	84+84.00	6	12	8.0	--	20	48	--
NB	85+34.00	6	12	8.0	--	20	48	--
NB	86+33.00	6	12	8.0	--	20	48	--
NB	86+51.00	6	12	8.0	--	20	48	--
NB	96+20.00	6	12	8.0	--	20	48	--
NB	96+31.00	6	12	8.0	--	20	48	--
NB	98+78.00	6	12	8.0	--	20	48	--
NB	98+93.00	6	12	8.0	--	20	48	--
NB	99+50.00	10	12	13.3	--	20	56	--
NB	100+40.00	6	12	8.0	--	20	48	--
NB	100+89.00	6	12	8.0	--	20	48	--
NB	107+15.00	8	12	10.7	--	20	52	--
NB	107+45.00	6	12	8.0	--	20	48	--
NB	107+97.00	6	12	8.0	--	20	48	--
NB	108+12.00	6	12	8.0	--	20	48	--
NB	109+46.00	6	12	8.0	--	20	48	--
SB	72+61.00	6	12	8.0	--	20	48	--
SB	73+10.00	6	12	8.0	--	20	48	--
SB	73+36.00	12	12	--	16.0	20	60	16.0
SB	73+55.00	6	12	8.0	--	20	48	--
SB	74+04.00	6	12	8.0	--	20	48	--
SB	75+50.00	6	12	8.0	--	20	48	--
SB	75+74.00	6	12	8.0	--	20	48	--
SB	76+27.00	6	12	8.0	--	20	48	--
SB	76+42.00	6	12	8.0	--	20	48	--
SB	77+99.00	6	12	8.0	--	20	48	--
SB	78+24.00	6	12	8.0	--	20	48	--
SB	78+97.00	6	12	8.0	--	20	48	--
SB	79+46.00	6	12	8.0	--	20	48	--
SB	82+92.00	6	12	8.0	--	20	48	--
SB	83+24.00	6	12	8.0	--	20	48	--
SB	83+40.00	6	12	8.0	--	20	48	--
SB	83+65.00	6	12	8.0	--	20	48	--
SB	84+53.00	6	12	8.0	--	20	48	--
SB	86+33.00	6	12	8.0	--	20	48	--
SB	86+51.00	6	12	8.0	--	20	48	--
SB	87+51.00	6	12	8.0	--	20	48	--
SB	88+02.00	6	12	8.0	--	20	48	--
SB	96+56.00	6	12	8.0	--	20	48	--
SB	98+22.00	6	12	8.0	--	20	48	--
SB	99+75.00	6	12	8.0	--	20	48	--
SB	100+40.00	6	12	8.0	--	20	48	--
SB	100+89.00	6	12	8.0	--	20	48	--
SB	107+86.00	6	12	8.0	--	20	48	--
SB	107+97.00	6	12	8.0	--	20	48	--
SB	108+12.00	6	12	8.0	--	20	48	--
SB	109+46.00	6	12	8.0	--	20	48	--
SB	141+65.00	6	12	8.0	--	20	48	--
SB	170+45.00	6	12	8.0	--	20	48	--
TOTAL =				440.0	16.0	1100.0	2664.0	16.0
ROUND TO :				440.0	16.0	1100.0	2664.0	16.0

MODEL: \\MODEL\NAMES  
 FILE NAME: \\p14m\com\dot\illinois\gov\PIWDOT\Documents\DOT\_Offices\District 5\Projects\0570F10\CAD\DATA\CAD\Faces\0570F10\PatchSchedule.dgn

USER NAME = DietzCB	DESIGNED -	REVISED -
	DRAWN -	REVISED -
PLOT SCALE = 40,0000 */ in.	CHECKED -	REVISED -
PLOT DATE = 1/15/2021	DATE -	REVISED -

**STATE OF ILLINOIS  
DEPARTMENT OF TRANSPORTATION**

**SCHEDULE OF QUANTITIES**

SCALE: SHEET 1 OF 1 SHEETS STA. TO STA.

F.A.S RTE.	SECTION	COUNTY	TOTAL SHEETS	SHEET NO.
331	CM21-5013	VERMILION	11	9
CONTRACT NO. 70F10				
ILLINOIS FED. AID PROJECT				







MODEL: \\MODEL\NAME: FILE: NAME: P:\pub\mcom\m.dwt ILLINOIS.GOR\PWDOT\Documents\DOT\_Offices\Director\_3\Projects\05701\0\CAD\Drawings\CAD\Faces\05701\0\ht-Decor.klg

USER NAME = DietzCB	DESIGNED -	REVISED -
	DRAWN -	REVISED -
PLOT SCALE = 40,0000 * / in.	CHECKED -	REVISED -
PLOT DATE = 1/15/2021	DATE -	REVISED -

**STATE OF ILLINOIS  
DEPARTMENT OF TRANSPORTATION**

**WIDTH RESTRICTION SIGNING LAYOUT**

SCALE: SHEET 1 OF 1 SHEETS STA. TO STA.

F.A.S. RTE.	SECTION	COUNTY	TOTAL SHEETS	SHEET NO.
331	CM21-5013	VERMILION	11	11
CONTRACT NO. 70F10				
ILLINOIS FED. AID PROJECT				