

F.A.P. RTE.	SECTION	COUNTY	TOTAL SHEETS	SHEET NO.
351	3277R	COOK	541	47
STA.		TO STA.		
FED. ROAD DIST. NO.		ILLINOIS FED. AID PROJECT		
CONTRACT NO. 60774				

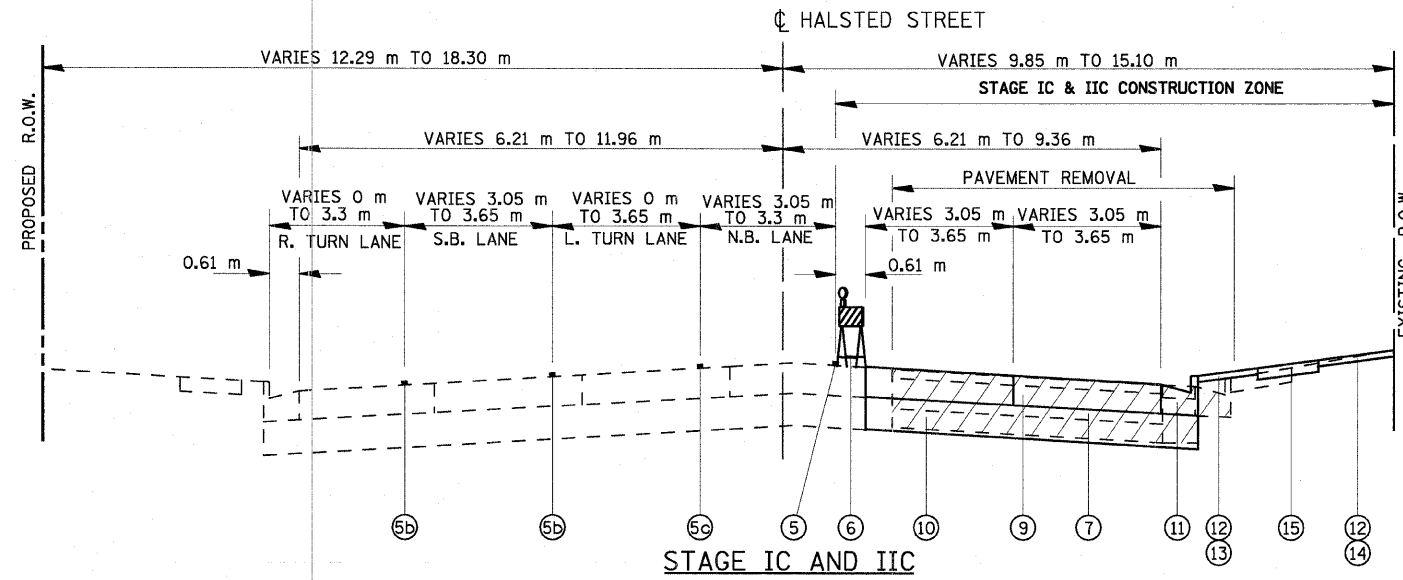
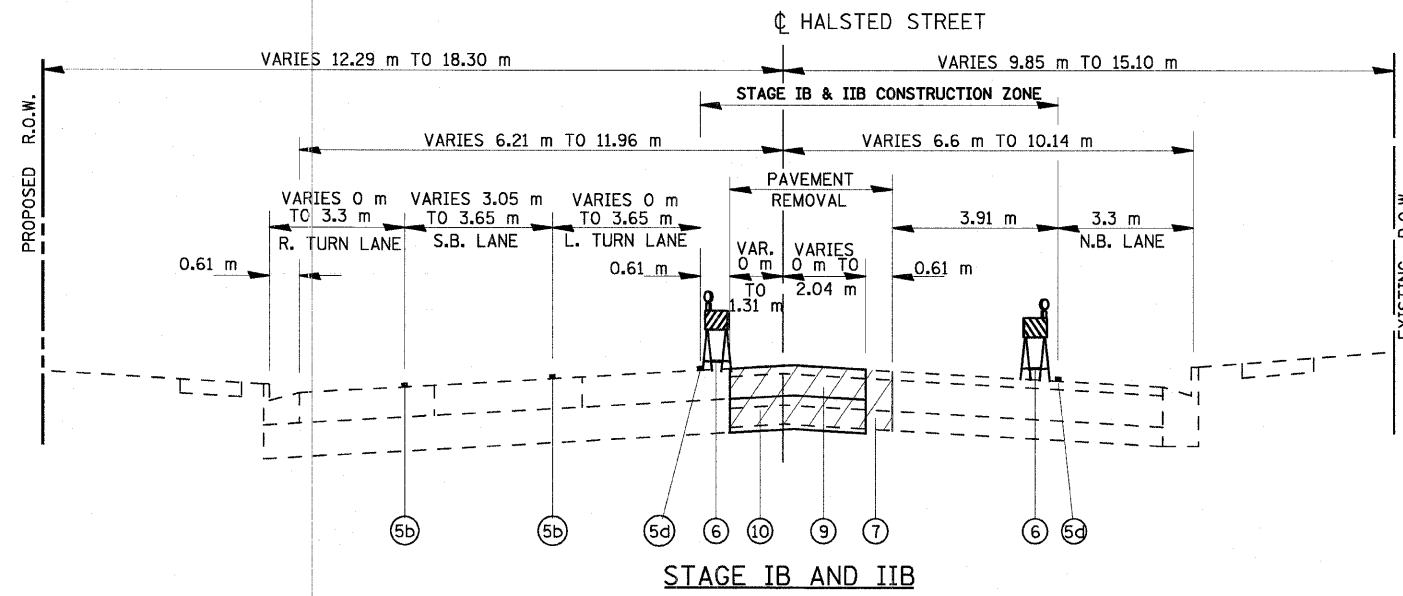
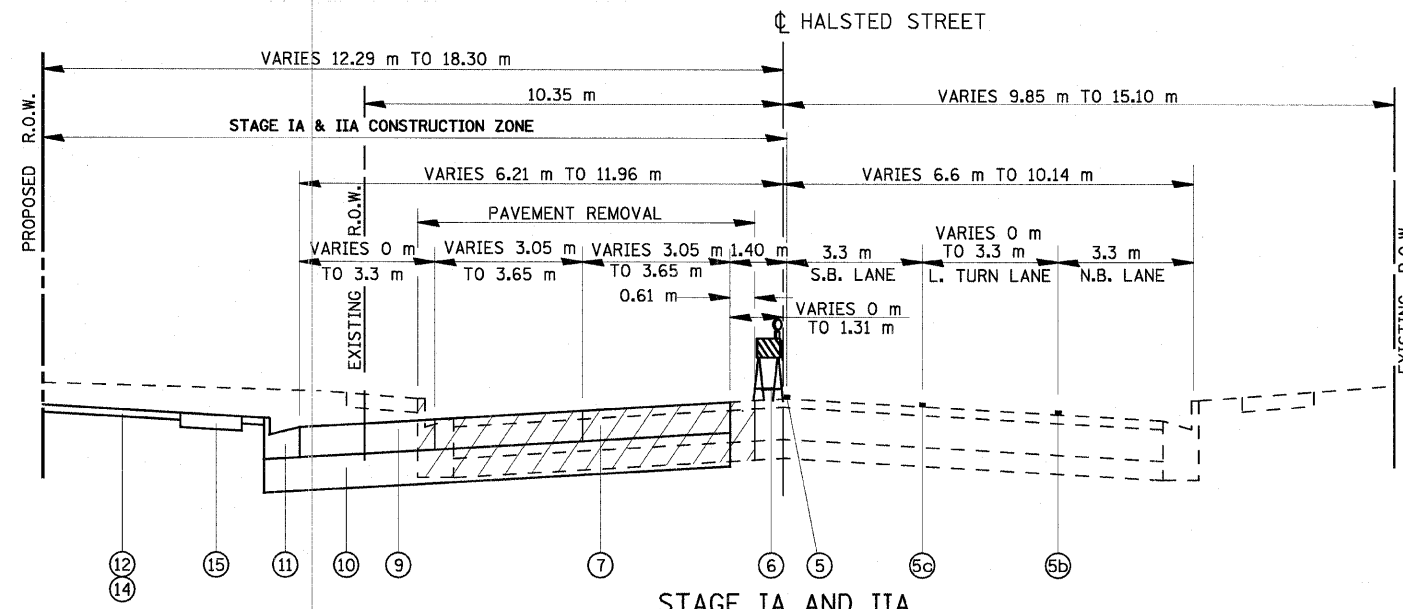

HALSTED STREET
NORTH OF U.S. ROUTE 6

LEGEND, TRAFFIC MAINTENANCE

⑤	PAVEMENT MARKING TAPE, TYPE III 100MM (WHITE)
⑤b	PAVEMENT MARKING TAPE, TYPE III 150MM (WHITE)
⑤c	PAVEMENT MARKING TAPE, TYPE III 100MM (DOUBLE YELLOW)
⑤d	PAVEMENT MARKING TAPE, TYPE III 100MM (YELLOW)
⑥	TEMPORARY LIGHTED BARRICADE, DRUM, OR VERTICAL PANEL
⑦	PAVEMENT REMOVAL
⑨	PORTLAND CEMENT CONCRETE PAVEMENT 260 mm (JOINTED)
⑩	AGGREGATE SUBGRADE 300 mm
⑪	COMBINATION CONCRETE CURB AND GUTTER, TYPE B-15.60*
⑫	TOPSOIL FURNISH AND PLACE, 100MM
⑬	SODDING, SALT TOLERANT
⑭	SODDING
⑮	PORTLAND CEMENT CONCRETE SIDEWALK 125MM

* PROVIDE FOR DEPRESSED CURB AT LOCATIONS OF EXISTING DRIVEWAYS
SEE SHEET MT-41 FOR TEMPORARY DRAINAGE DETAILS, AND MAINTENANCE OF TRAFFIC PLAN SHEETS FOR LOCATIONS OF TEMPORARY INLETS

REVISIONS	
NAME	DATE

ILLINOIS DEPARTMENT OF TRANSPORTATION
US RTE 6 FROM I-294 TO IL RTE 1
MAINTENANCE OF TRAFFIC
TYPICAL SECTIONS

MT-11
DATE 01/28/09

DRAWN BY MRF
CHECKED BY JWK