

F.A.P. RTE.	SECTION	COUNTY	TOTAL SHEETS	SHEET NO.
351	3277R	COOK	541	51
STA. 1+000		TO STA. 1+600		
FED. ROAD DIST. NO.		ILLINOIS FED. AID PROJECT		
CONTRACT NO. 60774				

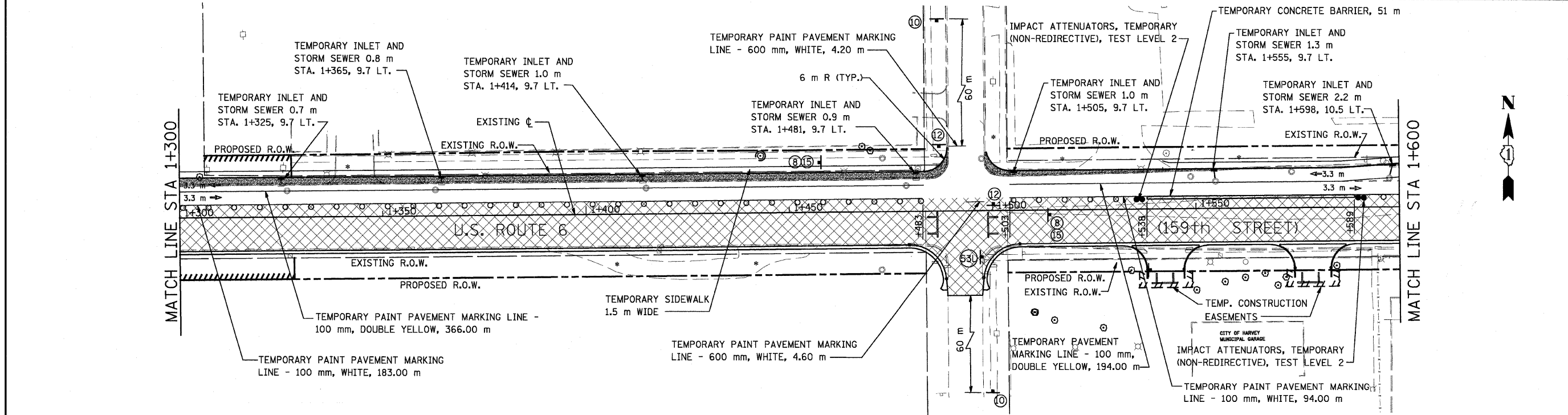
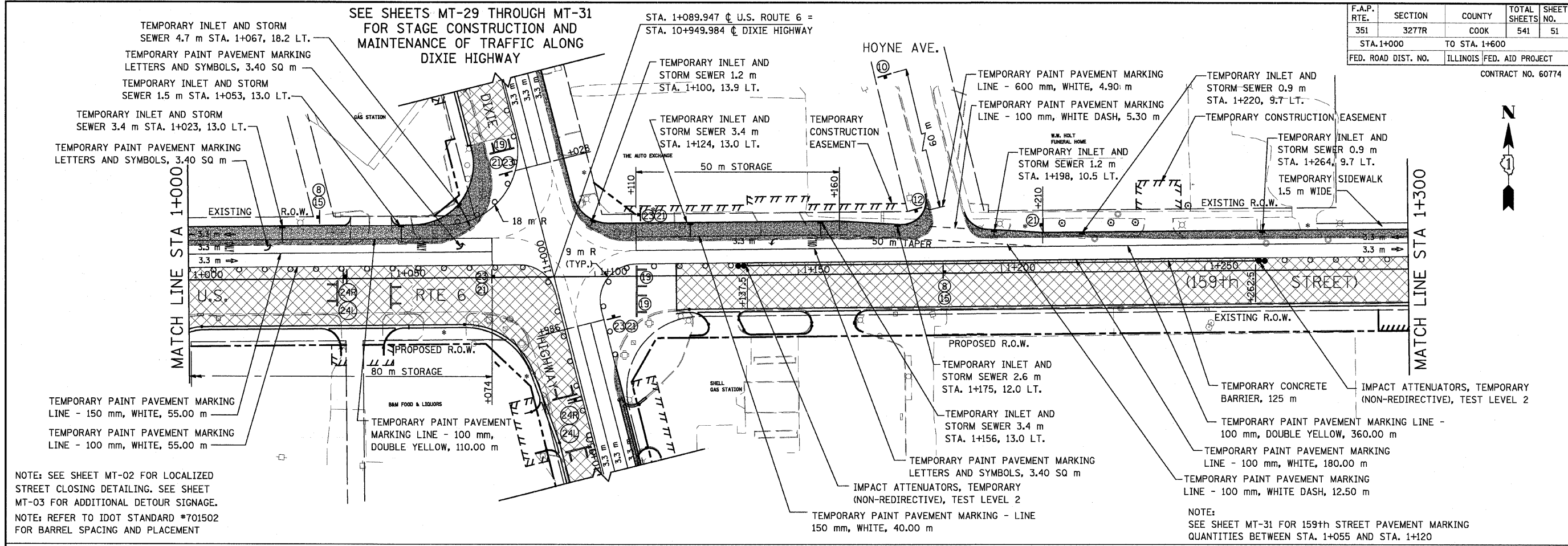

NOTE: REFER TO IDOT STANDARD #701502 FOR BARREL SPACING AND PLACEMENT

NOTE: SEE SHEET MT-02 FOR LOCALIZED STREET CLOSING DETAILING. SEE SHEET MT-03 FOR ADDITIONAL DETOUR SIGNAGE.

LEGEND

- CONSTRUCTION WORK ZONE
- TEMPORARY PAVEMENT WITH TEMP. C&G (PAID FOR AS C&G TY. B-15.60)
- * DRIVEWAY TO BE CLOSED

REVISIONS

NAME	DATE

ILLINOIS DEPARTMENT OF TRANSPORTATION
US RTE 6 FROM I-294 TO IL RTE 1
STAGE CONSTRUCTION AND MAINTENANCE OF TRAFFIC
U.S. ROUTE 6 (159th ST.)
STAGE I

MT-15
DATE 01/28/09
DRAWN BY TJJ
CHECKED BY JWK

SCALE IN METERS

URS 100 S. WACKER DR., SUITE 500
CHICAGO, ILLINOIS 60606
TEL. (312) 939-1000
FAX (312) 939-4198