

F.A.P. RTE.	SECTION	COUNTY	TOTAL SHEETS	SHEET NO.
351	3277R	COOK	541	60
STA. 1+600		TO STA. 2+150		
FED. ROAD DIST. NO.		ILLINOIS FED. AID PROJECT		
CONTRACT NO. 60774				

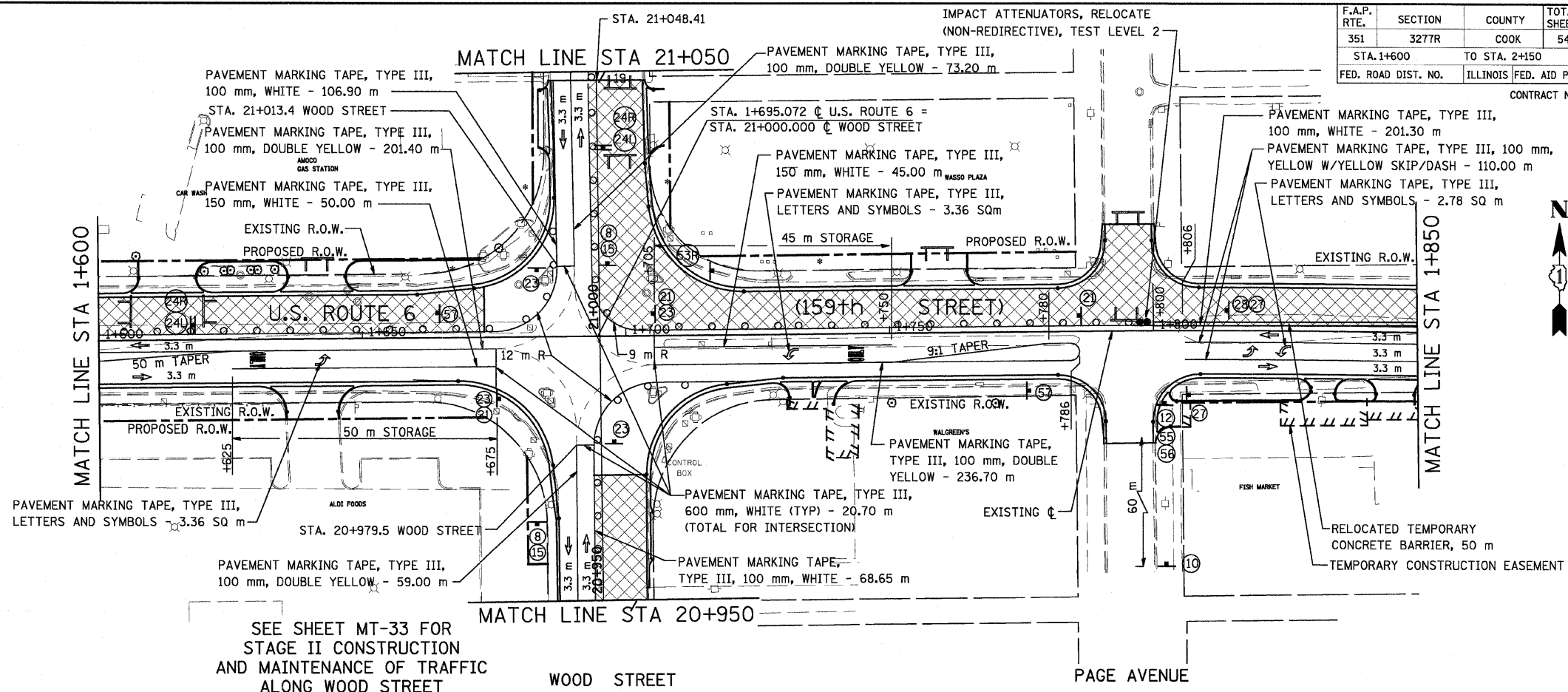

NOTE: SEE SHEET MT-02 FOR LOCALIZED STREET CLOSING DETAILING. SEE SHEET MT-03 FOR ADDITIONAL DETOUR SIGNAGE.

NOTE: REFER TO IDOT STANDARD #701502 FOR BARREL SPACING AND PLACEMENT

SEE SHEET MT-33 FOR STAGE II CONSTRUCTION AND MAINTENANCE OF TRAFFIC ALONG WOOD STREET

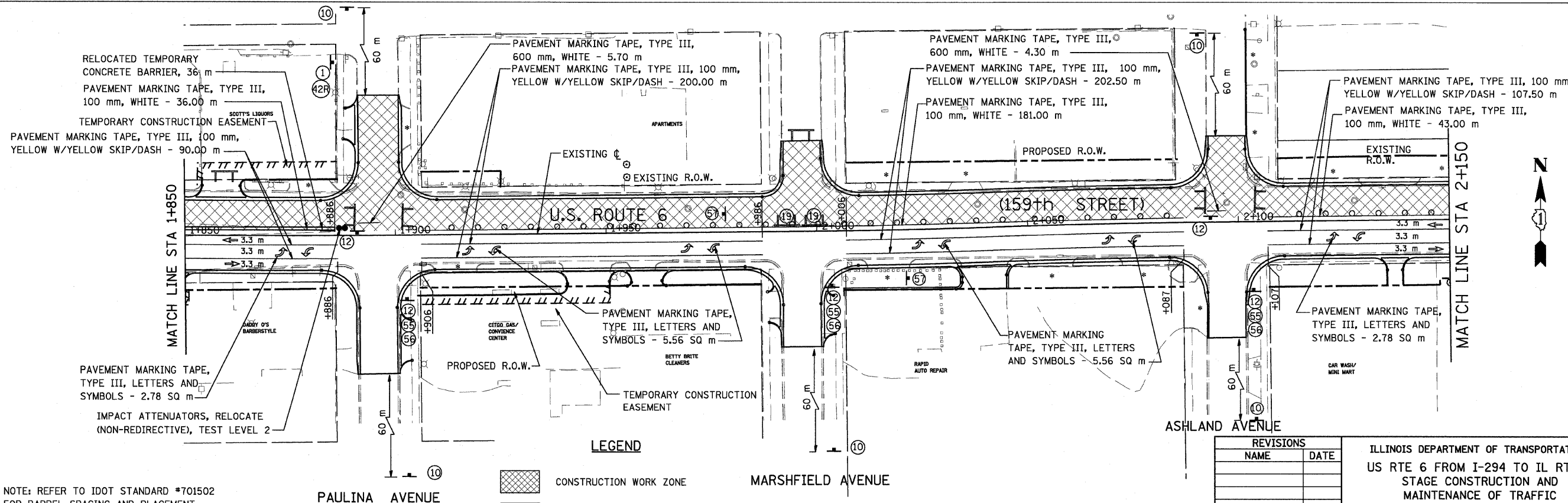

NOTE: REFER TO IDOT STANDARD #701502 FOR BARREL SPACING AND PLACEMENT

NOTE: SEE SHEET MT-02 FOR LOCALIZED STREET CLOSING DETAILING. SEE SHEET MT-03 FOR ADDITIONAL DETOUR SIGNAGE.

- LEGEND**
- CONSTRUCTION WORK ZONE
 - TEMP. PAVEMENT WITH TEMP. C&G (PAID FOR AS C&G TY. B-15.60)
 - DRIVEWAY TO BE CLOSED

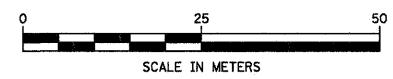

REVISIONS	
NAME	DATE

ILLINOIS DEPARTMENT OF TRANSPORTATION
 US RTE 6 FROM I-294 TO IL RTE 1
 STAGE CONSTRUCTION AND
 MAINTENANCE OF TRAFFIC
 U.S. ROUTE 6 (159th ST.)
 STAGE II

MT-24
 DATE 01/28/09
 DRAWN BY TJJ
 CHECKED BY JWK