

BY \_\_\_\_\_ DATE \_\_\_\_\_  
 ORIGINAL SURVEYED \_\_\_\_\_  
 SURVEY PLOTTED \_\_\_\_\_  
 NOTE BOOK TEMPLATE \_\_\_\_\_  
 AREAS CHECKED \_\_\_\_\_  
 NO. \_\_\_\_\_

BY \_\_\_\_\_ DATE \_\_\_\_\_  
 ORIGINAL SURVEYED \_\_\_\_\_  
 SURVEY PLOTTED \_\_\_\_\_  
 NOTE BOOK TEMPLATE \_\_\_\_\_  
 AREAS CHECKED \_\_\_\_\_  
 NO. \_\_\_\_\_

DRAINAGE STRUCTURE TABLE STA. 20+950 TO STA. 21+100

NO.	STA.	OFFSET	STRUCTURE TYPE/SIZE				FRAME & GRATE	INVERT				RIM ELEV
			MH	CB	INL	OTHER		N	S	E	W	
WD6	20+966.000	9.200 LT	A6				T-1-CL	182.833	182.833	184.010		185.550
WD7	20+968.318	8.375 RT	A3				T-24				184.062	185.398
WD8	21+030.752	9.170 RT	A4				T-24	184.65EX			184.380	185.407
WD9	21+030.752	8.375 LT	A4				T-24		184.331	184.331		185.400

F.A.P. RTE.	SECTION	COUNTY	TOTAL SHEETS	SHEET NO.
351	3277R	COOK	541	136
STA. 20+950		TO STA. 21+100		
FED. ROAD DIST. NO.		ILLINOIS FED. AID PROJECT		
CONTRACT NO. 60774				

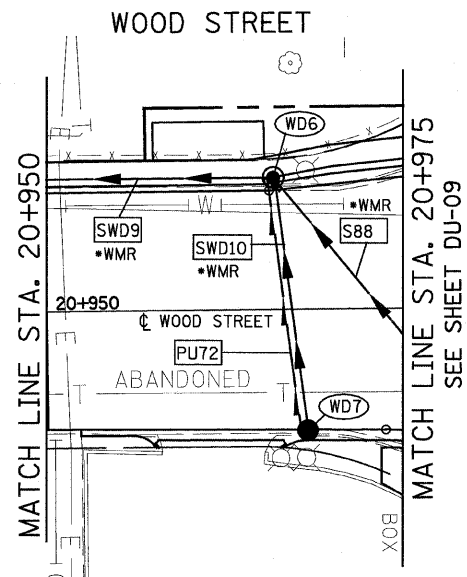

US ROUTE 6  
 STA. 20+975 TO STA. 21+025 -  
 SEE U.S. ROUTE 6 DRAINAGE  
 AND UTILITIES SHEETS  
 FOR PLAN DETAILS

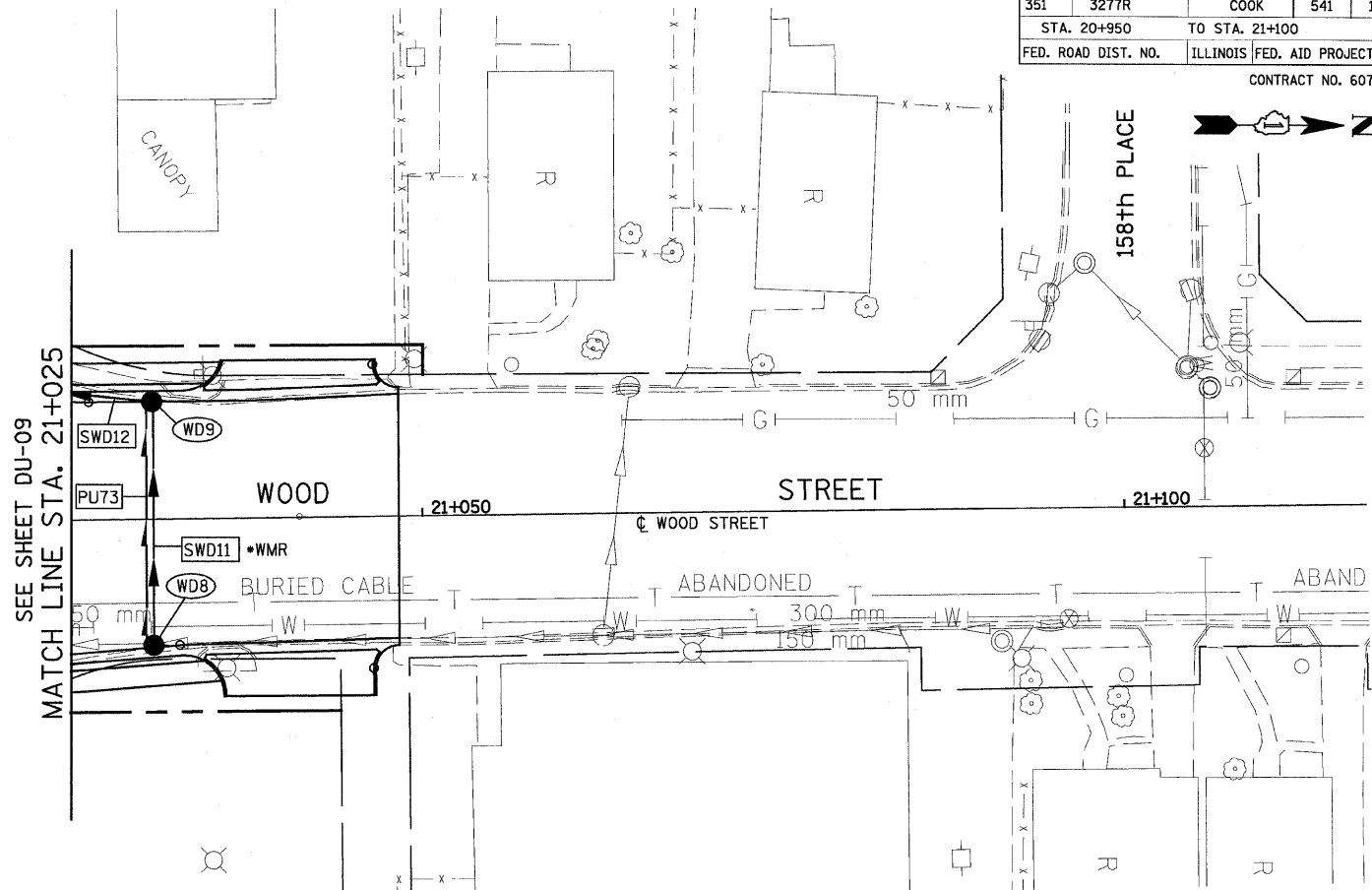

PIPE TABLE STA. 20+950 TO STA. 21+100

PIPE NO.	PIPE LOCATION		DESCRIPTION	DIA. (mm)	L (M)	S (%)	TRENCH BACKFILL VOLUME (CU M)
	FROM STR. #	TO STR. #					
SWD10	WD7	WD6	SS, WMR	300	17.3	0.30	8.9
SWD11	WD8	WD9	SS, WMR	300	16.4	0.30	2.9
SWD12	WD9	86	SS T1, RCP CL IV	300	10.6	0.30	2.7

PIPE UNDERDRAIN 100 mm

PIPE NO.	FROM STR. #	TO STR. #	L (m)
PU72	WD7	WD6	17.3
PU73	WD8	WD9	16.4

DRAINAGE TABLE LEGEND  
 A3 = TYPE C, 0.6m DIAMETER  
 A4 = TYPE A, 1.2m DIAMETER  
 A5 = TYPE A, 1.5m DIAMETER  
 A6 = TYPE A, 1.8m DIAMETER  
 A7 = TYPE A, 2.1m DIAMETER  
 \*WMR = WATER MAIN REQUIREMENTS

NOTE:  
 STRUCTURE OFFSET LOCATIONS GIVEN ON THE PLANS ARE TO THE FOLLOWING POINTS  
 A) FOR STRUCTURES FALLING IN THE CURB LINE - TO THE EDGE OF PAVEMENT  
 B) FOR ALL OTHER STRUCTURE LOCATIONS - TO THE CENTER OF THE STRUCTURE

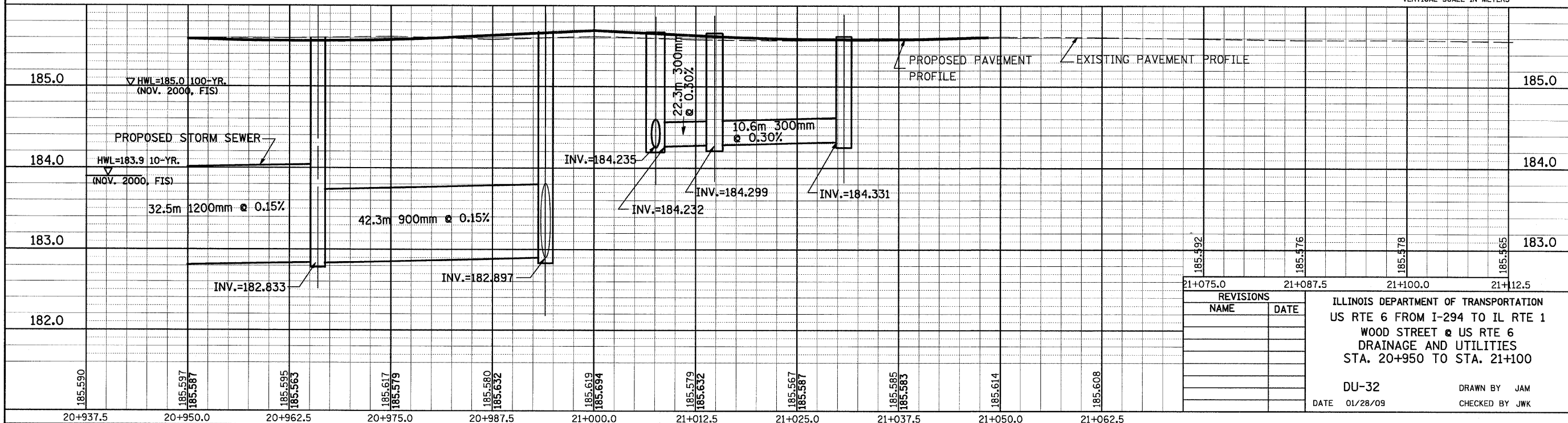
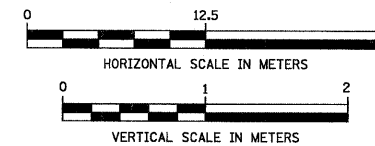

REVISIONS	
NAME	DATE

ILLINOIS DEPARTMENT OF TRANSPORTATION  
 US RTE 6 FROM I-294 TO IL RTE 1  
 WOOD STREET @ US RTE 6  
 DRAINAGE AND UTILITIES  
 STA. 20+950 TO STA. 21+100  
 DU-32  
 DATE 01/28/09  
 DRAWN BY JAM  
 CHECKED BY JWK