

F.A. RTE.	SECTION	COUNTY	TOTAL SHEETS	SHEET NO.
*		COOK	23	1
F.H.W.A. REG.		ILLINOIS	PROJECT	

\*FAP 351 U.S. RTE. 6(159th ST.)

# STATE OF ILLINOIS DEPARTMENT OF TRANSPORTATION RIGHT OF WAY PLANS FOR PROPOSED FEDERAL AID HIGHWAY

ROUTE : FAP 351 U.S. RTE. 6(159th ST.)  
SECTION :  
PROJECT NO. :  
JOB NO. : R90-011-99  
COUNTY : COOK  
LIMITS

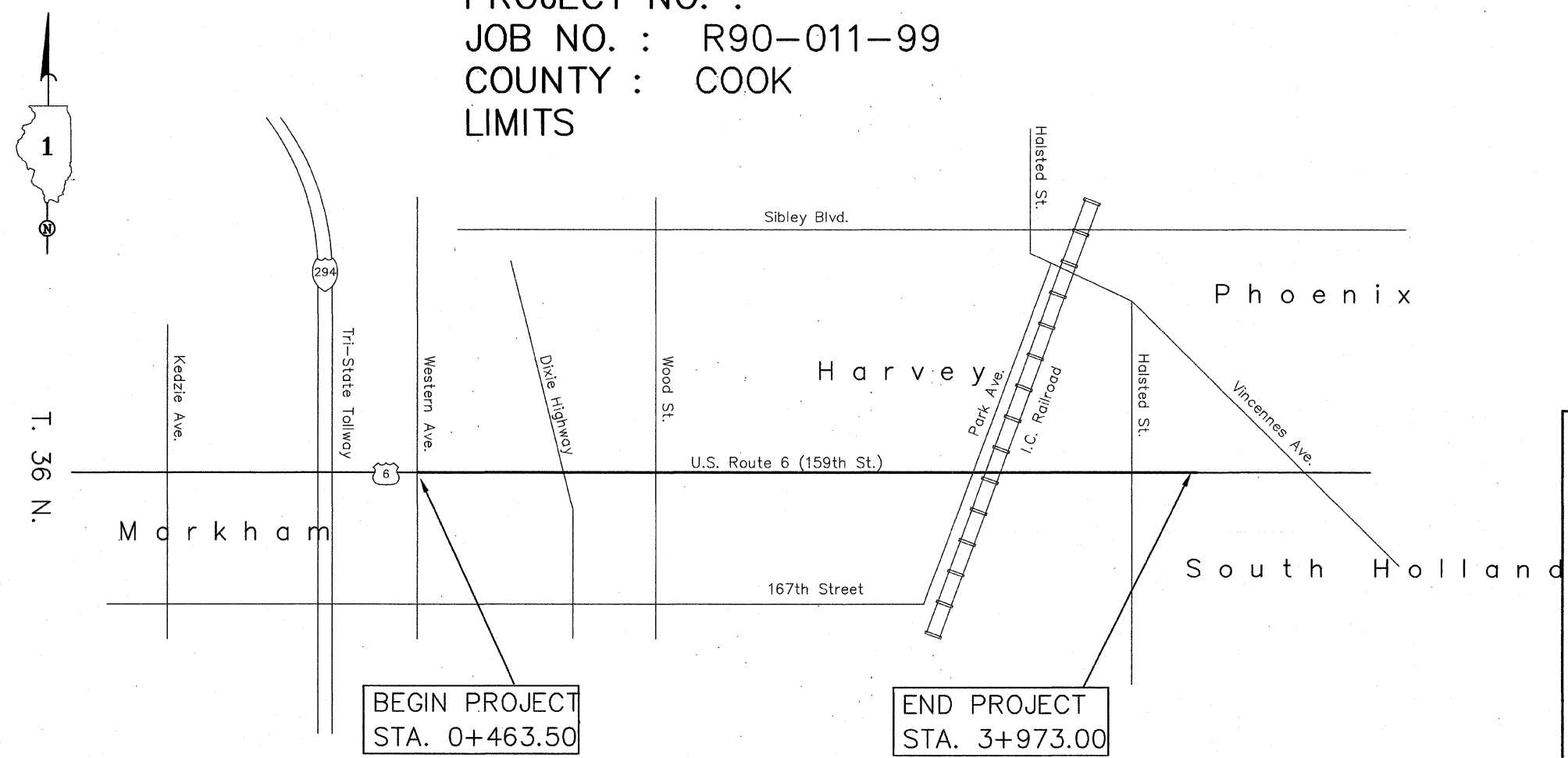
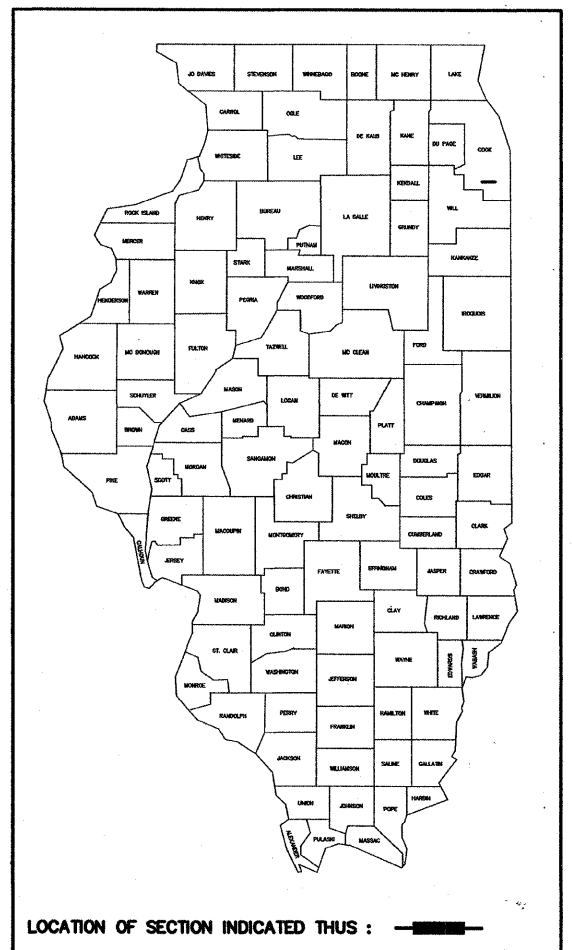

STATE OF ILLINOIS  
DEPARTMENT OF TRANSPORTATION  
DIVISION OF HIGHWAYS

SUBMITTED \_\_\_\_\_ 20 \_\_\_\_  
DISTRICT ENGINEER

EXAMINED \_\_\_\_\_ 20 \_\_\_\_  
DISTRICT RIGHT OF WAY PLANS ENGINEER

PASSED \_\_\_\_\_ 20 \_\_\_\_  
DISTRICT LAND ACQUISITION ENGINEER

REVIEWED \_\_\_\_\_ 20 \_\_\_\_  
CENTRAL BUREAU RIGHT OF WAY PLANS ENGINEER

APPROVED \_\_\_\_\_ 20 \_\_\_\_  
ENGINEER OF LAND ACQUISITION

PROJECT LENGTH = 11,514 L.F. = 2.18 MILES, FAP 351 U.S. RTE. 6

N:\Tech\2000\0161\p01\cover.dwg Thu Dec 05 05:15:02 2002 J.M.