

F.A.P. RTE.	SECTION	COUNTY	TOTAL SHEETS	SHEET NO.
351	3277R	COOK	541	291
STA. 3+250		TO STA. 3+850		
FED. ROAD DIST. NO.		ILLINOIS FED. AID PROJECT		

CONTRACT NO. 60774

**TREE LEGEND**

- (A) STATE STREET MIYABE MAPLE
- (B) AUTUMN SPLENDOR BUCKEYE
- (C) SKYLINE HONEYLOCUST
- (D) KENTUCKY COFFEETREE
- (E) SHINGLE OAK
- (F) RED JEWEL CRABAPPLE
- (G) BUR OAK

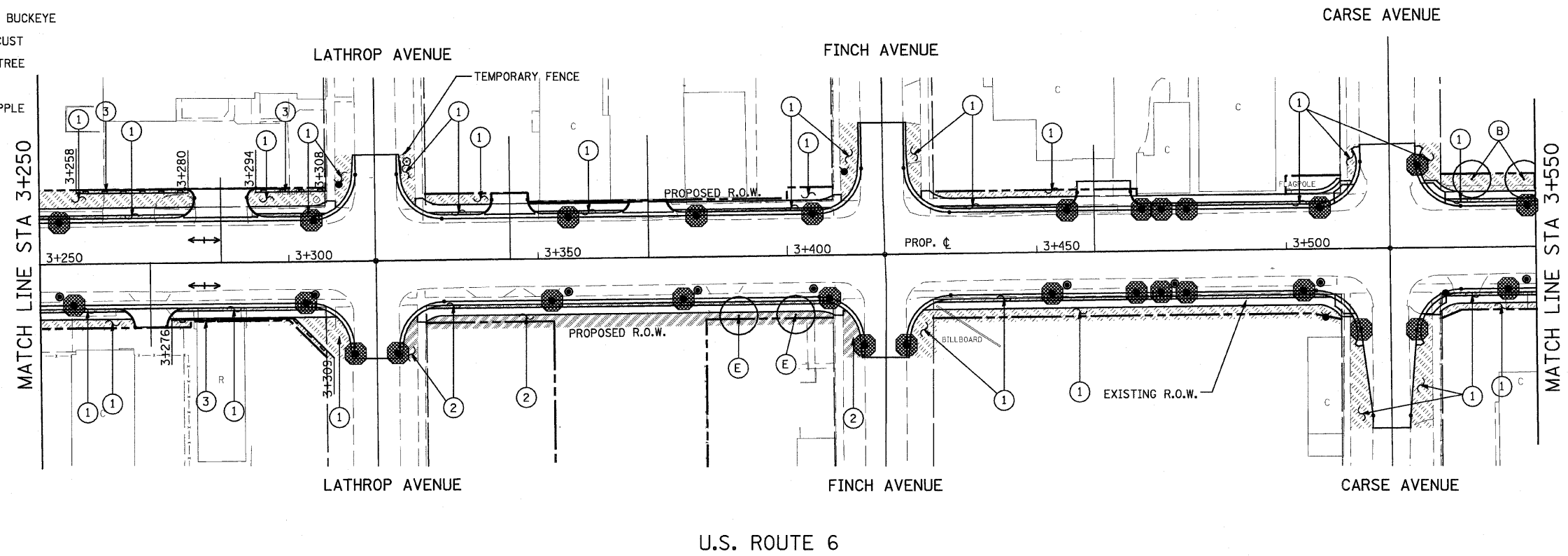

**LEGEND**

- (1) SODDING, SALT TOLERANT
- (2) SEEDING, CLASS 2A
- (3) PERIMETER EROSION BARRIER
- ⊕ INLET & PIPE PROTECTION
- INLET FILTER

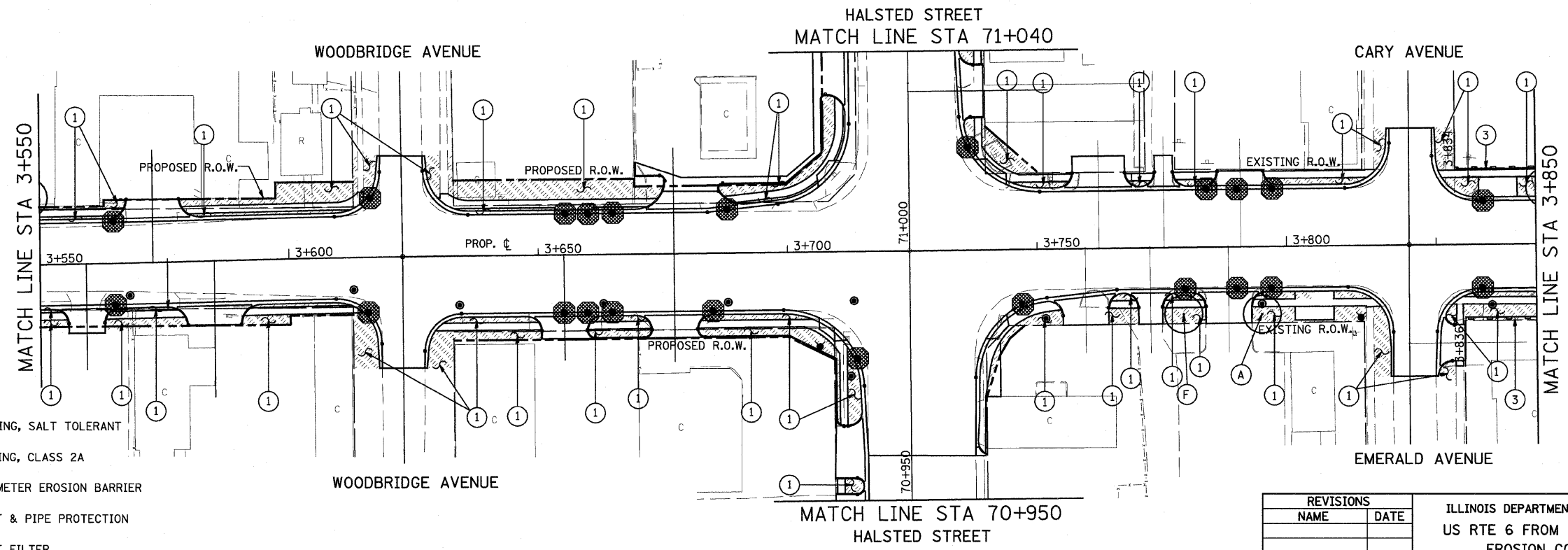

**URS**  
 100 S. WACKER DR., SUITE 500  
 CHICAGO, ILLINOIS 60606  
 TEL. (312) 939-1000  
 FAX (312) 939-4198

U.S. ROUTE 6

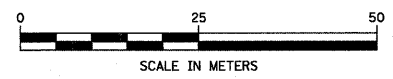

REVISIONS	
NAME	DATE

ILLINOIS DEPARTMENT OF TRANSPORTATION  
 US RTE 6 FROM I-294 TO IL RTE 1  
 EROSION CONTROL AND  
 LANDSCAPING PLAN  
 STA. 3+250 TO STA. 3+850  
 EC-06  
 DATE 01/28/09  
 DRAWN BY VAP  
 CHECKED BY NAP