

SCHEDULE OF QUANTITIES

| PAY ITEM | UNIT | QTY. |
|---|-------|------|
| HANDHOLE | EACH | 5 |
| HEAVY-DUTY HANDHOLE | EACH | 4 |
| DOUBLE HANDHOLE | EACH | 1 |
| FULL-ACTUATED CONTROLLER AND TYPE IV CABINET | EACH | 1 |
| TRANSCIEVER-FIBER OPTIC | EACH | 1 |
| TRAFFIC SIGNAL BACKPLATE | EACH | 12 |
| INDUCTIVE LOOP DETECTOR | EACH | 8 |
| *LIGHT DETECTOR | EACH | 2 |
| *LIGHT DETECTOR AMPLIFIER | EACH | 1 |
| PEDESTRIAN PUSH-BUTTON | EACH | 4 |
| TEMPORARY TRAFFIC SIGNAL INSTALLATION | EACH | 1 |
| REMOVE EXISTING TRAFFIC SIGNAL EQUIPMENT | EACH | 1 |
| REMOVE EXISTING HANDHOLE | EACH | 15 |
| REMOVE EXISTING CONCRETE FOUNDATION | EACH | 9 |
| SIGN PANEL - TYPE 1 | SQ M | 1.12 |
| SIGN PANEL - TYPE 2 | SQ M | 2.1 |
| CONDUIT IN TRENCH, 50MM DIA., GALVANIZED STEEL | METER | 169 |
| CONDUIT IN TRENCH, 65MM DIA., GALVANIZED STEEL | METER | 6 |
| CONDUIT IN TRENCH, 100MM DIA., GALVANIZED STEEL | METER | 7 |
| CONDUIT PUSHED, 50MM DIA., GALVANIZED STEEL | METER | 32 |
| CONDUIT PUSHED, 100MM DIA., GALVANIZED STEEL | METER | 113 |
| TRENCH AND BACKFILL FOR ELECTRICAL WORK | METER | 10 |
| ELECTRIC CABLE IN CONDUIT, SIGNAL NO. 14 2C | METER | 192 |
| ELECTRIC CABLE IN CONDUIT, SIGNAL NO. 14 3C | METER | 243 |
| ELECTRIC CABLE IN CONDUIT, SIGNAL NO. 14 5C | METER | 487 |
| ELECTRIC CABLE IN CONDUIT, SIGNAL NO. 14 7C | METER | 442 |
| ELECTRIC CABLE IN CONDUIT, LEAD-IN, NO 4 1 PAIR | METER | 277 |
| ELECTRIC CABLE IN CONDUIT, SERVICE, NO. 6 2C | METER | 55 |
| STEEL COMBINATION MAST ARM ASSEMBLY AND POLE, 11.58 METER | EACH | 4 |
| CONCRETE FOUNDATION, TYPE D | METER | 1.2 |
| CONCRETE FOUNDATION, TYPE E 750 MM DIAMETER | METER | 18.4 |
| PREFORMED DETECTOR LOOP | METER | 421 |
| ELECTRIC CABLE IN CONDUIT, GROUNDING, NO. 6 1C | METER | 162 |
| ELECTRIC CABLE IN CONDUIT, NO. 20 3/C, TWISTED, SHIELDED | METER | 107 |
| SERVICE INSTALLATION, POLE MOUNT | EACH | 1 |
| SIGNAL HEAD, LED, 1-FACE, 3-SECTION, MAST ARM MOUNTED | EACH | 8 |
| SIGNAL HEAD, LED, 1-FACE, 5-SECTION, BRACKET MOUNTED | EACH | 4 |
| SIGNAL HEAD, LED, 1-FACE, 5-SECTION, MAST ARM MOUNTED | EACH | 4 |
| PEDESTRIAN SIGNAL HEAD, LED, 2-FACE, BRACKET MOUNTED WITH COUNTDOWN TIMER | EACH | 4 |
| TEMPORARY TRAFFIC SIGNAL TIMING | EACH | 1 |
| UNINTERRUPTIBLE POWER SUPPLY | EACH | 1 |

* 100% cost to City of Harvey

| I.D.O.T. TRAFFIC SIGNAL INSTALLATION ELECTRICAL SERVICE REQUIREMENTS | | | | | TOTAL WATTAGE |
|--|-----------|-----------------|-------------|-------------|----------------|
| TYPE | NO. LAMPS | WATTAGE INCAND. | WATTAGE LED | % OPERATION | |
| SIGNAL (RED) | 16 | 135 | 17 | 0.50 | 136.0 |
| (YELLOW) | 16 | 135 | 25 | 0.25 | 100.0 |
| (GREEN) | 16 | 135 | 15 | 0.25 | 60.0 |
| ARROW | 16 | 135 | 12 | 0.10 | 19.2 |
| PED. SIGNAL | 8 | 90 | 25 | 1.00 | 200.0 |
| CONTROLLER | 1 | 100 | 100 | 1.00 | 100.0 |
| ILLUM. SIGN | | 84 | | 0.05 | |
| FLASHER | | | | 0.50 | |
| ENERGY COSTS TO: | | | | | TOTAL = 615.20 |

ILLINOIS DEPARTMENT OF TRANSPORTATION
 201 WEST CENTER COURT
 SCHUMBERG, ILLINOIS 60196-1096
 CONTACT: MIKE LYNCH
 PHONE: (847) 816-5331
 COMPANY: COM. EDISON

| FOUNDATION (DEPTH) | FT. (m) | CABLE SLACK | FT. (m) | VERTICAL | FT. (m) |
|--------------------|------------|------------------|-----------|-------------------|------------|
| TYPE A - POST | 4 (1.2) | HANDHOLE | 6.5 (2.0) | ALL FOUNDATIONS | 3.5 (1.0) |
| D - CONTROLLER | 4 (1.2) | DOUBLE HANDHOLE | 13 (4.0) | MAST ARM (L) POLE | 20'+L-2' |
| E - M. ARM POLE | | SIGNAL POST | 2 (1.0) | (6m+L-0.6m)= | |
| 30" (750mm) | 13.5 (4.1) | CONTROLLER CAB. | 1 (0.5) | BRACKET MOUNTED | 13 (4.0) |
| 36" (900mm) | 11 (3.4) | FIBER OPTIC | 13 (4.0) | PED. PUSHBUTTON | 4 (1.2) |
| 36" (900mm) | 13 (4.0) | ELECTRIC SERVICE | 1 (0.5) | ELECTRIC SERVICE | 13.5 (4.1) |
| 36" (900mm) | 15 (4.6) | GROUND CABLE | 1 (0.5) | SERVICE TO GROUND | 13.5 (4.1) |
| | | | | POST MOUNTED | 6 (1.8) |

CABLE PLAN LEGEND

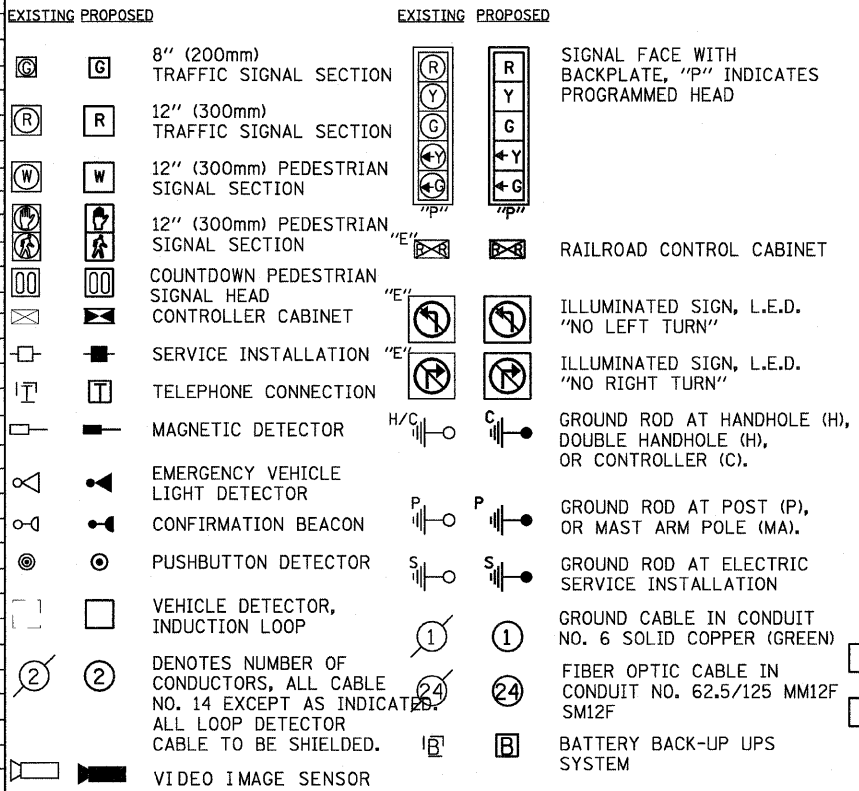

CONTROLLER SEQUENCE

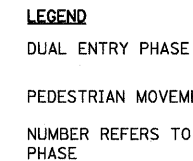
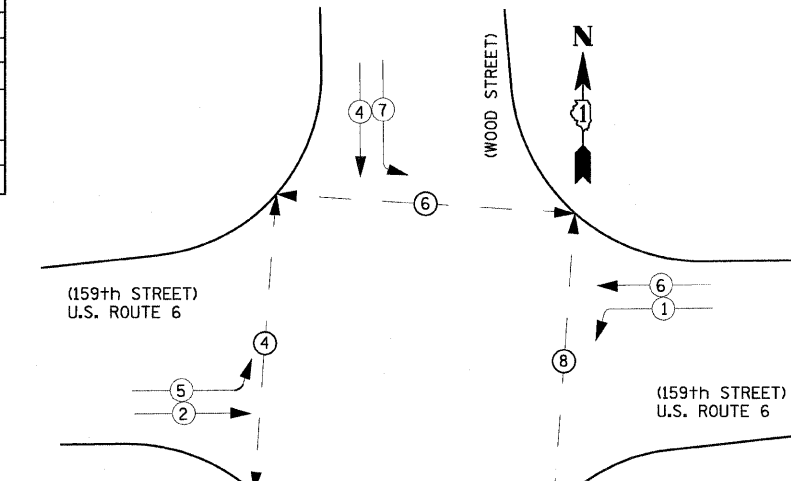

PHASE DESIGNATION DIAGRAM

| PROPOSED EMERGENCY VEHICLE PREEMPTOR | |
|--------------------------------------|---------|
| VEHICLE EMERGENCY PREEMPTOR | 3 4 |
| MOVEMENT | ← → ↑ ↓ |

NOTE:
 PUSHBUTTON "A" SHALL PLACE A CALL IN PHASES 2 AND 4
 PUSHBUTTON "B" SHALL PLACE A CALL IN PHASES 4 AND 6
 PUSHBUTTON "C" SHALL PLACE A CALL IN PHASES 6 AND 8
 PUSHBUTTON "D" SHALL PLACE A CALL IN PHASES 2 AND 8

NOTE:
 THE TRAFFIC SIGNAL CONTROLLER EQUIPMENT FOR THIS PROJECT SHALL BE "EAGLE" TO MATCH THE EXISTING ADJACENT SYSTEM.

| F.A. RTE. | SECTION | COUNTY | TOTAL SHEETS | SHEET NO. |
|--------------|---------|---------------------------|--------------|-----------|
| 351 | 3277R | COOK | 541 | 308 |
| STA. TO STA. | | ILLINOIS FED. AID PROJECT | | |

CONTRACT NO. 60774

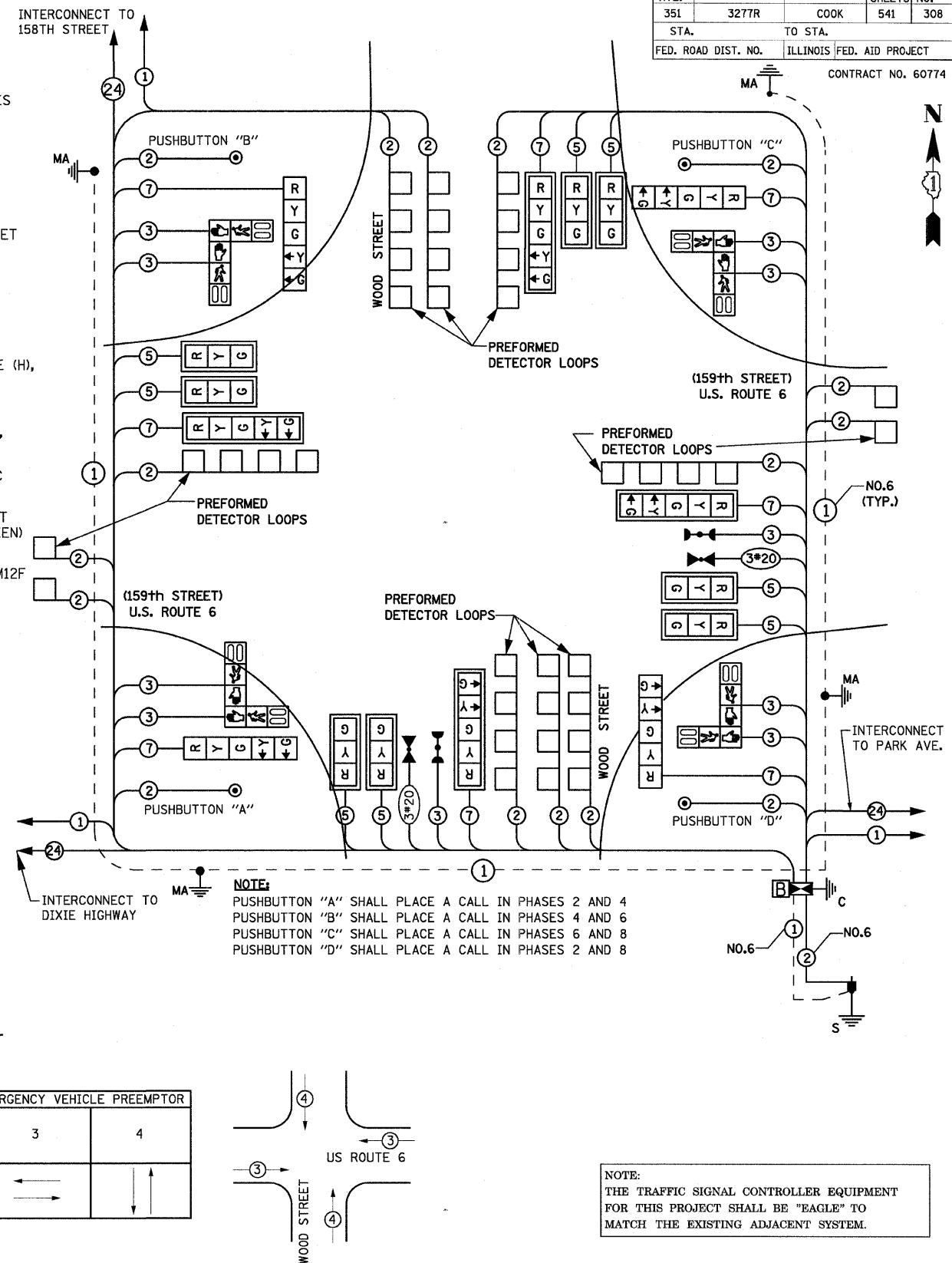

| REVISIONS | |
|-----------|------|
| NAME | DATE |
| | |
| | |
| | |
| | |

ILLINOIS DEPARTMENT OF TRANSPORTATION
 US RTE 6 FROM I-294 TO IL RTE 1
 SCHEDULE OF QUANTITIES AND CABLE PLAN
 US RTE 6 & WOOD STREET
 SCALE: NONE DRAWN BY: DK
 DATE: 01/28/09 CHECKED BY: JA

Delta Engineering, Inc.
 CONSULTING ENGINEERS, CHICAGO, ILLINOIS