

F.A. RTE.	SECTION	COUNTY	TOTAL SHEETS	SHEET NO.
351	3277R	COOK	541	338
STA. 2+150		TO STA. 2+700		
FED. ROAD DIST. NO.		ILLINOIS FED. AID PROJECT		
CONTRACT NO. 60774				

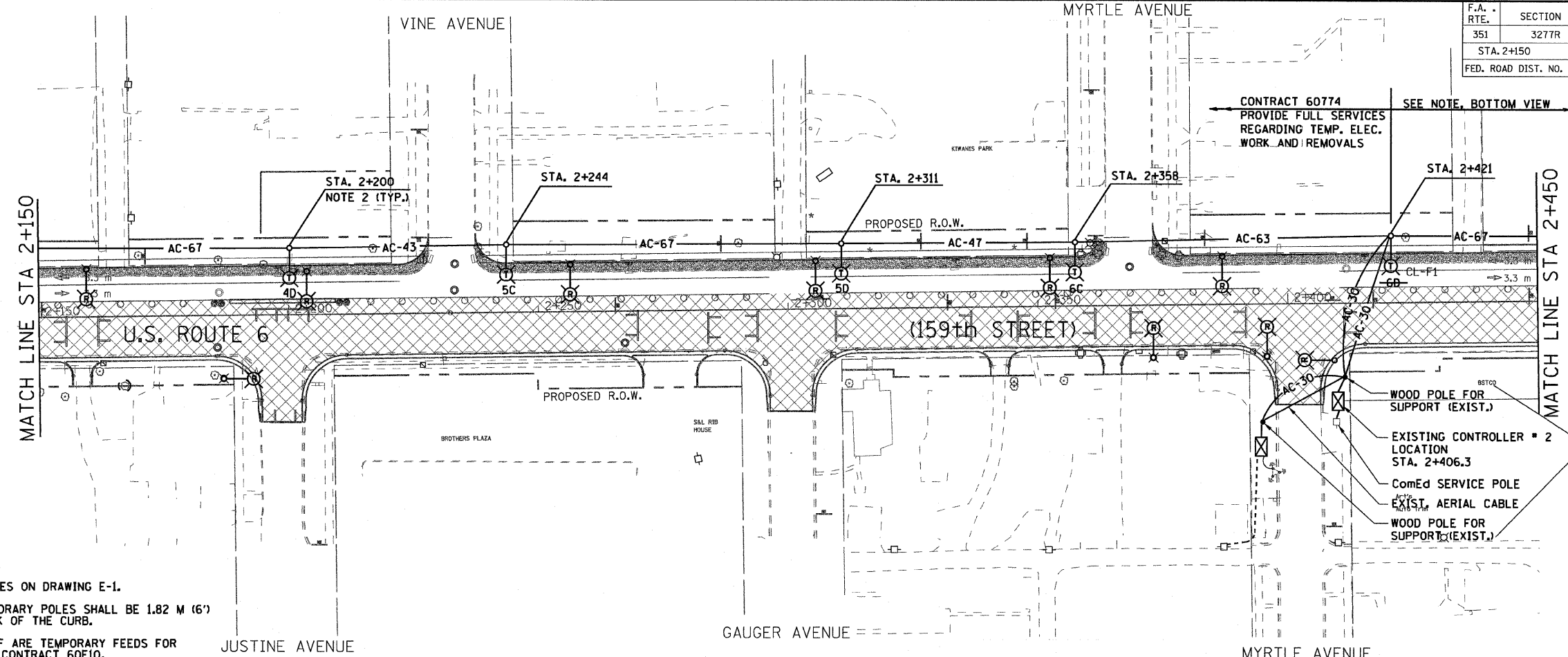

- NOTES:**
- REFER TO LIGHTING NOTES ON DRAWING E-1.
 - SETBACK FOR THE TEMPORARY POLES SHALL BE 1.82 M (6') MINIMUM FROM THE BACK OF THE CURB.
 - CIRCUITS CL-E AND CL-F ARE TEMPORARY FEEDS FOR LIGHTING INSTALLED IN CONTRACT 60E10.

CONTRACT 60774
 PROVIDE FULL SERVICES REGARDING TEMP. ELEC. WORK AND REMOVALS
 SEE NOTE, BOTTOM VIEW

ALL ITEMS ARE TO BE REMOVED IN THIS CONTRACT (UPON COMPLETION OF NEW LIGHTING SYSTEM).

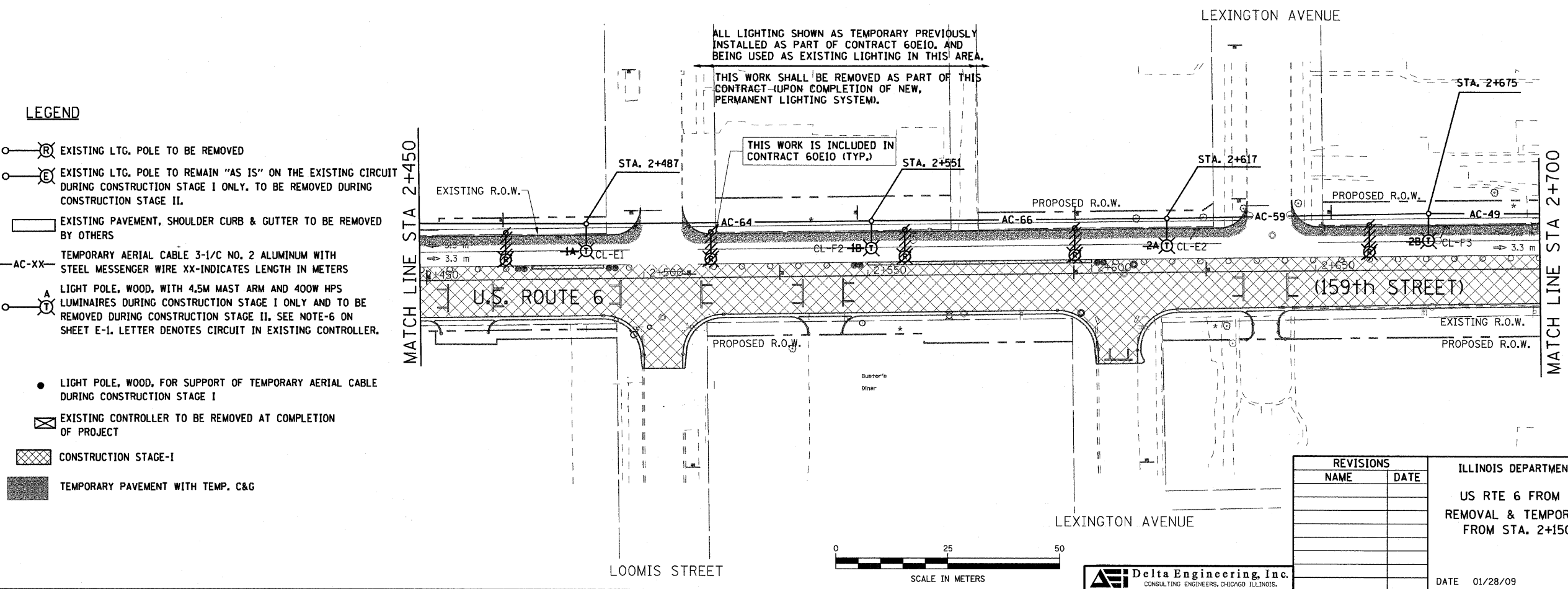

- LEGEND**
- ⊗ EXISTING LTC. POLE TO BE REMOVED
 - ⊕ EXISTING LTC. POLE TO REMAIN "AS IS" ON THE EXISTING CIRCUIT DURING CONSTRUCTION STAGE I ONLY. TO BE REMOVED DURING CONSTRUCTION STAGE II.
 - ▭ EXISTING PAVEMENT, SHOULDER CURB & GUTTER TO BE REMOVED BY OTHERS
 - AC-XX— TEMPORARY AERIAL CABLE 3-1/C NO. 2 ALUMINUM WITH STEEL MESSENGER WIRE XX-INDICATES LENGTH IN METERS
 - ⊙ LIGHT POLE, WOOD, WITH 4.5M MAST ARM AND 400W HPS LUMINAIRES DURING CONSTRUCTION STAGE I ONLY AND TO BE REMOVED DURING CONSTRUCTION STAGE II. SEE NOTE-6 ON SHEET E-1. LETTER DENOTES CIRCUIT IN EXISTING CONTROLLER.
 - LIGHT POLE, WOOD, FOR SUPPORT OF TEMPORARY AERIAL CABLE DURING CONSTRUCTION STAGE I
 - ⊗ EXISTING CONTROLLER TO BE REMOVED AT COMPLETION OF PROJECT
 - ▨ CONSTRUCTION STAGE-I
 - ▩ TEMPORARY PAVEMENT WITH TEMP. C&G

ALL LIGHTING SHOWN AS TEMPORARY PREVIOUSLY INSTALLED AS PART OF CONTRACT 60E10, AND BEING USED AS EXISTING LIGHTING IN THIS AREA.
 THIS WORK SHALL BE REMOVED AS PART OF THIS CONTRACT (UPON COMPLETION OF NEW, PERMANENT LIGHTING SYSTEM).
 THIS WORK IS INCLUDED IN CONTRACT 60E10 (TYP.)

REVISIONS	
NAME	DATE

ILLINOIS DEPARTMENT OF TRANSPORTATION
 US RTE 6 FROM I-294 TO IL RTE 1
 REMOVAL & TEMPORARY LIGHTING PLAN
 FROM STA. 2+150 TO STA. 2+700

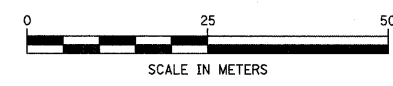

Delta Engineering, Inc.
 CONSULTING ENGINEERS, CHICAGO, ILLINOIS.

DATE 01/28/09
 DRAWN BY S.S./W.S.
 CHECKED BY C.K./H.S.

DRAWING No. E-5