

LEGEND

- T1 XX GALVANIZED STEEL CONDUIT IN TRENCH (T) UNDER DRIVEWAYS/PAVEMENT 65MM, XX DENOTES LENGTH IN METERS.
- CH-AX PROPOSED ALUMINUM LIGHT POLE (14.5 M M.H., 2.5M MAST ARM), FOUNDATION & 310W HPS LUMINAIRE. 'CH' DENOTES CONTROLLER NO. 'A' DENOTES CIRCUIT NUMBER. 'X' DENOTES POLE NO. 'B' DENOTES BREAKAWAY DEVICE AT THE POLE BASE.
- UNDER GROUND SERVICE 50mm GALVANIZED STEEL
- EXISTING CONTROLLER TO BE REMOVED AT COMPLETION OF PROJECT
- PROPOSED CONTROLLER
- GS GALVANIZED STEEL
- TU XX TU DENOTES UNIT DUCT IN TRENCH, SIZES AS NOTED ON PLANS, XX-DENOTES LENGTH IN METERS.
- GROUND ROD, 16MM DIA, X 3.0M LONG
- T XX GALVANIZED STEEL CONDUIT IN TRENCH (T) UNDER DRIVEWAYS/PAVEMENT 50MM, XX DENOTES LENGTH IN METERS.
- GROUND FIELD FOR CONTROLLERS. 2/0 AWG BARE COPPER WIRE
- STEEL COMBINATION MAST ARM ASSEMBLY AND POLE. SEE DWG E-14. (BY TRAFFIC SIGNAL CONTRACTOR)

NOTES:

1. ALL DIMENSIONS ARE IN METERS.
2. REFER TO LIGHTING NOTES ON DRAWING E-1.
3. UNIT DUCT, WITH 3-1/2 NO. 6 AND 1-1/2 NO. 6 GROUND, 600V (EPR-TYPE RHW), 25MM DIA., POLYETHYLENE UNLESS OTHERWISE NOTED.
4. UNIT DUCT, WITH 3-1/2 NO. 2 AND 1-1/2 NO. 4 GROUND, 600V (EPR-TYPE RHW), 40MM DIA., POLYETHYLENE UNLESS OTHERWISE NOTED. (CKT CM-A/B & CM-C/D)
5. LUMINAIRES ON THE COMBINATION MAST ARM ASSEMBLY SHALL BE FURNISHED, INSTALLED AND WIRED BY THE LIGHTING CONTRACTOR.
6. POLES SETBACK ARE MEASURED FROM BACK OF THE CURB.
7. 65MM GALVANIZED STEEL CONDUIT USED IN CIRCUITS "A", "B", "C" AND "D", 50MM GALVANIZED STEEL CONDUIT USED IN CIRCUITS "E", "F", "G" AND "H".

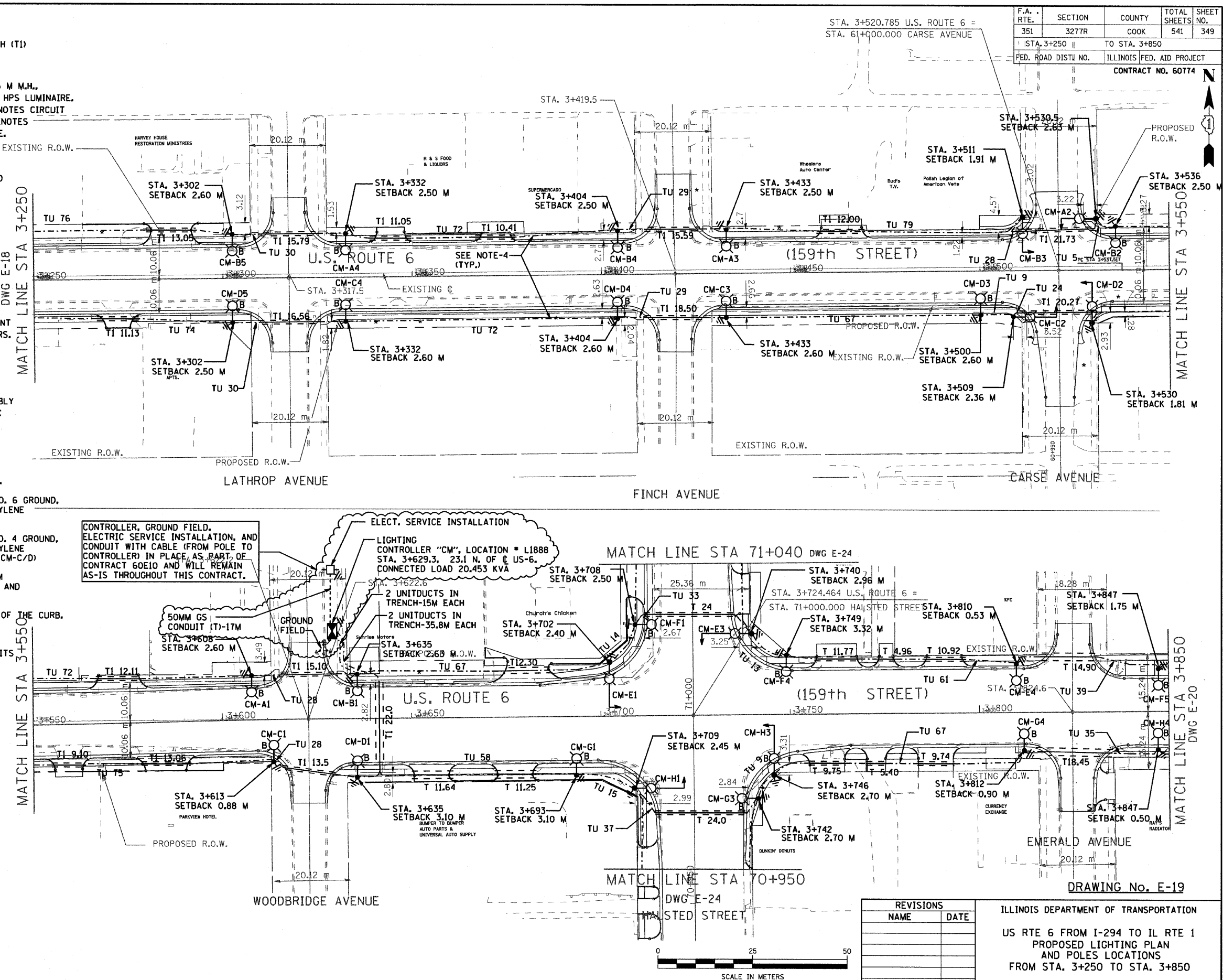

CONTROLLER, GROUND FIELD, ELECTRIC SERVICE INSTALLATION, LIGHTING CONTROLLER "CM", LOCATION = L1888 STA. 3+629.3, 23.1 N. OF US-6. CONNECTED LOAD 20.453 KVA

2 UNITDUCTS IN TRENCH-15M EACH
2 UNITDUCTS IN TRENCH-35.8M EACH

50MM GS CONDUIT (T)-17M
GROUND FIELD

REVISIONS	
NAME	DATE

ILLINOIS DEPARTMENT OF TRANSPORTATION
 US RTE 6 FROM I-294 TO IL RTE 1
 PROPOSED LIGHTING PLAN
 AND POLES LOCATIONS
 FROM STA. 3+250 TO STA. 3+850

SCALE AS NOTED
 DATE 01/28/09

DRAWN BY S.S./W.S.
 CHECKED BY C.K./H.S.

F.A. RTE.	SECTION	COUNTY	TOTAL SHEETS	SHEET NO.
351	3277R	COOK	541	349
STA. 3+250		TO STA. 3+850		
FED. ROAD DIST. NO.		ILLINOIS FED. AID PROJECT		
CONTRACT NO. 60774				

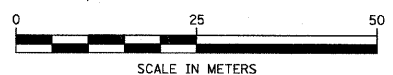

DRAWING No. E-19