

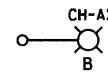
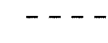

F.A. RTE.	SECTION	COUNTY	TOTAL SHEETS	SHEET NO.
351	3277R	COOK	541	350
STA. 3+850		TO STA. 3+973		
FED. ROAD DIST. NO.		ILLINOIS FED. AID PROJECT		
CONTRACT NO. 60774				

LEGEND

-  PROPOSED ALUMINUM LIGHT POLE (14.5 M M.H., 2.5M MAST ARM), FOUNDATION & 310W HPS LUMINAIRE. 'CH' DENOTES CONTROLLER NO. 'A' DENOTES CIRCUIT NUMBER. 'X' DENOTES POLE NO. 'B' DENOTES BREAKAWAY DEVICE AT THE POLE BASE.
-  UNDER GROUND SERVICE 50mm GALVANIZED STEEL
-  EXISTING CONTROLLER TO BE REMOVED AT COMPLETION OF PROJECT
-  PROPOSED CONTROLLER
- GS GALVANIZED STEEL
-  TU XX TU DENOTES UNIT DUCT IN TRENCH, SIZES AS NOTED ON PLANS, XX-DENOTES LENGTH IN METERS.
-  GROUND ROD, 16MM DIA, X 3.0M LONG
-  T XX GALVANIZED STEEL CONDUIT IN TRENCH (T) UNDER DRIVEWAYS/PAVEMENT 50MM, XX DENOTES LENGTH IN METERS.
-  GROUND FIELD FOR CONTROLLERS. 2/0 AWG BARE COPPER WIRE

NOTES:

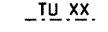
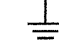
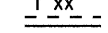
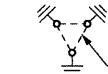
1. ALL DIMENSIONS ARE IN METERS.
2. REFER TO LIGHTING NOTES ON DRAWING ON E-1.
3. UNIT DUCT, WITH 3-1/C NO. 6 AND 1-1/C NO. 6 GROUND, 600V (EPR-TYPE RHW), 25MM DIA., POLYETHYLENE UNLESS OTHERWISE NOTED.
4. POLES SETBACK ARE MEASURED FROM BACK OF THE CURB.

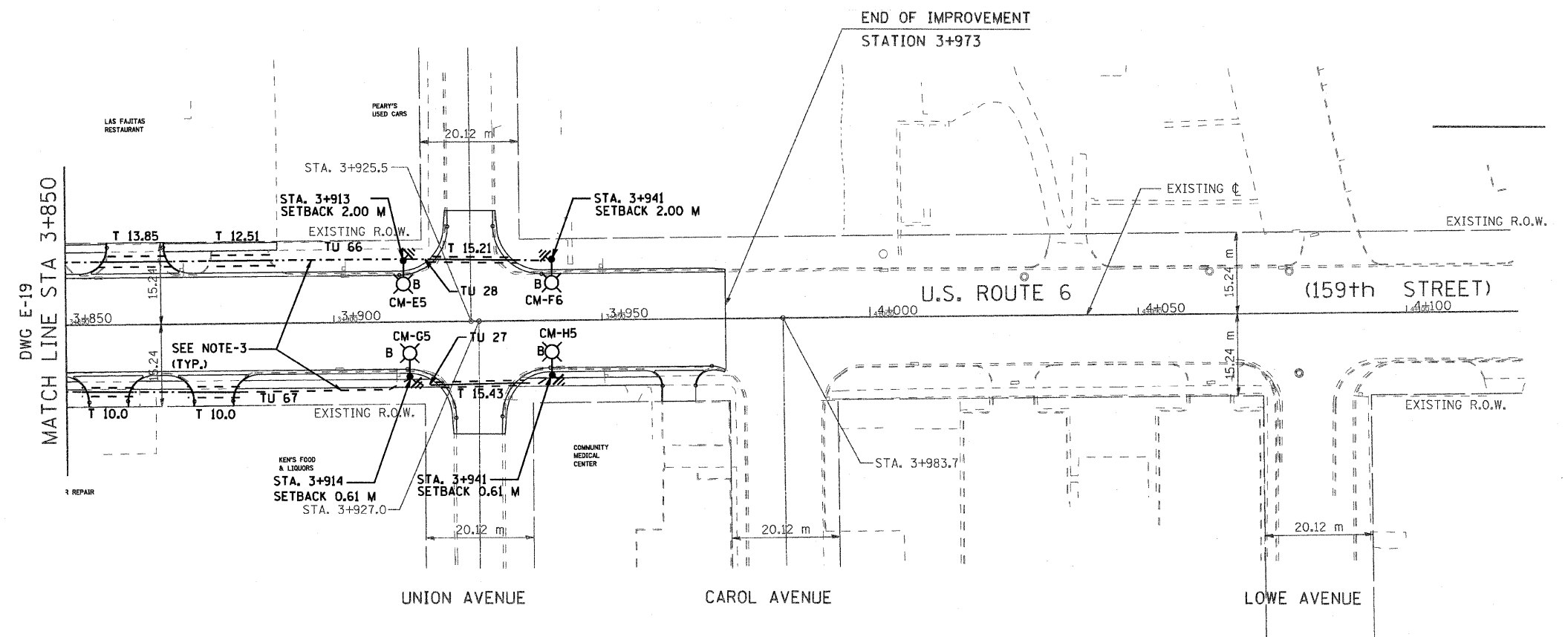

DRAWING No. E-20

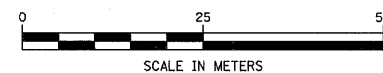

Delta Engineering, Inc.
CONSULTING ENGINEERS, CHICAGO, ILLINOIS.

REVISIONS	
NAME	DATE

ILLINOIS DEPARTMENT OF TRANSPORTATION
US RTE 6 FROM I-294 TO IL RTE 1
PROPOSED LIGHTING PLAN
AND POLES LOCATIONS
FROM STA. 3+850 TO STA. 3+973

SCALE AS NOTED DRAWN BY S.S./W.S.
DATE 01/28/09 CHECKED BY C.K./H.S.