

F.A.P. RTE.	SECTION	COUNTY	TOTAL SHEETS	SHEET NO.
351	3277R	COOK	541	479
STA.		TO STA.		
FED. ROAD DIST. NO.		ILLINOIS FED. AID PROJECT		
CONTRACT NO. 60774				

REVISED SURVEY	DATE
BY	
REVISIONS	
NO.	

ORIGINAL SURVEY	DATE
BY	
REVISIONS	
NO.	

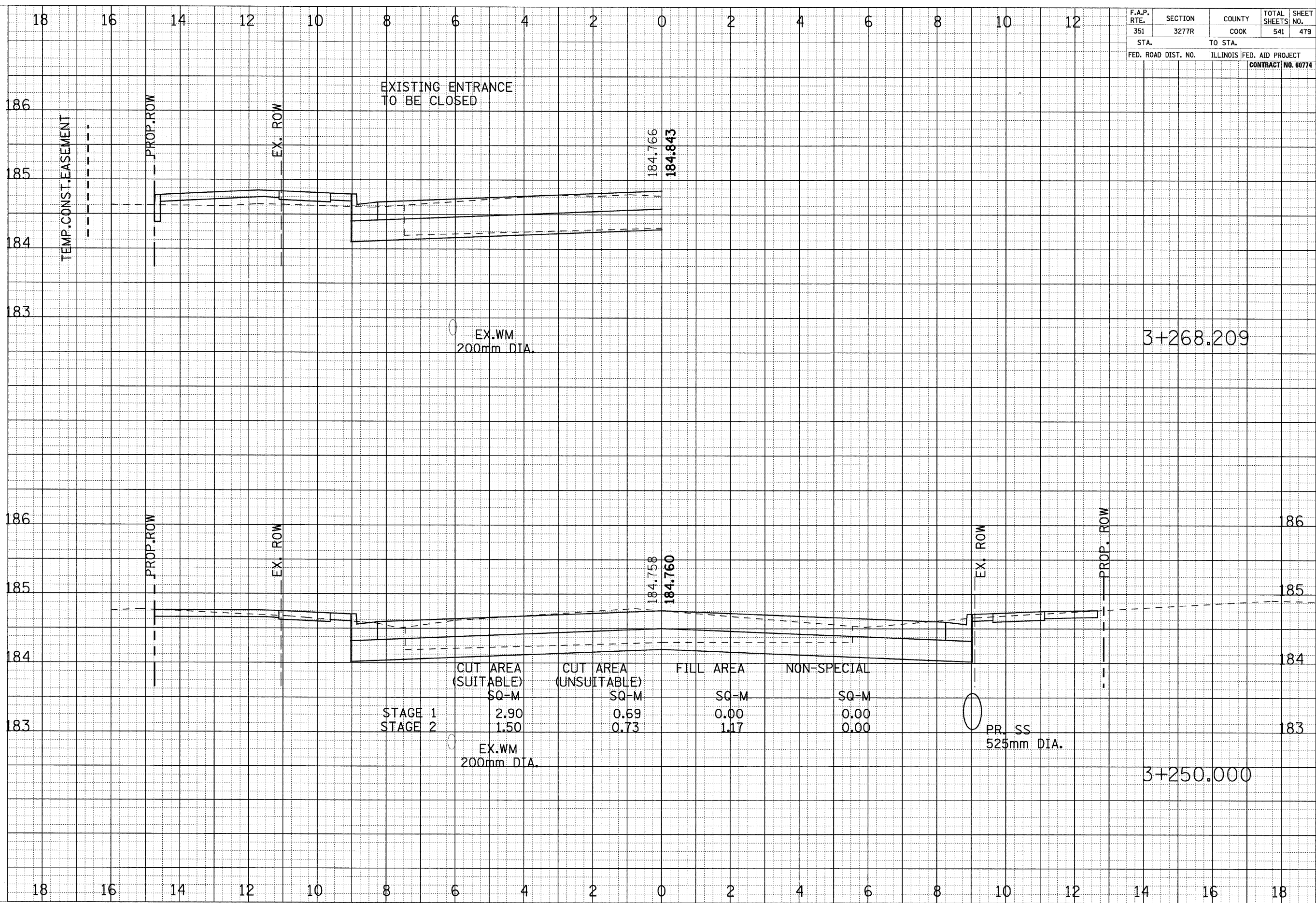

EXISTING ENTRANCE
TO BE CLOSED

EX.WM
200mm DIA.

3+268.209

	CUT AREA (SUITABLE) SQ-M	CUT AREA (UNSUITABLE) SQ-M	FILL AREA SQ-M	NON-SPECIAL SQ-M
STAGE 1	2.90	0.69	0.00	0.00
STAGE 2	1.50	0.73	1.17	0.00

EX.WM
200mm DIA.

PR. SS
525mm DIA.

3+250.000