

QUANTITY
 4 (100) LINE = 64.1 ft. (19.7 m)
 21.1 sq. ft. (1.97 sq. m)

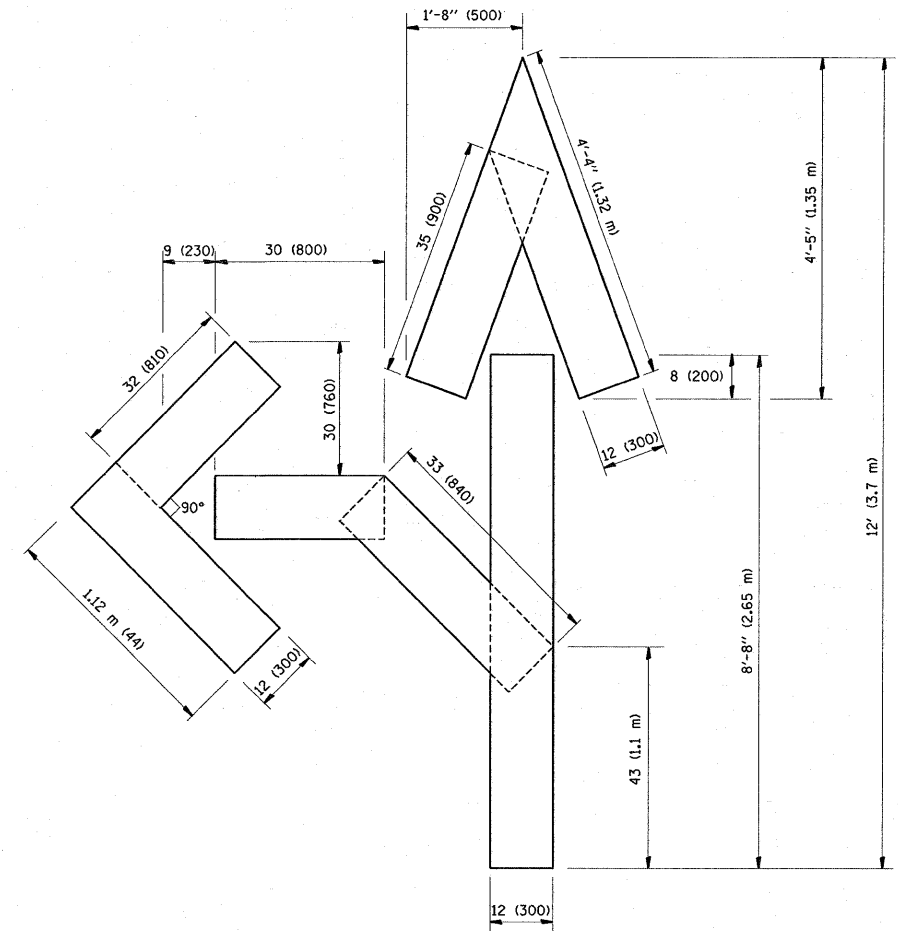

QUANTITY
 4 (100) LINE = 82.5 ft. (25.3 m)
 27.5 sq. ft. (2.53 sq. m)

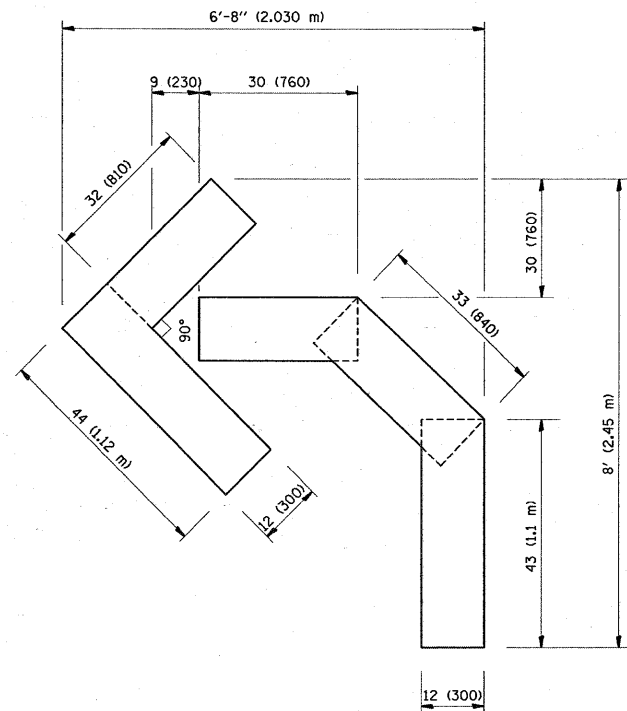

QUANTITY
 4 (100) LINE = 45.5 ft. (13.9 m)
 15.2 sq. ft. (1.39 sq. m)

All dimensions are in inches (millimeters) unless otherwise shown.

| | | | |
|--|--------------------|---------------------------------|---------------------------------|
| FILE NAME = | USER NAME = midjja | DESIGNED - | REVISED - T. RAMMACHER 06-05-96 |
| c:\pw_work\p\1001\MIDYJA\dms92647\Dist | sd.dgn | DRAWN - | REVISED - T. RAMMACHER 11-04-97 |
| PLOT SCALE = 50.0000' / IN. | CHECKED - | REVISED - T. RAMMACHER 03-02-98 | |
| PLOT DATE = 2/2/2009 | DATE = 09-18-94 | REVISED - E. GOMEZ 08-28-00 | |

STATE OF ILLINOIS
 DEPARTMENT OF TRANSPORTATION

PAVEMENT MARKING LETTERS AND SYMBOLS
 FOR TRAFFIC STAGING

SCALE: NONE SHEET NO. 1 OF 1 SHEETS STA. TO STA.

| | | | | |
|---|-------------|--------|--------------------|-----------|
| F.A.U. RTE. | SECTION | COUNTY | TOTAL SHEETS | SHEET NO. |
| 2843 | 2006-022 RS | COOK | 22 | 21 |
| TC-16 | | | CONTRACT NO. 60857 | |
| FED. ROAD DIST. NO. 1 ILLINOIS FED. AID PROJECT | | | | |