 HOT-MIX ASPHALT SURFACE REMOVAL, 1 1/2" AND REPLACED WITH HOT-MIX ASPHALT SURFACE COURSE, MIX D, N50, 1 1/2" (NOTE: THIS WORK SHALL BE DONE DURING PRE-STAGE)

TEMPORARY CONTROL POINTS (PK NAIL)

| POINT | NORTH | EAST | STATION | OFFSET |
|-------|--------------------------------|---------------|----------|---------|
| CP#1 | 1,793,189.377 FEATURE : 103 | 1,149,232.886 | 20+77.35 | 35.228 |
| CP#2 | 1,793,020.724 FEATURE : 103 | 1,149,615.032 | 25+05.62 | 43.098 |
| CP#3 | 1,792,720.807 FEATURE : 103 | 1,150,221.573 | 31+80.70 | -42.838 |
| CP#4 | 1,792,543.647 FEATURE : 103 | 1,150,543.745 | 35+55.83 | -29.873 |

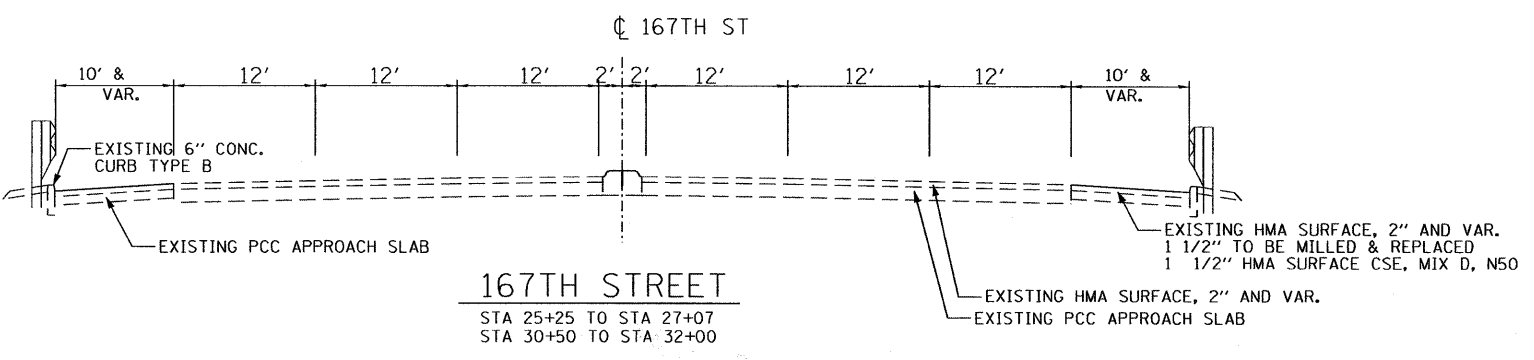

1/28/2008 10:27:00 AM Ver-Plan-Philly-Cadd\MOI\Bases\SH1_167\PEX01167.dwg
 PLOT DATE: 1/28/2008 10:27:00 AM
 PLOT SCALE: 1/4" = 1'-0"
 USER NAME: Millennium Engineering
 MODEL:

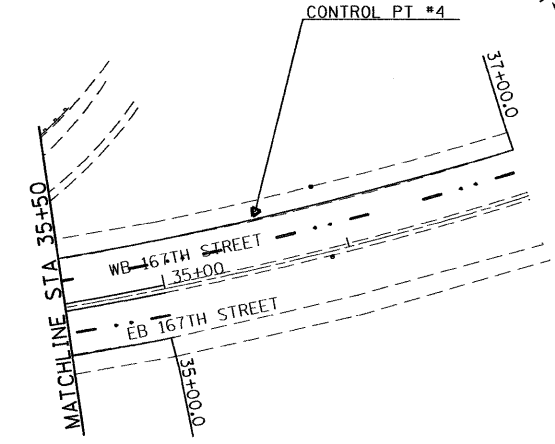

200 22ND Street, Suite 216, Lombard, IL 60148
 630.795.0110 voice, 630.839.2566 fax
 www.millenniaeng.com
MILLENNIA ENGINEERING

| | |
|-----------------|-----------|
| DESIGNED - TVN | REVISED - |
| DRAWN - TVN | REVISED - |
| CHECKED - RPD | REVISED - |
| DATE - 01/28/08 | REVISED - |

**STATE OF ILLINOIS
DEPARTMENT OF TRANSPORTATION**

**FAI 57/I-57
AT 167TH STREET**

SCALE: 1"=50' SHEET NO. 4 OF 20 SHEETS STA. 20+00 TO STA. 37+00

EXISTING CONDITION PLAN

| | | | | |
|--|-----------------|-------------|-----------------|-------------|
| F.A.I. RTE. 57 | SECTION 1011.3I | COUNTY COOK | TOTAL SHEETS 20 | SHEET NO. 4 |
| CONTRACT NO. 60D63 | | | | |
| FED. ROAD DIST. NO. 1 ILLINOIS FED. AID PROJECT PA\2007\ME07888_Ver-Plan-Philly-Cadd\MOI\Bases\SH1_167\PEX01167.dwg | | | | |