

EXIST. CURVE R1
 PI STA. = 11+23.51
 $\Delta = 2^\circ 07' 04''$ (LT)
 D = 1° 26' 09"
 R = 3,990.65'
 T = 73.76'
 L = 147.50'
 E = 0.68'
 e = -----
 T.R. = -----
 S.E. RUN = -----
 P.C. STA. = 10+49.75
 P.T. STA. = 11+97.25

EXIST. CURVE R2
 PI STA. = 16+68.76
 $\Delta = 5^\circ 31' 05''$ (RT)
 D = 3° 39' 51"
 R = 1,563.72'
 T = 75.36'
 L = 150.60'
 E = 1.81'
 e = -----
 T.R. = -----
 S.E. RUN = -----
 P.C. STA. = 15+93.40
 P.T. STA. = 17+44.00



BENCHMARK:

BM #1 CHICAGO CITY STANDARD BM 57.5' SOUTH OF NORTH LINE OF LEXINGTON & 30' EAST OF WEST LINE OF LYTLE
 ELEV 593.41

BM #2 CHICAGO CITY STANDARD BM 5' NORTH OF NORTH LINE OF WASHINGTON & 50' EAST OF EAST LINE OF ASHLAND
 ELEV 595.34

GPS MON GPS MONUMENT ON SOUTH SIDE OF WASHINGTON BETWEEN OGDEN & ASHLAND
 ELEV 595.47

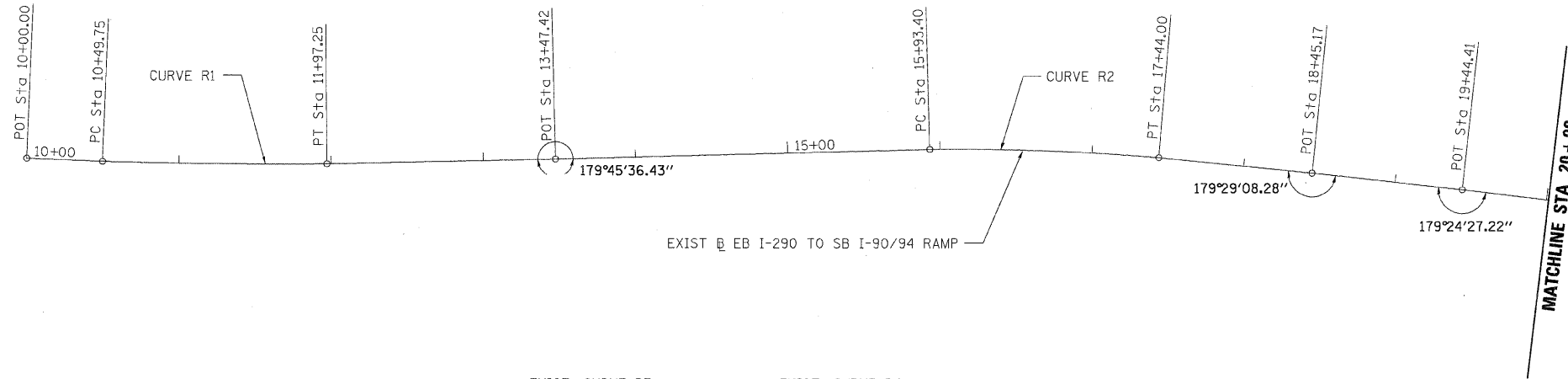

EXIST. CURVE R3
 PI STA. = 22+16.86
 $\Delta = 14^\circ 21' 36''$ (RT)
 D = 9° 30' 21"
 R = 602.74'
 T = 75.93'
 L = 151.06'
 E = 4.76'
 e = -----
 T.R. = -----
 S.E. RUN = -----
 P.C. STA. = 21+40.93
 P.T. STA. = 22+92.00

EXIST. CURVE R4
 PI STA. = 24+78.16
 $\Delta = 37^\circ 03' 18''$ (RT)
 D = 10° 18' 52"
 R = 555.50'
 T = 186.16'
 L = 359.26'
 E = 30.36'
 e = -----
 T.R. = -----
 S.E. RUN = -----
 P.C. STA. = 22+92.00
 P.T. STA. = 26+51.25

EXIST. CURVE RAMPB.BL-2
 PI STA. = 51+56.72
 $\Delta = 19^\circ 06' 22''$ (LT)
 D = 18° 45' 15"
 R = 305.51'
 T = 51.42'
 L = 101.88'
 E = 4.30'
 e = -----
 T.R. = -----
 S.E. RUN = -----
 P.C. STA. = 51+05.31
 P.T. STA. = 52+07.18

EXIST. CURVE RAMPB.BL-1
 PI STA. = 50+53.05
 $\Delta = 17^\circ 07' 32''$ (LT)
 D = 16° 15' 46"
 R = 352.31'
 T = 53.05'
 L = 105.31'
 E = 3.97'
 e = -----
 T.R. = -----
 S.E. RUN = -----
 P.C. STA. = 50+00.00
 P.T. STA. = 51+05.31

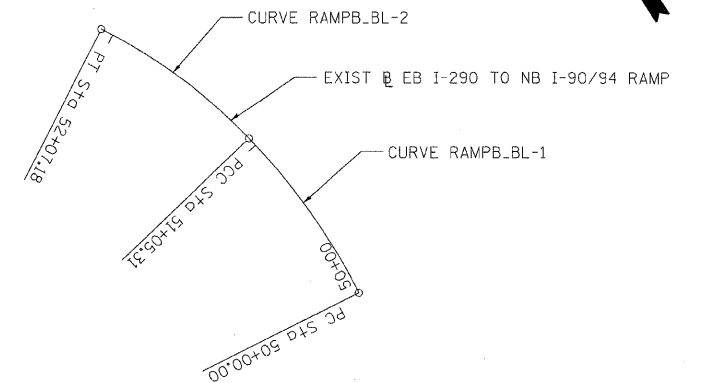
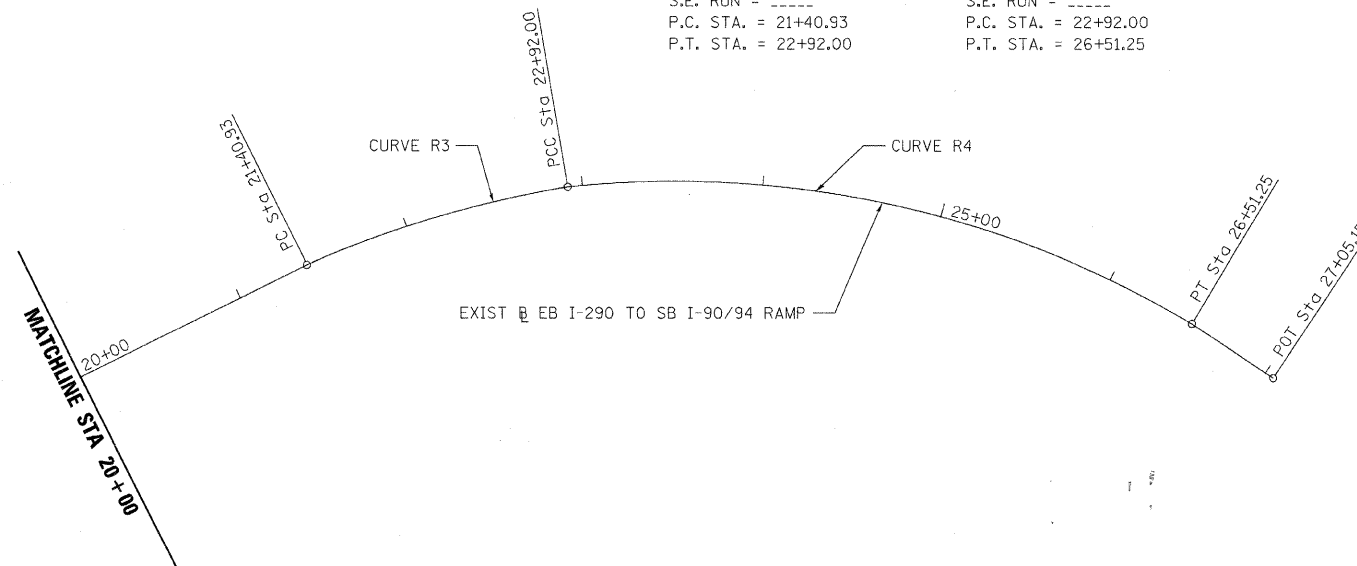

FILE NAME = S:\11-CADD\01-sh\11.D160D93-SHT-ATB.dgn	USER NAME = 3692	DESIGNED - AAC	REVISED -
	PLOT SCALE = 50:1	DRAWN - ED	REVISED -
	PLOT DATE = Friday, December 12, 2008	CHECKED - AAC	REVISED -
		DATE - 12/12/2008	REVISED -

**STATE OF ILLINOIS
 DEPARTMENT OF TRANSPORTATION**

ALIGNMENT, TIES & BENCHMARK

SCALE: 1"=50' SHEET NO. 1 OF 1 SHEETS STA. 10+00.00 TO STA. 25+67.92

F.A. RTE.	SECTION	COUNTY	TOTAL SHEETS	SHEET NO.
290	2007-057 T	COOK	60	11
CONTRACT NO. 60D93				
FED. ROAD DIST. NO. ILLINOIS FED. AID PROJECT				