

TYPICAL ENTRANCE/EXIT RAMP COMBINATION PAVEMENT MARKINGS

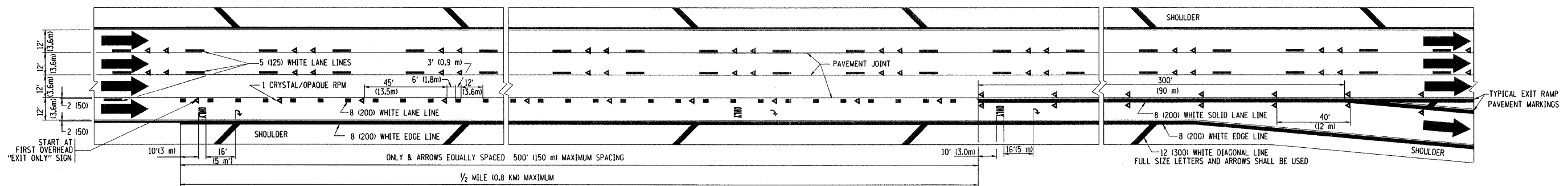

TYPICAL EXIT ONLY LANE PAVEMENT MARKINGS

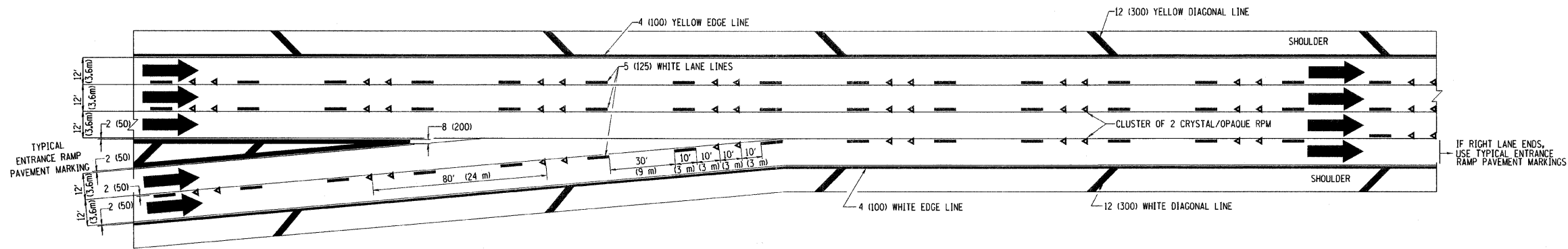

TYPICAL TWO LANE ENTRANCE RAMP PAVEMENT MARKINGS

FILE NAME = W:\distatd\22x34\1\1012.dgn	USER NAME = geglrenobt	DESIGNED - D.W.S.	REVISED - A.H. 03-96	STATE OF ILLINOIS DEPARTMENT OF TRANSPORTATION	MULTI-LANE FREEWAY PAVEMENT MARKING DETAILS			F A P RTE.	SECTION	COUNTY	TOTAL SHEETS	SHEET NO.		
	PLOT SCALE = 50.000' / IN.	DRAWN -	REVISED - D.W.S. 07-96		SCALE: NONE	SHEET NO. 1	OF 2 SHEETS	STA.	TO STA.	352	56 RS-8	LAKE	39	31
	PLOT DATE = 1/4/2008	CHECKED -	REVISED - J.A.F. 02-06								TC-12			CONTRACT NO. 60E23
		DATE - 01-90	REVISED - S.P.B. 01-07							FED. ROAD DIST. NO. 1 ILLINOIS FED. AID PROJECT				