

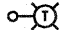









LEGEND

-  TEMPORARY LIGHTING UNIT
50' MOUNTING HEIGHT ON 60' CLASS 4 WOOD POLE
15' MAST ARM, 400 WATT, 120 VOLT LUMINAIRE
WITH PHOTOCELL ON EACH LUMINAIRE
-  AC AERIAL CABLE, 3-1/C NO. 4, ALUMINUM, WITH MESSENGER WIRE
-  UNIT DUCT IN TRENCH, 600V, 3-1/C NO. 4, 1/C NO. 6 GROUND
1 1/4" DIA. POLYETHYLENE
-  3" RIGID GALVANIZED STEEL CONDUIT, PUSHED
CONTAINING PULLED-IN UNIT DUCT
-  A A EXISTING AERIAL UTILITY LINES
-  GROUND ROD, 5/8" DIAMETER x 10'
-  ELECTRIC SERVICE DISCONNECT, LIGHTING AND TRAFFIC SIGNAL
-  45' FOOT CLASS 4 TEMPORARY WOOD POLE
-  EXISTING UTILITY POLE
-  A1 INDICATES CIRCUIT AND POLE NUMBER

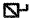

Robert A. Swanson
1-29-2009
EXPIRES 11-30-2009
SHEETS 14-17

BILL OF MATERIALS

ITEM	UNIT	QUANTITY
ELECTRIC SERVICE INSTALLATION	EACH	1
ELECTRIC UTILITY SERVICE CONNECTION	L SUM	1
CONDUIT PUSHED, 3" DIA., GALVANIZED STEEL	FOOT	40
UNIT DUCT, 600V, 3-1/C NO. 4, 1/C NO. 6 GROUND (EPR-TYPE RHW), 1 1/4" DIA. POLYETHYLENE	FOOT	275
AERIAL CABLE, 3-1/C NO. 4 WITH MESSENGER WIRE	FOOT	905
TRENCH AND BACKFILL FOR ELECTRICAL WORK	FOOT	195
LUMINAIRE, SODIUM VAPOR, HORIZONTAL MOUNT, PHOTO-CELL CONTROL, 400 WATT	EACH	5
LIGHT POLE, WOOD, 45 FOOT, CLASS 4	EACH	1
LIGHT POLE, WOOD, 60 FOOT, CLASS 4, WITH 15 FT. MAST ARM	EACH	5
REMOVAL OF TEMPORARY LIGHTING UNITS	EACH	5
MAINTENANCE OF LIGHTING SYSTEM	CAL MO	4
GROUND ROD, 5/8" DIA. X 10 FT.	EACH	2
ELECTRIC SERVICE DISCONNECT, LIGHTING AND TRAFFIC SIGNAL	EACH	1

•: THIS ITEM INCLUDES ELECTRIC UTILITY SERVICE COSTS FOR BOTH TEMPORARY LIGHTING SYSTEMS ASSOCIATED WITH THIS PROJECT.
 ••: THIS ITEM INCLUDES MAINTENANCE OF BOTH TEMPORARY LIGHTING SYSTEMS ASSOCIATED WITH THIS PROJECT.

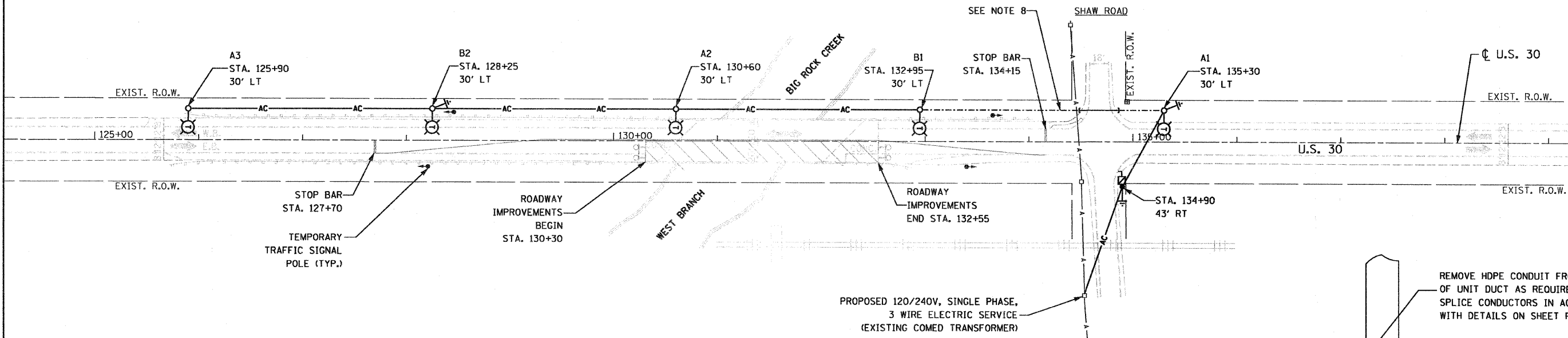

TEMPORARY ROADWAY LIGHTING PLAN
(STAGE I TRAFFIC CONTROL SHOWN)

GENERAL NOTES:

- THE MATERIALS AND INSTALLATION METHODS SHALL COMPLY WITH THE LATEST CODES, STANDARDS, AND ORDINANCES OF FEDERAL, STATE, AND LOCAL GOVERNING BODIES HAVING JURISDICTION. ALL WORK SHOWN ON THE PLANS AND DESCRIBED ELSEWHERE SHALL CONFORM TO THE LATEST NATIONAL ELECTRICAL CODE.
- THE CONTRACTOR SHALL CONTACT COMED AS SOON AS POSSIBLE CONCERNING PENDING ELECTRICAL SERVICE INSTALLATION AND CONNECTION TO ENSURE AVAILABILITY OF ELECTRICAL POWER SUPPLY IN A TIMELY MANNER.
- TEMPORARY LIGHTING SHALL BE INSTALLED AND OPERATIONAL BEFORE THE START OF ROADWAY CONSTRUCTION. TEMPORARY LIGHTING SHALL REMAIN IN OPERATION FOR BOTH STAGE I AND STAGE II.
- OVERHEAD CABLES SHALL MAINTAIN CLEARANCE FROM GROUND IN ACCORDANCE WITH NATIONAL ELECTRICAL CODE SECTION 225.18 AND FROM EXISTING OVERHEAD UTILITY ELECTRICAL LINES IN ACCORDANCE WITH COMED REQUIREMENTS.

- GROUND RODS SHALL BE INSTALLED AT EVERY THIRD TEMPORARY LIGHT POLE, AND SHALL BE PAID FOR AS "GROUND ROD, 5/8" DIA. X 10 FT." GROUND WIRES AND CONNECTION OF GROUND RODS AT TEMPORARY LIGHT POLES ARE INCLUDED IN THE COST OF THE GROUND RODS. THE GROUND ROD AT THE SERVICE DISCONNECT BOX IS INCLUDED IN THE COST OF THE ITEM "ELECTRIC SERVICE DISCONNECT, LIGHTING AND TRAFFIC SIGNAL."
- ALL AREAS DISTURBED UNDER THIS CONTRACT SHALL BE RESTORED TO THEIR ORIGINAL CONDITION OR BETTER TO THE SATISFACTION OF THE ENGINEER.
- THE REMOVAL OF TEMPORARY LIGHTING UNITS SHALL INCLUDE ALL POLES, LUMINAIRES, MAST ARMS, MESSENGER WIRES, CABLES (INCLUDING UNDERGROUND CONDUCTORS IN UNIT DUCT), GROUND RODS, AND SERVICE DISCONNECT EQUIPMENT. ALL EQUIPMENT SHALL BECOME PROPERTY OF THE CONTRACTOR AND SHALL BE REMOVED FROM THE SITE. THE UNDERGROUND HDPE AND RIGID GALVANIZED STEEL CONDUIT ASSOCIATED WITH THE TEMPORARY ROADWAY LIGHTING SHALL BE ABANDONED IN PLACE.
- THE TEMPORARY WIRING BETWEEN THE POLES FOR TEMPORARY LIGHT UNITS A1 AND B1 IS TO BE INSTALLED UNDERGROUND TO AVOID CONFLICTS WITH EXISTING COMED OVERHEAD LINES.

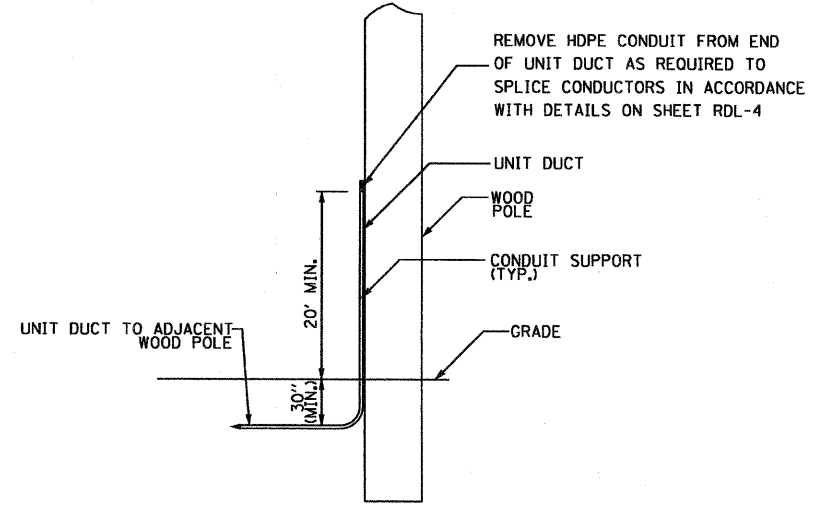

UNIT DUCT INSTALLATION AT WOOD POLE
NO SCALE

NOTE:
PROVIDE PLASTIC CABLE GUARD FOR UNIT DUCT ON POLE.
THE CABLE GUARD AND CONDUIT SUPPORTS ARE INCLUDED IN THE COST OF THE WOOD POLE.

FILE NAME = 0160663-RDL-1.dgn
PLOT DATE = 1/26/2009

SPAAN Tech, Inc.
311 South Wacker Drive, Suite 2400
Chicago, IL 60606
phone: 312.277.8800
fax: 312.277.8808
web: www.SpaanTech.com

DESIGNED - R.A.S.	REVISED -
DRAWN - R.P.J.	REVISED -
CHECKED - I.A.B.	REVISED -
DATE - JANUARY 26, 2009	REVISED -

STATE OF ILLINOIS
DEPARTMENT OF TRANSPORTATION

TEMPORARY ROADWAY LIGHTING PLAN
U.S. 30 OVER WEST BRANCH BIG ROCK CREEK

SCALE: 1" = 50'
SHEET NO. OF SHEETS STA. 130+30 TO STA. 132+55

F.A.P. RTE.	SECTION	COUNTY	TOTAL SHEETS	SHEET NO.
573	117 R-2B-R	KANE	40	14

CONTRACT NO. 60E63
FED. ROAD DIST. NO. 1 [ILLINOIS] FED. AID PROJECT