

GENERAL NOTES:

Plan Dimensions and Details relative to existing plans are subject to nominal Construction variations. The Contractor shall field verify existing dimensions and details affecting new Construction and make necessary approved adjustments prior to Construction or ordering of materials. Such variations shall not be cause for additional compensation for a change in scope of the work, however, the Contractor will be paid for the Quantity actually furnished at the Unit Price Bid for the Work.

These Plans have been prepared from notes received from I.D.O.T. Field Maintenance Engineers.

All Asphalt Primer and other debris should be removed from the deck prior to sealing.

Concrete Sealer shall be applied to the Deck Slab, Parapets & Approach Slabs.

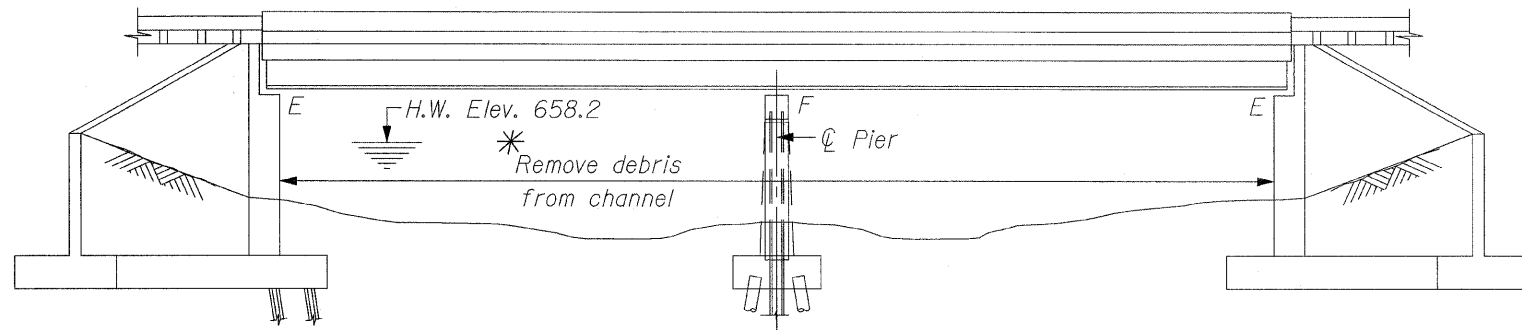

* Paid for as Channel Excavation

ELEVATION

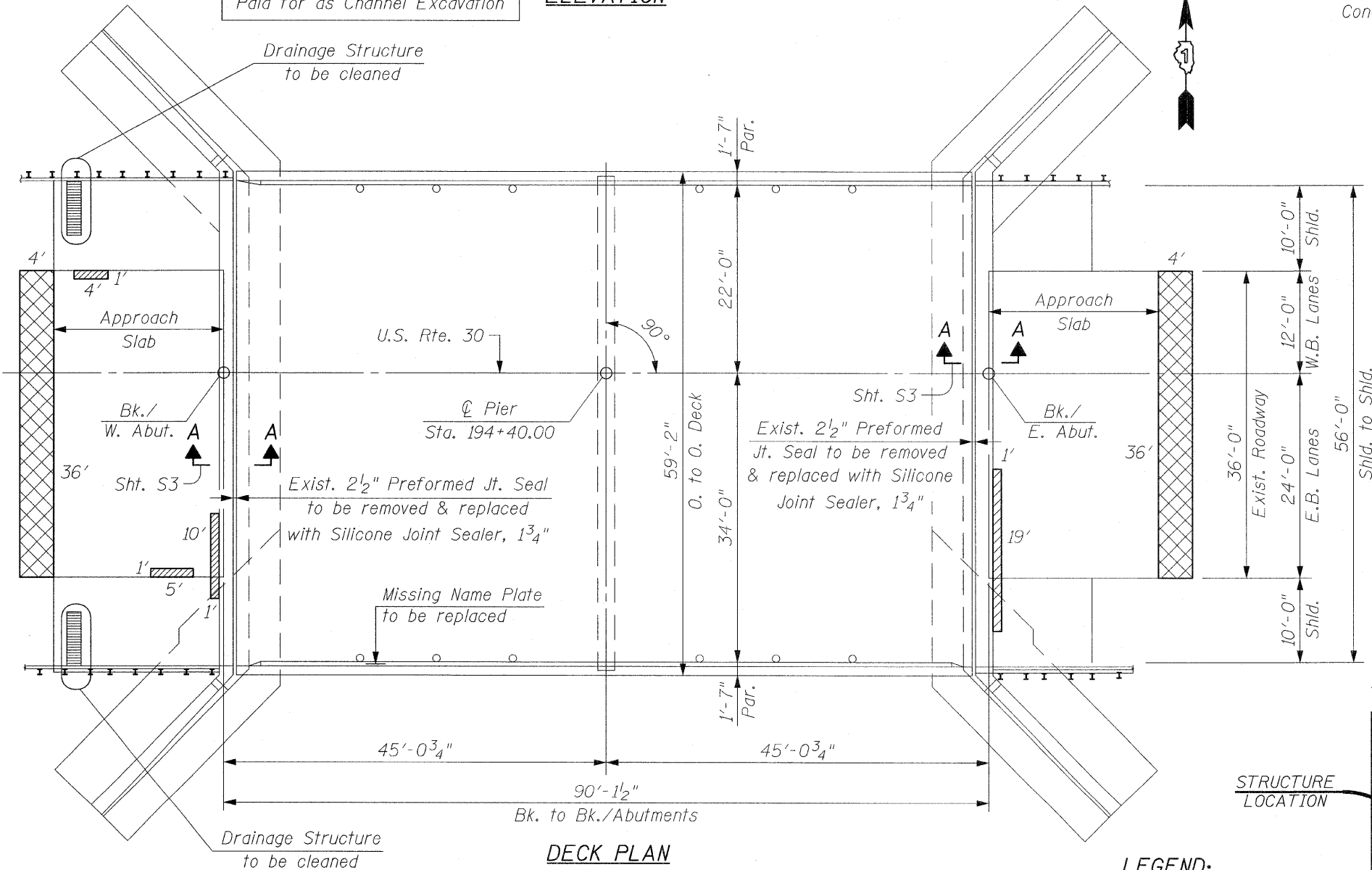

DECK PLAN

TOTAL BILL OF MATERIAL

ITEM	UNIT	QUANTITY
Channel Excavation	Cu. Yd.	15
Concrete Sealer	Sq. Ft.	7,812
Class D Patches, Type III, 10 Inch	Sq. Yd.	32
Name Plates	Each	1
Silicone Joint Sealer, 1 ³ / ₄ "	Foot	118
Approach Slab Repair (Partial Depth)	Sq. Yd.	4.2
Drainage Structures to be Cleaned	Each	2
Structural Repair of Concrete (Depth Equal to or Less Than 5 Inches)	Sq. Ft.	48

STATION 194+40.00
REBUILT 1991 BY
STATE OF ILLINOIS
F.A.U. RTE. 1555 SEC. 88-00027-00-PV
LOADING HS 20
STRUCTURE NO. 047-0029

NAME PLATE

See Std. 515001

(Taken from existing bridge plans dated 1991)

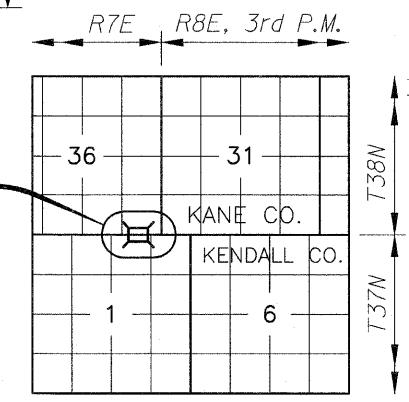

LOCATION SKETCH

LEGEND:

- Class D Patches, Type III, 10 Inch
- Approach Slab Repair (Partial Depth)

INSPECTION WAS CONDUCTED ON FEBRUARY 22, 2009
BY I.D.O.T. FIELD MAINTENANCE ENGINEERS



Bhadresh N. Shah
BHADRESH N. SHAH Feb. 27, 2005
LICENSED STRUCTURAL ENGINEER
STATE OF ILLINOIS LIC. No. 081-004476
EXPIRES: 11-30-10