

INTERCONNECT SCHEMATIC LEGEND

- | | | | |
|--|--|--|--|
| | EXISTING INTERSECTION CONTROLLER | | PROPOSED FIBER OPTIC CABLE IN CONDUIT, NO. 62.5/125, MM12F SM12F |
| | PROPOSED INTERSECTION CONTROLLER | | EXISTING INTERCONNECT CABLE - NO. 62.5/125 12F FIBER OPTIC CABLE |
| | EXISTING MASTER CONTROLLER | | PROPOSED INTERCONNECT CABLE - NO. 62.5/125 12F FIBER OPTIC CABLE |
| | PROPOSED MASTER CONTROLLER | | EXISTING INTERCONNECT CABLE - NO. 18 3 PAIR TWISTED, SHIELDED |
| | MASTER MASTER CONTROLLER | | PROPOSED INTERCONNECT CABLE - NO. 18 3 PAIR TWISTED, SHIELDED |
| | EXISTING INTERSECTION & SAMPLING (SYSTEM) DETECTORS | | EXISTING LOOP DETECTOR CABLE 2/C TWISTED, SHIELDED |
| | PROPOSED INTERSECTION & SAMPLING (SYSTEM) DETECTORS | | PROPOSED LOOP DETECTOR CABLE 2/C TWISTED, SHIELDED |
| | EXISTING INTERSECTION LOOP DETECTORS | | EXISTING ELECTRIC CABLE, 1/C (NO. 10 OR AS SPECIFIED) |
| | PROPOSED INTERSECTION LOOP DETECTORS | | PROPOSED ELECTRIC CABLE, 1/C (NO. 14 OR AS SPECIFIED) |
| | EXISTING SAMPLING (SYSTEM) DETECTORS | | EXISTING TELEPHONE CONNECTION |
| | PROPOSED SAMPLING (SYSTEM) DETECTORS | | PROPOSED TELEPHONE CONNECTION |
| | EXISTING SAMPLING (SYSTEM) DETECTORS, PROPOSED SAMPLING (SYSTEM) DETECTORS | | PROPOSED UNINTERRUPTIBLE POWER SUPPLY |
| | EXISTING PREFORMED INTERSECTION & SAMPLING (SYSTEM) DETECTORS | | EXISTING UNINTERRUPTIBLE POWER SUPPLY |
| | PROPOSED PREFORMED INTERSECTION & SAMPLING (SYSTEM) DETECTORS | | |
| | EXISTING SAMPLING (SYSTEM) DETECTORS, PREFORMED DETECTORS | | |
| | PROPOSED SAMPLING (SYSTEM) DETECTORS, PREFORMED DETECTORS | | |
| | EXISTING FIBER OPTIC CABLE IN CONDUIT, NO. 62.5/125, MM12F SM12F | | |

SCHEDULE OF QUANTITIES

QTY	UNIT	ITEM DESCRIPTION
1.0	CAL MO	ENGINEER'S FIELD OFFICE, TYPE A
0.25	L SUM	MOBILIZATION
0.25	L SUM	TRAFFIC CONTROL AND PROTECTION, STANDARD 701406
0.25	L SUM	TRAFFIC CONTROL AND PROTECTION, STANDARD 701701
5919.0	FOOT	CONDUIT IN TRENCH, 2" DIA., GALVANIZED STEEL
386.0	FOOT	CONDUIT PUSHED, 2" DIA., GALVANIZED STEEL
6.0	EACH	HANDHOLE
3.0	EACH	HEAVY DUTY HANDHOLE
5919	FOOT	TRENCH AND BACKFILL FOR ELECTRICAL WORK
6962	FOOT	ELECTRIC CABLE IN CONDUIT, TRACER, NO. 14 1C
6975	FOOT	FIBER OPTIC CABLE IN CONDUIT, NO. 62.5/125, MM12F & SM 12F

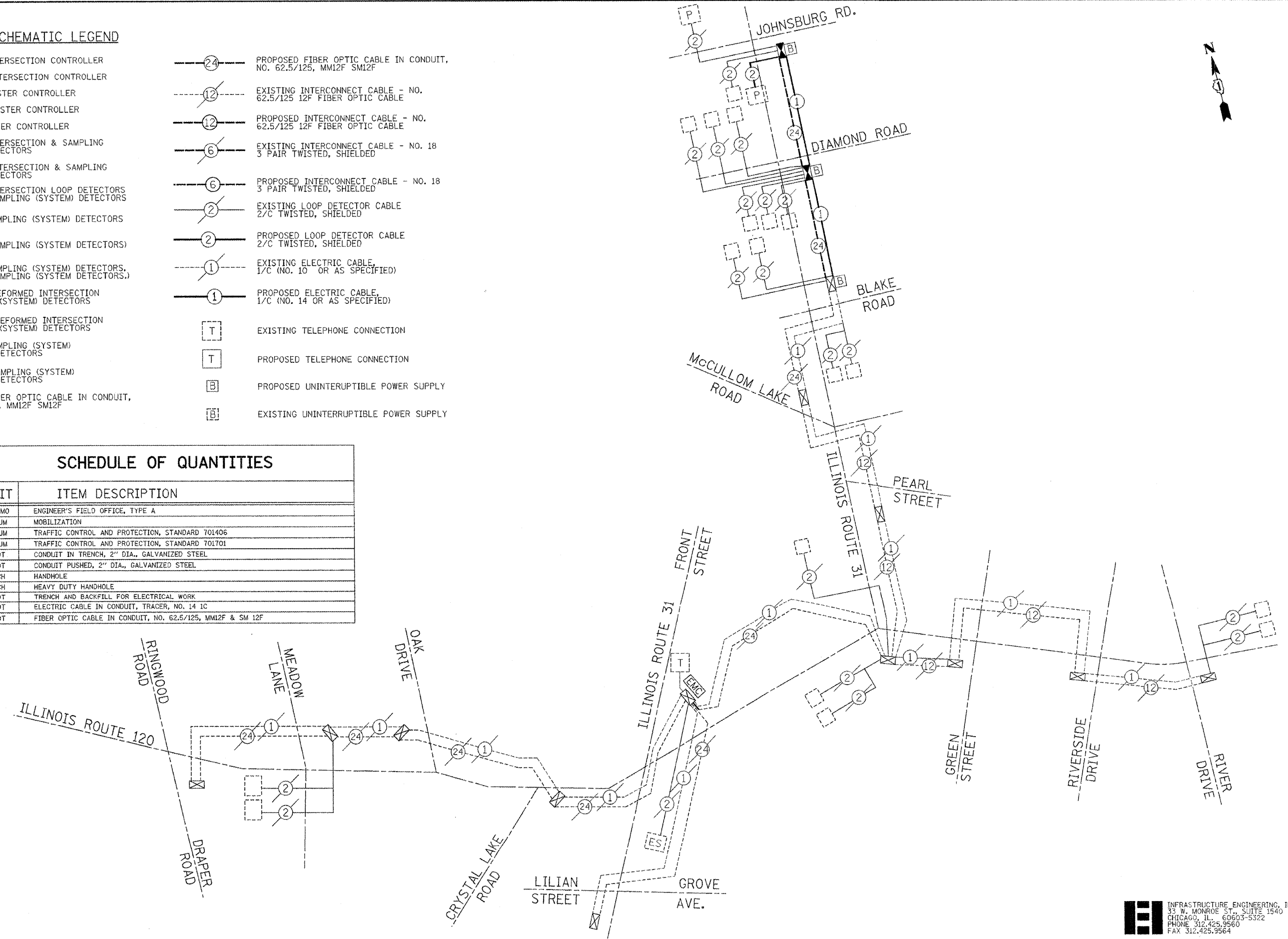

INFRASTRUCTURE ENGINEERING, INC.
 33 W. MONROE ST., SUITE 1540
 CHICAGO, IL 60603-5322
 PHONE 312.425.9560
 FAX 312.425.9564