

1/27/2009
 FILE NAME = 06A_TempSignalPlan_Rand&Dundee.dgn
 USER NAME = #USER#
 DESIGNED - CH, JS
 DRAWN - MP
 CHECKED - MJL
 DATE - 1/22/2009
 REVISED -
 REVISED -
 REVISED -
 REVISED -

RESTORATION OF WORK AREA, RESTORATION OF THE TRAFFIC SIGNAL WORK AREA SHALL BE INCIDENTAL TO THE RELATED PAY ITEM SUCH AS FOUNDATION, CONDUIT, HANDHOLE, TRENCH AND BACKFILL, ETC., AND NO EXTRA COMPENSATION SHALL BE ALLOWED. ALL ROADWAY SURFACES SUCH AS SHOULDERS, MEDIANS, SIDEWALKS, PAVEMENT, ETC. SHALL BE REPLACED IN KIND. ALL DAMAGE TO MOWED LAWNS SHALL BE REPLACED WITH AN APPROVED SOD, AND ALL DAMAGE TO UNMOWED FIELDS SHALL BE SEEDED IN ACCORDANCE WITH STANDARD SPECIFICATIONS 252 AND 250 RESPECTIVELY.

NOTES FOR TEMPORARY TRAFFIC SIGNALS
 SEE SHEET 2 OF 2

THE FOLLOWING ITEMS SHALL BE REMOVED BY THE CONTRACTOR AND SHALL BE DISPOSED BY THEM OUTSIDE THE RIGHT-OF-WAY AT THEIR EXPENSE. THE SALVAGE VALUE OF THE REMOVED EQUIPMENT SHALL BE REFLECTED IN THE CONTRACT BID PRICE.

- 1 EACH CONTROLLER AND CABINET (COMPLETE)
- 4 EACH MAST ARM ASSEMBLY AND POLE
- 2 EACH TRAFFIC SIGNAL POST
- 2 EACH SIGNAL HEAD, 1-FACE, 3-SECTIONS
- 1 EACH SIGNAL HEAD, 1-FACE, 3-SECTION (MAST ARM)
- 4 EACH SIGNAL HEAD, 1-FACE, 5-SECTION (MAST ARM)
- 2 EACH SIGNAL HEAD, 2-FACE, 1-3-SECTION
- 2 EACH SIGNAL HEAD, 3-FACE, 2-3-SECTION, 1-5-SECTION
- 14 EACH PEDESTRIAN SIGNAL HEAD
- 6 EACH PEDESTRIAN PUSH BUTTON
- 1 EACH SERVICE INSTALLATION, TYPE C

THE FOLLOWING ITEMS SHALL REMAIN AND BE INCORPORATED AS PART OF THE PROPOSED SIGNAL.

- 2 EACH TRAFFIC SIGNAL POST, GALVANIZED STEEL, 10 FT
- 2 EACH CONCRETE FOUNDATION, TYPE A

THE CONTRACTOR SHALL REMOVE THE EXISTING EMERGENCY VEHICLE PRIORITY SYSTEM CONSISTING OF:

- 1 EACH EMERGENCY VEHICLE PRIORITY SYSTEM, PHASING UNIT
- 2 EACH EMERGENCY VEHICLE PRIORITY SYSTEM, DETECTOR UNIT
- 2 EACH EMERGENCY VEHICLE PRIORITY SYSTEM, CONFIRMATION BEACON

AND SHALL DELIVER IT TO THE VILLAGE OF PALATINE FIRE DEPARTMENT AT THE ADDRESS BELOW FOR STORAGE. AFTER THE NEW TRAFFIC SIGNAL EQUIPMENT IS IN PLACE, THE CONTRACTOR SHALL BE REQUIRED TO PICK UP ALL DELIVERED EQUIPMENT AND INSTALL THE PHASING UNIT IN THE CONTROLLER CABINET AND THE DETECTOR UNIT ON THE PROPOSED MAST ARM AS INDICATED ON THE PLANS.

PALATINE FIRE DEPARTMENT
 39 EAST COLFAX
 PALATINE, IL 60067

TEMPORARY TRAFFIC SIGNAL LEGEND

- ▲ TEMPORARY TRAFFIC SIGNAL HEAD SPAN WIRE MOUNTED ORIGINAL LOCATION
- ▲ TEMPORARY TRAFFIC SIGNAL HEAD SPAN WIRE MOUNTED SECONDARY LOCATION
- ⊗ TEMPORARY WOOD POLE (CLASS 5 OR BETTER)
- DOWN GUY
- TEMPORARY CONTROLLER CABINET
- TEMPORARY SPAN WIRE, TETHER WIRE, AND CABLE
- TEMPORARY SERVICE INSTALLATION
- TEMPORARY PEDESTRIAN SIGNAL HEAD, BRACKET MOUNTED
- PEDESTRIAN PUSHBUTTON DETECTOR
- EMERGENCY VEHICLE LIGHT DETECTOR
- CONFIRMATION BEACON
- VEHICLE DETECTOR, INDUCTION LOOP
- CT COMMON TRENCH
- UD UNIT DUCT
- G.S. CONDUIT IN TRENCH OR PUSHED
- HANDHOLE
- HEAVY DUTY HANDHOLE
- VIDEO DETECTION CAMERA
- RADIO INTERCONNECT
- VIDEO DETECTION ZONE

EXISTING EQUIPMENT TO BE REMOVED LEGEND

- "E"▲ EXISTING SIGNAL HEAD TO BE REMOVED
- "E"■ EXISTING SERVICE INSTALLATION TO BE REMOVED
- "E"○ EXISTING SIGNAL POST AND FOUNDATION TO BE REMOVED
- "E"□ EXISTING ALUMINUM MAST ARM POLE AND FOUNDATION TO BE REMOVED
- "E"□ EXISTING CONTROLLER AND FOUNDATION TO BE REMOVED
- "E"□ EXISTING HANDHOLE TO BE REMOVED
- "E"□ EXISTING PEDESTRIAN SIGNAL HEAD TO BE REMOVED
- "E"○ EXISTING PEDESTRIAN PUSH-BUTTON TO BE REMOVED
- "E"○ EXISTING EMERGENCY VEHICLE SYSTEM DETECTOR TO BE RELOCATED
- "E"○ CONFIRMATION BEACON TO BE RELOCATED
- "E"□ HEAVY DUTY HANDHOLE TO BE REMOVED
- "E"□ MAST ARM ASSEMBLY AND POLE TO BE REMOVED
- "R" RELOCATE
- "A" ABANDON
- "S" SAVE EQUIPMENT IN CURRENT LOCATION

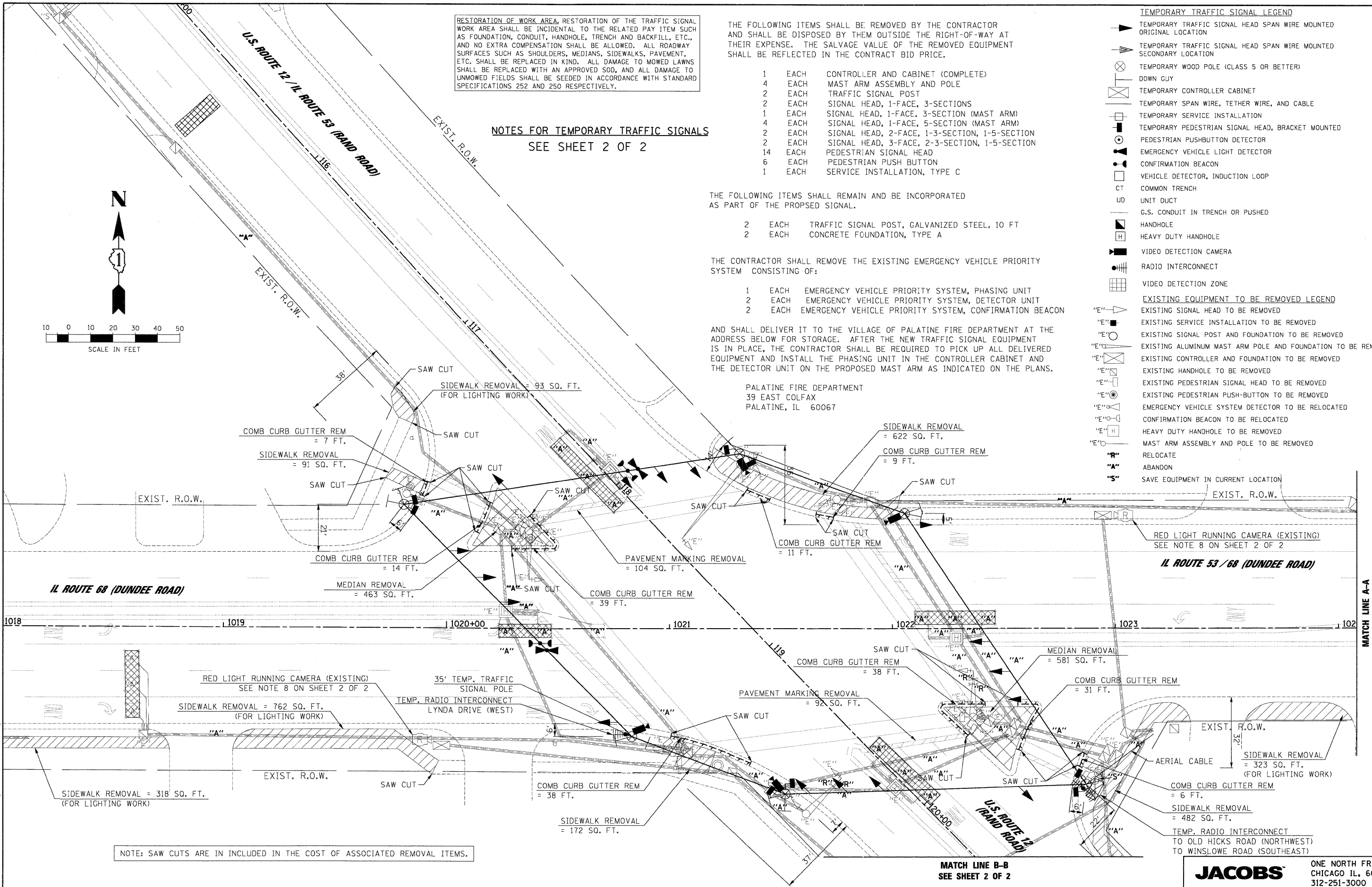
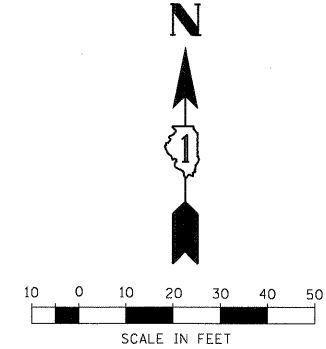

NOTE: SAW CUTS ARE INCLUDED IN THE COST OF ASSOCIATED REMOVAL ITEMS.

MATCH LINE A-A
SEE SHEET 2 OF 2

MATCH LINE B-B
SEE SHEET 2 OF 2

**STATE OF ILLINOIS
 DEPARTMENT OF TRANSPORTATION**

**TEMPORARY TRAFFIC SIGNAL INSTALLATION— SHEET 1 OF 2
 REMOVE EXISTING TRAFFIC SIGNAL EQUIPMENT PLAN
 U.S. ROUTE 12 (RAND ROAD) AND IL ROUTE 53 / 68 (DUNDEE ROAD)**

JACOBS ONE NORTH FRANKLIN
 CHICAGO IL, 60606
 312-251-3000

FILE NAME = 06A_TempSignalPlan_Rand&Dundee.dgn	USER NAME = #USER#	DESIGNED - CH, JS	DRAWN - MP	CHECKED - MJL	DATE - 1/22/2009	REVISED -	REVISED -	REVISED -	REVISED -
SCALE: 1"=20' SHEET NO. OF SHEETS STA. TO STA.									
F.A.P. RTE. 334 SECTION 2008-08-31 COUNTY COCK TOTAL SHEETS 80 SHEET NO. 15 CONTRACT NO. 60F87									
FED. ROAD DIST. NO. ILLINOIS FED. AID PROJECT									