

RESTORATION OF WORK AREA, RESTORATION OF THE TRAFFIC SIGNAL WORK AREA SHALL BE INCIDENTAL TO THE RELATED PAY ITEM SUCH AS FOUNDATION, CONDUIT, HANDHOLE, TRENCH AND BACKFILL, ETC., AND NO EXTRA COMPENSATION SHALL BE ALLOWED. ALL ROADWAY SURFACES SUCH AS SHOULDERS, MEDIANS, SIDEWALKS, PAVEMENT, ETC. SHALL BE REPLACED IN KIND. ALL DAMAGE TO MOWED LAWNS SHALL BE REPLACED WITH AN APPROVED SOB, AND ALL DAMAGE TO UNMOWED FIELDS SHALL BE SEED IN ACCORDANCE WITH STANDARD SPECIFICATIONS 252 AND 250 RESPECTIVELY.

NOTE: THE TRAFFIC SIGNAL CONTROLLER EQUIPMENT FOR THIS PROJECT SHALL BE "ECONOLITE" TO MATCH THE EXISTING ADJACENT SYSTEM.

TRAFFIC SIGNAL LEGEND

- EXISTING EQUIPMENT TO BE REMOVED LEGEND**
- "E" [Symbol] EXISTING SIGNAL HEAD TO BE REMOVED
  - "E" [Symbol] EXISTING SERVICE INSTALLATION TO BE REMOVED
  - "E" [Symbol] EXISTING SIGNAL POST AND FOUNDATION TO BE REMOVED
  - "E" [Symbol] EXISTING ALUMINUM MAST ARM POLE AND FOUNDATION TO BE REMOVED
  - "E" [Symbol] EXISTING CONTROLLER AND FOUNDATION TO BE REMOVED
  - "E" [Symbol] EXISTING HANDHOLE TO BE REMOVED
  - "E" [Symbol] EXISTING PEDESTRIAN SIGNAL HEAD TO BE REMOVED
  - "E" [Symbol] EXISTING PEDESTRIAN PUSH-BUTTON TO BE REMOVED
  - "E" [Symbol] EMERGENCY VEHICLE SYSTEM DETECTOR TO BE RELOCATED
  - "E" [Symbol] CONFIRMATION BEACON TO BE RELOCATED
  - "E" [Symbol] HEAVY DUTY HANDHOLE TO BE REMOVED
  - "E" [Symbol] MAST ARM ASSEMBLY AND POLE TO BE REMOVED
  - "R" [Symbol] RELOCATE
  - "A" [Symbol] ABANDON

- PROPOSED**
- [Symbol] CONTROLLER
  - [Symbol] SERVICE INSTALLATION
  - [Symbol] SIGNAL HEAD
  - [Symbol] SIGNAL HEAD WITH BACKPLATE
  - [Symbol] SIGNAL HEAD, PEDESTRIAN
  - [Symbol] SIGNAL POST
  - [Symbol] MAST ARM ASSEMBLY AND POLE, STEEL
  - [Symbol] MAST ARM ASSEMBLY AND POLE, ALUMINUM
  - [Symbol] MAST ARM ASSEMBLY AND POLE, STEEL WITH LUMINAIRE
  - [Symbol] UNIT DUCT
  - [Symbol] COMMON TRENCH
  - [Symbol] HANDHOLE
  - [Symbol] HEAVY DUTY HANDHOLE
  - [Symbol] DOUBLE HANDHOLE
  - [Symbol] G.S. CONDUIT IN TRENCH OR PUSHED
  - [Symbol] DEPRESSED CURB
  - [Symbol] DETECTABLE WARNING TILE
  - [Symbol] UNINTERRUPTIBLE POWER SUPPLY
  - [Symbol] RELOCATED
- EXISTING**
- [Symbol] PEDESTRIAN PUSHBUTTON DETECTOR
  - [Symbol] DETECTOR LOOP
  - [Symbol] CAST IRON JUNCTION BOX
  - [Symbol] EMERGENCY VEHICLE LIGHT DETECTOR
  - [Symbol] CONFIRMATION BEACON
  - [Symbol] SIGNAL HEAD OPTICALLY PROGRAMMED
  - [Symbol] CONDUIT SPLICE
  - [Symbol] WOOD POLE
  - [Symbol] RACEWAY FOR MAGNETIC DETECTOR, TYPE I OR TYPE II
  - [Symbol] VEHICLE DETECTOR, NON COMPENSATED MAGNETIC TYPE
  - [Symbol] RAILROAD CONTROL CABINET
  - [Symbol] TELEPHONE CONNECTION
  - [Symbol] ILLUMINATED SIGN, "NO LEFT TURN"
  - [Symbol] ILLUMINATED SIGN, "NO RIGHT TURN"
  - [Symbol] RADIO INTERCONNECT

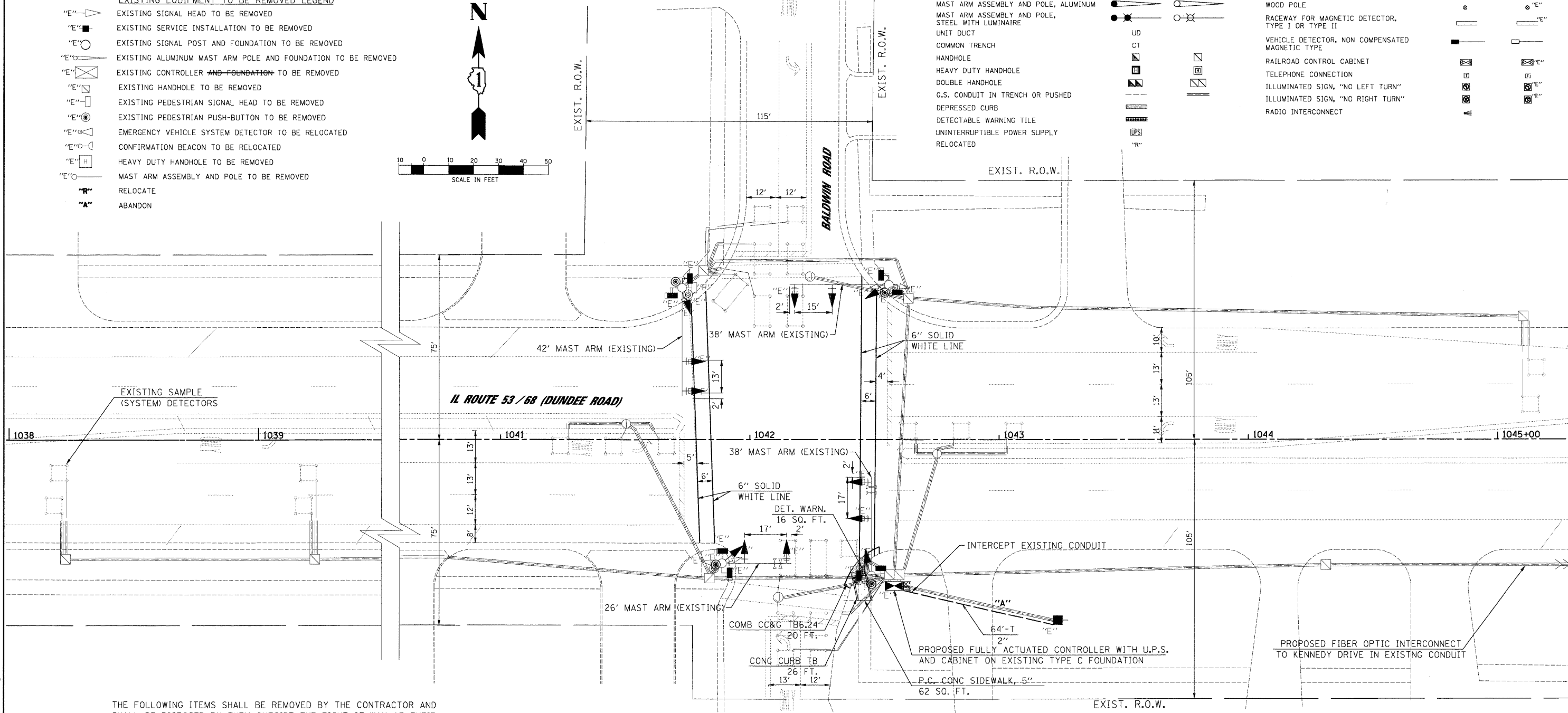
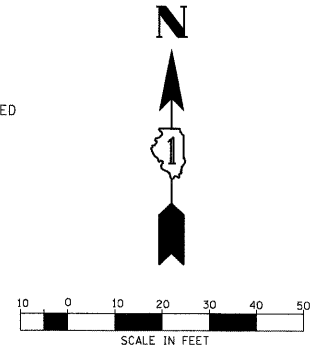

THE FOLLOWING ITEMS SHALL BE REMOVED BY THE CONTRACTOR AND SHALL BE DISPOSED BY THEM OUTSIDE THE RIGHT-OF-WAY AT THEIR EXPENSE. THE SALVAGE VALUE OF THE REMOVED EQUIPMENT SHALL BE REFLECTED IN THE CONTRACT BID PRICE.

- 1 EACH CONTROLLER AND CABINET (COMPLETE)
- 2 EACH SIGNAL HEAD, 1-FACE, 3-SECTION (MAST ARM)
- 4 EACH SIGNAL HEAD, 1-FACE, 5-SECTION (MAST ARM)
- 4 EACH SIGNAL HEAD, 2-FACE, 1-3-SECTION, 1-5-SECTION
- 6 EACH PEDESTRIAN SIGNAL HEAD, 1-FACE
- 4 EACH PEDESTRIAN PUSH BUTTON
- 1 EACH SERVICE INSTALLATION, TYPE C

CONSTRUCTION NOTES:

1. EXISTING MASTARMS, POLES, HANDHOLES, CONDUIT AND TYPE C CONTROLLER FOUNDATION TO BE MAINTAINED.
2. INSTALL NEW CONTROLLER AND TYPE IV CABINET (SPECIAL). RELOCATE EXISTING EMERGENCY VEHICLE PHASING UNIT TO NEW CONTROLLER CABINET AND RELOCATE DETECTOR UNIT ON NEW MAST ARM. RELOCATION OF THE EMERGENCY PRIORITY SYSTEM EQUIPMENT WILL BE INCLUDED IN THE NEW CONTROLLER AND TYPE IV CABINET (SPECIAL) UNIT PRICE.

FILE NAME = 18\_SignalPlan\_Dundee&Baldwin.dgn

USER NAME = #USER#	DESIGNED - CH	REVISED -
PLOT SCALE = #SCALE#	DRAWN - MP, AG	REVISED -
PLOT DATE = 1/27/2009	CHECKED - MJL	REVISED -
	DATE - 1/27/2009	REVISED -

STATE OF ILLINOIS  
DEPARTMENT OF TRANSPORTATION

REMOVE EXISTING TRAFFIC SIGNAL EQUIPMENT PLAN  
TRAFFIC SIGNAL MODERNIZATION PLAN  
IL ROUTE 53 / 68 (DUNDEE ROAD) & BALDWIN ROAD

SCALE: 1"=20' SHEET NO. OF SHEETS STA. TO STA.

<b>JACOBS</b>		ONE NORTH FRANKLIN CHICAGO IL, 60606 312-251-3000		
F.A.P. RTE. 334	SECTION 2008-08-31	COUNTY COOK	TOTAL SHEETS 80	SHEET NO. 29
FED. ROAD DIST. NO.		ILLINOIS FED. AID PROJECT		
CONTRACT NO. 60F87				