

RESTORATION OF WORK AREA, RESTORATION OF THE TRAFFIC SIGNAL WORK AREA SHALL BE INCIDENTAL TO THE RELATED PAY ITEM SUCH AS FOUNDATION, CONDUIT, HANDHOLE, TRENCH AND BACKFILL, ETC., AND NO EXTRA COMPENSATION SHALL BE ALLOWED. ALL ROADWAY SURFACES SUCH AS SHOULDERS, MEDIAN, SIDEWALKS, PAVEMENT ETC. SHALL BE REPLACED IN KIND. ALL DAMAGE TO MOWED LAWNS SHALL BE REPLACED WITH AN APPROVED SOD, AND ALL DAMAGE TO UNMOWED FIELDS SHALL BE SEEDDED IN ACCORDANCE WITH STANDARD SPECIFICATIONS 252 AND 250 RESPECTIVELY.

STEARNS SCHOOL ROAD

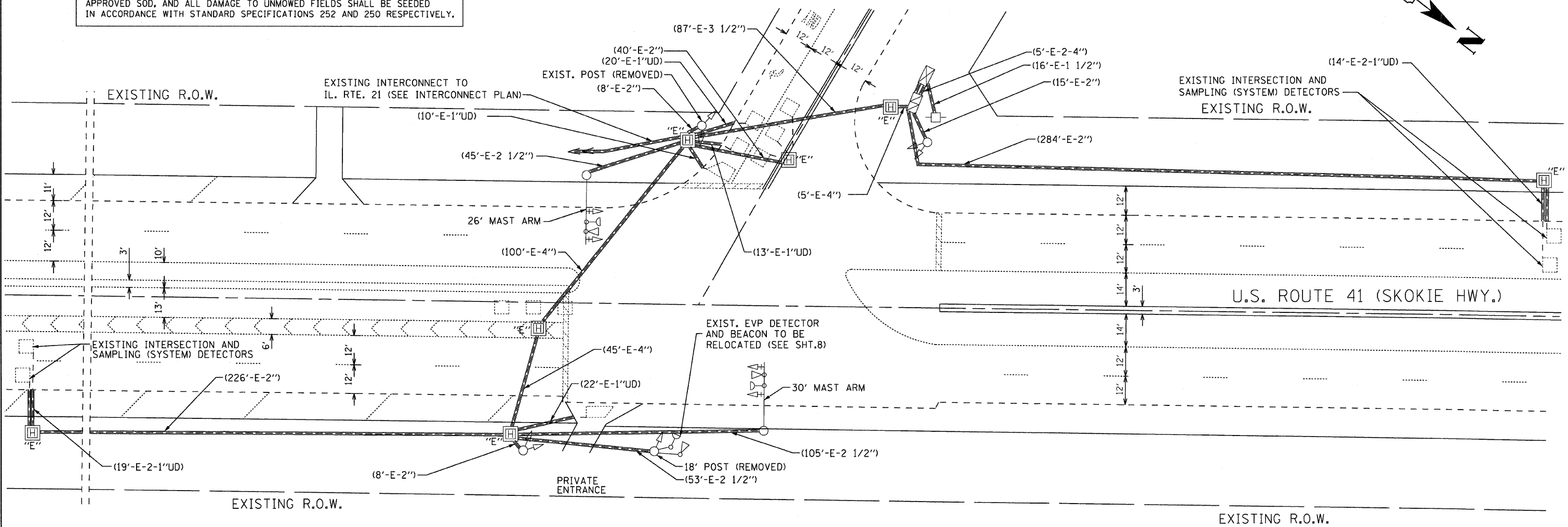

REGINA WEBSTER AND ASSOC. INC. CIVIL ENGINEERING CONSULTANTS 610 North Cicero Ave., Suite 500 Chicago, Illinois 60623-1969
RWA
 Regina Webster & Associates, Inc.

EXISTING EQUIPMENT TO BE REMOVED LEGEND

- ◁ EXISTING SIGNAL HEAD TO BE REMOVED
- "E" □ EXISTING SERVICE INSTALLATION TO BE REMOVED
- EXISTING SIGNAL POST AND FOUNDATION TO BE REMOVED
- ◁ EXISTING MAST ARM POLE AND FOUNDATION TO BE REMOVED
- "E" ⊠ EXISTING CONTROLLER AND FOUNDATION TO BE REMOVED
- "E" □ EXISTING HANDHOLE TO BE REMOVED
- "X" EXISTING SIGNAL HEAD, POST AND FOUNDATION TO BE REMOVED BEFORE STAGE 1

REMOVAL OF EXISTING TRAFFIC SIGNAL EQUIPMENT

THE FOLLOWING ITEMS SHALL BE REMOVED BY THE CONTRACTOR AND SHALL BE DISPOSED OF BY THEM OUTSIDE THE RIGHT-OF-WAY AT THEIR EXPENSE. THE SALVAGE VALUE OF THE REMOVED EQUIPMENT SHALL BE REFLECTED IN THE CONTRACT BID PRICE.

- 4 EACH SIGNAL HEAD, 1 - FACE, 3 - SECTION
- 1 EACH SIGNAL HEAD, 1 - FACE, 5 - SECTION
- 3 EACH SIGNAL HEAD, 2 - FACE, 1-3 SECTION, 1-5 SECTION
- 4 EACH TRAFFIC SIGNAL BACKPLATE
- 2 EACH SIGNAL POST

NOTE:
 EXISTING SIGNAL POSTS TO BE REMOVED, WITH RELATED SIGNAL HEADS, MUST REMAIN IN OPERATION UNTIL THE PROPOSED MAST ARM IS INSTALLED AND THE PROPOSED SIGNAL HEADS ARE TURN-ON. THE PROPOSED WORK MUST BE ACCEPTED AND APPROVED BY THE IDOT AREA FIELD ENGINEER BEFORE THE EXISTING SIGNAL POST AND RELATED SIGNAL HEADS ARE REMOVED.

FILE NAME =	USER NAME = #USER#	DESIGNED - JS	REVISED -	STATE OF ILLINOIS DEPARTMENT OF TRANSPORTATION	U.S. ROUTE 41 (SKOKIE HWY.) AND STEARNS SCHOOL RD. REMOVE EXISTING TRAFFIC SIGNAL EQUIPMENT PLAN	F.A.P. RTE.	SECTION	COUNTY	TOTAL SHEETS	SHEET NO.	
#FILE#		DRAWN - DW	REVISED -			346	2009-004-TS	LAKE	15	7	
	PLOT SCALE = #SCALE#	CHECKED - JD	REVISED -			CONTRACT NO. 60G00					
	PLOT DATE = #DATE#	DATE - 01/29/09	REVISED -			SCALE: 1"=20'	SHEET NO. 7 OF 15 SHEETS	STA.	TO STA.	FED. ROAD DIST. NO. ILLINOIS FED. AID PROJECT	