

THE FOLLOWING ITEMS SHALL BE REMOVED BY THE CONTRACTOR AND SHALL BE DISPOSED OF BY THEM OUTSIDE THE RIGHT-OF-WAY AT THEIR EXPENSE. THE SALVAGE VALUE OF THE REMOVED EQUIPMENT SHALL BE REFLECTED IN THE CONTRACT BID PRICE.

- 6 EACH PEDESTRIAN SIGNAL SIGNAL HEAD, 1-FACE
- 2 EACH PEDESTRIAN SIGNAL SIGNAL HEAD, 3-FACE
- 8 EACH PEDESTRIAN PUSH-BUTTON

DATE	BY	DATE	BY
DATE	BY	DATE	BY

CHRISTOPHER B. BURKE ENGINEERING LTD.
 3575 West Higgins Road, Suite 600
 Rosemont, Illinois 60018
 (847) 823-0500

PROFILL
 SURVEYED
 CHECKED
 DATE
 BY

MATCH LINE H-H

TRAFFIC SIGNAL LEGEND

- | | | | |
|--|--|----------|--|
| CONTROLLER | | EXISTING | |
| SERVICE INSTALLATION | | EXISTING | |
| SIGNAL HEAD | | EXISTING | |
| SIGNAL HEAD WITH BACKPLATE | | EXISTING | |
| SIGNAL HEAD, PEDESTRIAN | | EXISTING | |
| SIGNAL POST | | EXISTING | |
| MAST ARM ASSEMBLY AND POLE, STEEL | | EXISTING | |
| MAST ARM ASSEMBLY AND POLE, ALUMINUM | | EXISTING | |
| COMBINATION MAST ARM ASSEMBLY AND POLE, STEEL WITH LUMINAIRE | | EXISTING | |
| UNIT DUCT | | EXISTING | |
| COMMON TRENCH | | EXISTING | |
| HANDHOLE | | EXISTING | |
| HEAVY DUTY HANDHOLE | | EXISTING | |
| DOUBLE HANDHOLE | | EXISTING | |
| G.S. CONDUIT IN TRENCH (T) OR PUSHED (P) | | EXISTING | |
| PEDESTRIAN PUSHBUTTON DETECTOR | | EXISTING | |
| DETECTOR LOOP | | EXISTING | |
| CAST IRON JUNCTION BOX | | EXISTING | |
| EMERGENCY VEHICLE LIGHT DETECTOR | | EXISTING | |
| CONFIRMATION BEACON | | EXISTING | |
| SIGNAL HEAD OPTICALLY PROGRAMMED | | EXISTING | |
| CONDUIT SPLICE | | EXISTING | |
| WOOD POLE | | EXISTING | |
| RACEWAY FOR MAGNETIC DETECTOR, TYPE I OR TYPE II | | EXISTING | |
| VEHICLE DETECTOR, NON COMPENSATED MAGNETIC TYPE | | EXISTING | |
| RAILROAD CONTROL CABINET | | EXISTING | |
| TELEPHONE CONNECTION | | EXISTING | |
| ILLUMINATED SIGN "NO LEFT TURN" | | EXISTING | |
| ILLUMINATED SIGN "NO RIGHT TURN" | | EXISTING | |
| UNINTERRUPTIBLE POWER SUPPLY | | EXISTING | |
| DETECTION ZONE | | EXISTING | |
| TELEPHONE CONNECTION | | EXISTING | |
| IMAGE SENSOR (CCTV CAMERA) | | EXISTING | |
| VIDEO SIGNAL TRANSMITTER | | EXISTING | |

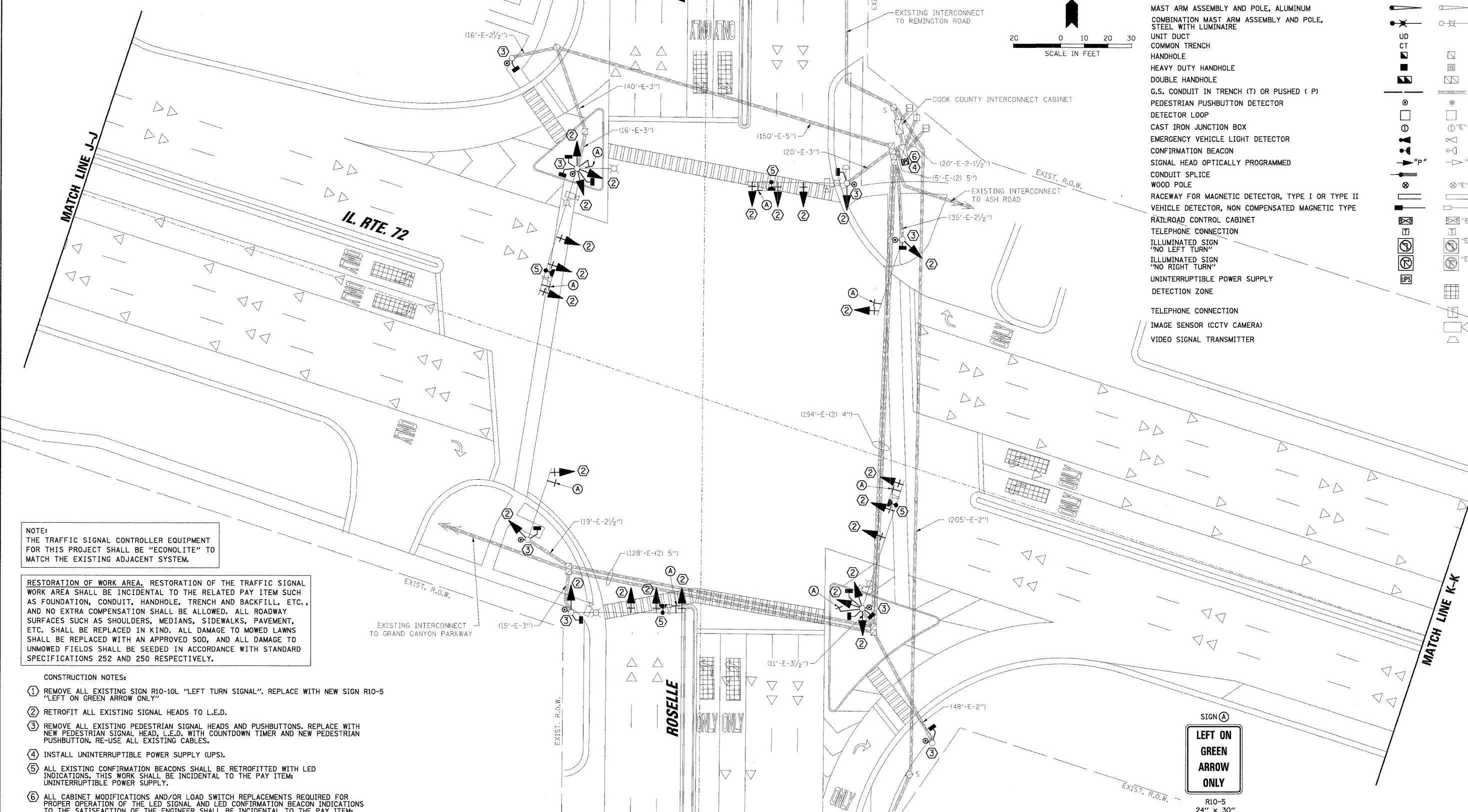
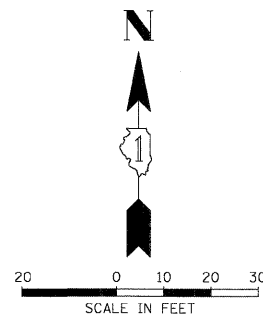

NOTE:
 THE TRAFFIC SIGNAL CONTROLLER EQUIPMENT FOR THIS PROJECT SHALL BE "ECONOLITE" TO MATCH THE EXISTING ADJACENT SYSTEM.

RESTORATION OF WORK AREA. RESTORATION OF THE TRAFFIC SIGNAL WORK AREA SHALL BE INCIDENTAL TO THE RELATED PAY ITEM SUCH AS FOUNDATION, CONDUIT, HANDHOLE, TRENCH AND BACKFILL, ETC., AND NO EXTRA COMPENSATION SHALL BE ALLOWED. ALL ROADWAY SURFACES SUCH AS SHOULDERS, MEDIANS, SIDEWALKS, PAVEMENT, ETC. SHALL BE REPLACED IN KIND. ALL DAMAGE TO MOWED LAWNS SHALL BE REPLACED WITH AN APPROVED SOD, AND ALL DAMAGE TO UNMOWED FIELDS SHALL BE SEED IN ACCORDANCE WITH STANDARD SPECIFICATIONS 252 AND 250 RESPECTIVELY.

- CONSTRUCTION NOTES:
- 1 REMOVE ALL EXISTING SIGN R10-10L "LEFT TURN SIGNAL". REPLACE WITH NEW SIGN R10-5 "LEFT ON GREEN ARROW ONLY"
 - 2 RETROFIT ALL EXISTING SIGNAL HEADS TO L.E.D.
 - 3 REMOVE ALL EXISTING PEDESTRIAN SIGNAL HEADS AND PUSHBUTTONS. REPLACE WITH NEW PEDESTRIAN SIGNAL HEAD, L.E.D. WITH COUNTDOWN TIMER AND NEW PEDESTRIAN PUSHBUTTON. RE-USE ALL EXISTING CABLES.
 - 4 INSTALL UNINTERRUPTIBLE POWER SUPPLY (UPS).
 - 5 ALL EXISTING CONFIRMATION BEACONS SHALL BE RETROFITTED WITH LED INDICATORS. THIS WORK SHALL BE INCIDENTAL TO THE PAY ITEM: UNINTERRUPTIBLE POWER SUPPLY.
 - 6 ALL CABINET MODIFICATIONS AND/OR LOAD SWITCH REPLACEMENTS REQUIRED FOR PROPER OPERATION OF THE LED SIGNAL AND LED CONFIRMATION BEACON INDICATORS TO THE SATISFACTION OF THE ENGINEER SHALL BE INCIDENTAL TO THE PAY ITEM: UNINTERRUPTIBLE POWER SUPPLY.



FILE NAME =	USER NAME = FPACIONE	DESIGNED - ABR	REVISED -	STATE OF ILLINOIS DEPARTMENT OF TRANSPORTATION	TRAFFIC SIGNAL MODERNIZATION PLAN IL. ROUTE 72 AND ROSELLE ROAD	F.A.P. RTE.	SECTION	COUNTY	TOTAL SHEETS	SHEET NO.	
...M001.IL72 & Roselle.dgn		DRAWN - FPB / FCP	REVISED -			VAR	2009-008-TS	COOK	41	7	
		CHECKED - MJT	REVISED -			CONTRACT NO. 60G04					
		DATE - 1/26/2009	REVISED -			FED. ROAD DIST. NO. ILLINOIS FED. AID PROJECT					