

SURVIVED  
 CHECKED  
 DATE  
 BY  
 PLAN  
 SURVIVED  
 CHECKED  
 DATE  
 BY  
 PROFILE  
 SURVIVED  
 CHECKED  
 DATE  
 BY  
 NOTE BOOK  
 NO.

**CHRISTOPHER B. BURKE ENGINEERING LTD.**  
 9575 West Higgins Road, Suite 600  
 Rosemont, Illinois 60018  
 (847) 823-0500

**TRAFFIC SIGNAL LEGEND**

- CONTROLLER
- SERVICE INSTALLATION
- SIGNAL HEAD
- SIGNAL HEAD WITH BACKPLATE
- SIGNAL HEAD, PEDESTRIAN
- SIGNAL POST
- MAST ARM ASSEMBLY AND POLE, STEEL
- MAST ARM ASSEMBLY AND POLE, ALUMINUM
- COMBINATION MAST ARM ASSEMBLY AND POLE, STEEL WITH LUMINAIRE
- UNIT DUCT
- COMMON TRENCH
- HANDHOLE
- HEAVY DUTY HANDHOLE
- DOUBLE HANDHOLE
- G.S. CONDUIT IN TRENCH (T) OR PUSHED (P)
- PEDESTRIAN PUSHBUTTON DETECTOR
- DETECTOR LOOP
- CAST IRON JUNCTION BOX
- EMERGENCY VEHICLE LIGHT DETECTOR
- CONFIRMATION BEACON
- SIGNAL HEAD OPTICALLY PROGRAMMED
- CONDUIT SPLICE
- WOOD POLE
- RACEWAY FOR MAGNETIC DETECTOR, TYPE I OR TYPE II
- VEHICLE DETECTOR, NON COMPENSATED MAGNETIC TYPE
- RAILROAD CONTROL CABINET
- TELEPHONE CONNECTION
- ILLUMINATED SIGN "NO LEFT TURN"
- ILLUMINATED SIGN "NO RIGHT TURN"
- UNINTERRUPTIBLE POWER SUPPLY

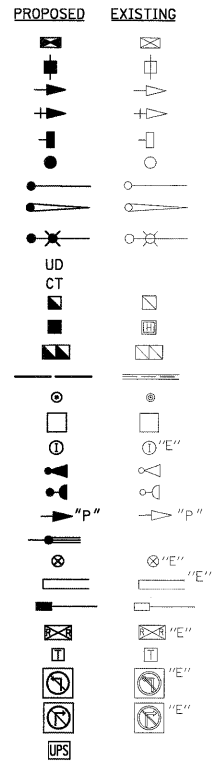

- CONSTRUCTION NOTES:**
- ① REMOVE ALL EXISTING SIGN R10-10L "LEFT TURN SIGNAL". REPLACE WITH NEW SIGN R10-5 "LEFT ON GREEN ARROW ONLY".
  - ② REMOVE EXISTING SIGNAL HEAD, 1-FACE, 3-SECTION, MAST ARM MOUNTED. REPLACE WITH NEW SIGNAL HEAD, L.E.D., 1-FACE, 3-SECTION, MAST ARM MOUNTED. RE-USE ALL EXISTING CABLES.
  - ③ REMOVE EXISTING SIGNAL HEADS, 3-FACE, 1-3 SECTION, 2-5 SECTION, BRACKET MOUNTED. REPLACE WITH NEW SIGNAL HEAD, L.E.D., 3-FACE, 1-3 SECTION, 2-5 SECTION, BRACKET MOUNTED. RE-USE ALL EXISTING CABLES.
  - ④ REMOVE ALL EXISTING PEDESTRIAN SIGNAL HEADS AND PUSHBUTTON. REPLACE WITH NEW PEDESTRIAN SIGNAL HEAD, L.E.D. WITH COUNTDOWN TIMER AND NEW PEDESTRIAN PUSHBUTTON. RE-USE ALL EXISTING CABLES.
  - ⑤ INSTALL UNINTERRUPTIBLE POWER SUPPLY (UPS).
  - ⑥ ALL EXISTING CONFIRMATION BEACONS SHALL BE RETROFITTED WITH LED INDICATIONS. THIS WORK SHALL BE INCIDENTAL TO THE PAY ITEM: UNINTERRUPTIBLE POWER SUPPLY.
  - ⑦ ALL CABINET MODIFICATIONS AND/OR LOAD SWITCH REPLACEMENTS REQUIRED FOR PROPER OPERATION OF THE LED SIGNAL AND LED CONFIRMATION BEACON INDICATIONS TO THE SATISFACTION OF THE ENGINEER SHALL BE INCIDENTAL TO THE PAY ITEM: UNINTERRUPTIBLE POWER SUPPLY.

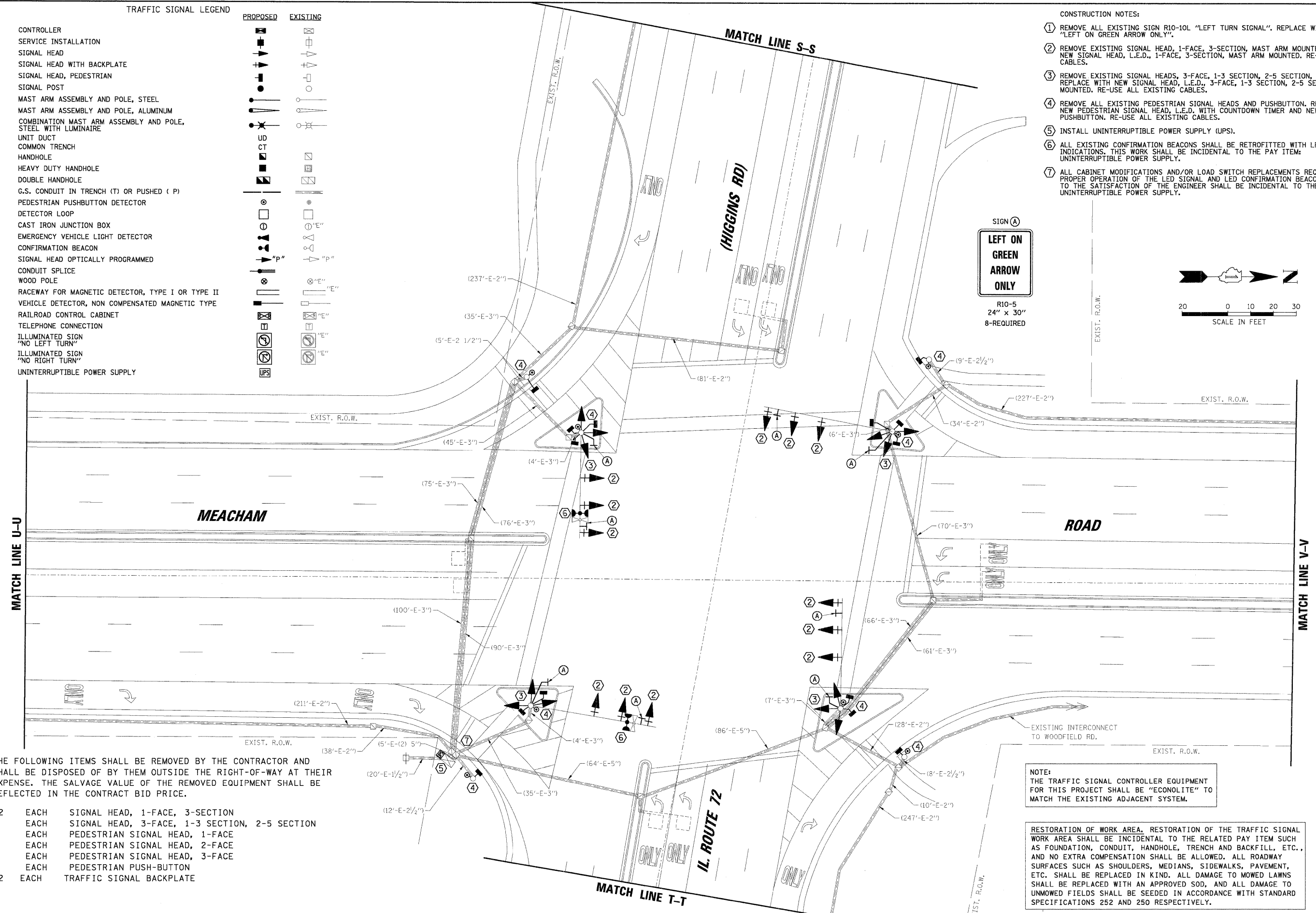
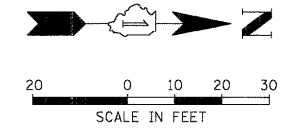

THE FOLLOWING ITEMS SHALL BE REMOVED BY THE CONTRACTOR AND SHALL BE DISPOSED OF BY THEM OUTSIDE THE RIGHT-OF-WAY AT THEIR EXPENSE. THE SALVAGE VALUE OF THE REMOVED EQUIPMENT SHALL BE REFLECTED IN THE CONTRACT BID PRICE.

- 12 EACH SIGNAL HEAD, 1-FACE, 3-SECTION
- 4 EACH SIGNAL HEAD, 3-FACE, 1-3 SECTION, 2-5 SECTION
- 4 EACH PEDESTRIAN SIGNAL HEAD, 1-FACE
- 2 EACH PEDESTRIAN SIGNAL HEAD, 2-FACE
- 2 EACH PEDESTRIAN SIGNAL HEAD, 3-FACE
- 8 EACH PEDESTRIAN PUSH-BUTTON
- 12 EACH TRAFFIC SIGNAL BACKPLATE

**NOTE:**  
THE TRAFFIC SIGNAL CONTROLLER EQUIPMENT FOR THIS PROJECT SHALL BE "ECONOLITE" TO MATCH THE EXISTING ADJACENT SYSTEM.

**RESTORATION OF WORK AREA.** RESTORATION OF THE TRAFFIC SIGNAL WORK AREA SHALL BE INCIDENTAL TO THE RELATED PAY ITEM SUCH AS FOUNDATION, CONDUIT, HANDHOLE, TRENCH AND BACKFILL, ETC., AND NO EXTRA COMPENSATION SHALL BE ALLOWED. ALL ROADWAY SURFACES SUCH AS SHOULDERS, MEDIANS, SIDEWALKS, PAVEMENT, ETC. SHALL BE REPLACED IN KIND. ALL DAMAGE TO MOWED LAWNS SHALL BE REPLACED WITH AN APPROVED SOD, AND ALL DAMAGE TO UNMOWED FIELDS SHALL BE SEEDED IN ACCORDANCE WITH STANDARD SPECIFICATIONS 252 AND 250 RESPECTIVELY.