

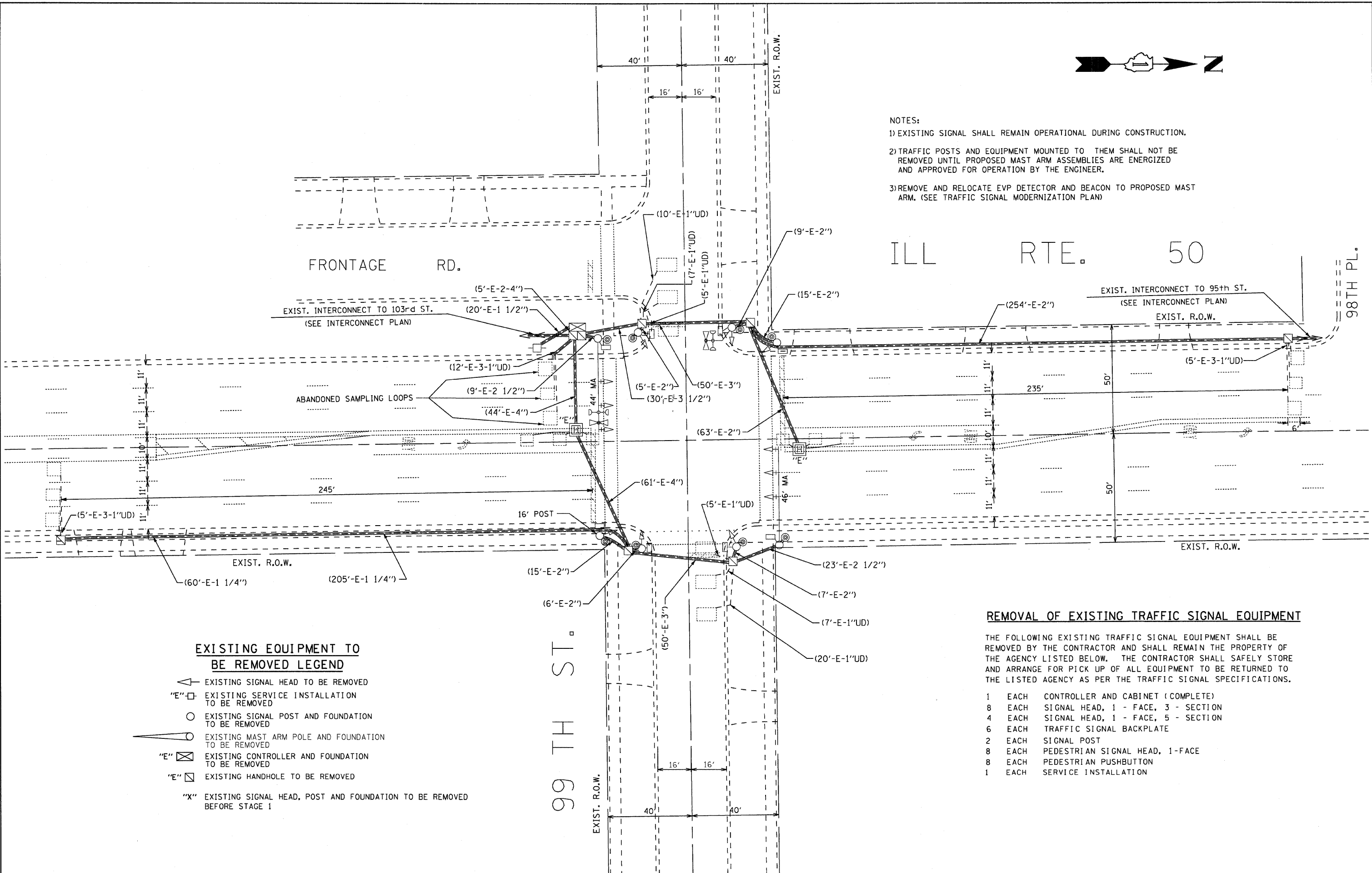

- NOTES:
- 1) EXISTING SIGNAL SHALL REMAIN OPERATIONAL DURING CONSTRUCTION.
 - 2) TRAFFIC POSTS AND EQUIPMENT MOUNTED TO THEM SHALL NOT BE REMOVED UNTIL PROPOSED MAST ARM ASSEMBLIES ARE ENERGIZED AND APPROVED FOR OPERATION BY THE ENGINEER.
 - 3) REMOVE AND RELOCATE EVP DETECTOR AND BEACON TO PROPOSED MAST ARM. (SEE TRAFFIC SIGNAL MODERNIZATION PLAN)



EXISTING EQUIPMENT TO BE REMOVED LEGEND

- ◁ EXISTING SIGNAL HEAD TO BE REMOVED
- "E" □ EXISTING SERVICE INSTALLATION TO BE REMOVED
- EXISTING SIGNAL POST AND FOUNDATION TO BE REMOVED
- ◁ EXISTING MAST ARM POLE AND FOUNDATION TO BE REMOVED
- "E" ⊠ EXISTING CONTROLLER AND FOUNDATION TO BE REMOVED
- "E" ⊠ EXISTING HANDHOLE TO BE REMOVED
- "X" EXISTING SIGNAL HEAD, POST AND FOUNDATION TO BE REMOVED BEFORE STAGE 1

REMOVAL OF EXISTING TRAFFIC SIGNAL EQUIPMENT

THE FOLLOWING EXISTING TRAFFIC SIGNAL EQUIPMENT SHALL BE REMOVED BY THE CONTRACTOR AND SHALL REMAIN THE PROPERTY OF THE AGENCY LISTED BELOW. THE CONTRACTOR SHALL SAFELY STORE AND ARRANGE FOR PICK UP OF ALL EQUIPMENT TO BE RETURNED TO THE LISTED AGENCY AS PER THE TRAFFIC SIGNAL SPECIFICATIONS.

- | | | |
|---|------|------------------------------------|
| 1 | EACH | CONTROLLER AND CABINET (COMPLETE) |
| 8 | EACH | SIGNAL HEAD, 1 - FACE, 3 - SECTION |
| 4 | EACH | SIGNAL HEAD, 1 - FACE, 5 - SECTION |
| 6 | EACH | TRAFFIC SIGNAL BACKPLATE |
| 2 | EACH | SIGNAL POST |
| 8 | EACH | PEDESTRIAN SIGNAL HEAD, 1-FACE |
| 8 | EACH | PEDESTRIAN PUSHBUTTON |
| 1 | EACH | SERVICE INSTALLATION |

FILE NAME =	USER NAME = #USER#	DESIGNED - JS	REVISED -	STATE OF ILLINOIS DEPARTMENT OF TRANSPORTATION	IL ROUTE 50 (CICERO AVE.) AND 99TH ST. REMOVE EXISTING TRAFFIC SIGNAL EQUIPMENT PLAN	F.A.P. RTE.	SECTION	COUNTY	TOTAL SHEETS	SHEET NO.	
#FILE#		DRAWN - DW	REVISED -			350	2009-013 TS	COOK	29	7	
		CHECKED - JD	REVISED -			CONTRACT NO. 60G11					
		DATE -	REVISED -			FED. ROAD DIST. NO. ILLINOIS FED. AID PROJECT					
				SCALE: 1"=20'		SHEET NO. 7 OF 29 SHEETS		STA. TO STA.			